

District I  
PO Box 1980, Hobbs, NM 88241-1980  
District II  
811 S. 1st Street, Artesia, NM 88210-2834  
District III  
1000 Rio Brazos Rd., Aztec, NM 87410  
District IV  
2040 South Pacheco, Santa Fe, NM 87505

State of New Mexico  
Energy, Minerals & Natural Resources Department

OIL CONSERVATION DIVISION  
2040 South Pacheco  
Santa Fe, NM 87505

Form C-101  
Revised October 18, 1994  
Instructions on back  
Submit to Appropriate District Office  
State Lease - 6 Copies  
Fee Lease - 5 Copies

☐ AMENDED REPORT

APPLICATION FOR PERMIT TO DRILL, RE-ENTER, DEEPEN, PLUGBACK, OR ADD A ZONE

<sup>1</sup> Operator name and Address Marathon Oil Company P.O. Box 552 Midland, TX 79702		<sup>2</sup> OGRID Number 14021
<sup>4</sup> Property Code 22992		<sup>3</sup> API Number 30-025-34341
<sup>5</sup> Property Name W. H. LAUGHLIN		<sup>6</sup> Well No. 8

<sup>7</sup> Surface Location

UL or lot no.	Section	Township	Range	Lot. Idn	Feet from the	North/South Line	Feet from the	East/West line	County
F	9	20-S	37-E		1760	NORTH	1750	WEST	LEA

<sup>8</sup> Proposed Bottom Hole Location If Different From Surface

UL or lot no.	Section	Township	Range	Lot. Idn	Feet from the	North/South Line	Feet from the	East/West line	County

<sup>9</sup> Proposed Pool 1

MONUMENT (TUBB) (ABO)

<sup>10</sup> Proposed Pool 2

MONUMENT (PADDOCK) WEIR BLINEBRY

<sup>11</sup> Work Type Code N	<sup>12</sup> Well Type Code O	<sup>13</sup> Cable/Rotary ROTARY	<sup>14</sup> Lease Type Code P	<sup>15</sup> Ground Level Elevation 3545
<sup>16</sup> Multiple NO	<sup>17</sup> Proposed Depth 7800	<sup>18</sup> Formation ABO	<sup>19</sup> Contractor PATTERSON 71	<sup>20</sup> Spud Date 3/30/98

<sup>21</sup> Proposed Casing and Cement Program

Hole Size	Casing Size	Casing weight/foot	Setting Depth	Sacks of Cement	Estimated TOC
17.5"	16"	CONDUCTOR	40'	REDI-MIX	SURFACE
12.25"	8.625"	24	1140'	400	SURFACE
7.875"	5.5"	15.5, 17	7800'	1150	SURFACE

<sup>22</sup> Describe the proposed program. If this application is to DEEPEN or PLUG BACK give the data on the present productive zone and proposed new productive zone. Describe the blowout prevention program, if any. Use additional sheets if necessary

PROPOSED BOPE: INTERMEDIATE - 13 5/8" 5M DUAL RAM, ANNULAR, ROTATING HEAD.

PRODUCTION HOLE: 11" 3M, DUAL RAM, ANNULAR, ROTATING HEAD.

ALL CASING SHALL BE RUN & CEMENTED ACCORDING TO OCD RULE #107.

ALL BOPE SHALL BE INSTALLED AND TESTED ACCORDING TO OCD RULES #109 & #114.

Permit Expires 1 Year From Approval  
Data Unless Drilling Underway

<sup>23</sup> I hereby certify that the information given above is true and complete to the best of my knowledge and belief.

Signature:

*Walter J. Norton*

Printed name:

D. P. NORT

Title:

DRILLING SUPERINTENDENT

OIL CONSERVATION DIVISION

Approved by:

ORIGINAL SIGNED BY CHRIS WILLIAMS

Title:

DRILLING SUPERVISOR

Approval Date:

Expiration Date:

DISTRICT I  
P.O. Box 1980, Hobbs, NM 88241-1980

State of New Mexico  
Energy, Minerals and Natural Resources Department

Form C-102  
Revised February 10, 1994  
Submit to Appropriate District Office  
State Lease - 4 Copies  
Fee Lease - 3 Copies

DISTRICT II  
P.O. Drawer DD, Artesia, NM 88211-0719

DISTRICT III  
1000 Rio Brazos Rd., Aztec, NM 87410

DISTRICT IV  
P.O. BOX 2088, SANTA FE, N.M. 87504-2088

OIL CONSERVATION DIVISION  
P.O. Box 2088  
Santa Fe, New Mexico 87504-2088

☐ AMENDED REPORT

WELL LOCATION AND ACREAGE DEDICATION PLAT

API Number <b>30-025-34341</b>	Pool Code <b>46970</b>	Pool Name <b>MONUMENT ABO</b>
Property Code <b>22992</b>	Property Name <b>W.H. LAUGHLIN</b>	Well Number <b>8</b>
OGRID No. <b>14021</b>	Operator Name <b>MARATHON OIL COMPANY</b>	Elevation <b>3545</b>

Surface Location

UL or lot No. <b>F</b>	Section <b>9</b>	Township <b>20 S</b>	Range <b>37 E</b>	Lot Idn	Feet from the <b>1760</b>	North/South line <b>NORTH</b>	Feet from the <b>1750</b>	East/West line <b>WEST</b>	County <b>LEA</b>
---------------------------	---------------------	-------------------------	----------------------	---------	------------------------------	----------------------------------	------------------------------	-------------------------------	----------------------

Bottom Hole Location If Different From Surface

UL or lot No.	Section	Township	Range	Lot Idn	Feet from the	North/South line	Feet from the	East/West line	County
---------------	---------	----------	-------	---------	---------------	------------------	---------------	----------------	--------

Dedicated Acres <b>40</b>	Joint or Infill	Consolidation Code	Order No.
------------------------------	-----------------	--------------------	-----------

NO ALLOWABLE WILL BE ASSIGNED TO THIS COMPLETION UNTIL ALL INTERESTS HAVE BEEN CONSOLIDATED  
OR A NON-STANDARD UNIT HAS BEEN APPROVED BY THE DIVISION

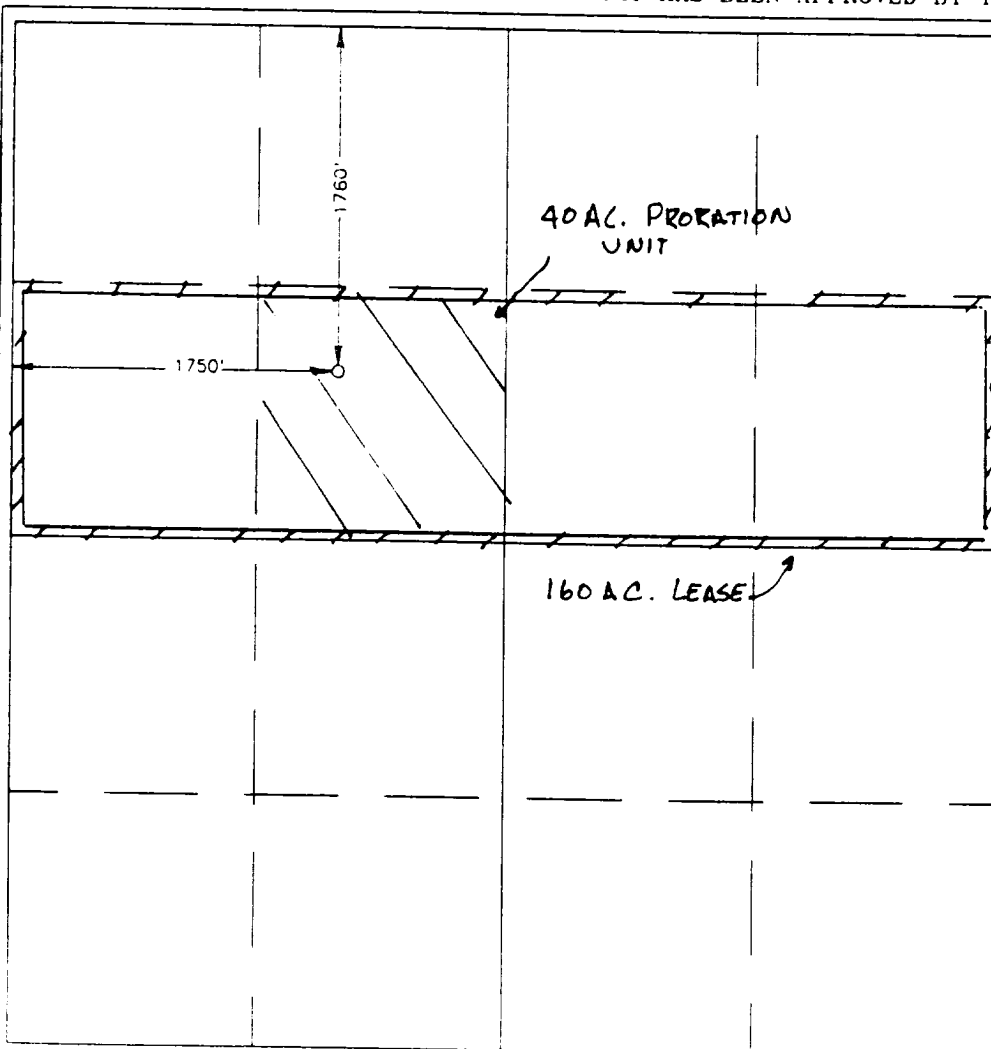

OPERATOR CERTIFICATION

I hereby certify the the information  
contained herein is true and complete to the  
best of my knowledge and belief.

*Walter J. Nordt*  
Signature

D. P. Nordt  
Printed Name

Drilling Superintendent  
Title

3/11/98  
Date

SURVEYOR CERTIFICATION

I hereby certify that the well location shown  
on this plat was plotted from field notes of  
actual surveys made by me or under my  
supervision, and that the same is true and  
correct to the best of my belief.

FEBRUARY 13, 1998

Date Surveyed DMCC

Signature & Seal of  
Professional Surveyor

*Samuel E. Olson* 2-19-98  
98-11-0234

Certificate No. JOHN W. WEST 676  
RONALD J. EIDSON 3239  
CARP EIDSON 2641

DISTRICT I  
P.O. Box 1980, Hobbs, NM 88241-1980

State of New Mexico  
Energy, Minerals and Natural Resources Department

Form C-102  
Revised February 10, 1994  
Submit to Appropriate District Office  
State Lease - 4 Copies  
Fee Lease - 3 Copies

DISTRICT II  
P.O. Drawer DD, Artesia, NM 88211-0719

DISTRICT III  
1000 Rio Brazos Rd., Aztec, NM 87410

DISTRICT IV  
P.O. BOX 2088, SANTA FE, N.M. 87504-2088

OIL CONSERVATION DIVISION

P.O. Box 2088  
Santa Fe, New Mexico 87504-2088

☐ AMENDED REPORT

WELL LOCATION AND ACREAGE DEDICATION PLAT

API Number <b>30-025-34341</b>	Pool Code <b>47090</b>	Pool Name <b>Monument Tubb</b>
Property Code <b>22992</b>	Property Name <b>W.H. LAUGHLIN</b>	Well Number <b>8</b>
OGRID No. <b>14021</b>	Operator Name <b>MARATHON OIL COMPANY</b>	Elevation <b>3545</b>

Surface Location

UL or lot No. <b>F</b>	Section <b>9</b>	Township <b>20 S</b>	Range <b>37 E</b>	Lot Idn	Feet from the <b>1760</b>	North/South line <b>NORTH</b>	Feet from the <b>1750</b>	East/West line <b>WEST</b>	County <b>LEA</b>
---------------------------	---------------------	-------------------------	----------------------	---------	------------------------------	----------------------------------	------------------------------	-------------------------------	----------------------

Bottom Hole Location If Different From Surface

UL or lot No.	Section	Township	Range	Lot Idn	Feet from the	North/South line	Feet from the	East/West line	County
---------------	---------	----------	-------	---------	---------------	------------------	---------------	----------------	--------

Dedicated Acres <b>80</b>	Joint or Infill	Consolidation Code	Order No.
------------------------------	-----------------	--------------------	-----------

NO ALLOWABLE WILL BE ASSIGNED TO THIS COMPLETION UNTIL ALL INTERESTS HAVE BEEN CONSOLIDATED  
OR A NON-STANDARD UNIT HAS BEEN APPROVED BY THE DIVISION

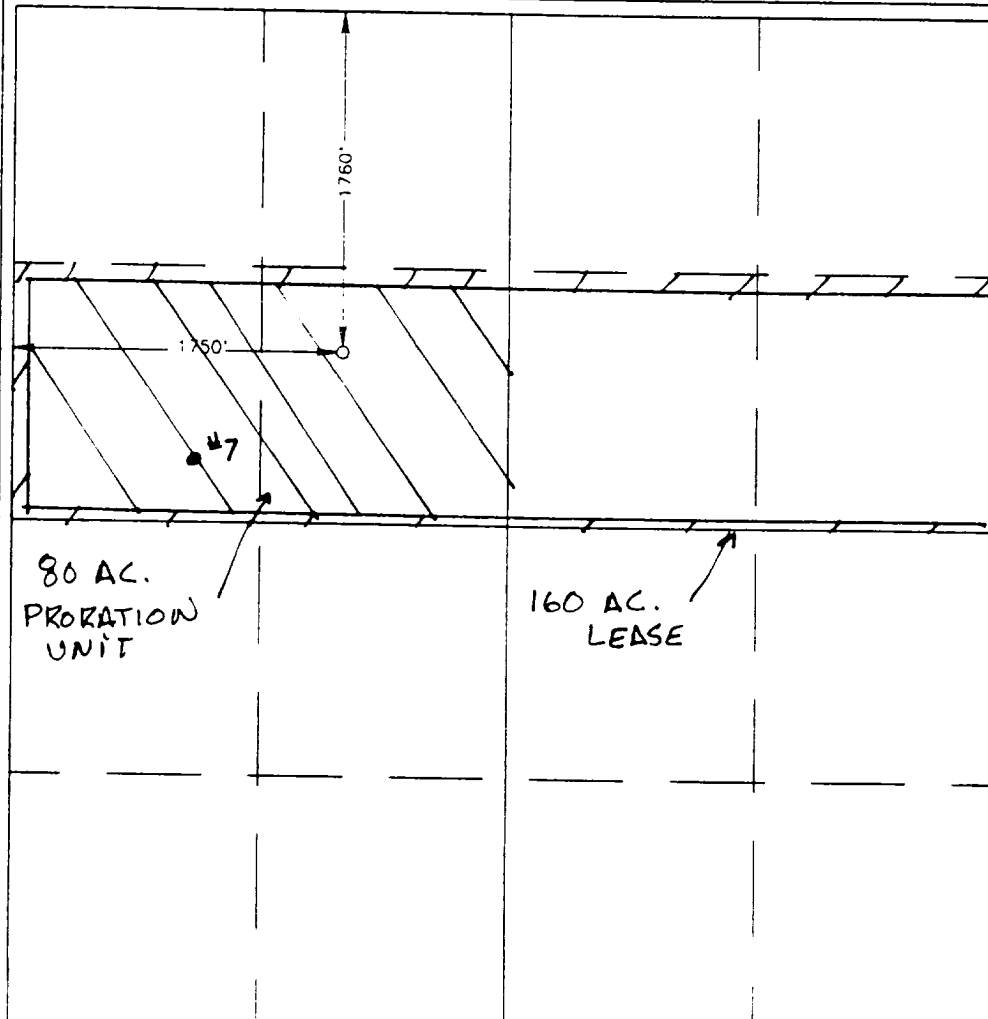
	<p><b>OPERATOR CERTIFICATION</b></p> <p>I hereby certify the the information contained herein is true and complete to the best of my knowledge and belief.</p> <p><i>Walter J. Nordt</i> Signature <b>D. P. Nordt</b> Printed Name <b>Drilling Superintendent</b> Title <b>3/11/98</b> Date</p> <p><b>SURVEYOR CERTIFICATION</b></p> <p>I hereby certify that the well location shown on this plat was plotted from field notes of actual surveys made by me or under my supervision, and that the same is true and correct to the best of my belief.</p> <p><b>FEBRUARY 13, 1998</b> Date Surveyed <b>DMCC</b> Signature &amp; Seal of Professional Surveyor <i>San B. L. ...</i> <b>98-11-0254</b> Certification No. <b>98-11-0254</b> J. EIDSON 676 3239 12641</p>
--	---

DISTRICT I  
P.O. Box 1980, Hobbs, NM 88241-1980

State of New Mexico  
Energy, Minerals and Natural Resources Department

Form C-102  
Revised February 10, 1994  
Submit to Appropriate District Office  
State Lease - 4 Copies  
Fee Lease - 3 Copies

DISTRICT II  
P.O. Drawer DD, Artesia, NM 88211-0719

DISTRICT III  
1000 Rio Brazos Rd., Aztec, NM 87410

DISTRICT IV  
P.O. BOX 2088, SANTA FE, N.M. 87504-2088

OIL CONSERVATION DIVISION  
P.O. Box 2088  
Santa Fe, New Mexico 87504-2088

☐ AMENDED REPORT

WELL LOCATION AND ACREAGE DEDICATION PLAT

API Number <b>30-025-34341</b>	Pool Code <b>47080</b>	Pool Name <b>Monument Paddock</b>
Property Code <b>22992</b>	Property Name <b>W.H. LAUGHLIN</b>	Well Number <b>8</b>
OGRID No. <b>14021</b>	Operator Name <b>MARATHON OIL COMPANY</b>	Elevation <b>3545</b>

Surface Location

UL or lot No. <b>F</b>	Section <b>9</b>	Township <b>20 S</b>	Range <b>37 E</b>	Lot Idn	Feet from the <b>1760</b>	North/South line <b>NORTH</b>	Feet from the <b>1750</b>	East/West line <b>WEST</b>	County <b>LEA</b>
---------------------------	---------------------	-------------------------	----------------------	---------	------------------------------	----------------------------------	------------------------------	-------------------------------	----------------------

Bottom Hole Location If Different From Surface

UL or lot No.	Section	Township	Range	Lot Idn	Feet from the	North/South line	Feet from the	East/West line	County
Dedicated Acres <b>40</b>	Joint or Infill	Consolidation Code	Order No.						

NO ALLOWABLE WILL BE ASSIGNED TO THIS COMPLETION UNTIL ALL INTERESTS HAVE BEEN CONSOLIDATED  
OR A NON-STANDARD UNIT HAS BEEN APPROVED BY THE DIVISION

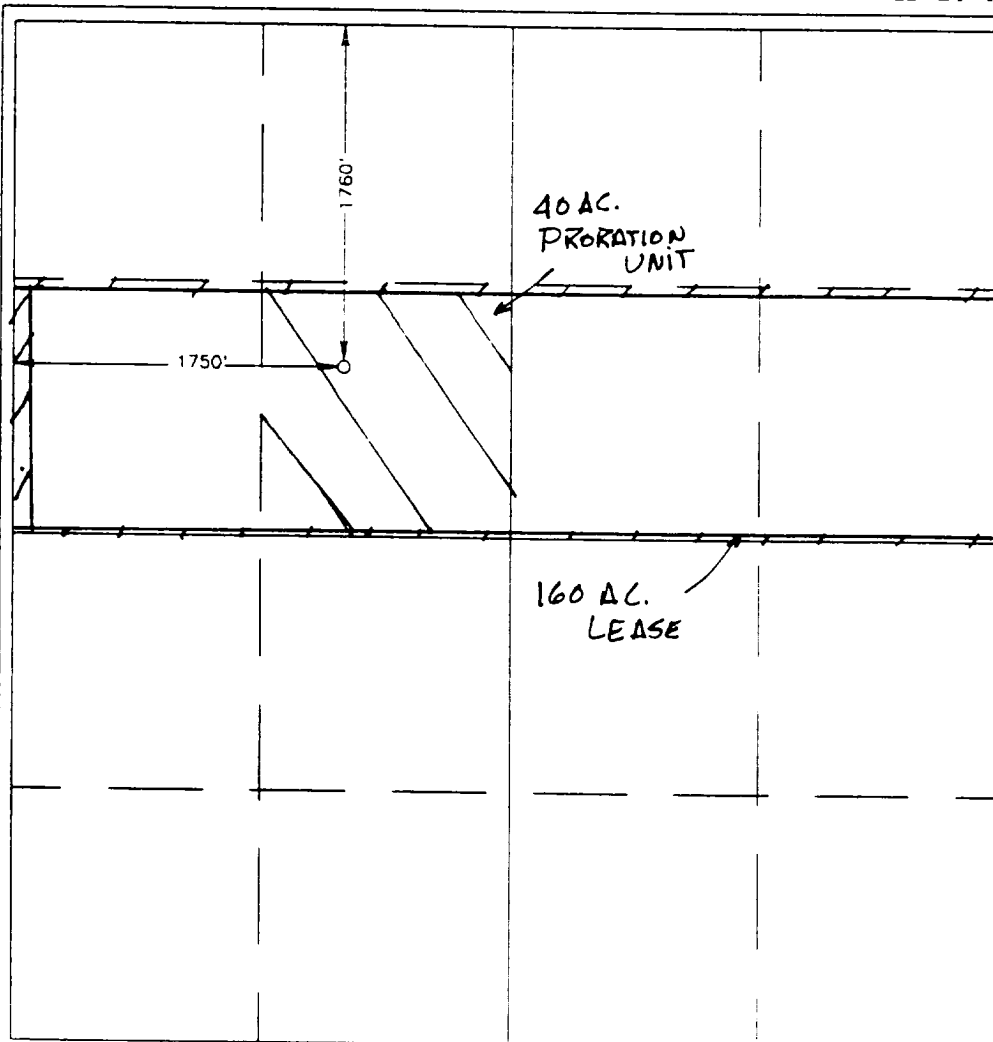

OPERATOR CERTIFICATION

I hereby certify that the information contained herein is true and complete to the best of my knowledge and belief.

Signature

D. P. Nordt

Printed Name

Drilling Superintendent

Title

3/11/98

Date

SURVEYOR CERTIFICATION

I hereby certify that the well location shown on this plat was plotted from field notes of actual surveys made by me or under my supervision, and that the same is true and correct to the best of my belief.

FEBRUARY 13, 1998

Date Surveyed

DMCC

Signature and Seal of  
Professional Surveyor

*Barry D. Nelson* 2-19-98  
98-11-0232

Certificate No. JOHN W. WEST  
RONALD E. EIDSON  
DAVID L. EIDSON

676  
3239  
12641

DISTRICT I  
P.O. Box 1980, Hobbs, NM 88241-1980

State of New Mexico  
Energy, Minerals and Natural Resources Department

Form C-102  
Revised February 10, 1994  
Submit to Appropriate District Office  
State Lease - 4 Copies  
Fee Lease - 3 Copies

DISTRICT II  
P.O. Drawer DD, Artesia, NM 88211-0719

DISTRICT III  
1000 Rio Brazos Rd., Aztec, NM 87410

DISTRICT IV  
P.O. BOX 2088, SANTA FE, N.M. 87504-2088

OIL CONSERVATION DIVISION

P.O. Box 2088  
Santa Fe, New Mexico 87504-2088

☐ AMENDED REPORT

WELL LOCATION AND ACREAGE DEDICATION PLAT

API Number <b>30-025-34341</b>	Pool Code <b>63780</b>	Pool Name <b>Weir Blinebry</b>
Property Code <b>22992</b>	Property Name <b>W.H. LAUGHLIN</b>	Well Number <b>8</b>
OGRID No. <b>14021</b>	Operator Name <b>MARATHON OIL COMPANY</b>	Elevation <b>3545</b>

Surface Location

UL or lot No. <b>F</b>	Section <b>9</b>	Township <b>20 S</b>	Range <b>37 E</b>	Lot Idn	Feet from the <b>1760</b>	North/South line <b>NORTH</b>	Feet from the <b>1750</b>	East/West line <b>WEST</b>	County <b>LEA</b>
---------------------------	---------------------	-------------------------	----------------------	---------	------------------------------	----------------------------------	------------------------------	-------------------------------	----------------------

Bottom Hole Location If Different From Surface

UL or lot No.	Section	Township	Range	Lot Idn	Feet from the	North/South line	Feet from the	East/West line	County
Dedicated Acres <b>40</b>	Joint or Infill	Consolidation Code	Order No.						

NO ALLOWABLE WILL BE ASSIGNED TO THIS COMPLETION UNTIL ALL INTERESTS HAVE BEEN CONSOLIDATED  
OR A NON-STANDARD UNIT HAS BEEN APPROVED BY THE DIVISION

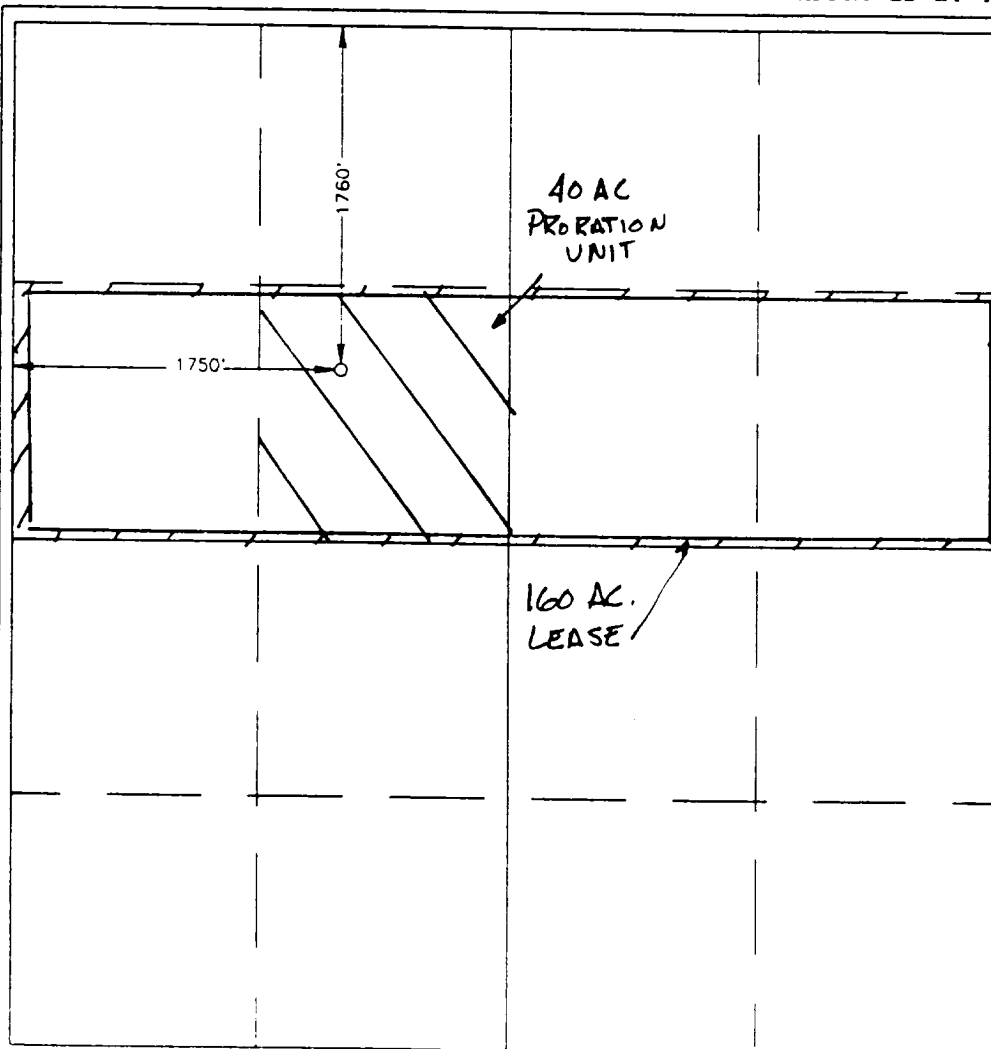

OPERATOR CERTIFICATION

I hereby certify that the information contained herein is true and complete to the best of my knowledge and belief.

Signature

**D. P. Nordt**

Printed Name

Drilling Superintendent

Title

**3/11/98**

Date

SURVEYOR CERTIFICATION

I hereby certify that the well location shown on this plat was plotted from field notes of actual surveys made by me or under my supervision, and that the same is true and correct to the best of my belief.

**FEBRUARY 13, 1998**

Date Surveyed

DMCC

Signature & Seal of  
Professional Surveyor

**Samuel J. Eidson** 2-19-98  
98-11-0234

Certificate No. **JOHN B. WEST**  
**RONALD J. EIDSON**  
PROFESSIONAL SURVEYOR

676  
3239  
12641