

DISTRICT I
P.O. Box 1980, Hobbs, NM 88241-198
DISTRICT II
P.O. Box Drawer DD, Artesia, NM 88211-0719
DISTRICT III
1000 Rio Brazos Rd., Aztec, NM 87410
DISTRICT IV
P.O. Box 2088, Santa Fe, NM 87504-2088

State of New Mexico
Energy, Minerals and Natural Resources Department

OIL CONSERVATION DIVISION

P.O. Box 2088
Santa Fe, New Mexico 87504-2088

Form C-101
Revised February 10, 1994
Instructions on back
Submit to Appropriate District Office
State Lease - 6 Copies
Fee Lease - 5 Copies

☐ AMENDED REPORT

APPLICATION FOR PERMIT TO DRILL, RE-ENTER, DEEPEN, PLUGBACK, OR ADD A ZONE

¹ Operator Name and Address TEXACO EXPLORATION & PRODUCTION INC. 205 E. Bender, HOBBS, NM 88240		² OGRIC Number 022351
⁴ Property Code 011127	⁵ Property Name VAN ETEN L.	³ API Number 30 025 34528
		⁶ Well No. 19

⁷ Surface Location

UI or lot no.	Section	Township	Range	Lot.Idn	Feet From The	North/South Line	Feet From The	East/West Line	County
0	9	20S	37E		467	SOUTH	1650	EAST	LEA

⁸ Proposed Bottom Hole Location If Different From Surface

UI or lot no.	Section	Township	Range	Lot.Idn	Feet From The	North/South Line	Feet From The	East/West Line	County
⁹ Proposed Pool 1 Weir Denardo					¹⁰ Proposed Pool 2				

¹¹ Work Type Code P	¹² Well Type Code O	¹³ Rotary or C.T. ROTARY	¹⁴ Lease Type Code P	¹⁵ Ground Level Elevation 3544 G.
¹⁶ Multiple Yes	¹⁷ Proposed Depth 7500'	¹⁸ Formation Pad/Blnbry/Tubb/Drkd	¹⁹ Contractor	²⁰ Spud Date C4/15/1989

²¹ Proposed Casing and Cement Program

SIZE OF HOLE	SIZE OF CASING	WEIGHT PER FOOT	SETTING DEPTH	SACKS OF CEMENT	EST. TOP
11"	8-5/8"	24#	1150'	450 SX, CIRC.	
7-7/8"	5-1/2"	15.5#LS65	1125'		
7-7/8"	5-1/2"	15.5#K55	7500'	1320 SX, CIRC.	

²² Describe the proposed program. If this application is to DEEPEN or PLUG BACK give the data on the present productive zone and proposed new productive zone. Describe the blowout prevention program, if any. Use additional sheets if necessary.

Texaco intends to drill out existing plugs and recomplete in the Drinkard formation. The intended procedure is as follows:
1. MIRU. Install BOP. PU and GIH w/ 4-3/4" bit, drill collars, and a 2-7/8" workstring. Tag PBTD at about 5347'.
2. RU reverse unit and drillout 3 CIBP's w/ 35' of cement located at following depths: 5347 (CIBP @ 5382), 5440 (CIBP @ 5475), and 6171 (CIBP @ 6206). Wash down to new PBTD @ 6985' TOH w/tubing.
3. RU Schlumberger w/ full lubricator and packoff. RIH w/ a 4" casing gun loaded w/ Hyperjet II HMX charges & perf. 48 shots @ 2 SPF in 24 net feet between 6788' - 6812'.
4. GIH w/ 100' of tailpipe, a 2-7/8" X 5-1/2" treat. pkr. & 2-7/8" tub. to surface. position end of tailpipe @ 6840'. RU Dowell. Spot 2 bbls. of 15% acid to across perfs. POOH to about 6675' w/ end of tailpipe & 6575' w/ packer. Set pkr. & acidize perfs. w/ 3500 gal. 15% NEFE HCL dropping 36 1.3SG ball sealers. Maximum pmp. rate 4 BPM & maximum pmp. press. of 2200psi. Flush to bottom perf. w/ 2% KCL water. SD, get ISIP, 5 min, 10 min. and 15 min SITP. RD Dowell.
5. Shut in for 2 hours. Flow or swab back. 6. Evaluate well for downhole commingling of all perforated zones.

²³ I hereby certify that the rules and regulations of the Oil Conservation Division have been complied with and that the information given above is true and complete to the best of my knowledge and belief.		OIL CONSERVATION DIVISION	
Signature <i>Bobby J. Hill</i>			
Printed Name Bobby J. Hill		Approved By: <i>Geologist</i>	
Title Engineering Assistant		Title:	
Date 09/10/1999		Approval Date: SEP 10 1999 Expiration Date:	
Telephone 397-0444		Conditions of Approval: Attached <input type="checkbox"/>	



DISTRICT I
P.O. Box 1980, Hobbs, NM 88241-1980
DISTRICT II
P.O. Box Drawer DD, Artesia, NM 88211-0719
DISTRICT III
1000 Rio Brazos Rd., Aztec, NM 87410
DISTRICT IV
P.O. Box 2088, Santa Fe, NM 87504-2088

State of New Mexico
Energy, Minerals and Natural Resources Department

OIL CONSERVATION DIVISION

P.O. Box 2088
Santa Fe, New Mexico 87504-2088

Form C-102
Revised February 10, 1994
Instructions on back
Submit to Appropriate District Office
State Lease - 4 Copies
Federal Lease - 3 Copies
☐ AMENDED REPORT

WELL LOCATION AND ACREAGE DEDICATION PLAT

¹ API Number 30 025 34528	² Pool Code 63780 63840	³ Pool Name Paddock/Blinberry/Tubb/Drinkard
⁴ Property Code 011127	⁵ Property Name VAN ETEN L.	⁶ Well No. 19
⁷ OGRID Number 022351	⁸ Operator Name TEXACO EXPLORATION & PRODUCTION INC.	⁹ Elevation 3544 GL

¹⁰ Surface Location

UI or lot no. O	Section 9	Township 20S	Range 37E	Lot.Idn	Feet From The 467	North/South Line SOUTH	Feet From The 1650	East/West Line EAST	County LEA
--------------------	--------------	-----------------	--------------	---------	----------------------	---------------------------	-----------------------	------------------------	---------------

¹¹ Bottom Hole Location If Different From Surface

UI or lot no.	Section	Township	Range	Lot.Idn	Feet From The	North/South Line	Feet From The	East/West Line	County
¹² Dedicated Acres 40	¹³ Joint or Infill No	¹⁴ Consolidation Code	¹⁵ Order No.						

NO ALLOWABLE WILL BE ASSIGNED TO THIS COMPLETION UNTIL ALL INTERESTS HAVE BEEN CONSOLIDATED
OR A NON-STANDARD UNIT HAS BEEN APPROVED BY THE DIVISION

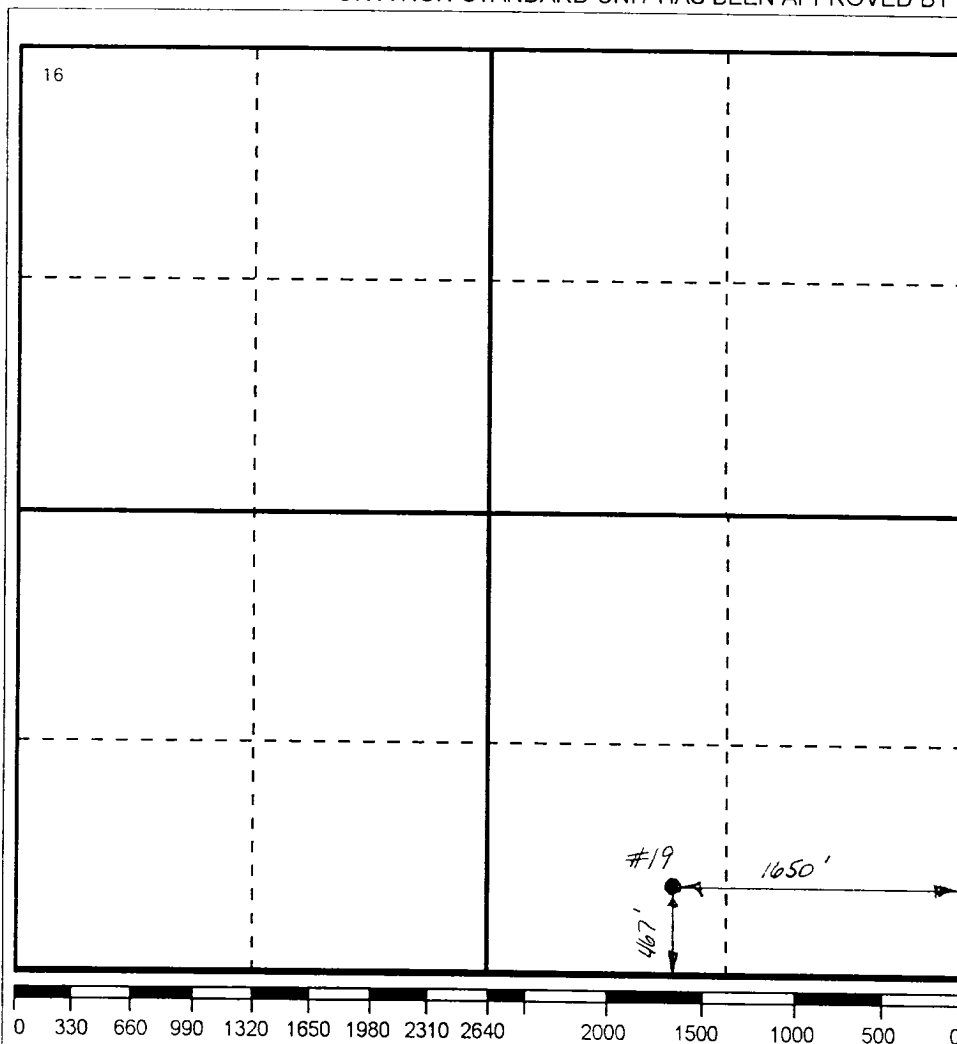

17 OPERATOR CERTIFICATION

I hereby certify that the information contained herein is true and complete to the best of my knowledge and belief

Signature

Bobby J. Hill

Printed Name

Bobby J. Hill

Position

Engineering Assistant

Date

09/10/1999

18 SURVEYOR CERTIFICATION

I hereby certify that the well location shown on this plat was plotted from field notes of actual surveys made by me or under my supervision, and that the same is true and correct to the best of my knowledge and belief.

Date Surveyed

Signature & Seal of
Professional Surveyor

Certificate No.

