

NEARBURG PRODUCING COMPANY HYDROGEN SULFIDE DRILLING OPERATIONS LOCATION PLAN

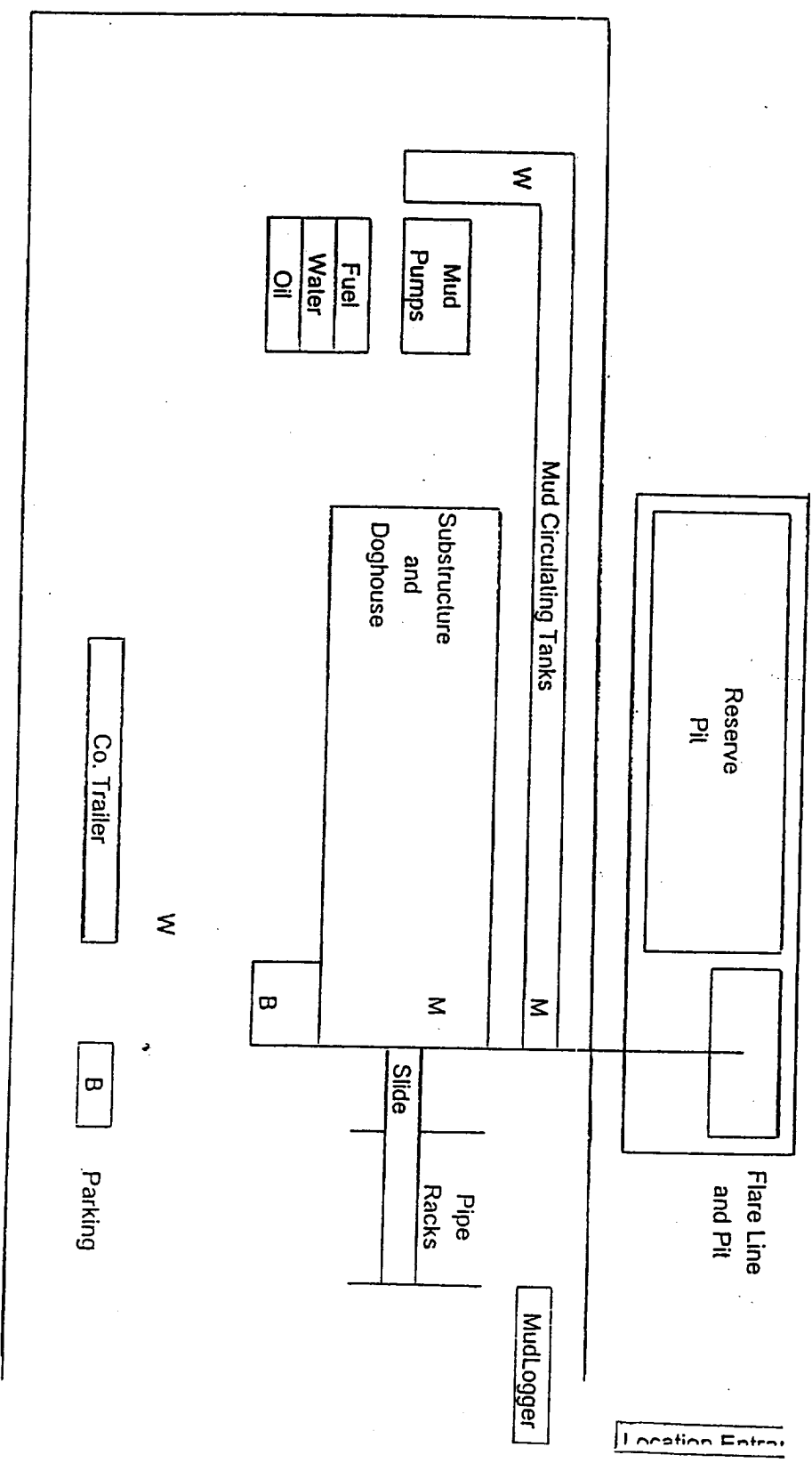

M - H2S Monitors with alarms at bell nipple and shale shaker

W - Wind Direction Indicators

B - Safe Briefing areas with caution signs and protective breathing equipment.
Minimum 150' from wellhead.

Viper 3 Federal Com #2
Section 3, T20S, R33E
1,650' FSL & 1,980' FEL
Lea County, New Mexico

Prevailing Wind Directions: Summer - South/Southwest
Winter - North/Northwest

