

DISTRICT I
P. O. Box 1980
Hobbs, NM 88241-1980

State of New Mexico
Minerals, and Natural Resources Department

Form C-102
Revised 02-10-94
Instructions on back

DISTRICT II
P. O. Drawer DD
Artesia, NM 88211-0719

OIL CONSERVATION DIVISION
P. O. Box 2088
Santa Fe, New Mexico 87504-2088

Submit to the Appropriate
District Office
State Lease - 4 copies
Fee Lease - 3 copies

☐ AMENDED REPORT

DISTRICT III
1000 Rio Brazos Rd.
Aztec, NM 87410

DISTRICT IV
P. O. Box 2088
Santa Fe, NM 87507-2088

WELL LOCATION AND ACREAGE DEDICATION PLAT

1 API Number 30-025-35151	2 Pool Code 57000 97060	3 Pool Name Wildcat Monument Skaggs; Drinkard
4 Property Code 10918	5 Property Name COOPER '5'	6 Well Number 6
7 OGRID No. 014245	8 Operator Name MATADOR OPERATING COMPANY	9 Elevation 3580'

10 SURFACE LOCATION

UL or lot no. G	Section 5	Township 20 SOUTH	Range 37 EAST, N.M.P.M.	Lot Ida	Feet from the 2310'	North/South line NORTH	Feet from the 2064'	East/West line EAST	County LEA
--------------------	--------------	----------------------	----------------------------	---------	------------------------	---------------------------	------------------------	------------------------	---------------

"BOTTOM HOLE LOCATION IF DIFFERENT FROM SURFACE

UL or lot no.	Section	Township	Range	Lot Ida	Feet from the	North/South line	Feet from the	East/West line	County
---------------	---------	----------	-------	---------	---------------	------------------	---------------	----------------	--------

12 Dedicated Acres	13 Joint or Infill	14 Consolidation Code	15 Order No.
--------------------	--------------------	-----------------------	--------------

NO ALLOWABLE WELL BE ASSIGNED TO THIS COMPLETION UNTIL ALL INTERESTS HAVE BEEN CONSOLIDATED OR A NON-STANDARD UNIT HAS BEEN APPROVED BY THE DIVISION

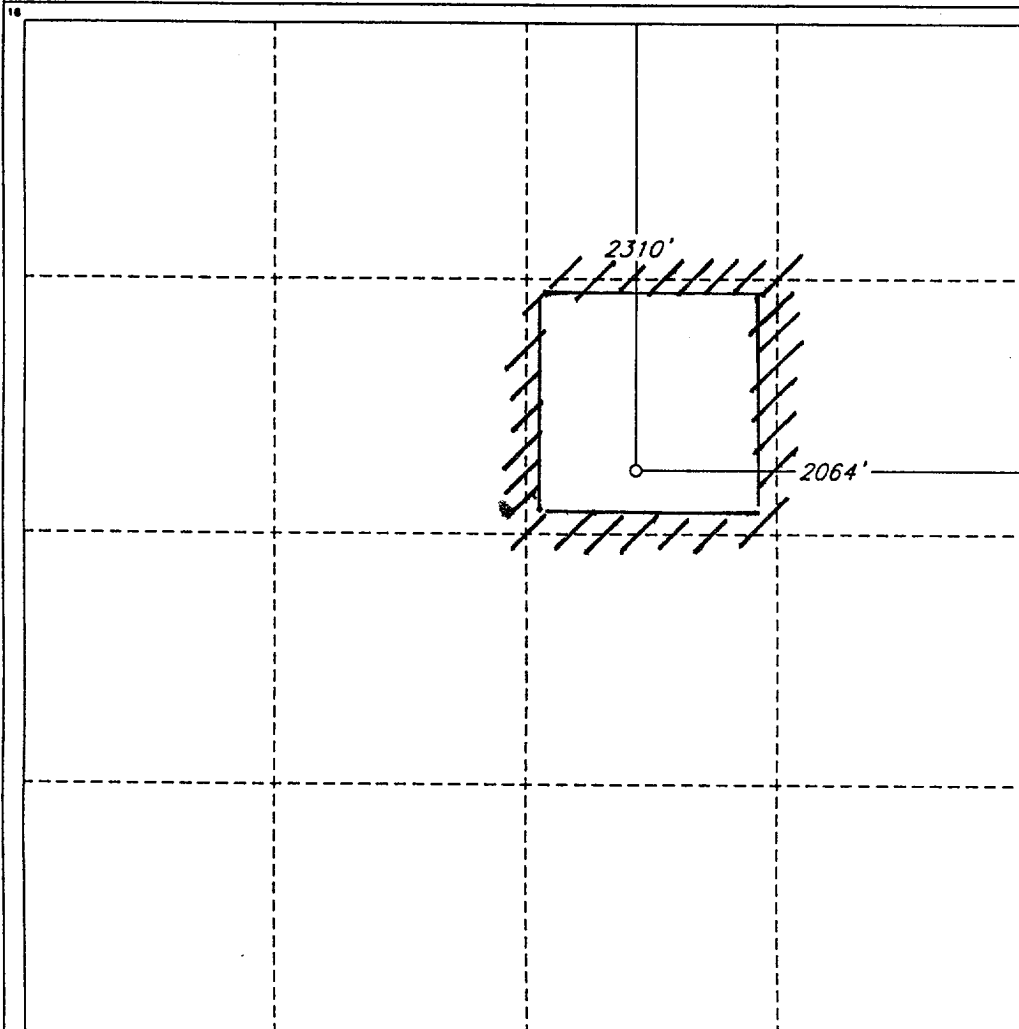

OPERATOR CERTIFICATION

I hereby certify that the information contained herein is true and complete to the best of my knowledge and belief.

Signature
Russ Mathis

Printed Name
Russ Mathis

Title
Production Manager

Date
12/27/00

SURVEYOR CERTIFICATION

I hereby certify that the well location shown on this plat was plotted from field notes of actual surveys made by me or under my supervision, and that the same is true and correct to the best of my belief.

Date of Survey
AUGUST 31, 2000

Signature and Seal of Professional Surveyor

V. LYNN BEZNER
NO. 71384
V. Lynn Bezner

Certificate No.
V. L. BEZNER R.P.S. #7920

JOB #71384 / 70 SW / JCP

2007
10/2
Received
from
DND

10/22/2007 10:24:26 AM