

District I  
1625 N. French Dr., Hobbs, NM 88240  
District II  
811 South First, Artesia, NM 88210  
District III  
1000 Rio Brazos Road, Aztec, NM 87410  
District IV  
2040 South Pacheco, Santa Fe, NM 87505

State of New Mexico  
Energy Minerals and Natural Resources

Oil Conservation Division  
2040 South Pacheco  
Santa Fe, NM 87505

Form C-101  
Revised March 17, 1999

Submit to appropriate District Office  
State Lease - 6 Copies  
Fee Lease - 5 Copies

☐ AMENDED REPORT

APPLICATION FOR PERMIT TO DRILL, RE-ENTER, DEEPEN, PLUGBACK, OR ADD A ZONE

<sup>1</sup> Operator Name and Address Matador Operating Company 8340 Meadow Rd., #158 Dallas, TX 75231		<sup>2</sup> OGRID Number 014245
		<sup>3</sup> API Number 30-025-35348
<sup>3</sup> Property Code 25471	<sup>5</sup> Property Name Laughlin	<sup>6</sup> Well No. 3

<sup>7</sup> Surface Location

UL or lot no.	Section	Township	Range	Lot Idn	Feet from the	North/South line	Feet from the	East/West line	County
O	4	20S	37E		430'	South	1650'	East	Lea

<sup>8</sup> Proposed Bottom Hole Location If Different From Surface

UL or lot no.	Section	Township	Range	Lot Idn	Feet from the	North/South line	Feet from the	East/West line	County

<sup>9</sup> Proposed Pool 1

Wildcat; ~~Stage~~ Drinkard 97060

<sup>10</sup> Proposed Pool 2

<sup>11</sup> Work Type Code N	<sup>12</sup> Well Type Code O	<sup>13</sup> Cable/Rotary R	<sup>14</sup> Lease Type Code P	<sup>15</sup> Ground Level Elevation 3551'
<sup>16</sup> Multiple No	<sup>17</sup> Proposed Depth 6900'	<sup>18</sup> Formation Drinkard	<sup>19</sup> Contractor Paterson Drilling	<sup>20</sup> Spud Date 1-25-01

<sup>21</sup> Proposed Casing and Cement Program

Hole Size	Casing Size	Casing weight/foot	Setting Depth	Sacks of Cement	Estimated TOC
12-1/4"	8-5/8"	24#	1350'	450 sx	Circ to surface
7-7/8"	4-1/2"	11.6#	6900'	600 sx	3000'

<sup>22</sup> Describe the proposed program. If this application is to DEEPEN or PLUG BACK, give the data on the present productive zone and proposed new productive zone. Describe the blowout prevention program, if any. Use additional sheets if necessary.

Drill 12-1/4" hole to top of Anhydrite @ +/- 1350'. Run and cement to surface 8-5/8" casing. Nipple up 11" 3M BOP assembly and test to 3000 psi. Drill 7-7/8" hole to 6900'. Evaluate to run production casing.

Permit Expires 1 Year From Approval  
Date Unless Drilling Underway

<sup>23</sup> I hereby certify that the information given above is true and complete to the best of my knowledge and belief.

Signature:

Printed name: Jim Kramer

Title: Sr. Drilling Engineer

Date: 1/9/01

Phone:  
214-987-7128

OIL CONSERVATION DIVISION

Approved by:

Title:

Approval Date:

Expiration Date:

Conditions of approval: JAN 22 2001

Attached ☐

**DISTRICT I**  
P. O. Box 1980  
Hobbs, NM 88241-1980

**DISTRICT II**  
P. O. Drawer DD  
Artesia, NM 88211-0719

**DISTRICT III**  
1000 Rio Brazos Rd.  
Aztec, NM 87410

**DISTRICT IV**  
P. O. Box 2088  
Santa Fe, NM 87507-2088

State of New Mexico  
En. y. Minerals, and Natural Resources Department

Form C-102  
Revised 02-10-94  
Instructions on back

Submit to the Appropriate  
District Office  
State Lease - 4 copies  
Fee Lease - 3 copies

**OIL CONSERVATION DIVISION**  
P. O. Box 2088  
Santa Fe, New Mexico 87504-2088

☐ AMENDED REPORT

**WELL LOCATION AND ACREAGE DEDICATION PLAT**

1 API Number <b>30-025-35348</b>		2 Pool Code <b>57000</b>		3 Pool Name <b>wildcat Skages; Drinkard</b>			
4 Property Code <b>25471</b>		5 Property Name <b>LAUGHLIN</b>				6 Well Number <b>3</b>	
7 OGRID No. <b>14245</b>		8 Operator Name <b>MATADOR OPERATING COMPANY</b>				9 Elevation <b>3551'</b>	

**10 SURFACE LOCATION**

UL or lot no. <b>0</b>	Section <b>4</b>	Township <b>20 SOUTH</b>	Range <b>37 EAST, N.M.P.M.</b>	Lot Ida	Feet from the <b>430'</b>	North/South line <b>SOUTH</b>	Feet from the <b>1650'</b>	East/West line <b>EAST</b>	County <b>LEA</b>
---------------------------	---------------------	-----------------------------	-----------------------------------	---------	------------------------------	----------------------------------	-------------------------------	-------------------------------	----------------------

**11 BOTTOM HOLE LOCATION IF DIFFERENT FROM SURFACE**

UL or lot no.	Section	Township	Range	Lot Ida	Feet from the	North/South line	Feet from the	East/West line	County
---------------	---------	----------	-------	---------	---------------	------------------	---------------	----------------	--------

12 Dedicated Acres <b>40</b>	13 Joint or Infill	14 Consolidation Code	15 Order No.
---------------------------------	--------------------	-----------------------	--------------

NO ALLOWABLE WELL BE ASSIGNED TO THIS COMPLETION UNTIL ALL INTERESTS HAVE BEEN  
CONSOLIDATED OR A NON-STANDARD UNIT HAS BEEN APPROVED BY THE DIVISION

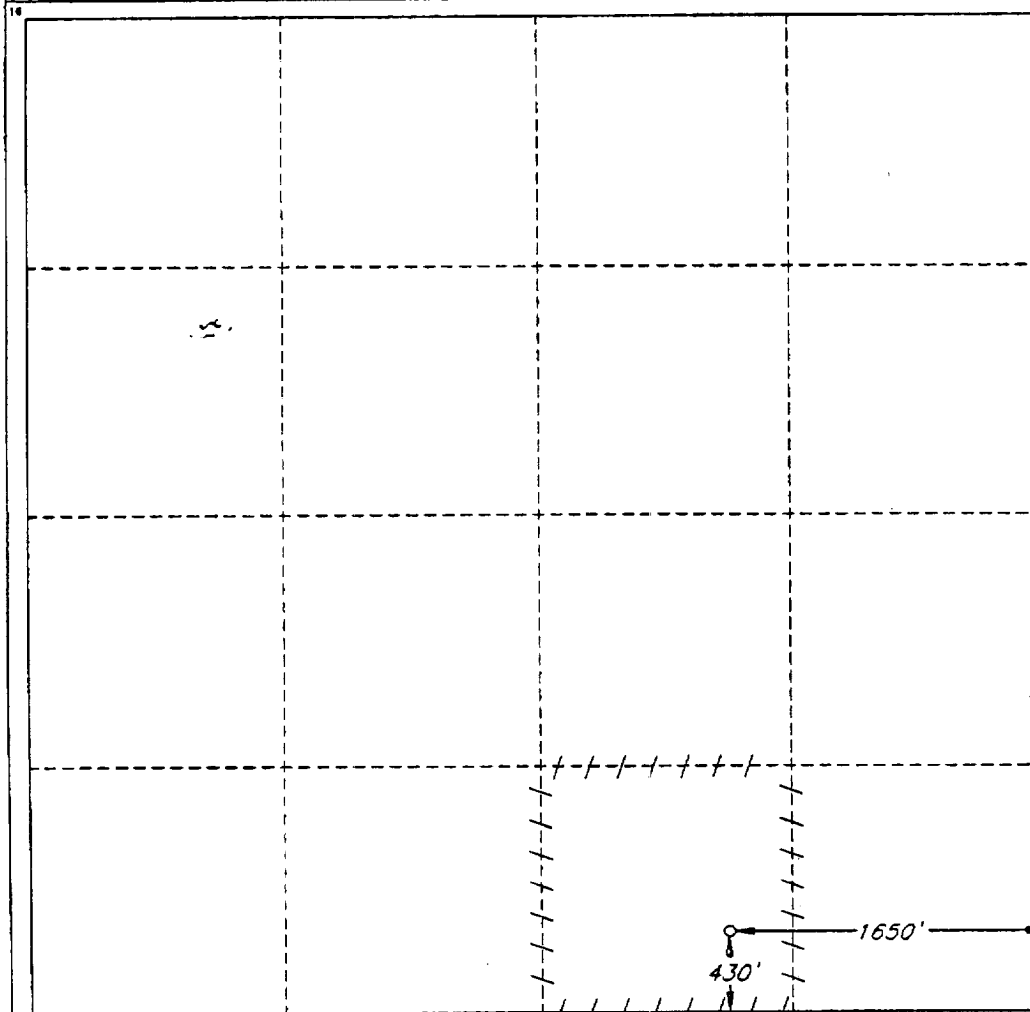

**OPERATOR CERTIFICATION**

I hereby certify that the information  
contained herein is true and complete  
to the best of my knowledge and belief.

Signature  
*Jim Kramer*

Printed Name  
**Jim Kramer**

Title  
**Sr. Drilling Engineer**

Date  
**1/12/01**

**SURVEYOR CERTIFICATION**

I hereby certify that the well  
location shown on this plat was  
plotted from field notes of actual  
surveys made by me or under  
my supervision, and that the  
same is true and correct to the  
best of my belief.

Date of Survey  
**JANUARY 2, 2001**

Signature and Seal of  
Professional Surveyor

**STATE OF NEW MEXICO**  
**V. L. BEYER**  
**NO. 7920**  
**PROF. SURV.**  
**1/12/01**  
Certificate No.  
**V. L. BEYER LAND SURV. #7920**  
JOB #73588 / SE / JCP

ELF 5/15/71  
ABOVE DATE DOES NOT  
INDICATE WHEN  
CONFIDENTIAL LOGS  
WILL BE RELEASED