

State of New Mexico
Energy, Minerals & Natural Resources

Form C-101
Revised March 17, 1999

District I
1625 N. French Dr., Hobbs, NM 88240
District II
811 S. 1st Street, Artesia, NM 88210
District III
1000 Rio Brazos Rd., Aztec, NM 87410
District IV
2040 South Pacheco, Santa Fe, NM 87505

Oil Conservation Division
2040 South Pacheco
Santa Fe, NM 87505

Submit to appropriate District Office
State Lease - 6 Copies
Fee Lease - 5 Copies

☐ AMENDED REPORT

APPLICATION FOR PERMIT TO DRILL, RE-ENTER, DEEPEN, PLUGBACK, OR ADD A ZONE

¹ Operator Name and Address Amerada Hess Corporation		² OGRID Number 000495
P.O. Box 2040 HOUSTON, TEXAS 77252-2040		³ API Number 30-025-35603
⁴ Property Code 000135	⁵ Property Name NORTH MONUMENT GRAYBURG SAN ANDRES UNIT BLK 11, NO 32	⁶ Well No. 322

⁷Surface Location

UL or lot no.	Section	Township	Range	Lot. Idn	Feet from the	North/South Line	Feet from the	East/West line	County
P	29	19 S	37 E		180	SOUTH	1173	EAST	LEA

⁸Proposed Bottom Hole Location If Different From Surface

UL or lot no.	Section	Township	Range	Lot. Idn	Feet from the	North/South Line	Feet from the	East/West line	County

⁹Proposed Pool 1

EDNICE-MONUMENT/GRAYBURG-SAN ANDRES

¹⁰Proposed Pool 2

¹¹ Work Type Code N	¹² Well Type Code O	¹³ Cable/Rotary R	¹⁴ Lease Type Code P	¹⁵ Ground Level Elevation 3591'
¹⁶ Multiple NO	¹⁷ Proposed Depth 4000'	¹⁸ Formation GRAYBURG-S. ANDRES	¹⁹ Contractor PATTERSON	²⁰ Spud Date 10/01/01

²¹Proposed Casing and Cement Program

Hole Size	Casing Size	Casing weight/foot	Setting Depth	Sacks of Cement	Estimated TOC
11"	8-5/8"	24#	1200'	475	SURFACE
7-7/8"	5-1/2"	15.5#	4000'	750	SURFACE

²² Describe the proposed program. If this application is to DEEPEN or PLUG BACK, give the data on the present productive zone and proposed new productive zone. Describe the blowout prevention program, if any. Use additional sheets if necessary.

- 1. DRILL AN 11" HOLE TO 1200' AND SET 1200' OF 24# 8-5/8" SURFACE CASING. CEMENT WITH 475 SK OF 65/35 POZ AND CIRCULATE TO SURFACE.**
- 2. DRILL AN 7-7/8" HOLE TO 4000' AND SET 4000' OF 15.5# 5-1/2" PRODUCTION CASING. CEMENT WITH 750 SK OF CLASS "C" AND CIRCULATE TO SURFACE.**

Permit Expires 1 Year From Approval
Date Unless Drilling Underway

²³ I hereby certify that the information given above is true and complete to the best of my knowledge and belief.

Signature: *Ann Williams*

Printed name: **ANN WILLIAMS**

Title: **SR. STAFF ASSOCIATE**

Date: **06/14/01**

Phone: **713-609-4838**

OIL CONSERVATION DIVISION

Approved by:

Paul Kautz
Geologist

Title:

Approval Date: **2001**

Expiration Date:

Conditions of Approval:

Attached ☐

SCA

8 mg

DISTRICT I
1625 N. French Dr., Hobbs, NM 88240

DISTRICT II
811 South First, Artesia, NM 88210

DISTRICT III
1000 Rio Brazos Rd., Artec, NM 87410

DISTRICT IV
2040 South Pacheco, Santa Fe, NM 87506

State of New Mexico
Energy, Minerals and Natural Resources Department

Form C-102
Revised March 17, 1999

Submit to Appropriate District Office
State Lease - 4 Copies
Fee Lease - 3 Copies

OIL CONSERVATION DIVISION

2040 South Pacheco
Santa Fe, New Mexico 87504-2088

☐ AMENDED REPORT

WELL LOCATION AND ACREAGE DEDICATION PLAT

API Number 30-025-35603	Pool Code 23000	Pool Name EUNICE-MONUMENT/GRAYBURG-SAN ANDRES
Property Code 000135	Property Name NMGSAU BLK 11, NO 32	Well Number 322
OGRID No. 000495	Operator Name AMERADA HESS CORPORATION	Elevation 3591

Surface Location

UL or lot No.	Section	Township	Range	Lot Idn	Feet from the	North/South line	Feet from the	East/West line	County
P	29	19 S	37 E		180'	SOUTH	1173'	EAST	LEA

Bottom Hole Location If Different From Surface

UL or lot No.	Section	Township	Range	Lot Idn	Feet from the	North/South line	Feet from the	East/West line	County

Dedicated Acres 40	Joint or Infill Y	Consolidation Code U	Order No. UNITIZATION ORDER #R-1994 - WF ORDER #R-9596
------------------------------	-----------------------------	--------------------------------	--

**NO ALLOWABLE WILL BE ASSIGNED TO THIS COMPLETION UNTIL ALL INTERESTS HAVE BEEN CONSOLIDATED
OR A NON-STANDARD UNIT HAS BEEN APPROVED BY THE DIVISION**

	<p>OPERATOR CERTIFICATION</p> <p>I hereby certify the the information contained herein is true and complete to the best of my knowledge and belief.</p> <p><i>Ann Williams</i> Signature</p> <p>ANN WILLIAMS Printed Name</p> <p>SR. STAFF ASSOCIATE Title</p> <p>06/14/01 Date</p>	
	<p>SURVEYOR CERTIFICATION</p> <p>I hereby certify that the well location shown on this plat was plotted from field notes of actual surveys made by me or under my supervision, and that the same is true and correct to the best of my belief.</p> <p>MAY 11, 2001 Date Surveyed</p> <p><i>Gary L. Jones</i> Signature of Surveyor</p> <p>GARY L. JONES Professional Surveyor</p> <p>NEW MEXICO Professional Surveyor</p> <p>7977 No. 1274</p> <p>Certificate of Survey Professional Land Surveyor 7977</p>	
	<p>Lat.: N32°37'28.5"</p> <p>Long.: W103°16'07.9"</p>	
	<p>180' 1173'</p>	

SECTION 29, TOWNSHIP 19 SOUTH, RANGE 37 EAST, N.M.P.M.,
LEA COUNTY, NEW MEXICO.

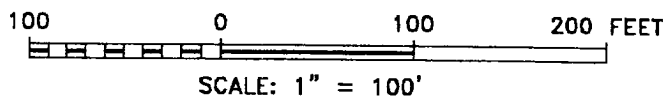
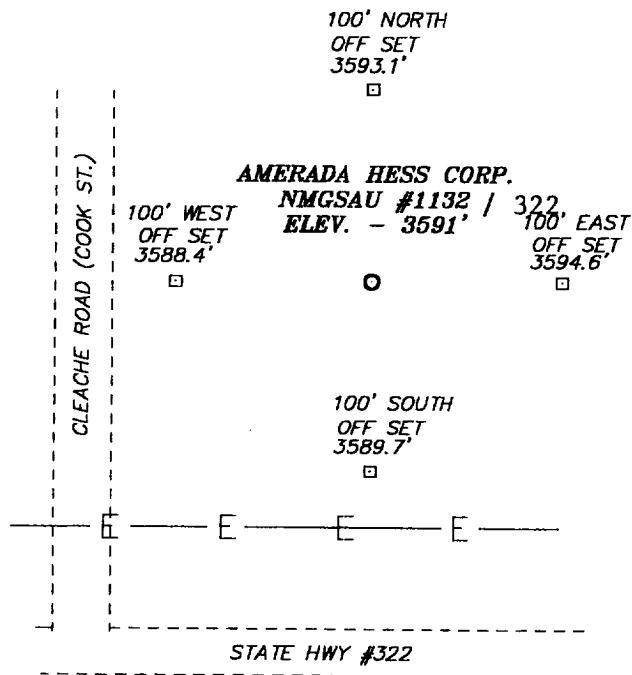

AMERADA HESS CORPORATION

REF: NMGSAU #1132 / Well Pad Topo

NMGSAU #1132 LOCATED 180' FROM THE
SOUTH LINE AND 1173' FROM THE EAST LINE OF
SECTION 29, TOWNSHIP 19 SOUTH, RANGE 37 EAST,
N.M.P.M., LEA COUNTY, NEW MEXICO.

BASIN SURVEYS P.O. BOX 1786 - HOBBS, NEW MEXICO

W.O. Number: 1274

Drawn By: **JAMES PRESLEY**

Date: 05/11/01

Disk: JLP #1 - 1274A

Survey Date: 05/11/01

Sheet 1 of 1 Sheets

3000# B.O.P. STACK

