

District I
1625 N. French Dr., Hobbs, NM 88240

District II
1301 W Grand Avenue, Artesia, NM 88210

District III
1000 Rio Brazos Rd., Aztec, NM 87410

District IV
1220 S. St. Francis Dr., Santa Fe, NM 87504

State of New Mexico
Energy, Minerals & Natural Resources

Oil Conservation Division
1220 South St. Francis Dr.
Santa Fe, NM 87504

Form C-104
Revised July 28, 2000

Submit to Appropriate District Office
5 Copies

☐ AMENDED REPORT

I. REQUEST FOR ALLOWABLE AND AUTHORIZATION TO TRANSPORT

¹ Operator name and Address Matador Operating Company 310 W. Wall, Suite 906 Midland, TX 79701		² OGRID Number 014245
⁴ API Number 30 - 025 - 35838		³ Reason for Filing Code/ Effective Date RT 500 bbls, effec 8/15/02
⁵ Pool Name Monument; Tubb	⁶ Pool Code 47090	
⁷ Property Code 27971	⁸ Property Name Shelley 35 State	⁹ Well Number 4

II. ¹⁰ Surface Location

UL or lot no. G	Section 35	Township 19S	Range 3E	Lot.Idn	Feet from the 2310	North/South Line North	Feet from the 2310	East/West line East	County Lea
---------------------------	----------------------	------------------------	--------------------	---------	------------------------------	----------------------------------	------------------------------	-------------------------------	----------------------

¹¹ Bottom Hole Location

UL or lot no.	Section	Township	Range	Lot Idn	Feet from the	North/South line	Feet from the	East/West line	County
5	P								
¹² Lse Code	¹³ Producing Method	¹⁴ Gas Connection Date	¹⁵ C-129 Permit Number	¹⁶ C-129 Effective Date	¹⁷ C-129 Expiration Date				

III. Oil and Gas Transporters

¹⁸ Transporter OGRID	¹⁹ Transporter Name and Address	²⁰ POD	²¹ O/G	²² POD ULSTR Location and Description
021778	Sunoco, Inc. (R&M) P O Box 2039 Tulsa, OK 74102-2039	2832633	O	

IV. Produced Water

²³ POD	²⁴ POD ULSTR Location and Description
-------------------	--

V. Well Completion Data

²⁵ Spud Date 5/30/02	²⁶ Ready Date 7/17/02	²⁷ TD 7180	²⁸ PBTD 7132	²⁹ Perforations 6705-08, 6764-67, 6804-2 CIBP @6985 7010-7025	³⁰ DHC, MC
³¹ Hole Size 12 1/4	³² Casing & Tubing Size 8 5/8	³³ Depth Set 1410	³⁴ Sacks Cement 640 sx Class C		
7 7/8	4 1/2	7180	725 sx Super H, 500 sx Inferfill C & 100 sx Class C		
	2 3/8 tbg	6619			

VI. Well Test Data

³⁵ Date New Oil	³⁶ Gas Delivery Date	³⁷ Test Date	³⁸ Test Length 24	³⁹ Tbg. Pressure	⁴⁰ Csg. Pressure
⁴¹ Choke Size	⁴² Oil	⁴³ Water	⁴⁴ Gas	⁴⁵ AOF	⁴⁶ Test Method

⁴⁷ I hereby certify that the rules of the Oil Conservation Division have been complied with and that the information given above is true and complete to the best of my knowledge and belief.
Signature: *Diane Kuykendall*

Printed name: **Diane Kuykendall**

Title: **Production Analyst**

Date: **08/15/02**

Phone: **915-687-5955**

OIL CONSERVATION DIVISION

Approved by:

Title:

Approval Date:

AUG 22 2002

**ORIGINAL SIGNED BY
PAUL F. KAUTZ
PETROLEUM ENGINEER**

DISTRICT I
P. O. Box 1980
Hobbs, NM 88241-1980

DISTRICT II
P. O. Drawer DD
Artesia, NM 88211-0719

DISTRICT III
1000 Rio Brazos Rd.
Aztec, NM 87410

DISTRICT IV
P. O. Box 2088
Santa Fe, NM 87507-2088

State of New Mexico
Energy, Minerals, and Natural Resources Department

Form C-102
Revised 02-10-94

Instructions on back

Submit to the Appropriate
District Office
State Lease - 4 copies
Fee Lease - 3 copies

OIL CONSERVATION DIVISION

P. O. Box 2088
Santa Fe, New Mexico 87504-2088

☒ AMENDED REPORT

WELL LOCATION AND ACREAGE DEDICATION PLAT

1 API Number 30-025-35838	2 Pool Code 47090	3 Pool Name Monument; Tubb
4 Property Code 27971	5 Property Name SHELLEY '35' STATE	6 Well Number 4
7 OGRID No. 14245	8 Operator Name MATADOR OPERATING COMPANY	9 Elevation 3592'

10 SURFACE LOCATION

UL or lot no. G	Section 35	Township 19 SOUTH	Range 37 EAST, N.M.P.M.	Lot Ida	Feet from the 2310'	North/South line NORTH	Feet from the 2310'	East/West line EAST	County LEA
--------------------	---------------	----------------------	----------------------------	---------	------------------------	---------------------------	------------------------	------------------------	---------------

11 BOTTOM HOLE LOCATION IF DIFFERENT FROM SURFACE

UL or lot no.	Section	Township	Range	Lot Ida	Feet from the	North/South line	Feet from the	East/West line	County
---------------	---------	----------	-------	---------	---------------	------------------	---------------	----------------	--------

12 Dedicated Acres 80	13 Joint or Infill	14 Consolidation Code	15 Order No.
--------------------------	--------------------	-----------------------	--------------

NO ALLOWABLE WELL BE ASSIGNED TO THIS COMPLETION UNTIL ALL INTERESTS HAVE BEEN
CONSOLIDATED OR A NON-STANDARD UNIT HAS BEEN APPROVED BY THE DIVISION

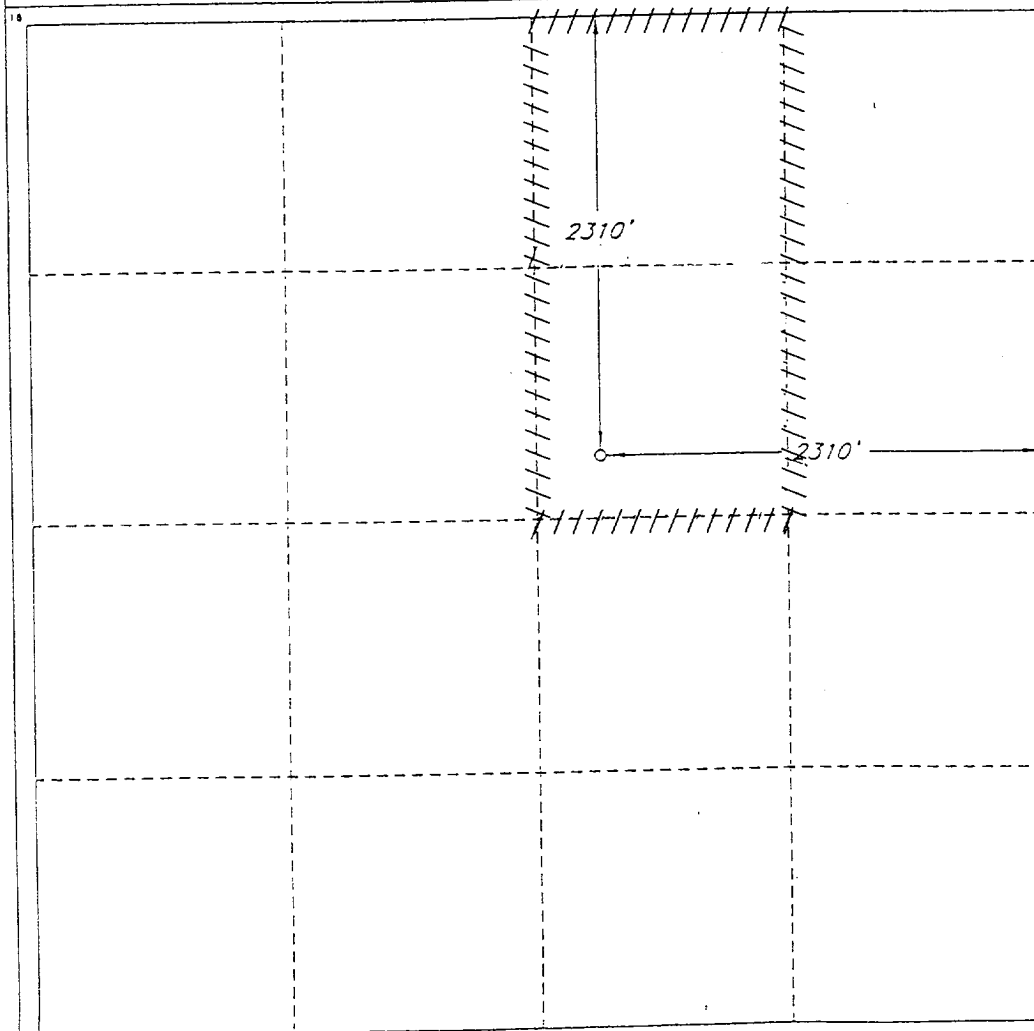

OPERATOR CERTIFICATION

I hereby certify that the information
contained herein is true and complete
to the best of my knowledge and belief.

Signature <i>[Signature]</i>
Printed Name Tim W. Wamer
Title Sr. Drilling Engineer
Date 1/11/02

SURVEYOR CERTIFICATION

I hereby certify that the well
location shown on this plat was
plotted from field notes of actual
surveys made by me or under
my supervision, and that the
same is true and correct to the
best of my belief.

Date of Survey JANUARY 31, 2002
Signature and Seal of Professional Surveyor <i>[Signature]</i> V. L. BEZNER
Certificate No. R.P.S. #7920
JOB #80249-70-SW / V.H.B.