

District I  
1625 N. French Dr., Hobbs, NM 88240  
District II  
1301 W. Grand Avenue, Artesia, NM 88210  
District III  
1000 Rio Brazos Road, Aztec, NM 87410  
District IV  
1220 S. St. Francis Dr., Santa Fe, NM 87505

State of New Mexico  
Energy Minerals and Natural Resources

Oil Conservation Division  
1220 South St. Francis Dr.  
Santa Fe, NM 87505

Form C-101  
Revised March 17, 1999

Submit to appropriate District Office  
State Lease - 6 Copies  
Fee Lease - 5 Copies

☐ AMENDED REPORT

**APPLICATION FOR PERMIT TO DRILL, RE-ENTER, DEEPEN, PLUGBACK, OR ADD A ZONE**

<sup>1</sup> Operator Name and Address Matador Operating Company 8340 Meadow Road #150 Dallas, TX 75231		<sup>2</sup> OGRID Number 14245
		<sup>3</sup> API Number 30-025-35862
<sup>3</sup> Property Code 29242	<sup>5</sup> Property Name Laughlin "5"	<sup>6</sup> Well No. 2

**<sup>7</sup> Surface Location**

UL or lot no.	Section	Township	Range	Lot Idn	Feet from the	North/South line	Feet from the	East/West line	County
J	5	20S	37E		1820	South	1650	East	Lea

**<sup>8</sup> Proposed Bottom Hole Location If Different From Surface**

UL or lot no.	Section	Township	Range	Lot Idn	Feet from the	North/South line	Feet from the	East/West line	County

<sup>9</sup> Proposed Pool 1 Monument; Drinkard	<sup>10</sup> Proposed Pool 2
--	-------------------------------

<sup>11</sup> Work Type Code N	<sup>12</sup> Well Type Code O	<sup>13</sup> Cable/Rotary Rotary	<sup>14</sup> Lease Type Code P	<sup>15</sup> Ground Level Elevation 3557'
<sup>16</sup> Multiple No	<sup>17</sup> Proposed Depth 6800'	<sup>18</sup> Formation Drinkard	<sup>19</sup> Contractor Patterson	<sup>20</sup> Spud Date March 20, 2002

**<sup>21</sup> Proposed Casing and Cement Program**

Hole Size	Casing Size	Casing weight/foot	Setting Depth	Sacks of Cement	Estimated TOC
12-1/4"	8-5/8"	24#	1200'	450	surface
7-7/8"	4-1/2"	11.6#	6800'	750	2000'

<sup>22</sup> Describe the proposed program. If this application is to DEEPEN or PLUG BACK, give the data on the present productive zone and proposed new productive zone.  
Describe the blowout prevention program, if any. Use additional sheets if necessary.

Drill 12-1/4" hole to top of Anhydrite @ 1200'. Run and cement to surface 8-5/8" casing. Nipple up 11" 3M BOP assembly and test to 3000 psi. Drill 7-7/8" hole to 6800'. Evaluate to run production casing.

<sup>23</sup> I hereby certify that the information given above is true and complete to the best of my knowledge and belief.

Signature:

Printed name: Jim Kramer

Title: Sr. Drilling Engineer

Date: 3/13/02

Phone: 214 987-7128

**OIL CONSERVATION DIVISION**

Approved by:

Title:

Approval Date:

Conditions of Approval:

Attached ☐

APPROVAL SIGNED BY  
DAVID T. KAUFZ  
DISTRICT ENGINEER

Expiration Date:

Permit Expires 1 Year From Approval  
Date Unless Drilling Underway

DISTRICT I  
P. O. Box 1980  
Hobbs, NM 88241-1980

State of New Mexico  
Encl. Minerals, and Natural Resources Department

Form C-102  
Revised 02-10-94  
Instructions on back

DISTRICT II  
P. O. Drawer DD  
Artesia, NM 88211-0719

## OIL CONSERVATION DIVISION

P. O. Box 2088  
Santa Fe, New Mexico 87504-2088

Submit to the Appropriate  
District Office  
State Lease - 4 copies  
Fee Lease - 3 copies

☐ AMENDED REPORT

DISTRICT III  
1000 Rio Brazos Rd.  
Aztec, NM 87410

DISTRICT IV  
P. O. Box 2088  
Santa Fe, NM 87507-2088

### WELL LOCATION AND ACREAGE DEDICATION PLAT

1 API Number <b>30-025-35862</b>		2 Pool Code <b>97060</b>		3 Pool Name <b>Monument; Drinkard</b>	
4 Property Code <b>29242</b>		5 Property Name <b>LAUGHLIN '5'</b>			6 Well Number <b>2</b>
7 OGRID No. <b>14245</b>		8 Operator Name <b>MATADOR OPERATING COMPANY</b>			9 Elevation <b>3557'</b>

#### 10 SURFACE LOCATION

UL or lot no.	Section	Township	Range	Lot Ida	Feet from the	North/South line	Feet from the	East/West line	County
J	5	20 SOUTH	37 EAST, N.M.P.M.		1820'	SOUTH	1650'	EAST	LEA

#### 11 BOTTOM HOLE LOCATION IF DIFFERENT FROM SURFACE

UL or lot no.	Section	Township	Range	Lot Ida	Feet from the	North/South line	Feet from the	East/West line	County

12 Dedicated Acres <b>40</b>	13 Joint or Infill	14 Consolidation Code	15 Order No.
---------------------------------	--------------------	-----------------------	--------------

NO ALLOWABLE WELL BE ASSIGNED TO THIS COMPLETION UNTIL ALL INTERESTS HAVE BEEN CONSOLIDATED OR A NON-STANDARD UNIT HAS BEEN APPROVED BY THE DIVISION

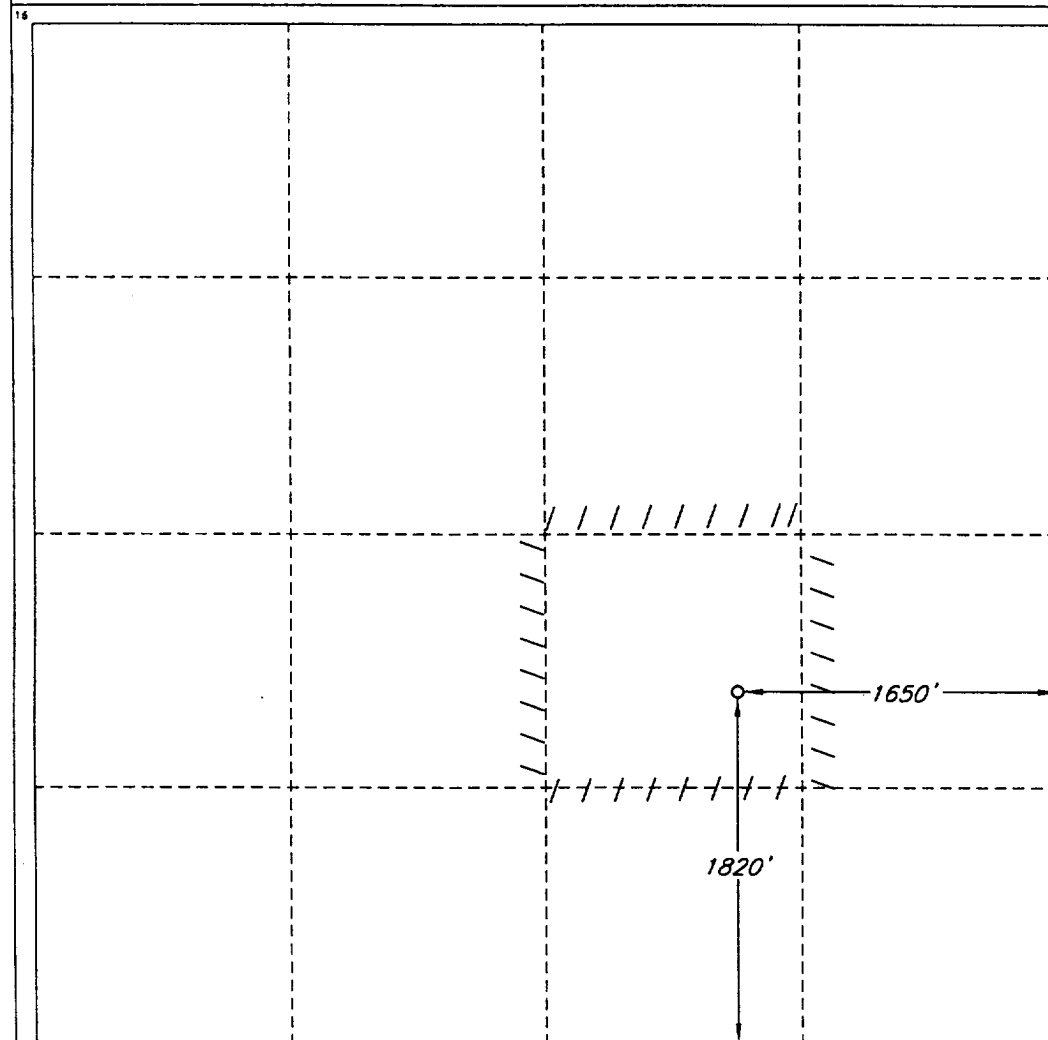

#### OPERATOR CERTIFICATION

I hereby certify that the information contained herein is true and complete to the best of my knowledge and belief.

Signature - *Jim Kramer*  
Printed Name  
**Jim Kramer**  
Title  
**Sr. Drilling Engineer**  
Date  
**3/13/02**

#### SURVEYOR CERTIFICATION

I hereby certify that the well location shown on this plat was plotted from field notes of actual surveys made by me or under my supervision, and that the same is true and correct to the best of my belief.

Date of Survey  
**AUGUST 15, 2000**

Signature and Seal of  
Professional Surveyor

Certificate No.  
**V. L. BEZNER R.P.S. #7920**

JOB #78028 / 71 SE / J.C.P.

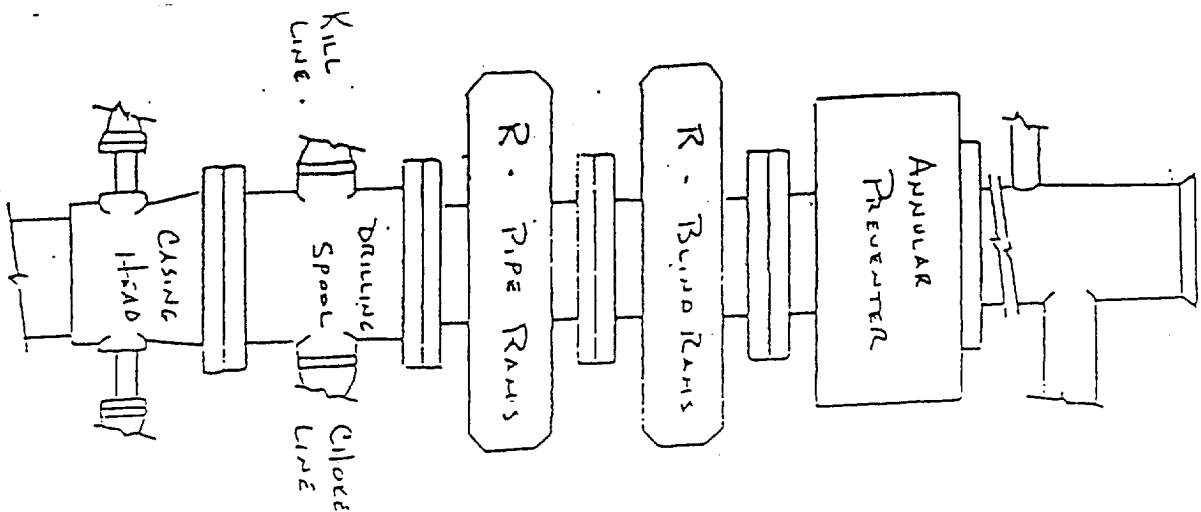

3000 Psi  
Working Pressure

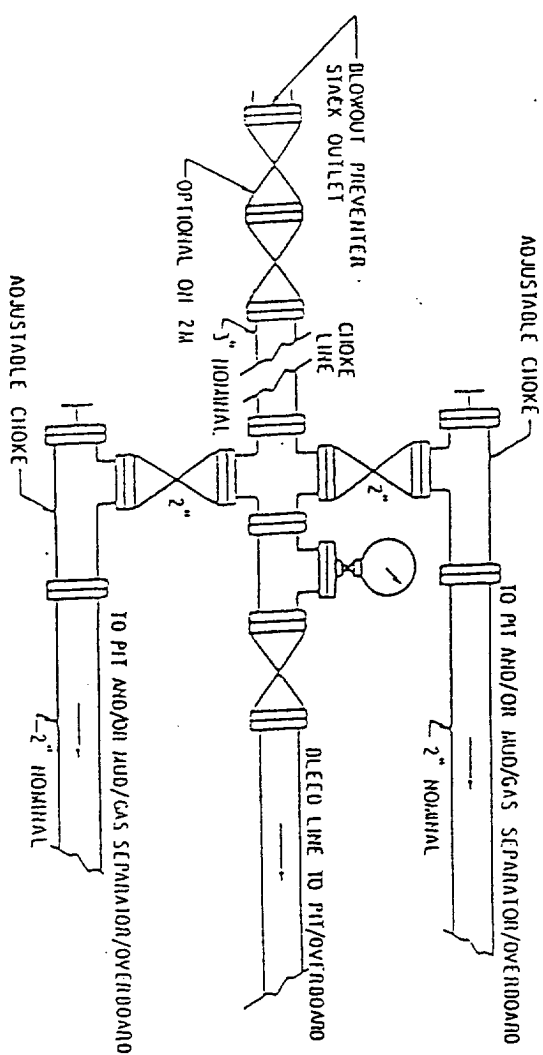

**BLOWOUT PREVENTER**  
**MATADOR OPERATING COMPANY**  
 LAUGHLIN "5" #2  
 1820' FSL & 1650' FEL  
 SEC. 5, T20S, R37E  
 LEA COUNTY, NEW MEXICO