

Lease No. 65215

NEW MEXICO OIL CONSERVATION COMMISSION

Santa Fe, New Mexico

Form C-101
Revised (12/1/55)

REVISED*

NOTICE OF INTENTION TO DRILL

Notice must be given to the District Office of the Oil Conservation Commission and approval obtained before drilling or recompletion begins. If changes in the proposed plan are considered advisable, a copy of this notice showing such changes will be returned to the sender. Submit this notice in QUINTUPLICATE. One copy will be returned following approval. See additional instructions in Rules and Regulations of the Commission. If State Land submit 6 Copies Attach Form C-128 in triplicate to first 3 copies of form C-101

Midland, Texas

(Place)

November 16, 1960

(Date)

OIL CONSERVATION COMMISSION
SANTA FE, NEW MEXICO(*Location moved 30' West. This supersedes
Form C-101 dated 11-10-60)

Gentlemen:

You are hereby notified that it is our intention to commence the Drilling of a well to be known as

TEXACO Inc.

(Company or Operator)

C. H. Weir "B"

(Lease)

Well No. 4

I

(Unit)

The well is

located 2044 feet from the South line and 660 feet from the

East

line of Section 11, T. -20-S, R. -37-E, NMPM.

(GIVE LOCATION FROM SECTION LINE) (Drinkard, Glorieta) oil Pool, Lea County

If State Land the Oil and Gas Lease is No.

If patented land the owner is C. H. Weir

Address Box 875, Hobbs, New Mexico

We propose to drill well with drilling equipment as follows: Rotary

The status of plugging bond is \$10,000 blanket surety bond of Maryland Casualty Co. has been filed with State Geologist.

Drilling Contractor Not known at present

We intend to complete this well in the (1) Penrose (2) Glorieta
(3) Drinkard

formation at an approximate depth of 6900 feet.

CASING PROGRAM

We propose to use the following strings of Casing and to cement them as indicated:

Size of Hole	Size of Casing	Weight per Foot	New or Second Hand	Depth	Sacks Cement
13-3/4"	10-3/4"	32.75 & 40.5#	New	1400'	800
9-7/8"	7-5/8"	24 & 26.4#	New	5475'	1100
6-3/4"	4-1/2" Liner	11.6#	New	6900'	300
	(5375' - 6900')				

If changes in the above plans become advisable we will notify you immediately.

ADDITIONAL INFORMATION (If recompletion give full details of proposed plan of work.)

FORMATIONS EXPECTED:

Top of Anhydrite	1385'	Top of Grayburg	3735'	Top of Drinkard	6745'
Top of Yates	2660'	Top of San Andres	4037'	Total Depth	6900'
Top of Queen	3482'	Top of Glorieta	5220'		
Top of Penrose	3610'	Top of Tubb	6300'		

CEMENT MUST BE CIRCULATED BEHIND

Approved: 19. Except as follows:

Sincerely yours, 10 3/4 CASING.

TEXACO Inc.

(Company or Operator)

By J. J. Veiten

Position Division Civil Engineer

Send Communications regarding well to

Name J. H. Markley

Address P. O. Box 3109

Midland, Texas

OIL CONSERVATION COMMISSION

NEW MEXICO OIL CONSERVATION COMMISSION
WELL LOCATION AND ACREAGE DEDICATION PLAT

FORM C-128
Revised 5/1/57

SEE INSTRUCTIONS FOR COMPLETING THIS FORM ON THE REVERSE SIDE

SECTION A

Operator TEXACO Inc.		Lease C. H. Weir "B"		Well No. 74*	
Unit Letter I	Section 11	Township 20 South	Range 37 East	County Lea	
Actual Footage Location of Well: 2044 feet from the South line and 660 feet from the East line Sec. 11					
Ground Level Elev. 3534	Producing Formation Drinkard	Pool Skaggs(Drinkard)Oil		Dedicated Acreage: 40 Acres	

* To be a triple with Eumont Gas & Skaggs(Glorieta)Oil

1. Is the Operator the only owner in the dedicated acreage outlined on the plat below? YES _____ NO X . ("Owner" means the person who has the right to drill into and to produce from any pool and to appropriate the production either for himself or for himself and another. (65-3-29 (e) NMSA 1935 Comp.)
2. If the answer to question one is "no," have the interests of all the owners been consolidated by communitization agreement or otherwise? YES X NO _____. If answer is "yes," Type of Consolidation Joint Operating Agreement
3. If the answer to question two is "no," list all the owners and their respective interests below:

Owner	Land Description

CERTIFICATION

I hereby certify that the information in SECTION A above is true and complete to the best of my knowledge and belief.

Name J. J. Velten
Position Division Civil Engineer
Company TEXACO Inc.
Date 11-10-60

I hereby certify that the well location shown on the plat in SECTION B was plotted from field notes of actual surveys made by me or under my supervision, and that the same is true and correct to the best of my knowledge and belief.

Date Surveyed 11-5-60
Registered Professional Engineer and/or Land Surveyor J. J. Velten
Certificate No. 8174

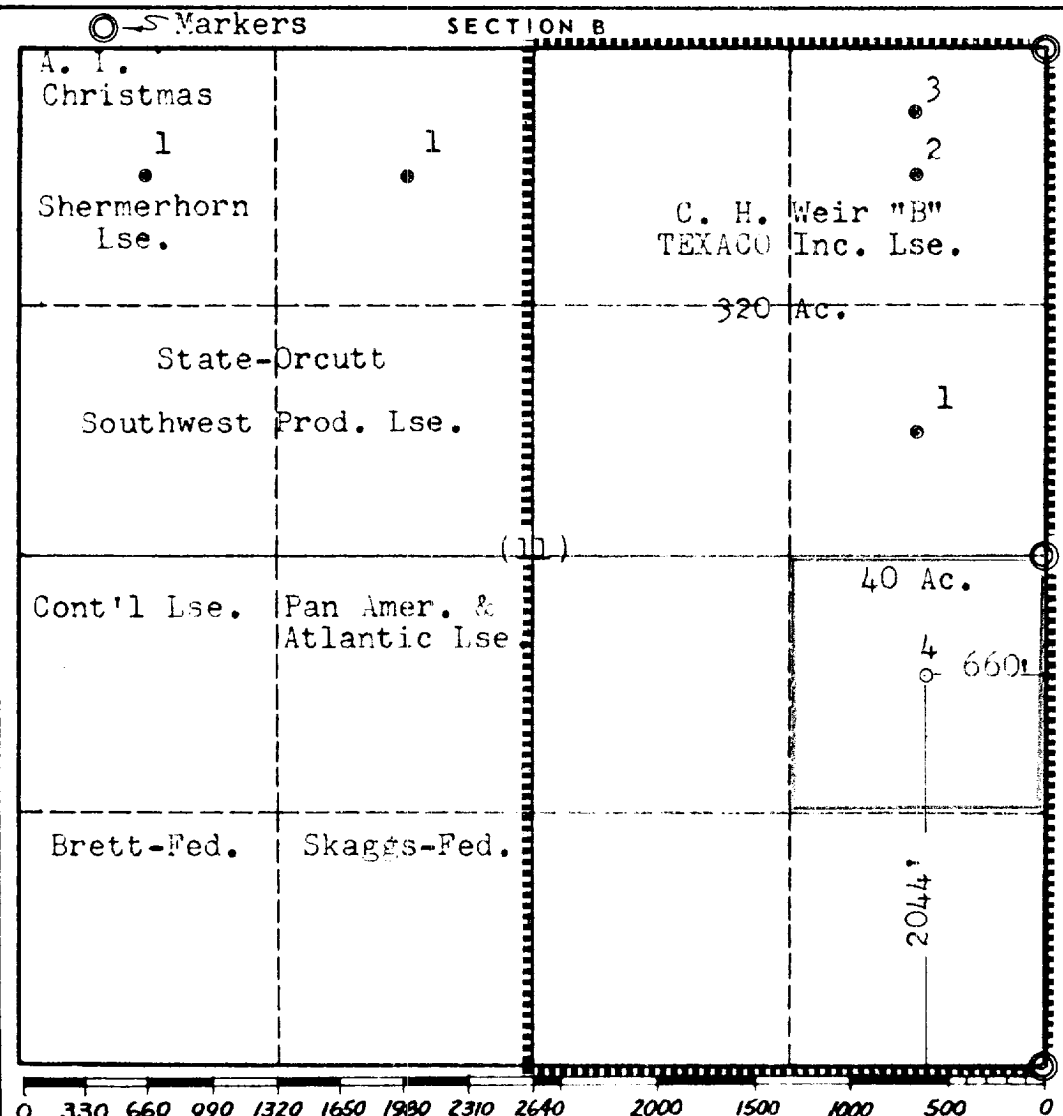

NEW MEXICO OIL CONSERVATION COMMISSION
WELL LOCATION AND ACREAGE DEDICATION PLAT

FORM C-128
Revised 5/1/57

SEE INSTRUCTIONS FOR COMPLETING THIS FORM ON THE REVERSE SIDE

SECTION A

Operator TEXACO Inc.		Lease C. H. Weir "B"		Well No. 4*
Unit Letter I	Section 11	Township 20 South	Range 37 East	County Lea
Actual Footage Location of Well: 2044 feet from the South line and 660 feet from the East line Sec. 11				
Ground Level Elev. 3534	Producing Formation Glorieta	Pool Skaggs(Glorieta) Oil	Dedicated Acreage: 40 Acres	

- * To be a triple with **Bumont Gas & Skaggs(Drinkard)Oil**
1. Is the Operator the only owner in the dedicated acreage outlined on the plat below? YES ☒ NO ☐ ("Owner" means the person who has the right to drill into and to produce from any pool and to appropriate the production either for himself or for himself and another. (65-3-29 (e) NMSA 1935 Comp.)
2. If the answer to question one is "no," have the interests of all the owners been consolidated by communitization agreement or otherwise? YES ☒ NO ☐ If answer is "yes," Type of Consolidation **Joint Operating Agreement**
3. If the answer to question two is "no," list all the owners and their respective interests below:

Owner	Land Description

Markers

SECTION B

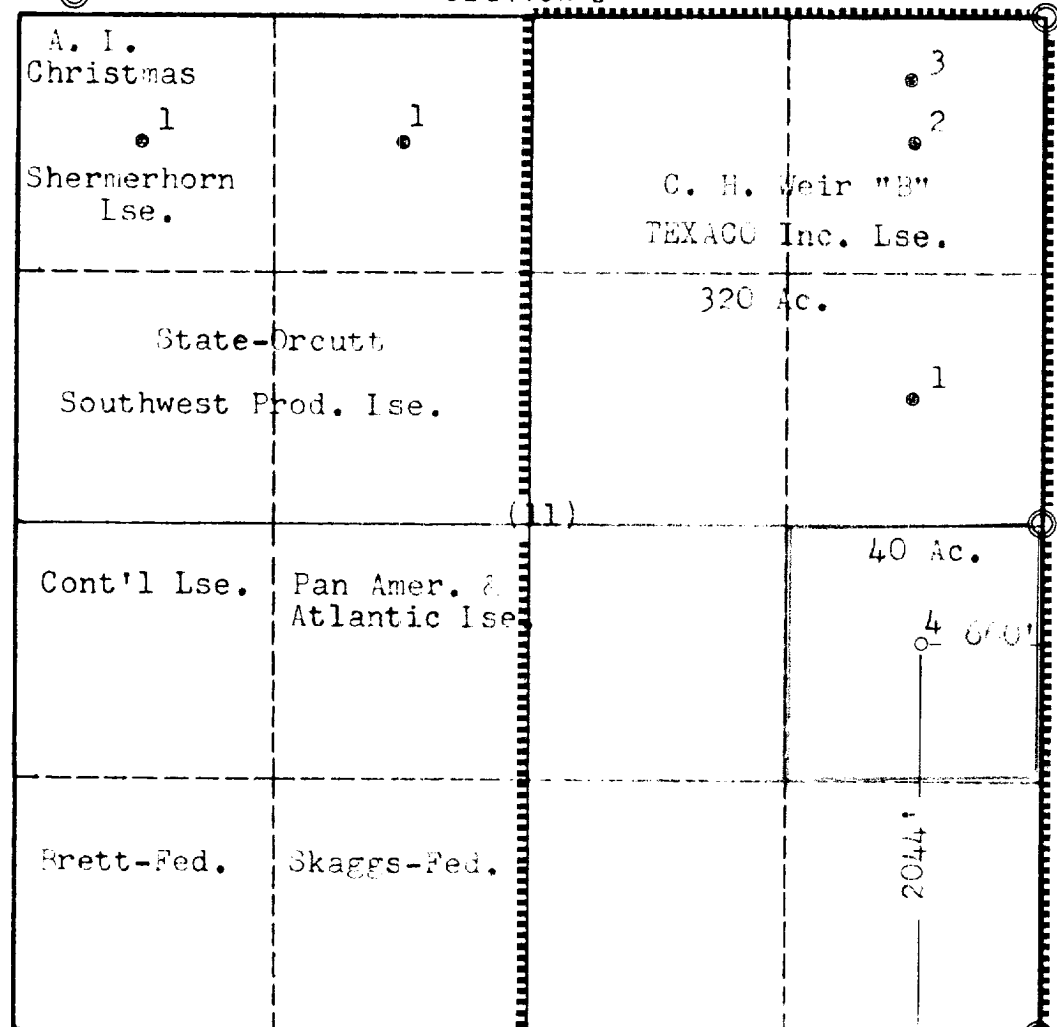

CERTIFICATION

I hereby certify that the information in SECTION A above is true and complete to the best of my knowledge and belief.

Name **J. J. Velten**
 Position **Division Civil Engineer**
 Company **TEXACO Inc.**
 Date **11-10-60**

I hereby certify that the well location shown on the plat in SECTION B was plotted from field notes of actual surveys made by me or under my supervision, and that the same is true and correct to the best of my knowledge and belief.

Date Surveyed **11-5-60**
 Registered Professional Engineer and/or Land Surveyor **J. J. Velten**
 Certificate No. **8174**

0 330 660 990 1320 1650 1980 2310 2640 2000 1500 1000 500 0

NEW MEXICO OIL CONSERVATION COMMISSION
WELL LOCATION AND ACREAGE DEDICATION PLAT

FORM C-128
Revised 5/1/57

SEE INSTRUCTIONS FOR COMPLETING THIS FORM ON THE REVERSE SIDE

SECTION A

Operator TEXACO Inc.		Lease C. H. Weir "B"		Well No. 1742
Unit Letter I	Section 11	Township 20 South	Range 37 East	County Lea
Actual Footage Location of Well: 2044 feet from the South line and 660 feet from the East line Sec. 11				
Ground Level Elev. 3534	Producing Formation Penrose	Pool Eumont Gas	Dedicated Acreage: 320 Acres	

- * To be a triple with Skaggs (Drinkard & Glorieta) oil
1. Is the Operator the only owner in the dedicated acreage outlined on the plat below? YES _____ NO X . ("Owner" means the person who has the right to drill into and to produce from any pool and to appropriate the production either for himself or for himself and another. (65-3-29 (e) NMSA 1935 Comp.)
 2. If the answer to question one is "no," have the interests of all the owners been consolidated by communitization agreement or otherwise? YES X NO _____. If answer is "yes," Type of Consolidation Joint Operating Agreement
 3. If the answer to question two is "no," list all the owners and their respective interests below:

Owner	Land Description

⊙ Markers

SECTION B

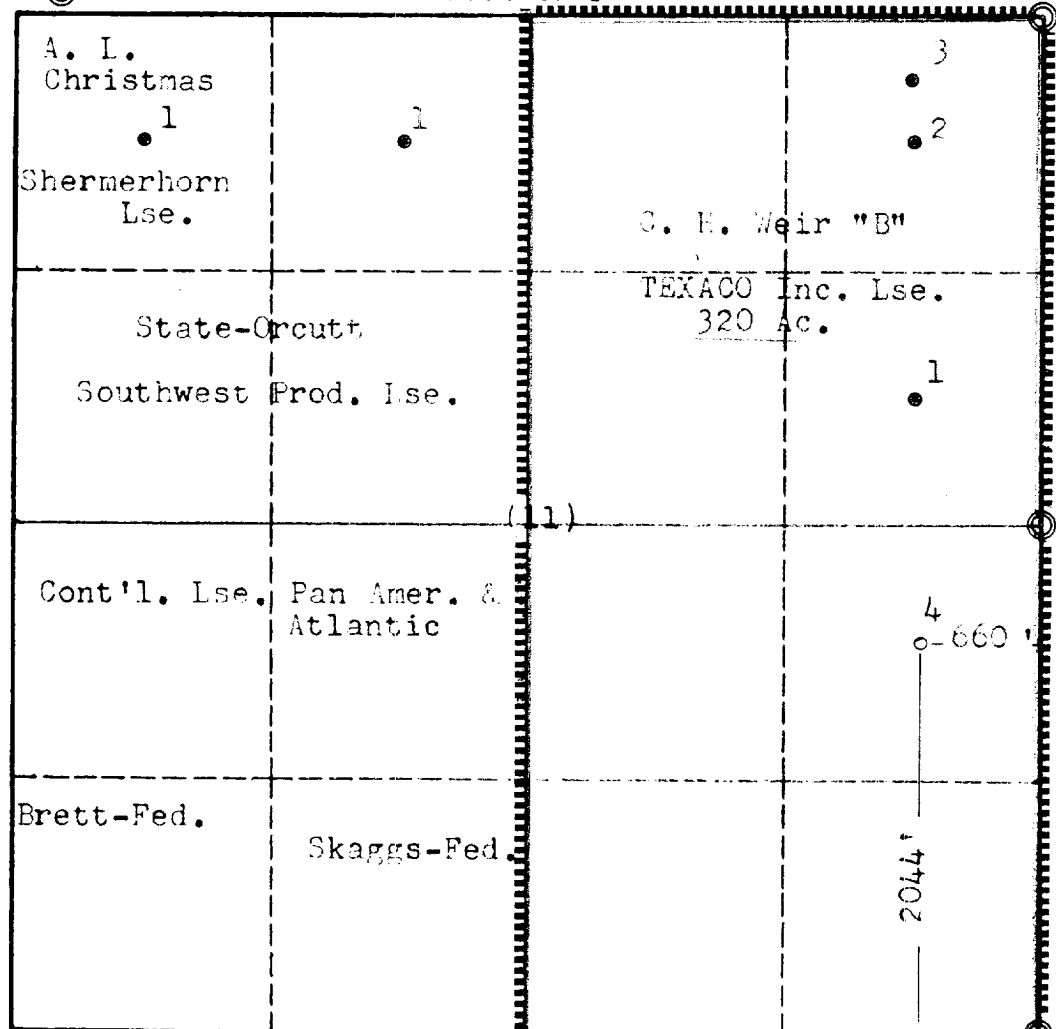

CERTIFICATION

I hereby certify that the information in SECTION A above is true and complete to the best of my knowledge and belief.

Name J. J. Velten
 Position Division Civil Engineer
 Company TEXACO Inc.
 Date 11-10-60

I hereby certify that the well location shown on the plat in SECTION B was plotted from field notes of actual surveys made by me or under my supervision, and that the same is true and correct to the best of my knowledge and belief.

Date Surveyed 11-5-60
 Registered Professional Engineer and/or Land Surveyor J. J. Velten
 Certificate No. 8174