

STATE OF NEW MEXICO  
ENERGY AND MINERALS DEPARTMENT

OIL CONSERVATION DIVISION

Form C-101  
Revised 10-1-78

NO. OF COPIES RECEIVED	
DISTRIBUTION	
SANTA FE	
FILE	
U.S.G.S.	
LAND OFFICE	
OPERATOR	

P. O. BOX 2088  
SANTA FE, NEW MEXICO 87501

5A. Indicate Type of Lease  
STATE ☐ FEE ☒  
5. State Oil & Gas Lease No.

APPLICATION FOR PERMIT TO DRILL, DEEPEN, OR PLUG BACK

1a. Type of Work DRILL <input type="checkbox"/> DEEPEN <input type="checkbox"/> PLUG BACK <input checked="" type="checkbox"/>		7. Unit Agreement Name
b. Type of Well OIL WELL <input checked="" type="checkbox"/> GAS WELL <input type="checkbox"/> OTHER <input type="checkbox"/> SINGLE ZONE <input checked="" type="checkbox"/> MULTIPLE ZONE <input type="checkbox"/>		8. Farm or Lease Name C. H. Weir "A"
2. Name of Operator Texaco Inc.		9. Well No. 8
3. Address of Operator P. O. Box 3109, Midland, Texas 79702		10. Field and Pool, or Wildcat Skaggs Drinkard
4. Location of Well UNIT LETTER <u>F</u> LOCATED <u>1985</u> FEET FROM THE <u>North</u> LINE AND <u>1980</u> FEET FROM THE <u>West</u> LINE OF SEC. <u>12</u> TWP. <u>20-S</u> RGE. <u>37-E</u> NMPM		12. County Lea
19. Proposed Depth 6843' PB		19A. Formation Drinkard
20. Rotary or C.T. Rotary		
21. Elevations (show whether DE, KT, etc.) 3562' GR	21A. Kind & Status Plug. Bond -	21B. Drilling Contractor -
		22. Approx. Date Work will start June 15, 1984

23.

PROPOSED CASING AND CEMENT PROGRAM

SIZE OF HOLE	SIZE OF CASING	WEIGHT PER FOOT	SETTING DEPTH	SACKS OF CEMENT	EST. TOP
12 1/4"	9 5/8"	32.3	1439'	700	Circulate
8 3/4"	2 7/8"	6.4	5416' (Blinbry)	1800	Circulate
8 3/4"	2 7/8"	6.4	6882' (Tubb)	-	-
8 3/4"	2 7/8"	6.4	6883' (Drinkard)	-	-

REFER TO ATTACHMENT FOR WORKOVER PROGRAM

IN ABOVE SPACE DESCRIBE PROPOSED PROGRAM: IF PROPOSAL IS TO DEEPEN OR PLUG BACK, GIVE DATA ON PRESENT PRODUCTIVE ZONE AND PROPOSED NEW PRODUCTIVE ZONE. GIVE SLOWOUT PREVENTER PROGRAM, IF ANY.

I hereby certify that the information above is true and complete to the best of my knowledge and belief.

Signed R. E. Sexton Title Engineer's Assistant Date 6-6-84

(This space for State Use)  
**Eddie W. Seay**

**Oil & Gas Inspector**

APPROVED BY \_\_\_\_\_ TITLE \_\_\_\_\_ DATE \_\_\_\_\_

CONDITIONS OF APPROVAL, IF ANY:

JUN 11 1984

RECEIVED

JUN 8 1984

O.C.D.  
HOBBY OFFICE



C. H. WEIR "A" WELL NO. 8

Workover program attached to C-101 dated 6-6-84.

1. Move in, rig up, Install BOP on Tubb string: Pull and lay down pkr. & 1 1/2" tbg.
2. GBIH w/bit & 1 5/8" drill pipe:  $\phi$  cmt and CIBP @ 6790' C.O. to 6844' P.O.H.
3. Rig up on Blinebry string: GIH and retrieve RBP'S @ 5889' & 6013' P.O.H.
4. GBI Blinebry string w/bit & 1 5/8" drill pipe C.O. to 6844' P.O.H.: GBIH & set RBP @ 6000' cap w/sand P.O.H.
5. Rig up full lube on Tubb string: GIH w/1 9/16" Perforating gun: Shoot Drinkard Perfs 2JSPI @ 6672, 89, 95, 6703, 20, 47, 52, 58, 82 (9 intervals: 18 holes) P.O.H.
6. Test 2 1/16" tbg & Pkr into Tubb string to 5500 psi: set Pkr @ 6650'. Prep to acidize Drinkard Perfs.
7. Acidize Drinkard Perfs. 6672' - 6843' w/10,000 gals 28% LST NE-FE Acid & 9000 gals of gelled 2% KCl water in three stages according to the following procedure: Expected max press of 4500 psi @ 5 BPM.
  - A. Pmp 3000 gals of gelled H<sub>2</sub>O pad.
  - B. Pmp 3000 gals of acid.
  - C. Flush w/1100 gals of 2% KCl H<sub>2</sub>O adding 250 lbs of Rocksalt block to the last 10 bbls of flush.
  - D. Pmp 500 gals of acid.
  - E. Repeat A-D one adjusting block as necessary.
  - F. Repeat A & B.
  - G. Flush w/1100 gals of 2% KCl H<sub>2</sub>O then overflush w/an additional 500 gal of 2% KCl H<sub>2</sub>O.
  - H. S.I. 2 hr. then flow back and Test.
8. Release Pkr: P.O.H. GBIH w/workstring, Pkr. & RBP set RBP @ 6650' cap w/sand: Pull up & set Pkr. @ 6300' Prep to Acidize Tubb Perfs.

RECEIVED

JUN 8 1984

O.C.D.  
HOBBS OFFICE

9. Acidize Tubb perfs 6370' - 6625' w/ 9,000 gals of 15% LST NE-FE acid in three stages according to the following procedure: Expected max press of 4500 psi @ 5 BPM
  - A. Pmp 3000 gals of acid.
  - B. Flush to bottom perf w/2% KCl H<sub>2</sub>O adding 300 lbs of rock salt block to the last 10 bbls of flush.
  - C. Repeat A & B once adjusting block as necessary.
  - D. Repeat A.
  - E. Flush to bottom perf. w/2% KCl H<sub>2</sub>O.
  - F. S.I. 1 hour: Flow back and test.
10. Release Pkr: Run down & Retrieve RBP @ 6650': Pull up: Set RBP @ 6300' cap w/sand P.O.H.
11. GBI Tubb string w/RBP: set RBP @ 5700' cap w/sand P.O.H.
12. Rig up on Blinebry string: GIH w/workstring & Pkr: set Pkr @ 5700': Prep to acidize Blinebry Perfs.
13. Acidize Blinebry perforations 5763' - 5877' w/7500 gals of 15% LST NE-FE acid in 3 stages according to the following procedure: Expected max. press. of 4500 psi @ 5BPM.
  - A. Prep 2500 gals of acid.
  - B. Flush to bottom perf w/2% KCl H<sub>2</sub>O adding 250 lbs of rock salt block to the last 10 bbls of Flush.
  - C. Repeat A & B once adjusting block as necessary.
  - D. Repeat A.
  - E. Flush to bottom perf w/2% KCl H<sub>2</sub>O.
  - F. S.I. 1 hour: Flow back and test.
14. Release Pkr: Run down and retrieve RBP @ 6000' P.O.H. T.I.H. w/bit to 6840'.

RECEIVED

JUN 8 1984

O.C.D.  
HOBBS OFFICE

15. Rig up on Tubb string GIH & retrieve RBP's @ 5700' & 6300' P.O.H.
16. Run 2 1/16" Production tbg in Blinebry string, Land @ 6840' Note: Use the 5852' of 2 1/16" tbg. currently in the Tubb string.
17. Run Pump & tapered rod string: Install Pumping Unit & Place on production as a Blinebry, Tubb, Drinkerd triple downhole commingle.



**NEW MEXICO OIL CONSERVATION COMMISSION  
WELL LOCATION AND ACREAGE DEDICATION PLAT**

Form C-102  
Supersedes C-128  
Effective 1-1-65

All distances must be from the outer boundaries of the Section.

Operator <b>TEXACO Inc.</b>			Lease <b>C. H. Weir "A"</b>		Well No. <b>8</b>
Unit Letter <b>F</b>	Section <b>12</b>	Township <b>20 South</b>	Range <b>37 East</b>	County <b>Lea</b>	
Actual Footage Location of Well: <b>1985</b> feet from the <b>North</b> line and <b>1980</b> feet from the <b>West</b> line <b>Sec. 12</b>					
Ground Level Elev. <b>3562'</b>	Producing Formation <b>Drinkard</b>	Pool <b>Skaggs Drinkard</b>		Dedicated Acreage: <b>40</b> Acres	

1. Outline the acreage dedicated to the subject well by colored pencil or hachure marks on the plat below.
2. If more than one lease is dedicated to the well, outline each and identify the ownership thereof (both as to working interest and royalty).
3. If more than one lease of different ownership is dedicated to the well, have the interests of all owners been consolidated by communitization, unitization, force-pooling, etc?

☒ Yes    ☐ No    If answer is "yes," type of consolidation Operating Agreement

If answer is "no," list the owners and tract descriptions which have actually been consolidated. (Use reverse side of this form if necessary.) \_\_\_\_\_

No allowable will be assigned to the well until all interests have been consolidated (by communitization, unitization, forced-pooling, or otherwise) or until a non-standard unit, eliminating such interests, has been approved by the Commission.

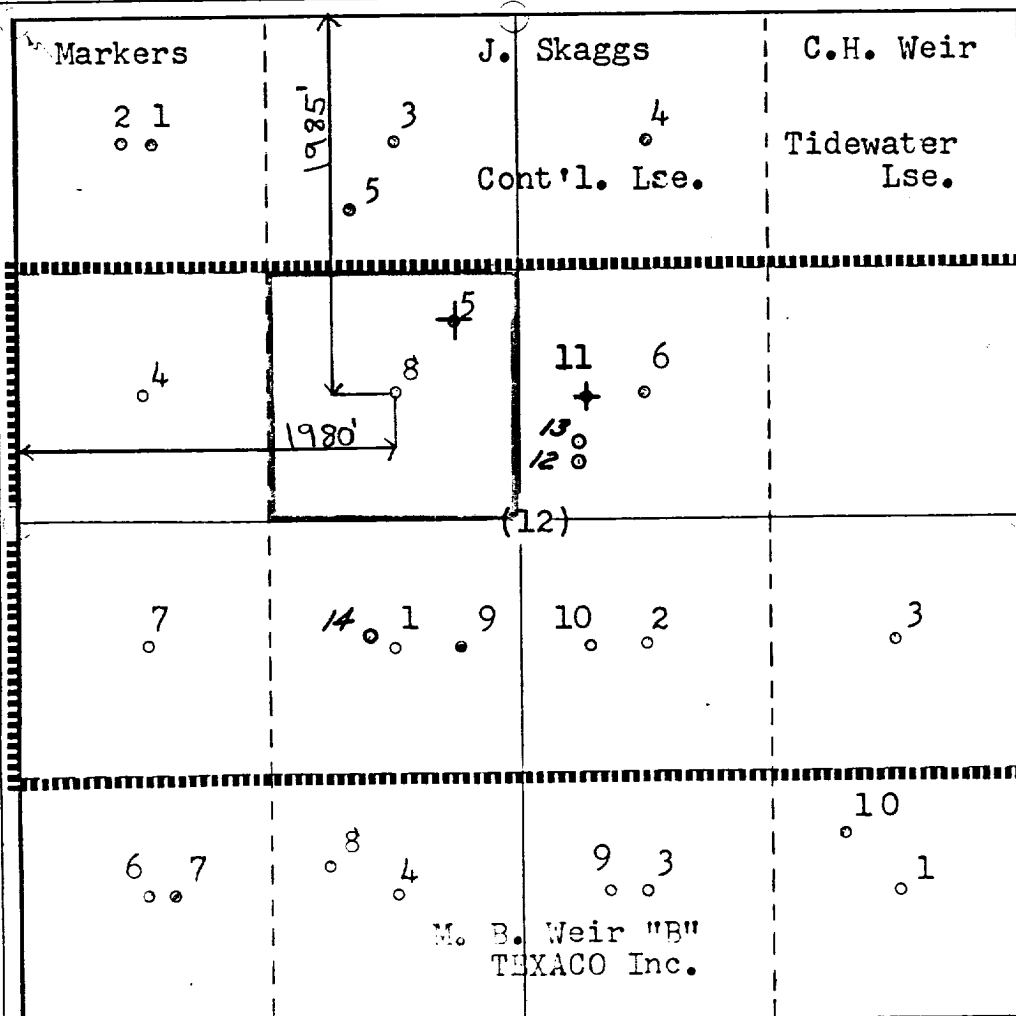

**CERTIFICATION**

I hereby certify that the information contained herein is true and complete to the best of my knowledge and belief.

*B. L. Eiland*

Name

**B. L. Eiland**

Position

**Division Surveyor**

Company

**Texaco Inc.**

Date

**May 25, 1984**

I hereby certify that the well location shown on this plat was plotted from field notes of actual surveys made by me or under my supervision, and that the same is true and correct to the best of my knowledge and belief.

Date Surveyed

Registered Professional Engineer  
and/or Land Surveyor

Certificate No.

0 330 660 990 1320 1650 1980 2310 2640 2970 3300 3630 3960 4290 4620 4950 5280 5610 5940 6270 6600