

**NEW MEXICO OIL CONSERVATION COMMISSION**  
**WELL LOCATION AND ACREAGE DEDICATION PLAT**

FORM C-125  
 Revised 5/1/57

SEE INSTRUCTIONS FOR COMPLETING THIS FORM ON THE REVERSE SIDE

**SECTION A**

Operator <b>Continental Oil Company</b>			Lease <b>Britt B.</b>		Well No. <b>10</b>
Unit Letter <b>F</b>	Section <b>15</b>	Township <b>20 South</b>	Range <b>37 East</b>	County <b>Lea</b>	
Actual Footage Location of Well: <b>1980</b> feet from the <b>North</b> line and <b>1980</b> feet from the <b>West</b> line					
Ground Level Elev.	Producing Formation <b>Tubb</b>		Pool <b>Monument Tubb</b>		Dedicated Acreage: <b>80</b> Acres

1. Is the Operator the only owner in the dedicated acreage outlined on the plat below? YES  NO  . ("Owner" means the person who has the right to drill into and to produce from any pool and to appropriate the production either for himself or for himself and another. (65-3-29 (e) NMSA 1935 Comp.)
2. If the answer to question one is "no," have the interests of all the owners been consolidated by communitization agreement or otherwise? YES  NO  . If answer is "yes," Type of Consolidation \_\_\_\_\_
3. If the answer to question two is "no," list all the owners and their respective interests below:

Owner	Land Description

**SECTION B**

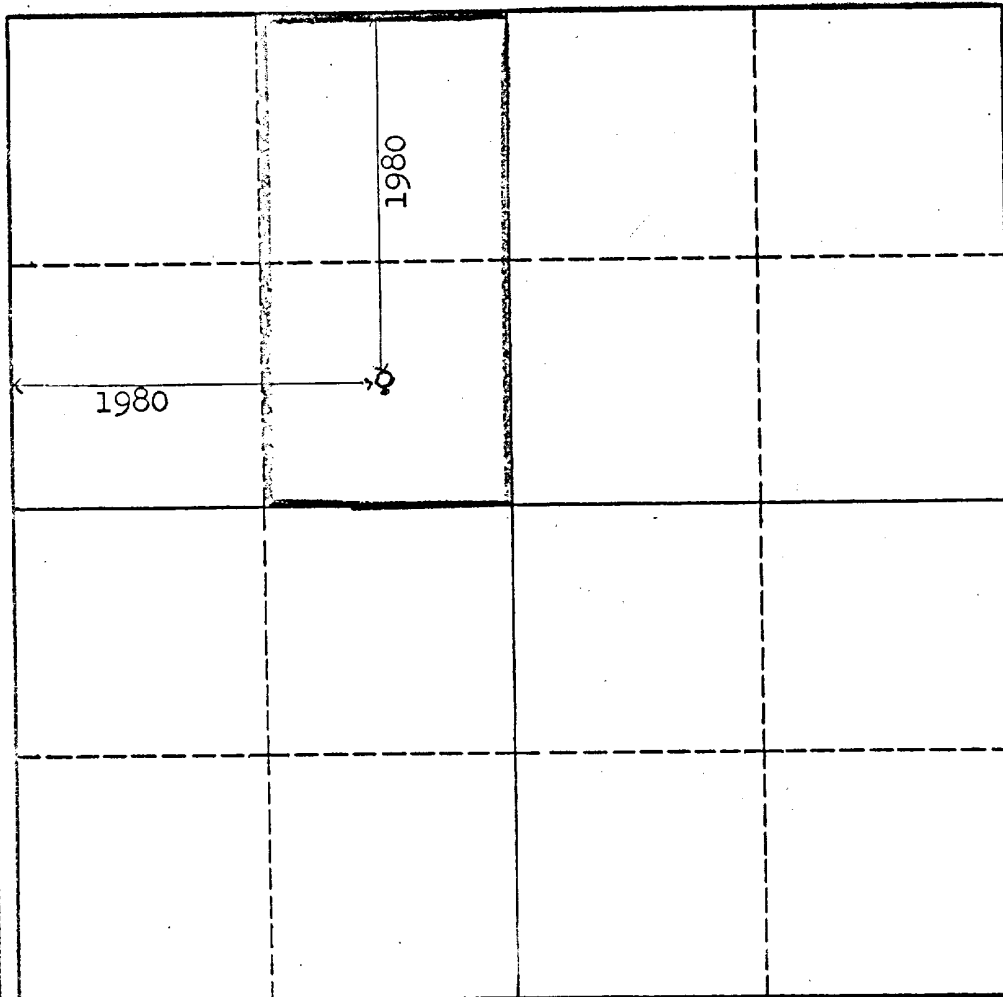

**CERTIFICATION**

I hereby certify that the information in SECTION A above is true and complete to the best of my knowledge and belief.

Name  
**SIGNED: ROBERT GAULT III**  
 Position  
**Staff Supervisor**  
 Company  
**Continental Oil Co.**  
 Date  
**12-2-64**

**NMOCC 4 - JM**

I hereby certify that the well location shown on the plat in SECTION B was plotted from field notes of actual surveys made by me or under my supervision, and that the same is true and correct to the best of my knowledge and belief.

Date Surveyed  
 Registered Professional Engineer  
 and/or Land Surveyor

Certificate No.

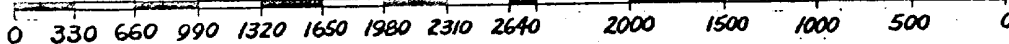

Submit to Appropriate District Office State Lease Office Fee 1.00 per copy

State of New Mexico Energy, Minerals and Natural Resources Department

Form C-102 Revised 1-1-89

OIL CONSERVATION DIVISION

P.O. Box 2088 Santa Fe, New Mexico 87504-2088

DISTRICT I P.O. Box 1980, Hobbs, NM 88240

DISTRICT II P.O. Drawer DD, Artesa, NM 88210

DISTRICT III 1000 Rio Brazos Rd., Aztec, NM 87410

WELL LOCATION AND ACREAGE DEDICATION PLAT

All Distances must be from the outer boundaries of the section

Operator <b>Conoco Inc.</b>			Lease <b>Britt</b>		Well No. <b>10</b>
Unit Letter <b>F</b>	Section <b>15</b>	Township <b>20S</b>	Range <b>37E</b>	County <b>Lea</b>	
Actual Footage Location of Well: <b>1980</b> feet from the <b>north</b> line and <b>1980</b> feet from the <b>west</b> line					
Ground level Elev. <b>3555'</b>	Producing Formation <b>Yates/Seven Rivers</b>		Pool <b>Eumont Gas Pool</b>	Dedicated Acreage: <b>640</b> Acres	

- Outline the acreage dedicated to the subject well by colored pencil or lacquer marks on the plat below.
  - If more than one lease is dedicated to the well, outline each and identify the ownership thereof (both as to working interest and royalty).
  - If more than one lease of different ownership is dedicated to the well, have the interest of all owners been consolidated by communitization, unitization, force-pooling, etc.?
    - Yes  No
    - If answer is "yes" type of consolidation \_\_\_\_\_
- If answer is "no" list the owners and tract descriptions which have actually been consolidated. (Use reverse side of this form if necessary.)
- No allowable will be assigned to the well until all interests have been consolidated (by communitization, unitization, forced-pooling, or otherwise) or until a non-standard unit, eliminating such interest, has been approved by the Division.

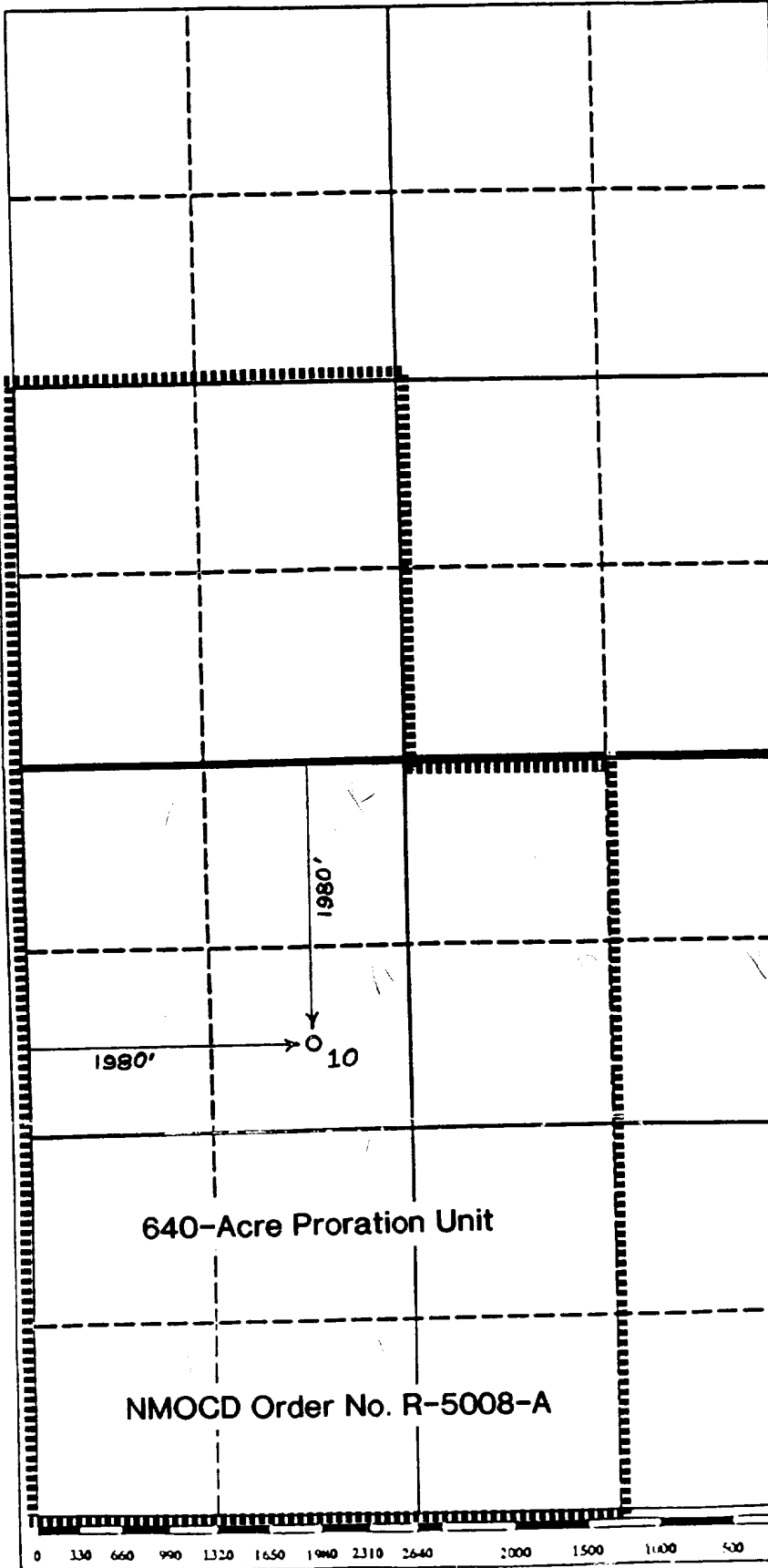

**OPERATOR CERTIFICATION**

I hereby certify that the information contained herein is true and complete to the best of my knowledge and belief.

Signature  
*Jerry W. Hoover*  
Printed Name  
**Jerry W. Hoover**

Position  
**Sr. Conservation Coord.**

Company  
**Conoco Inc.**

Date  
**6/3/93**

---

**SURVEYOR CERTIFICATION**

I hereby certify that the well location shown on this plat was plotted from field notes of actual surveys made by me or under my supervision, and that the same is true and correct to the best of my knowledge and belief.

Date Surveyed \_\_\_\_\_

Signature & Seal of Professional Surveyor \_\_\_\_\_

Certificate No. \_\_\_\_\_

**RECEIVED**

JUN 24 1993

ROD HOBBS  
OFFICE

# WRS COMPLETION REPORT

COMPLETIONS SEC 15 TWP 20S RGE 37E  
PI# 30-1-0020 05/02/88 30-025-06109-0004 PAGE 1

NMEX LEA \* 1980FNL 1980FWL SEC SE NW  
STATE COUNTY FOOTAGE SPOT  
CONOCO INC D D DO  
OPERATOR WELL CLASS INIT FIN  
10 BRITT "B"  
WELL NO. LEASE NAME  
3555GR CASS  
OPER ELEV. FIELD POOL AREA  
API 30-025-06109-0004  
LEASE TYPE NO. PERMIT OR WELL I.D. NO.  
12/22/1987 01/26/1988 WO-UNIT OIL-WO  
SPUD DATE COMP. DATE TYPE TOOL STATUS  
7730 PNNSYLVN NOT RPTD  
PROJ. DEPTH PROJ. FORM CONTRACTOR  
DTD 7790 PB 7730 OTD 6980 FM/TD STRAWN  
DRILLERS T.D. LOG T.D. PLUG BACK TD OLD T.D. FORM T.D.

## LOCATION DESCRIPTION

4 MI SE MONUMENT, NM

## CASING/LINER DATA

LNR 5 1/2 5475- 7743 W/ 245S

## TUBING DATA

TBG 2 7/8 AT 7720

## INITIAL POTENTIAL

IPP 195BOPD 261 MCFD 102BW 24HRS  
STRAWN PERF JET W/ 16/IT 7701- 7705  
PERF 7701- 7705  
ACID 7701- 7705 2500GALS  
15% NEFE HCL  
GOR 1338 GTY (NR)

FIELD /RESERVOIR  
/PENNSYLVANIAN

TYPE FORMATION LTH TOP DEPTH/SUB BSE DEPTH/SUB

LOG STRAWN 7685 -4130

## FORMATION TEST DATA

DST 1 7765- 7790 STRAWN  
INIT OP 5M

CONTINUED IC# 300257020988

Copyrighted 1988  
Petroleum  
Information Corporation

Petroleum Information

PI-WRS-GET  
Form No 187

BB a company of  
The Dun & Bradstreet Corporation

COMPLETIONS SEC 15 TWP 20S RGE 37E  
PI# 30-T-0020 05/02/88 30-025-06109-0004 PAGE 2

CONOCO INC D D DO  
10 BRITT "B"

FORMATION TEST DATA

FINAL OP 2H 5M  
1H 12H  
AFTER 2 HRS FTP 350 PSI ON 1/4 CHK, OIL CUT 25%. NO  
PRESSURES OR RECOVERIES RPTD

PRODUCTION TEST DATA

BLINEBRY PERF 5612- 6534  
DRINKARD PERF 6642- 6851  
PERF 5612- 6534 6642- 6851  
SQZD 5612- 6851 W/ 550S

LOGS AND SURVEYS /INTERVAL, TYPE/

LOGS	DLL	MLL	GR
LOGS	CAL	CNL	

DRILLING PROGRESS DETAILS

CONOCO INC  
BOX 460  
HOBBS, NM 88240  
505-393-4141  
OWDD: OLD INFO: FORMERLY CONOCO INC #10 BRITT  
"B". ELEV 3565 DF. SPUD 4/24/84. 13 3/8 @  
341 W/400 SX, 9 5/8 @ 3999 W/650 SX, 7 @ 6979  
W/370 SX. OTD 6980. PB 6881. COMP 7/23/84.  
IPP 29 BO, 32 BWPD. PROD ZONE: BLINEBRY 5612-  
6524. IPP 4 BO, 32 BWPD. PROD ZONE: DRINKARD  
6642-6851. DUAL PRODUCER.  
ABANDON LOCATION ISSUED 12/17/87  
FORMERLY ABAN LOC UNDER SAME API & IC 30-025-  
70368-86.  
04/26 LOC/1988/  
04/26 DOC & DEEPENED TO 7750  
RAN 5 1/2 LNR  
04/26 7750 TD, PB 7730  
COMP 1/26/88, IPP 195 BO, 261 MCFG, 102  
BWPD, GOR 1338, GTY (NR)  
PROD ZONE - PENNSYLVANIAN 7701-7705  
NO CORES, ONE DST RPTD  
FIRST REPORT & COMPLETION

**WRS COMPLETION REPORT**

COMPLETIONS SEC 15 TWP 20S RGE 37E  
 PIZ 30-T-0008 12/23/87 30-025-06109-0004 PAGE 1

NMEX LEA \* 1980FNL 1980FWL SEC SE NW  
 STATE COUNTY FOOTAGE SPOT  
 CONOCO INC WDD  
 OPERATOR WELL CLASS INIT FIN  
 10 BRITT "B"  
 WELL NO. LEASE NAME

OPER ELEV WILDCAT  
 FIELD POOL AREA  
 API 30-025-06109-0004

LEASE TYPE NO. PERMIT OR WELL I.D. NO.  
 12/17/1987 ROTARY AB-LOC  
 SPUD DATE COMP. DATE TYPE TOOL STATUS

7130 ABO  
 PROJ. DEPTH PROJ. FORM CONTRACTOR  
 OTD 6980  
 DRILLERS T.D. LOG T.D. PLUG BACK TO OLD T.D. FORM T.D.

LOCATION DESCRIPTION

4 MI SE MONUMENT, NM

DRILLING PROGRESS DETAILS

CONOCO INC  
 BOX 460  
 HOBBS, NM 88240  
 505-393-4141  
 OWDD: OLD INFO: FORMERLY CONOCO INC #10 BRITT  
 "B": ELEV 3565 DF. SPUD 4/24/84. 7 @ 6979  
 W/370 SX. OTD 6980. PB 6881. COMP 7/23/84.  
 IPP 29 BO, 32 BWP. PROD ZONE: BLINEBRY  
 5612-6534. IPP 4 BO, 32 BWP. PROD ZONE:  
 DRINKARD 6642-6851. (DUAL PRODUCER)  
 12/18 LOC/1986/  
 12/21 ABND OWDD

IC# 300257036386

COUNTY LEA FIELD Monument-Tubb STATE N.M. OWWO  
 OPR CONTINENTAL OIL COMPANY MAF  
10 Britt "B"  
Sec. 15, T-20-S, R-37-E CO-ORD  
1980' fr N & W Lines of Sec.  
 Re-Spud 6-4-64 CLASS owd 3565  
 Re-Comp 6-11-64  
 CSG & SX - TUBING  
7" 6979' 370  
 LOGS EL GR RA IND HC A  
TD 6890', PBD 6534'

IP Tubb Perfs 6496-6534' Flwd 136 BOPD. Pot. Based on 24 hr test thru 18/64" chk., TP 1100#, CP Pkr, Gravity 39., GOR 10,941.

NOW DUAL COMPLETE WITH BLINEBRY 5782-5802'

Distribution limited and publication prohibited by subscribers' agreement.  
 Reproduction rights reserved by Williams & Lee Scouting Service, Inc.

CONT.	PROP DEPTH	TYPE
DATE		

8-3-64 F.R.C. 8-6-64; OWWO, OTD 6980'.  
 Elev. 3566' Df, Orig.  
 TD 6890', PBD 6534', COMPLETED.  
 Squeezed Tubb Perfs 6430-6534' W/100 sx.  
 DO to 6534'  
 Re-Perf (Tubb) 6496-6505', 6508-12', 6524-34'  
 W/1 SPF  
 Ac. 3000 gals. 6496-6534'.