

NEW MEXICO OIL CONSERVATION COMMISSION
WELL LOCATION AND ACREAGE DEDICATION PLAT

FORM C-128
Revised 5/1/57

SEE INSTRUCTIONS FOR COMPLETING THIS FORM ON THE REVERSE SIDE

SECTION A

Operator CONTINENTAL OIL COMPANY		Lease BRITT B15		Well No. 14	
Unit Letter L	Section 15	Township 20 SOUTH	Range 37 EAST	County LEA	
Actual Footage Location of Well: 1980 feet from the SOUTH line and 660 feet from the WEST line					
Ground Level Elev.	Producing Formation Blinebry & Tubb		Pool Weir Blinebry & Monument Tubb		Dedicated Acreage: 40 Acres
<p>1. Is the Operator the only owner in the dedicated acreage outlined on the plat below? YES <input checked="" type="checkbox"/> NO <input type="checkbox"/> ("Owner" means the person who has the right to drill into and to produce from any pool and to appropriate the production either for himself or for himself and another. (65-3-29 (e) NMSA 1935 Comp.)</p> <p>2. If the answer to question one is "no," have the interests of all the owners been consolidated by communitization agreement or otherwise? YES <input type="checkbox"/> NO <input type="checkbox"/> If answer is "yes," Type of Consolidation _____</p> <p>3. If the answer to question two is "no," list all the owners and their respective interests below:</p>					
Owner			Land Description		

SECTION B

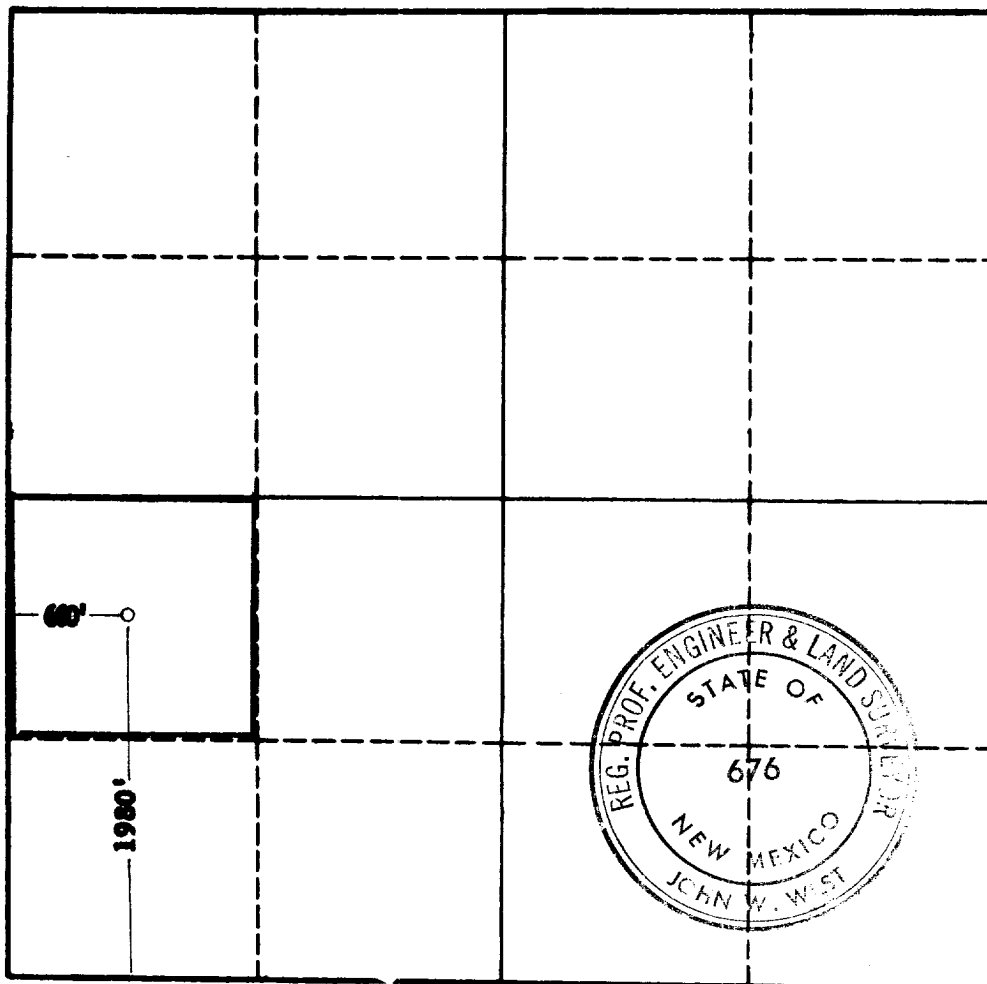

CERTIFICATION

I hereby certify that the information in SECTION A above is true and complete to the best of my knowledge and belief.

Name *J. R. Parker*
Position **District Superintendent**
Company **Continental Oil Company**
Date **8-30-62**

I hereby certify that the well location shown on the plat in SECTION B was plotted from field notes of actual surveys made by me or under my supervision, and that the same is true and correct to the best of my knowledge and belief.

Date Surveyed **8-30-62**
Registered Professional Engineer and/or Land Surveyor, **JOHN W. WEST**
John W. West
Certificate No. **N. M. - P. E. & L. S. NO. 676**

0 330 660 990 1320 1650 1980 2310 2640 2000 1500 1000 500 0