

NEW MEXICO OIL CONSERVATION COMMISSION
WELL LOCATION AND ACREAGE DEDICATION PLAT

Form C-102
Supersedes C-128
Effective 1-1-65

All distances must be from the outer boundaries of the Section.

30-025-06114

Operator CONOCO INC.		Lease SEMU-Drinkard-Weir		Well No. 61
Unit Letter P	Section 15	Township 20-S	Range 37-E	County LEA
Actual Footage Location of Well: 990 feet from the South line and 990 feet from the EAST line				
Ground Level Elev.	Producing Formation Drinkard	Pool Weir Drinkard	Dedicated Acreage: 40 Acres	

1. Outline the acreage dedicated to the subject well by colored pencil or hachure marks on the plat below.
2. If more than one lease is dedicated to the well, outline each and identify the ownership thereof (both as to working interest and royalty).
3. If more than one lease of different ownership is dedicated to the well, have the interests of all owners been consolidated by communitization, unitization, force-pooling, etc?

☐ Yes ☐ No If answer is "yes," type of consolidation _____

If answer is "no," list the owners and tract descriptions which have actually been consolidated. (Use reverse side of this form if necessary.) _____

No allowable will be assigned to the well until all interests have been consolidated (by communitization, unitization, forced-pooling, or otherwise) or until a non-standard unit, eliminating such interests, has been approved by the Commission.

CERTIFICATION

I hereby certify that the information contained herein is true and complete to the best of my knowledge and belief.

Name *Jane A. New*
Position Administrative Supervisor

Company CONOCO INC.

Date SEP 30 1981

I hereby certify that the well location shown on this plat was plotted from field notes of actual surveys made by me or under my supervision, and that the same is true and correct to the best of my knowledge and belief.

Date Surveyed

Registered Professional Engineer and/or Land Surveyor

Certificate No.

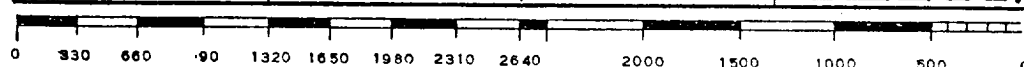

NEW MEXICO OIL CONSERVATION COMMISSION
WELL LOCATION AND ACREAGE DEDICATION PLAT

FORM C-128
Revised 5/1/57

SEE INSTRUCTIONS FOR COMPLETING THIS FORM ON THE REVERSE SIDE

SECTION A

Operator Continental Oil Company			Lease SEMU Pennsylvanian		Well No. 61
Unit Letter	Section 15	Township 20 S	Range 37E	County Lea	
Actual Footage Location of Well: 990 feet from the South line and 990 feet from the East line					
Ground Level Elev. 3537'	Producing Formation Pennsylvanian		Pool Cass	Dedicated Acreage: 80 Acres	

1. Is the Operator the only owner in the dedicated acreage outlined on the plat below? YES ☒ NO ____ . ("Owner" means the person who has the right to drill into and to produce from any pool and to appropriate the production either for himself or for himself and another. (65-3-29 (e) NMSA 1935 Comp.)
2. If the answer to question one is "no," have the interests of all the owners been consolidated by communitization agreement or otherwise? YES ____ NO ____ . If answer is "yes," Type of Consolidation ____
3. If the answer to question two is "no," list all the owners and their respective interests below:

Owner	Land Description

SECTION B

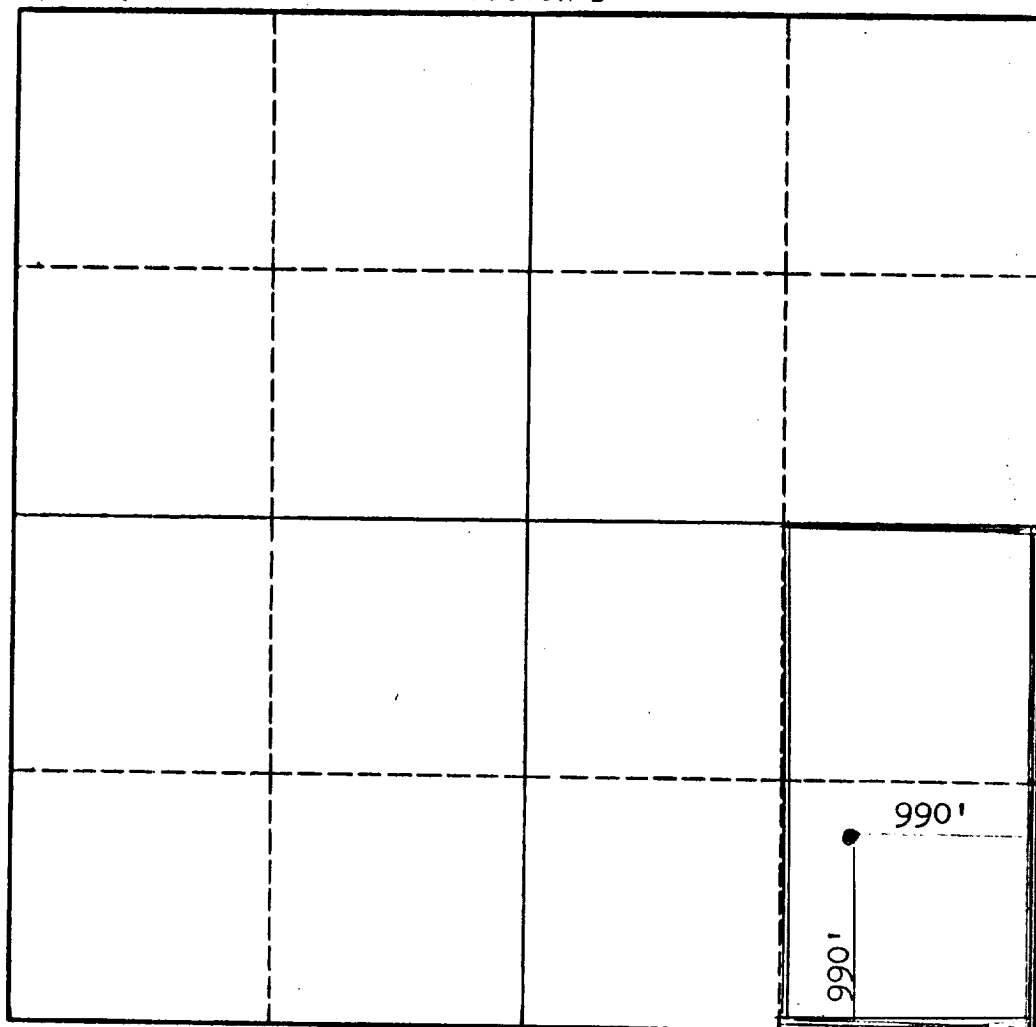

CERTIFICATION

I hereby certify that the information in SECTION A above is true and complete to the best of my knowledge and belief.

Name
SIGNED: ROBERT CAULT III

Position
Staff Supervisor

Company
Continental Oil Co.

Date
1-6-65

NMOCC-5, USGS-2 JM
Pan Am Hobbs-3 Atl Ros 2
Standard-Mid 3

I hereby certify that the well location shown on the plat in SECTION B was plotted from field notes of actual surveys made by me or under my supervision, and that the same is true and correct to the best of my knowledge and belief.

Date Surveyed

Registered Professional Engineer
and/or Land Surveyor

Certificate No.

0 330 660 990 1320 1650 1980 2310 2640 2000 1500 1000 500 0

OWWO

COUNTY LEA FIELD Weir STATE NM MN 06114

OPR CONTINENTAL OIL CO. MAP

61 SEMU

Sec 15, T-20-S, R-37-E CO-ORD

990' FSL, 990' FEL of Sec

Re-Cmp 10-25-71	CLASS		EL	
	FORMATION	DATUM	FORMATION	DATUM
CSG & SX - TUBING				
13 3/8" at 319' w/300 sx				
9 5/8" at 3998' w/1800 sx				
7" at 7744' w/500 sx.				
LOGS EL GR RA IND HC A				
TD 10,436'; PBD 6750'				

IP (Blinebry) Perfs 5654-5766' F 1200 MCFGPD. Pot based on 24 hr test thru 38/64" chk. GOR Dry; Grav NR; CP 230#.

IP (Drinkard) Perfs 6640-76' F 408 MCFGPD. Pot based on 24 hr test thru 27/64" chk. GOR Dry; Grav NR; CP Pkr; TP 150#.

Distribution limited and publication prohibited by subscribers' agreement.
Reproduction rights reserved by Williams & Lee Scouting Service, Inc.

CONT PROP DEPTH 6676' TYPE WO

DATE

2-22-72 F.R.C. 2-24-72; Opr's Elev. 3550' DF
PD 6676' WO (Drinkard)
(Orig. #61 SEMU Penn, comp 10-2-57 thru (Pennsylvania)
Perfs 7725-31', OTD 10,436', OFB 7338')
TD 10,436'; PBD 7616'; COMPLETE
Sqzd (7725-31') w/50 sx
Perf (Drinkard) @ 6640', 6644', 6647', 6650',
6654', 6657', 6662', 6666', 6670', 6676',
6862-91' w/1 SPF
Acid (6640-6891') 2000 gals (LSTNE)
Swbd wtr (6862-91')
Sqzd (6862-91') w/200 sx
Perf (Tubb) 6405-6568' w/11 shots (overall)
Acid (6405-6568') 2500 gals (15%)
Tested non-commercial (6405-6568')

LEA Weir NM Sec 15,T20S,R37E
CONTINENTAL OIL CO. 61 SEMU Page #2

2-22-72 Continued
Sqzd (6405-6568') w/200 sx
Perf (Blinbry) @ 5654', 5674', 5693', 5711',
5716', 5720', 5732', 5740', 5743', 5766'
w/1 SPI
Acid (5654-5766') 9000 gals (15%)
2-24-72 COMPLETION REPORTED