

NEW MEXICO
OIL CONSERVATION COMMISSION

7a Well Plat

Date March 16, 1954

R. B. Honeyman, Jr.

Wulff State

2

Operator

Lease

Well No.

Name of Producing Formation Queen Pool Eumont

No. Acres Dedicated to the Well 80

SECTION 17 TOWNSHIP 20 RANGE 37

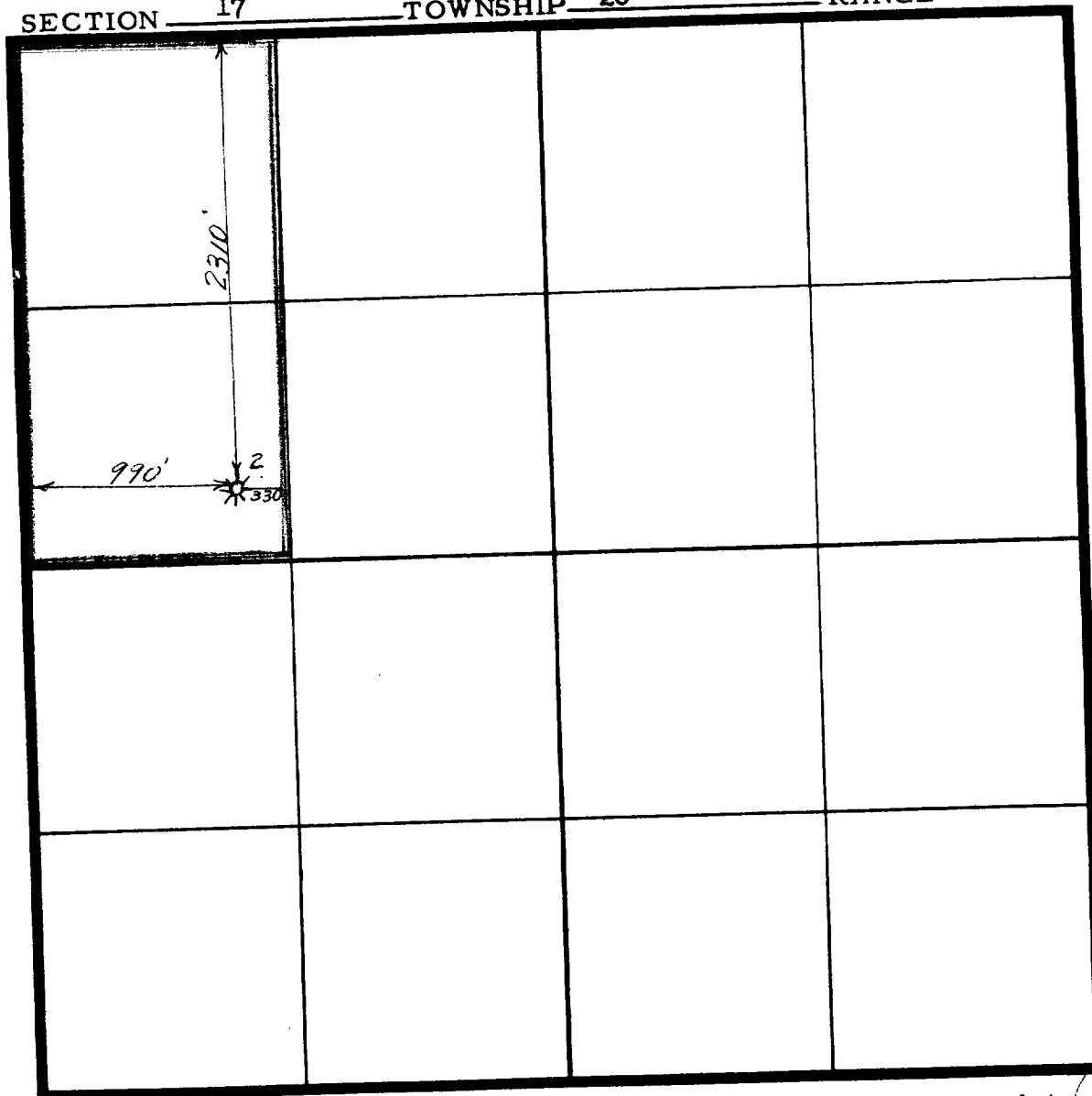

I hereby certify that the information given above is true and complete to the best of my knowledge.

Name J. V. Short

Position Supt.

Representing R. B. Honeyman, Jr.

Address Box 429, Big Springs, Tex.

(over)

INSTRUCTIONS

1. Is this gas well a dual completion? Yes _____ No X
2. If the answer to Question 1 is Yes, are there any other
dually completed wells within the dedicated acreage?
Yes _____ No _____

A separate plat must be filed for each gas well, outlining the area dedicated to such well and showing the location of all other wells (oil and gas) within the outlined area.

Mail in duplicate to the district office for the district in which the well is located.