

State of New Mexico
Energy, Minerals & Natural Resources Department

Form C-102

Revised October 18, 1994

OIL CONSERVATION DIVISION
2040 South Pacheco
Santa Fe, NM 87505

Instructions on back
Submit to Appropriate District Office
State Lease - 4 Copies
Fee Lease - 3 Copies

District I
PO Box 1980, Hobbs, NM 88241-1980
District II
811 S. 1st Street, Artesia, NM 88210-2834
District III
1000 Rio Brazos Rd., Aztec, NM 87410
District IV
2040 South Pacheco, Santa Fe, NM 87505

☐ AMENDED REPORT

WELL LOCATION AND ACREAGE DEDICATION PLAT

¹ API Number 30-025-06145	² Pool Code 76480	³ Pool Name Eumont Yates 7RQ
⁴ Property Code 000160	⁵ Property Name New Mexico "F" State	⁶ Well Number 1
⁷ OGRID No. 000495	⁸ Operator Name Amerada Hess Corporation	⁹ Elevation

¹⁰ Surface Location									
UL or lot no. K	Section 17	Township 20S	Range 37E	Lot. Idn	Feet from the 1980	North/South Line South	Feet from the 1986.7	East/West line West	County Lea

¹¹ Bottom Hole Location If Different From Surface									
UL or lot no.	Section	Township	Range	Lot. Idn	Feet from the	North/South Line	Feet from the	East/West line	County
¹² Dedicated Acres 160	¹³ Joint or Infill Y	¹⁴ Consolidation Code		¹⁵ Order No.					

NO ALLOWABLE WILL BE ASSIGNED TO THIS COMPLETION UNTIL ALL INTERESTS HAVE BEEN CONSOLIDATED
OR A NON-STANDARD UNIT HAS BEEN APPROVED BY THE DIVISION

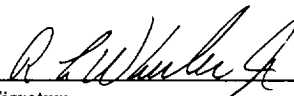
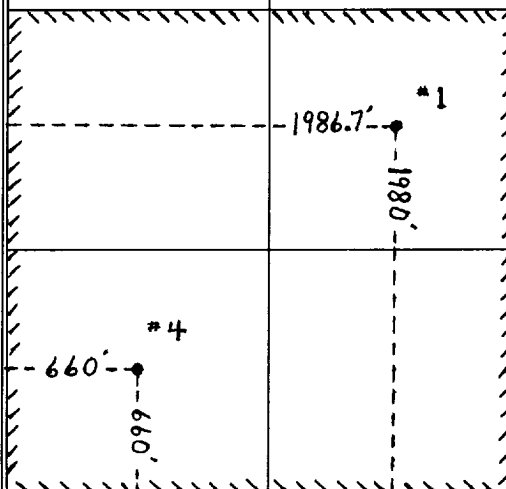
				¹⁷ OPERATOR CERTIFICATION <i>I hereby certify that the information contained herein is true and complete to the best of my knowledge and belief.</i>	
				Signature  Roy L. Wheeler, Jr. Printed Name Bus. Svc. Spec. II Title 02-05-99 Date	
				¹⁸ SURVEYOR CERTIFICATION <i>I hereby certify that the well location shown on this plat was plotted from field notes of actual surveys made by me or under my supervision, and that the same is true and correct to the best of my belief.</i>	
				Date of Survey Signature and Seal of Professional Surveyer: Certificate Number	

Submit to Appropriate
District Office
State Leases - 4 copies
Fee Leases - 3 copies

State of New Mexico
Energy, Minerals and Natural Resources Department

Form C-102
Revised 1-1-89

OIL CONSERVATION DIVISION

DISTRICT I
P.O. Box 1980, Hobbs, NM 88240

P.O. Box 2088

Santa Fe, New Mexico 87504-2088

DISTRICT II
P.O. Drawer DD, Artesia, NM 88210

DISTRICT III
1000 Rio Brazos Rd., Aztec, NM 87410

WELL LOCATION AND ACREAGE DEDICATION PLAT

All Distances must be from the outer boundaries of the section

Operator Amerada Hess Corporation			Lease New Mexico "F" State		Well No. 1
Unit Letter K	Section 17	Township 20S	Range 37E	County NMPM	Lea
Actual Footage Location of Well: 1980 feet from the South line and 1986.7 feet from the West line					
Ground level Elev. 3525'	Producing Formation Eumont Yates 7 RQ		Pool Eumont	Dedicated Acreage: 160 Acres	

- Outline the acreage dedicated to the subject well by colored pencil or hatchure marks on the plat below.
- If more than one lease is dedicated to the well, outline each and identify the ownership thereof (both as to working interest and royalty).
- If more than one lease of different ownership is dedicated to the well, have the interest of all owners been consolidated by communization, unitization, force-pooling, etc.?
☐ Yes ☐ No If answer is "yes" type of consolidation _____
If answer is "no" list the owners and tract descriptions which have actually been consolidated. (Use reverse side of this form if necessary.) _____
No allowable will be assigned to the well until all interests have been consolidated (by communization, unitization, forced-pooling, or otherwise) or until a non-standard unit, eliminating such interest, has been approved by the Division.

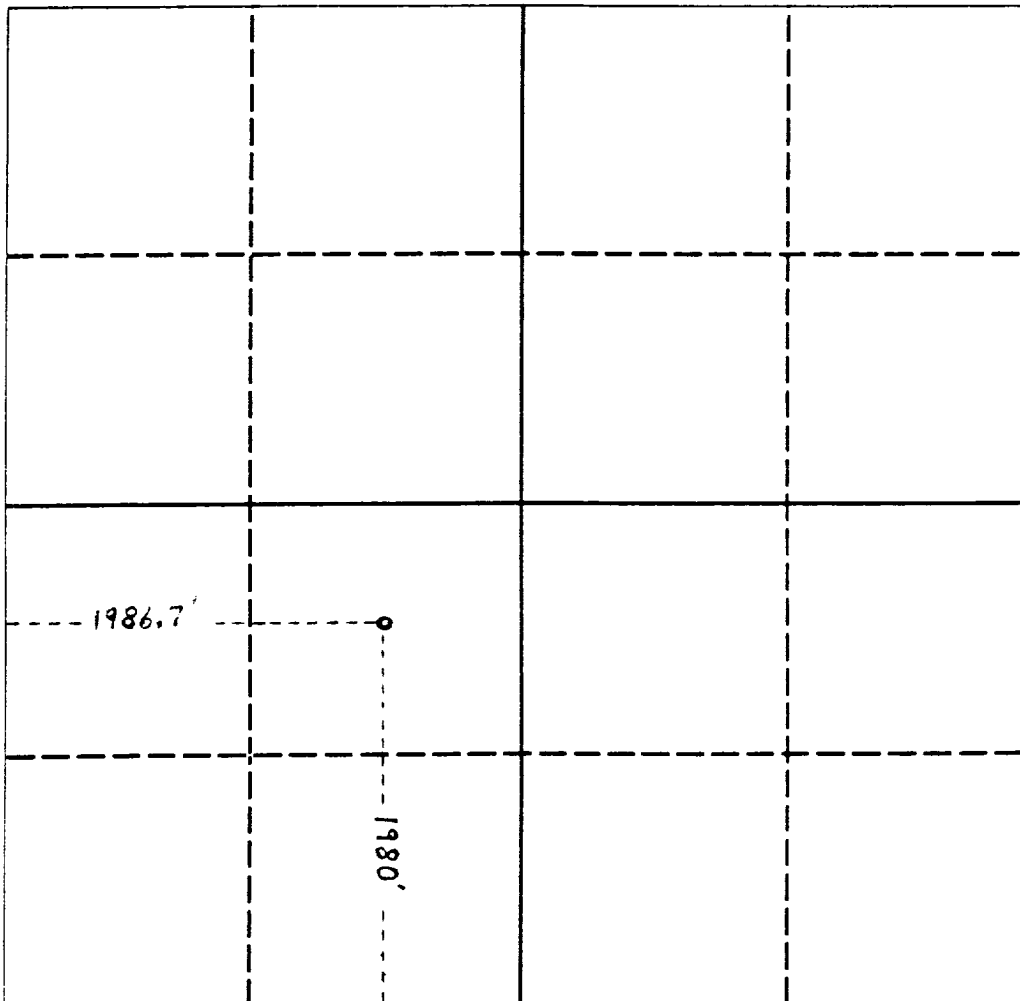

OPERATOR CERTIFICATION

I hereby certify that the information contained herein is true and complete to the best of my knowledge and belief.

Signature
R. L. Wheeler, Jr.
Printed Name
R. L. Wheeler, Jr.
Position
Supv. Adm. Svc.
Company
Amerada Hess Corporation
Date
2-19-91

SURVEYOR CERTIFICATION

I hereby certify that the well location shown on this plat was plotted from field notes of actual surveys made by me or under my supervision, and that the same is true and correct to the best of my knowledge and belief.

Date Surveyed
Signature & Seal of Professional Surveyor
Certificate No.

NEW MEXICO
OIL CONSERVATION COMMISSION

Gas Well Plat

Date 11-12-53

HUMBLE OIL & REFINING CO.

NEW MEXICO STATE "F"

1

Operator

Lease

Well No.

Name of Producing Formation QUEEN

Pool EUMONT

No. Acres Dedicated to the Well 160

SECTION 17

TOWNSHIP

20-S

RANGE 37-E

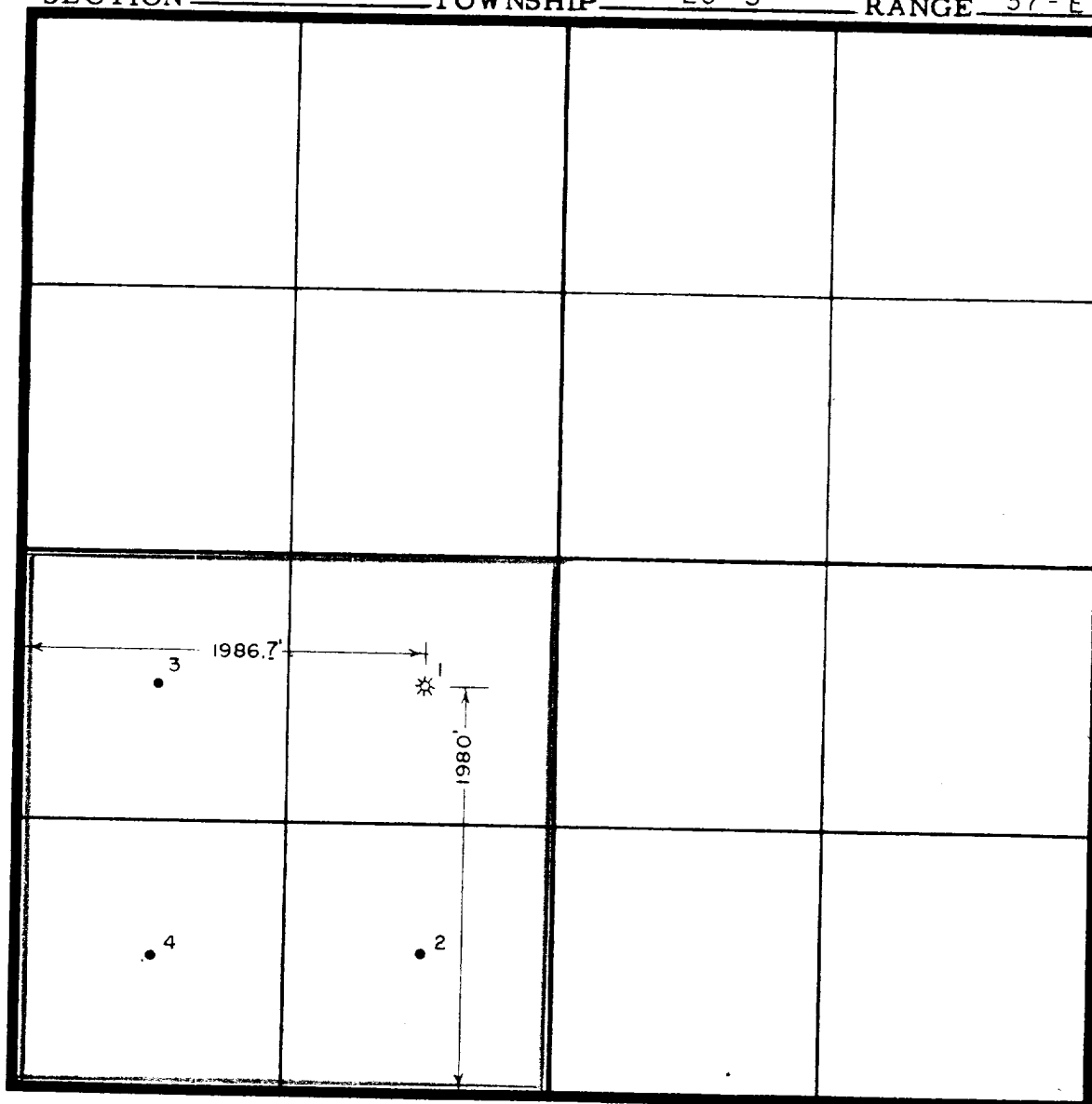

I hereby certify that the information given above is true and complete to the best of my knowledge.

1. Is this gas well a dual completion? Yes No
2. Are there any other dually completed wells within the dedicated acreage? Yes No

Name J. H. Sacco
Position Assistant Division Superintendent
Representing Humble Oil & Refining Co.
Address Box 1400, Dallas 1, Texas

(over)