

NEW MEXICO
OIL CONSERVATION COMMISSION

Form C-128

~~Well Location and/or Gas Proration Plat~~

Date October 18, 1956

Operator Skelly Oil Company Lease State "P" (C)

Well No. 2 Section 17 Township 20-S Range 37-E NMPM

Located 660' Feet From South Line, 1980' Feet From East Line

Lea County, New Mexico. G. L. Elevation 3529'

Name of Producing Formation Queen Pool Eumont Dedicated Acreage 160

(Note: All distances must be from outer boundaries of Section)

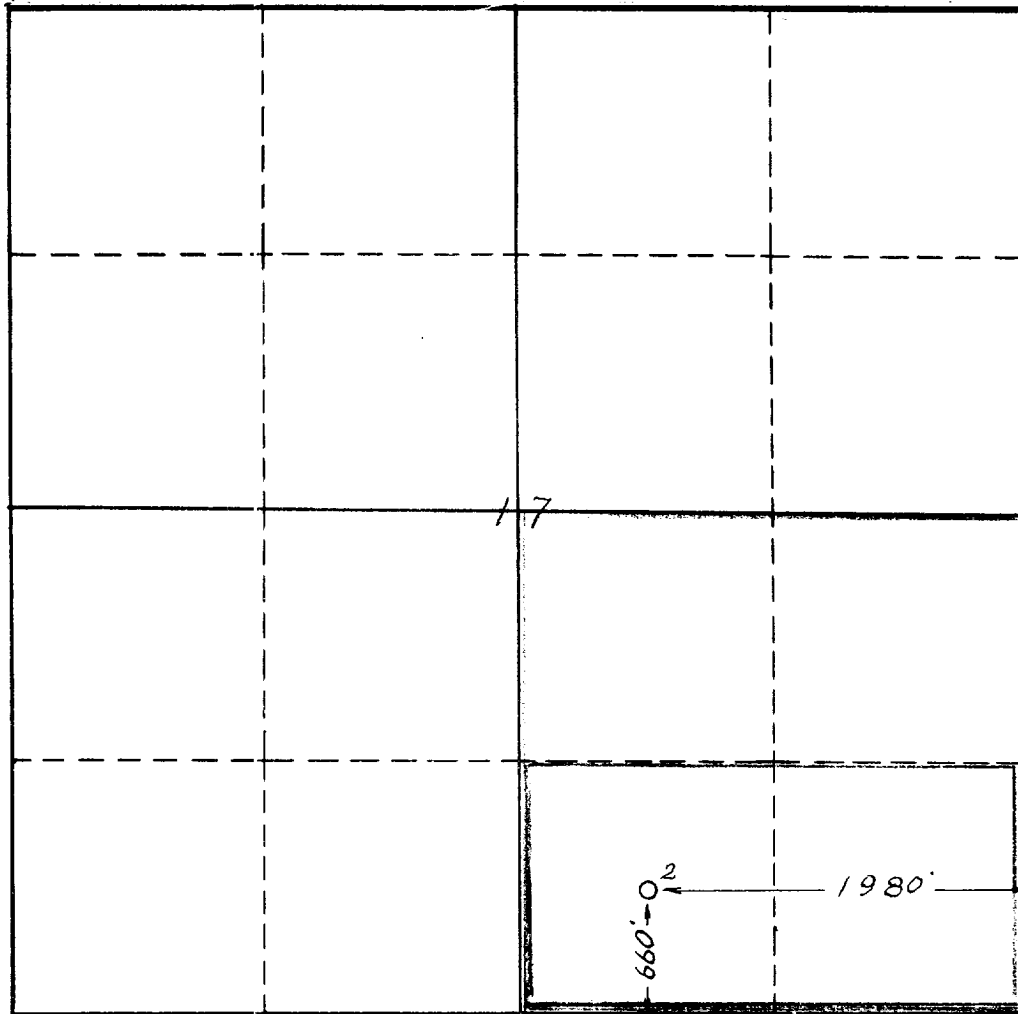

SCALE: 1"=1000'

1. Is this Well a Dual Comp. ? Yes X No .
2. If the answer to Question 1 is yes, are there any other dually completed wells within the dedicated acreage ? Yes No X.

This is to certify that the above plat was prepared from field notes of actual surveys made by me or under my supervision and that the same are true and correct to the best of my knowledge and belief.

Name J. A. Anderson
Position Dist. Supt.
Representing Skelly oil Co.
Address Box 38, Hobbs, New Mexico

Date Surveyed
Registered Professional Engineer and/or
Land Surveyor