

NEW MEXICO OIL CONSERVATION COMMISSION

Santa Fe, New Mexico

It is necessary that Form C-104 be approved before this form can be approved an initial allowable be assigned to any completed Oil or Gas well. Submit this form in QUADRUPPLICATE.

CERTIFICATE OF COMPLIANCE AND AUTHORIZATION  
TO TRANSPORT OIL AND NATURAL GAS

Company or Operator Continental Oil Company Lease State A-36

Address Box 427, Hobbs, N.M. Pampa City, Oklahoma  
(Local or Field Office) (Principal Place of Business)

Unit N, Well(s) No. 4, Sec. 36, T. 20S, R. 37E, Pool Hardy

County Lea Kind of Lease: State

If Oil well Location of Tanks

Authorized Transporter Continental Carbon Company Address of Transporter

Emice, N.M. Amarillo, Texas  
(Local or Field Office) (Principal Place of Business)

Per cent of Oil or Natural Gas to be Transported 100% Other Transporters authorized to transport Oil or Natural Gas from this unit are Shell Pipe Line Corp.

100%

REASON FOR FILING: (Please check proper box)

NEW WELL ☐ CHANGE IN OWNERSHIP ☐

CHANGE IN TRANSPORTER ☒ OTHER (Explain under Remarks) ☐

REMARKS To change transporter from Phillips to Continental Carbon effective 4-16-55.

The undersigned certifies that the Rules and Regulations of the Oil Conservation Commission have been complied with.

Executed this the 5th day of May 1955

Continental Oil Company

Approved \_\_\_\_\_, 19\_\_\_\_

OIL CONSERVATION COMMISSION

By M. L. Hernandez

By \_\_\_\_\_

Title District Superintendent

Title \_\_\_\_\_

(See Instructions on Reverse Side)

## INSTRUCTIONS

This form shall be executed and filed in QUADRUPLICATE with the District Office of the Oil Conservation Commission, covering each unit from which oil or gas is produced. A separate certificate shall be filed for each transporter authorized to transport oil or gas from a unit. After said certificate has been approved by the Oil Conservation Commission, one copy shall be forwarded to the transporter, one copy returned to the producer, and two copies retained by the Oil Conservation Commission.

A new certificate shall be filed to cover each change in operating ownership and each change in the transporter, except that in the case of a temporary change in the transporter involving less than the allowable production for one proration period, the operator shall in lieu of filing a new certificate notify the Oil Conservation Commission District Office, and the transporter authorized by certificate on file with the Commission, by letter of the estimated amount of oil or gas to be moved by the transporter temporarily moving oil or gas from the unit and the name of such temporary transporter and a copy of such notice shall also be furnished such temporary transporter. Such temporary transporter shall not move any more oil or gas than the estimated amount shown in said notice.

This certificate when properly executed and approved by the Oil Conservation Commission shall constitute a permit for pipe line connection and authorization to transport oil and gas from the property named therein and shall remain in full force and effect until

- (a) Operating ownership changes
- (a) The transporter is changed or
- (c) The permit is cancelled by the Commission.

If any of the rules and regulations of the Oil Conservation Commission have not been complied with at the same time this report is filed, explain fully under the heading "REMARKS."

In all cases where this certificate is filed to cover a change in operating ownership or a change in the transporter designated to move oil or gas, show under "REMARKS" the previous owner or operator and the transporter previously authorized to transport oil or gas.

A separate report shall be filed to cover each producing unit as designated by the Oil Conservation Commission.

**OIL CONSERVATION COMMISSION  
STATE OF NEW MEXICO**

**Certificate of Compliance and Authorization to Transport Oil**

**Company or Operator** Continental Oil Company **Lease** State A-36  
**Address** Box CC, Hobbs, New Mexico Ponca City, Oklahoma  
(Local or Field Office) (Principal Place of Business)  
**Unit** N **Wells No.** 4 **Sec.** 36, 20S **R.** 37E **Field** Hardy **County** Lea  
**Kind of Lease** State **Location of Tanks** SE/4 Sec. 36  
**Transporter** Shell Pipe Line Co. **Address of Transporter** Midland, Texas  
(Principal Place of Business) (Local or Field Office)  
**Houston, Texas** **Percent of oil to be transported** 100% **Other transporters authorized to transport oil from this unit are** None %

REMARKS:

The undersigned certifies that the above rules and regulations of the Oil Conservation Commission have been complied with except as noted above and that gathering agent is authorized to transport the percentage of oil produced from the above described property and that this authorization will be valid until further notice to the transporter named herein or until cancelled by the Oil Conservation Commission of New Mexico.

Executed this the 24th. day of February, 194 2

Continental Oil Company  
(Company or Operator)

By [Signature]

Title Dist. Mgt.

State of NEW MEXICO }  
 County of Lea } ss.

Before me, the undersigned authority, on this day personally appeared G. E. Purswell known to me to be the person whose name is subscribed to the above instrument, who being by me duly sworn on oath states that he is authorized to make this report and has knowledge of the facts stated herein and that said report is true and correct.

Subscribed and sworn to before me, this the 24th. day of February, 194 2

Notary Public in and for Lea County, New Mexico

Approved: \_\_\_\_\_, 194

**My Commission expires: 4-26-41**

OIL CONSERVATION COMMISSION

By Roy Yarbrough

(See Instructions on Reverse Side)

### INSTRUCTIONS

This form shall be executed and filed in quadruplicate with the Oil Conservation Commission at Santa Fe, New Mexico, covering each unit from which oil is produced. A separate certificate shall be filed for each transporter authorized to transport oil from a unit. After said certificate has been approved by the Oil Conservation Commission, one copy shall be forwarded to the transporter, one copy returned to the producer, and two copies retained by the Oil Conservation Commission.

A new certificate shall be filed to cover each change in operating ownership and each change in the transporter, except that in the case of a temporary change in the transporter involving less than the allowable production for one month the operator shall, in lieu of filing a new certificate, notify the Oil Conservation Commission at Santa Fe, New Mexico, and the transporter authorized by certificate on file with the Commission, by letter of the estimated amount of oil to be moved by the transporter temporarily moving oil from the unit and the name of such temporary transporter and a copy of such notice shall also be furnished such temporary transporter. Such temporary transporter shall not move any more oil than the estimated amount shown in said notice.

This certificate when properly executed and approved by the Oil Conservation Commission shall constitute a permit for pipe line connection and authorization to transport oil from the property named therein and shall remain in full force and effect until

- (a) Operating ownership changes
- (b) The transporter is changed or
- (c) The permit is cancelled by the Commission

If any of the rules and regulations of the Oil Conservation Commission have not been complied with at the time this report is filed, explain fully under the heading "REMARKS."

In all cases where this certificate is filed to cover a change in operating ownership or a change in the transporter designated to move oil, show under "REMARKS" the previous owner or operator and the transporter previously authorized to transport oil.

A separate report shall be filed to cover each producing unit as designated by the Oil Conservation Commission.

HARDY

# SCOUT REPORT NEW MEXICO OIL CONSERVATION COMMISSION

Check

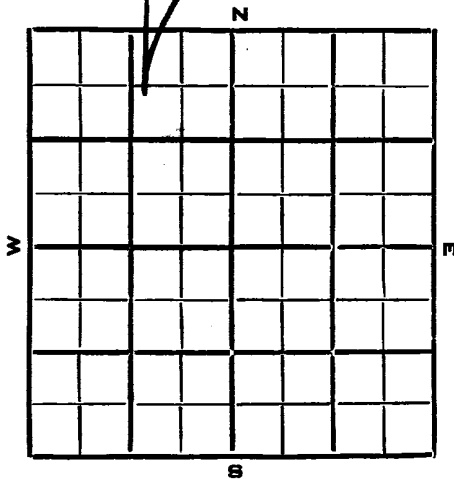
Company ConocoFarm Name State A-36Well No. 4Land Classification StateSec. 36- Twp. 20 Range 37 County LeeFeet from Line: N. 660 S. E.1980 W.

Elevation

Method SpindleContractor Lyons and Miller

Scout

Spudded 8-18-40 Completed 10-15-40 Initial Production

Bond Status

## Amount Casing and Cementing Record

Size	Feet	Inches	Sax Cement
13 3/8"	168		S-P
10 3/4	472		S-P
8 1/2	828		S-P
7"	1335		S-P

## Tubing Record

5 1/2	3515	900
2"	3770	

## ACID RECORD

Gals.

Top Pay

TD

TA

TS 1430BS 2560

TRS

TBL

TWL

## SHOOTING RECORD

No. of Quarts	<u>260</u>	Shot at	<u>3605</u>	Feet	<u>3780</u>
No. of Quarts		Shot at		Feet	
S/O	<u>3605</u>	S/O		S/O	
S/O	<u>3605</u>	S/O		S/O	

DATE		DATE	
8-22	<u>8-21-40</u> <u>18515R</u>	10-15	<u>T.D. 3810L</u>
	<u>W- 340-15</u>		<u>H.C. 3780</u>
9-4	<u>2620A</u>		<u>IP. 3 1/2 BOPH - 5 line</u>
9-10	<u>3295L</u>		<u>3 1/4" <math>\phi</math></u>
9-18	<u>T.D. 3515L</u>		
9-25	<u>3748L</u>		
10-2	<u>T.D. 3810L</u>		
10-9			
	<u>DS 5 1/2 BOPH 10 line</u>		
	<u>w/ 86000 Cor 2 line</u>		
	<u>1/2 5 line</u>		
	<u>SL 10 3775 - 87</u>		
	<u>AS 5 BOPH - 10 line</u>		
	<u>w/ 4 line</u>		

**LOG**

[illegible]

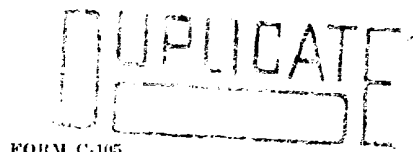

FORM C-105

N

## NEW MEXICO OIL CONSERVATION COMMISSION

Santa Fe, New Mexico

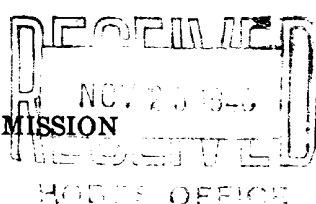

AREA 640 ACRES  
LOCATE WELL CORRECTLY

## WELL RECORD

Mail to Oil Conservation Commission, Santa Fe, New Mexico, or its proper agent not more than twenty days after completion of well. Follow instructions in the Rules and Regulations of the Commission. Indicate questionable data by following it with (?). SUBMIT IN TRIPLICATE.

Continental Oil Company

Box CC, Hobbs, N.M.

State A-36	Company or Operator	4	SW/4	36	Address	20S
37E	Well No.	4	in	36	of Sec.	T
4620	Lease	Eunice	Field	Lea	County	
	N. M. P. M.					
	Well is	4620	feet south of the North line and	3300	feet west of the East line of	Sec. 36
	If State land the oil and gas lease is No.		Assignment No.			
	If patented land the owner is		Address			
	If Government land the permittee is		Address			
	The Lessee is	Continental Oil Company	Address	Box CC, Hobbs, N.M.		
	Drilling commenced	8-18-40	Drilling was completed	10-6-40		
	Name of drilling contractor	Lyons & Miller	Address	Hobbs, N.M.		
	Elevation above sea level at top of casing	3489	feet			
	The information given is to be kept confidential until			19		

## OIL SANDS OR ZONES

No. 1, from	3638	to	3780	No. 4, from		to	
No. 2, from		to		No. 5, from		to	
No. 3, from		to		No. 6, from		to	

## IMPORTANT WATER SANDS

Include data on rate of water inflow and elevation to which water rose in hole.

No. 1, from		to		feet	
No. 2, from		to		feet	
No. 3, from		to		feet	
No. 4, from		to		feet	

## CASING RECORD

SIZE	WEIGHT PER FOOT	THREADS PER INCH	MAKE	AMOUNT	KIND OF SHOE	CUT & FILLED FROM	PERFORATED		PURPOSE
							FROM	TO	
13-3/8	50	8	SH	159'9"		159'9"			
10-3/4	32.75	8	SH	470'0"		470'0"			
8-5/8	32#	8	SH	888'7"		888'7"			
7"	24#	10	SH	1339'8"		1339'8"			
5 1/2"	17#	8	New	3533'3"	Cement	guide shoe & float collar			
2"	4.70	8	New	3790'5"	Tubing	set at 3771'.			

## MUDDING AND CEMENTING RECORD

SIZE OF HOLE	SIZE OF CASING	WHIRL SET	NO. SACKS OF CEMENT	METHOD USED	MUD GRAVITY	AMOUNT OF MUD USED
6-1/4	5-1/2	3515	900	Halliburton		

## PLUGS AND ADAPTERS

Heaving plug—Material		Length		Depth Set	
Adapters—Material		Size			

## RECORD OF SHOOTING OR CHEMICAL TREATMENT

SIZE	SHELL USED	EXPLOSIVE OR CHEMICAL USED	QUANTITY	DATE	DEPTH SHOT OR TREATED	DEPTH CLEANED OUT
3 1/2"	Risonite	S.N.G.	260 qts	10-7-40	3645-3780	bottom

Results of shooting or chemical treatment	

## RECORD OF DRILL-STEM AND SPECIAL TESTS

If drill-stem or other special tests or deviation surveys were made, submit report on separate sheet and attach hereto.

## TOOLS USED

Rotary tools were used from		feet to		feet, and from		feet to		feet
Cable tools were used from	0	feet to	3810	feet, and from		feet to		feet

## PRODUCTION

Put to producing	10-16-40	19	
The production of the first 24 hours was	84	barrels of fluid of which	100 % was oil; %
emulsion; % water; and		% sediment. Gravity, Be	
If gas well, cu. ft. per 24 hours	185,000	Gallons gasoline per 1,000 cu. ft. of gas	
Rock pressure, lbs. per sq. in.			

## EMPLOYEES

Wilhite	Driller	E. E. Minger	Driller
Frank Smith	Driller		Driller

## FORMATION RECORD ON OTHER SIDE

I hereby swear or affirm that the information given herewith is a complete and correct record of the well and all work done on it so far as can be determined from available records.

Subscribed and sworn to before me this	20th d	Hobbs, N.M.	11-20-40
day of	November	19	40
Name		Position	District Superintendent

# FORMATION RECORD

FROM	TO	THICKNESS IN FEET	FORMATION
0	70		Gyp
70	140		Sand
140	310		Redrock
310	390		Red shale
390	395		Water sand
395	415		Red shale
415	450		Sandy shale
450	460		Water sand
460	470		Red shale
490	495		Blue shale
495	575		Red shale
575	615		Redrock
615	675		Red shale
675	725		Redrock
725	750		Red shale
750	800		Redrock
800	890		Red shale
890	930		Red shale
930	945		Water sand
945	1175		Red sandy shale
1175	1210		Redrock
1210	1265		Red shale
1265	1288		Redrock
1288	1310		Anhydrite
1310	1315		Red shale
1315	1350		Anhydrite
1350	1380		Lime
1380	1425		Anhydrite
1425	1430		Redrock
1430	1450		Salt
1450	1480		Potash
1480	1565		Redrock & salt
1565	1635		Salt
1635	1655		Anhydrite
1655	1665		Redrock
1665	1730		Salt & anhydrite
1730	1770		Anhydrite
1770	1780		Salt
1780	1810		Anhydrite
1810	1825		Salt
1825	1855		Anhydrite
1855	1880		Salt & red shale
1880	1990		Salt
1990	2005		Potash
2005	2080		Salt & potash
2180	2195		Anhydrite
2195	2260		Salt
2260	2285		Anhydrite
2285	2330		Salt & potash
2330	2385		Salt
2385	2425		Anhydrite
2425	2560		Salt
2560	2610		Lime
2610	2620		Lime & shale
2620	3705		Lime
3705	3709		Blue shale
3709	3762		Lime
3762	3810		Lime.

Total depth 3810'. Plugged back to 3780' with cement. Initial production  $3\frac{1}{2}$  bbls oil hourly on a 6 hour test thru a  $3/4$ " choke on 2" tubing with 185 MCF gas. Well was shot with 260 qts SNG from 3645 to 3780' on 10-7-40. Was not acidized. Pay: 3638-3780.

Shell Pipe Line Co. connected and running top allowable effective 10-16-40.

All measurements are from derrick floor which is 4' above ground level.

HLJ:FP  
Hobbs - 11-20-40