

NEW MEXICO
OIL CONSERVATION COMMISSION

Form C-128

Well Location and/or Gas Protection Plat

HOBBS

1956 OCT

UCC

Date 10-1-56

Operator Continental Oil Co.

Lease State A-36

Well No. 8 Section 36 Township 20 South Range 37 East NMPM

Located 1980 Feet From South Line, 1980 Feet From East Line,

Lea County, New Mexico. G. L. Elevation

Name of Producing Formation Pool Dedicated Acreage

(Note: All distances must be from outer boundaries of Section)

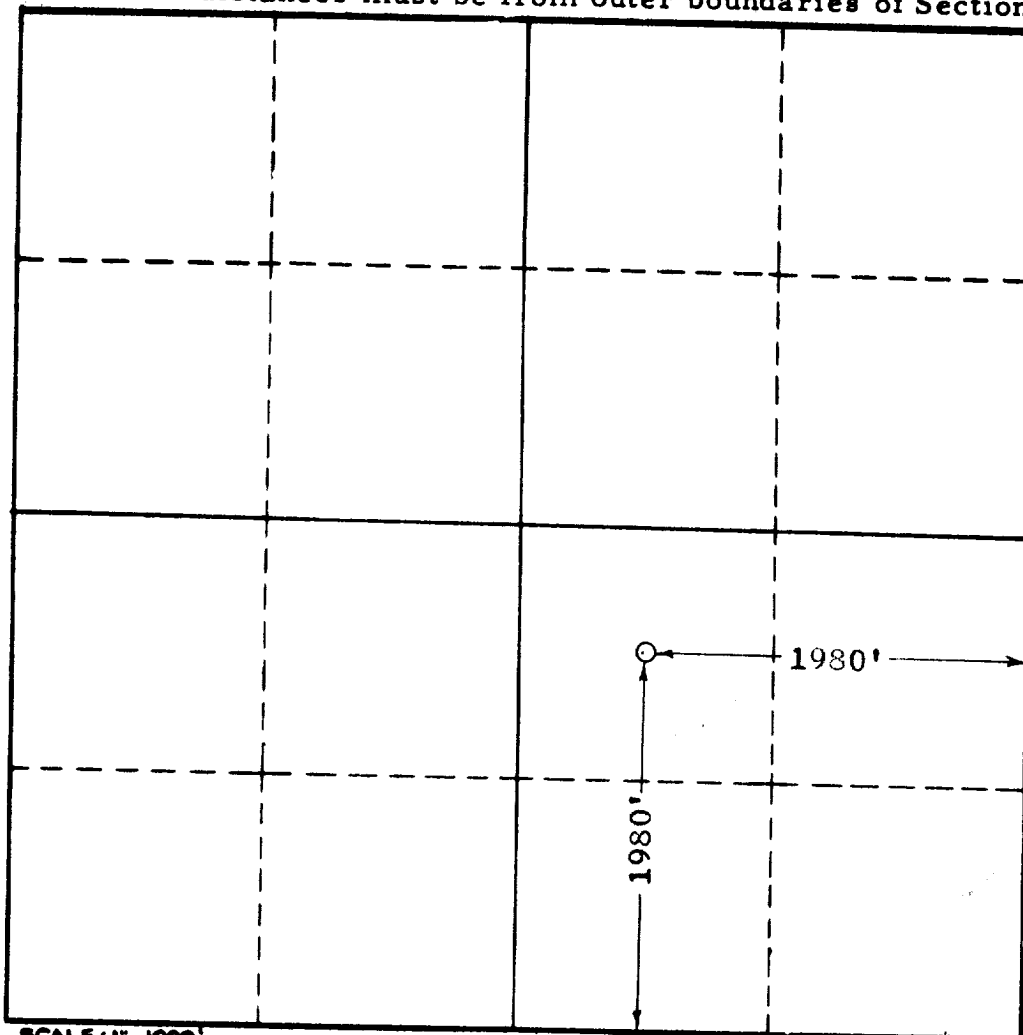

SCALE: 1" = 1000'

1. Is this Well a Dual Comp. ? Yes ___ No ___.
2. If the answer to Question 1 is yes, are there any other dually completed wells within the dedicated acreage? Yes ___ No ___.

This is to certify that the above plat was prepared from field notes of actual surveys made by me or under my supervision and that the same are true and correct to the best of my knowledge and belief.

Name _____
Position _____
Representing _____
Address _____

Date Surveyed 10-1-56

Registered Professional Engineer and/or Land Surveyor *John W. West*