

Form 9-331
Dec. 1973Form Approved.
Budget Bureau No. 42-R1424UNITED STATES
DEPARTMENT OF THE INTERIOR
GEOLOGICAL SURVEY

SUNDRY NOTICES AND REPORTS ON WELLS

(Do not use this form for proposals to drill or to deepen or plug back to a different reservoir. Use Form 9-331-C for such proposals.)

1. oil ☒ gas ☐ other ☐
well well

2. NAME OF OPERATOR

Conoco Inc.

3. ADDRESS OF OPERATOR

P.O. Box 460, Hobbs, N.M. 88240

4. LOCATION OF WELL (REPORT LOCATION CLEARLY. See space 17 below.)

AT SURFACE: 1980' FSL & 990' FEL

AT TOP PROD. INTERVAL: same

AT TOTAL DEPTH: same

16. CHECK APPROPRIATE BOX TO INDICATE NATURE OF NOTICE, REPORT, OR OTHER DATA

REQUEST FOR APPROVAL TO:

SUBSEQUENT REPORT OF:

TEST WATER SHUT-OFF ☐FRACTURE TREAT ☐SHOOT OR ACIDIZE ☐REPAIR WELL ☐PULL OR ALTER CASING ☐MULTIPLE COMPLETE ☐CHANGE ZONES ☐ABANDON* ☐(other) Re-enter well & complete in Blinbry ☒

RECEIVED

DEC 21 1979

(NOTE: Report results of multiple completion or zone change on Form 9-330.)

17. DESCRIBE PROPOSED OR COMPLETED OPERATIONS (Clearly state all pertinent details, and give pertinent dates, including estimated date of starting any proposed work. If well is directionally drilled, give subsurface locations and measured and true vertical depths for all markers and zones pertinent to this work.)*

It is proposed to re-enter subject well & complete it in the Blinbry zone as follows: 6 1/4" w/ 4 3/4" bit & csg. scraper. Circ. hole clean w/ TFW to 5459'. Drillout cement plug & co to 6080'. Pressure test csg. Spot 252 gal. 15% HCl-NE-FE from 6006' to 5754'. Perf. Blinbry zone @ 5755', 5757', 5765', 5769', 5782', 5786', 5789', 5816', 5818', 5823', 5863', 5875', 5897', 5903', 5919', 5922', 5925', 5938', 5982', 5989', 5993', 5996, 6006' (24 holes). Establish injection into perfs. Acid frac Blinbry perfs from 5755' to 6006' in 3 stages w/ 39,000 gal. 28% HCl-NE-FE. Flush w/ 3000 gal. 2% KCl water. Swab well 6 1/4" w/ 2 3/8", 4.7", J-55 tbg., setting tbg. at 6060'.

Subsurface Safety Valve: Manu. and Type

Set @ _____ Ft.

18. I hereby certify that the foregoing is true and correct

SIGNED

Wm. A. Butterfield

TITLE Admin. Supervisor

DATE

12/10/79

(This space for Federal or State office use)

APPROVED BY

TITLE

DATE

CONDITIONS OF APPROVAL, IF ANY:

USGS -5
NMFU -4
FILE

APPROVED

DEC 21 1979

ACTING DISTRICT ENGINEER

**NEW MEXICO OIL CONSERVATION COMMISSION
WELL LOCATION AND ACREAGE DEDICATION PLAT**

Form C-102
Supersedes C-128
Effective 1-1-65

All distances must be from the outer boundaries of the Section.

Operator Conoco Inc.			Lease SEMU		Well No. 82
Unit Letter I	Section 25	Township 20 South	Range 37 East	County Lea	
Actual Footage Location of Well: 1980 feet from the South line and 990 feet from the East line					
Ground Level Elev: 3515'	Producing Formation Blinberry		Pool Blinberry Oil & Gas		Dedicated Acreage: 40 Acres

1. Outline the acreage dedicated to the subject well by colored pencil or hachure marks on the plat below.
2. If more than one lease is dedicated to the well, outline each and identify the ownership thereof (both as to working interest and royalty).
3. If more than one lease of different ownership is dedicated to the well, have the interests of all owners been consolidated by communitization, unitization, force-pooling, etc?

☐ Yes ☐ No If answer is "yes," type of consolidation _____

If answer is "no," list the owners and tract descriptions which have actually been consolidated. (Use reverse side of this form if necessary.) _____

No allowable will be assigned to the well until all interests have been consolidated (by communitization, unitization, forced-pooling, or otherwise) or until a non-standard unit, eliminating such interests, has been approved by the Commission.

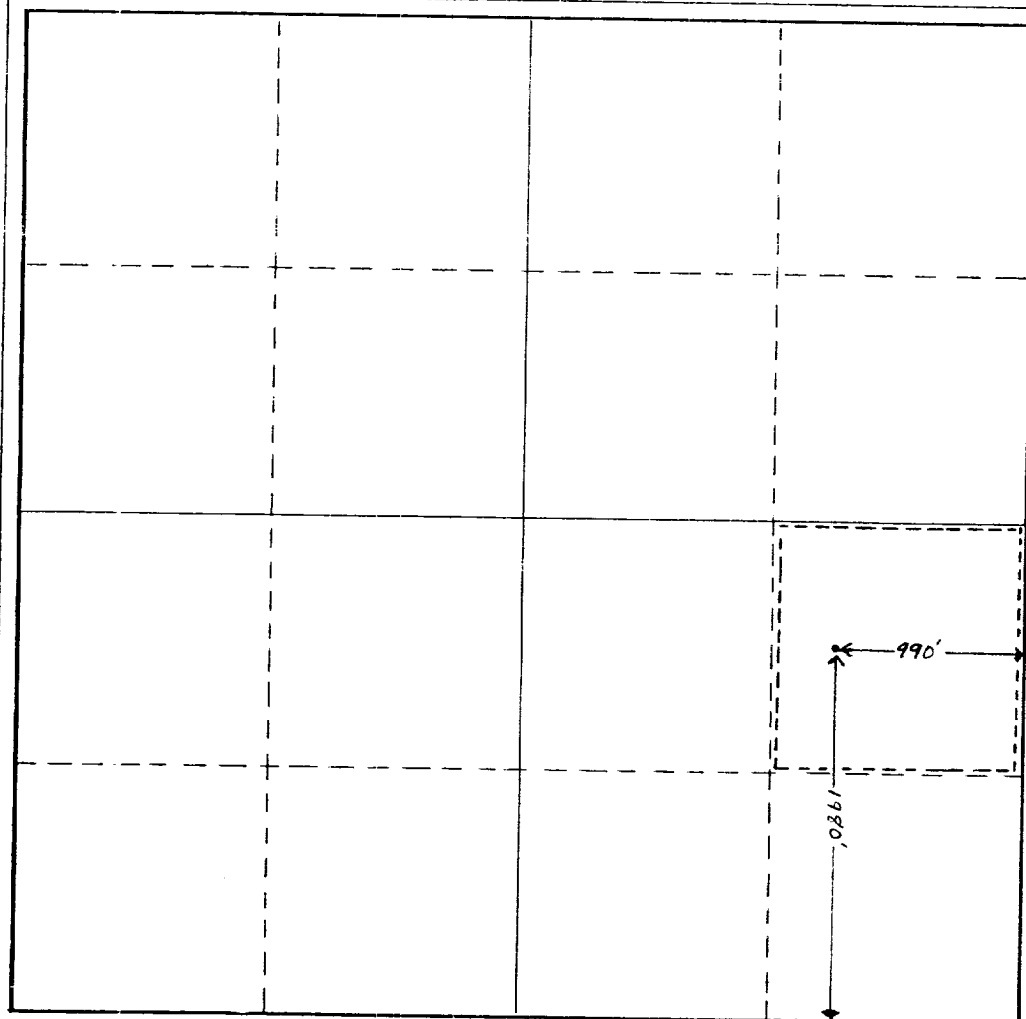

CERTIFICATION

I hereby certify that the information contained herein is true and complete to the best of my knowledge and belief.

Name **John A. Butterfield**
Position **Administrative Supervisor**
Company **Conoco Inc.**
Date **12/18/79**

I hereby certify that the well location shown on this plat was plotted from field notes of actual surveys made by me or under my supervision, and that the same is true and correct to the best of my knowledge and belief.

Date Surveyed _____

Registered Professional Engineer and/or Land Surveyor

Certificate No. _____