

COUNTY	LEA	FIELD	Blinebry/Tubb/	STATE	N.	OWWO
OPR	SINCLAIR OIL & GAS CO.		/Drinkard		MAP	
2 Cone, J. R. "A"						
Sec. 26, T-21-S, R-37-E						
1980' fr S Line & 660' fr W Line of Sec.						
Re-Spud 10-7-64						
		CLASS		EL		
Re-Comp 12-2-64 (B & T)		FORMATION	DATUM	FORMATION	DATUM	
CSG & SX - TUBING						
13 3/8" 277' 300						
9 5/8" 2803' 1000						
7" 6553' 400						
LOGS EL GR RA IND HC A						
		TD 6553', PBD 6550'				
IP Blinebry Perfs 5695-5902' Flwd 60 BOPD. Pot. Based on 24 hr test thru 24/64" chk., TP 200#, gravity 40., GOR 4500.						
IP Tubb Gas Perfs 6078-6174' Flwd 763 MCFGPD + 15 BO thru 18/64" chk., CP 500#, 4 hr SICP 600#.						
NOW TRIPLE COMPLETE W/DRINKARD PERFS 6488-6550'						
Distribution limited and publication prohibited by subscribers' agreement. Reproduction rights reserved by Williams & Lee Scouting Service, Inc.						
CONT.	PROP DEPTH			TYPE		
DATE						

1-18-65 F.R.C. 1-21-65; OWWO, OTD 6553'
 Orig comp from Blinebry Gas Perfs 5492-5630'
 & Drinkard perfs 6404-15' & 6488-6550'.
 TD 6553', PBD 6550', COMPLETED.
 Squeezed Blinebry Gas Perfs 5492-5630' W/300 sx.
 Re-Squeezed w/250 sx.
 DO to 6205'
 Perf 6204-05' W/4 shots
 Squeezed perf 6204-05' W/580 sx.
 Perf 6026-27' W/4 shots
 Squeezed perf 6026-27' W/240 sx.
 Drld Out
 Frac 20,000 gals oil + 20,000# sd. (6404-6550')
 Flwd load &
 Flwd 60 BNO in 8 hrs thru 12/64" to 24/64" chk.,
 TP 1300-1500#.

1-18-65

- cont. -

Delta logs indicate gas entry 6404-15' &
Very little above perfs

Squeezed Drinkard Perfs 6404-15' W/85 sx.
DO to 6550'

Perf (Tubb) 6078-6110', 6123-28', 6142-46',
6150-52', 6162-66', 6172-74' W/66 shots

Ac. 3000 gals. 6078-6174'

Perf (Blinebry) @ 5695', 5715', 5734', 5743',
5767', 5770', 5783', 5795', 5800', 5810',
5825', 5838', 5848', 5889', 5896', 5902'

W/36 shots

Ac. 1750 gals., 5695-5902'.

Frac 20,000 gals oil + 20,000# sd. 6488-6550'.

Flwd 31 BNO in 24 hrs thru 24/64" chk., TP 75#,
gravity 35.7, GOR 870.

NEW MEXICO OIL CONSERVATION COMMISSION
WELL LOCATION AND ACREAGE DEDICATION PLAT

Form C-102
Supersedes C-128
Effective 1-1-65

All distances must be from the outer boundaries of the Section.

Operator Sinclair Oil & Gas Company			Lease J. R. Cone "A"		Well No. 2
Unit Letter L	Section 26	Township 21 South	Range 37 East	County Lea	
Actual Footage Location of Well: 1980 feet from the South line and 660 feet from the West line					
Ground Level Elev:	Producing Formation Tubb	Pool Tubb Gas		Dedicated Acreage: 160 Acres	

1. Outline the acreage dedicated to the subject well by colored pencil or hachure marks on the plat below.
2. If more than one lease is dedicated to the well, outline each and identify the ownership thereof (both as to working interest and royalty).
3. If more than one lease of different ownership is dedicated to the well, have the interests of all owners been consolidated by communitization, unitization, force-pooling, etc?

☒ Yes ☐ No If answer is "yes," type of consolidation Operating Agreement dated 12-10-57

If answer is "no," list the owners and tract descriptions which have actually been consolidated. (Use reverse side of this form if necessary.)

No allowable will be assigned to the well until all interests have been consolidated (by communitization, unitization, forced-pooling, or otherwise) or until a non-standard unit, eliminating such interests, has been approved by the Commission.

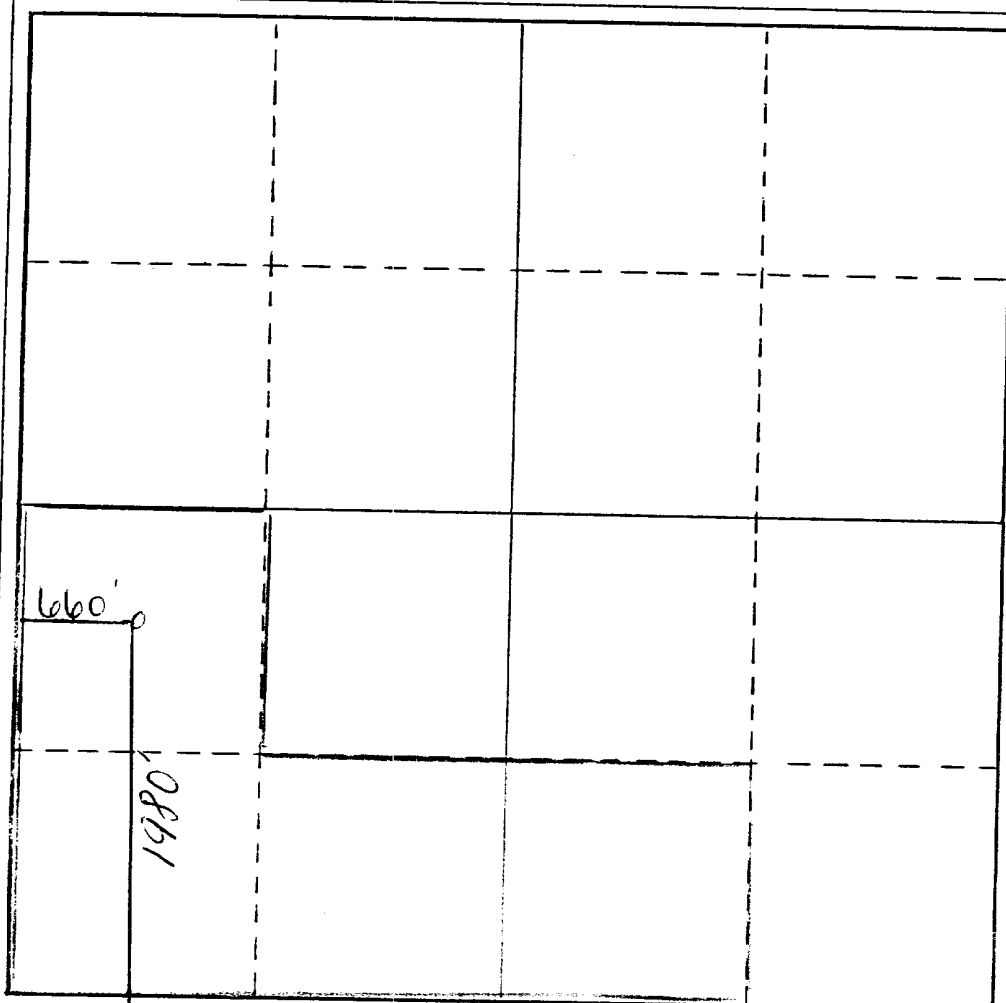

CERTIFICATION

I hereby certify that the information contained herein is true and complete to the best of my knowledge and belief.

Name [Signature]
Position
Prod. Clerk
Company
Sinclair Oil & Gas Company
Date
January 6, 1965

[Signature] [Signature]
I hereby certify that the well location shown on this plat was plotted from field notes of actual surveys made by me or under my supervision, and that the same is true and correct to the best of my knowledge and belief.

Date Surveyed

Registered Professional Engineer
and/or Land Surveyor

Certificate No.

0 330 660 990 1320 1650 1980 2310 2640 2000 1500 1000 500 0

NUMBER OF COPIES RECEIVED	
DISTRIBUTION	
SANTA FE	
PIRE	
U.S.G.S.	
LAND OFFICE	
TRANSPORTER	
PRORATION OFFICE	
OPERATOR	

NEW MEXICO OIL CONSERVATION COMMISSION
WELL LOCATION AND ACREAGE DEDICATION PLAT
 SEE INSTRUCTIONS FOR COMPLETING THIS FORM ON THE REVERSE SIDE.

FORM C-128
 Revised 5/1/57

SEP 10 11 42 AM '64

SECTION A					
Operator Sinclair Oil & Gas Company			Lease J. R. Cone "A"		Well No. 2
Unit Letter L	Section 26	Township 21-S	Range 37-E	County Lea	
Actual Footage Location of Well: 1980 feet from the South line and 660 feet from the West line					
Ground Level Elev. 1980	Producing Formation Blinberry		Pool Blinberry Gas	Dedicated Acreage: 80 Acres	

1. Is the Operator the only owner in the dedicated acreage outlined on the plat below? YES **X** NO ____ . ("Owner" means the person who has the right to drill into and to produce from any pool and to appropriate the production either for himself or for himself and another. (65-3-29 (e) NMSA 1935 Comp.)
2. If the answer to question one is "no," have the interests of all the owners been consolidated by communitization agreement or otherwise? YES ____ NO ____ . If answer is "yes," Type of Consolidation ____
3. If the answer to question two is "no," list all the owners and their respective interests below:

Owner	Land Description

SECTION B

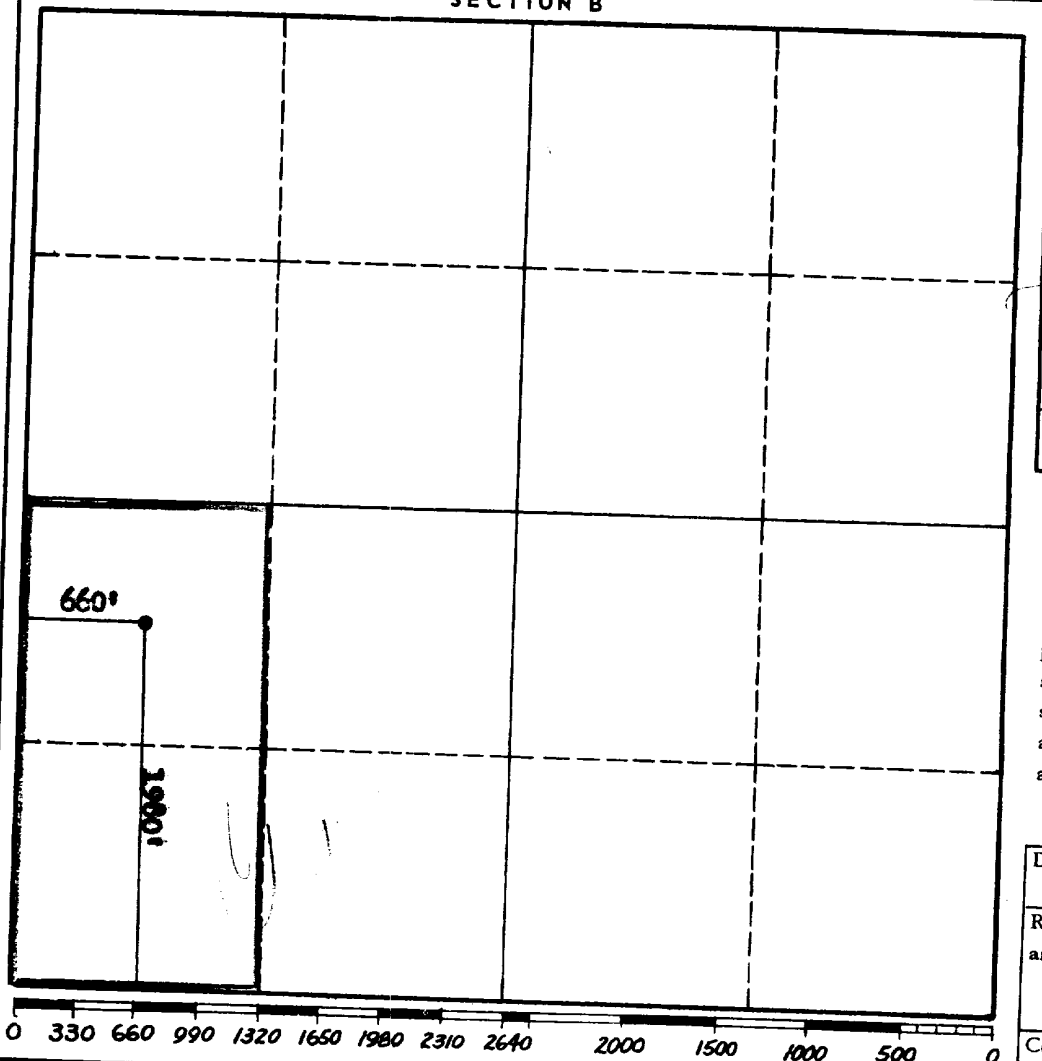

CERTIFICATION

I hereby certify that the information in SECTION A above is true and complete to the best of my knowledge and belief.

Name <i>[Signature]</i>
Position District Superintendent
Company Sinclair Oil & Gas Company
Date May 11, 1964

I hereby certify that the well location shown on the plat in SECTION B was plotted from field notes of actual surveys made by me or under my supervision, and that the same is true and correct to the best of my knowledge and belief.

Date Surveyed
Registered Professional Engineer and/or Land Surveyor
Certificate No.

INSTRUCTIONS FOR COMPLETION OF FORM C-128

1. Operator shall furnish and certify to the information called for in Section A.
2. Operator shall outline the dedicated acreage for *both* oil and gas wells on the plat in Section B.
3. A registered professional engineer or land surveyor registered in the State of New Mexico or approved by the Commission shall show on the plat the location of the well and certify this information in the space provided.
4. All distances shown on the plat must be from the outer boundaries of the Section.
5. If additional space is needed for listing owners and their respective interests as required in question 3 of Section A, please use space below.

NEW MEXICO OIL CONSERVATION COMMISSION
Well Location and Acreage Dedication Plat

Form C-128
Revised 5/1/57

Section A.

Date March 14, 1958

Operator Sinclair Oil & Gas Company Lease J. R. Cone Blinbry Unit
Well No. 2-A Unit Letter L Section 26 Township 21-South Range 37-East NMPM
Located 1980 Feet From South Line, 660 Feet From West Line
County Lea G. L. Elevation 3385 Dedicated Acreage 160 Acres
Name of Producing Formation Blinbry Pool Blinbry Gas Pool

1. Is the Operator the only owner* in the dedicated acreage outlined on the plat below?
Yes _____ No X
2. If the answer to question one is "no," have the interests of all the owners been consolidated by communitization agreement or otherwise? Yes _____ No X. If answer is "yes," Type of Consolidation _____
3. If the answer to question two is "no," list all the owners and their respective interests below:

Owner

Land Description

Sinclair Oil & Gas Company *

144,317/154,000 interest

J. R. Cone *

9,625/154,000 interest

J. H. Atwood

58/154,000 interest

Section B *The Sinclair Oil & Gas Company and J. R. Cone interests are consolidated by Joint Operating Agreement

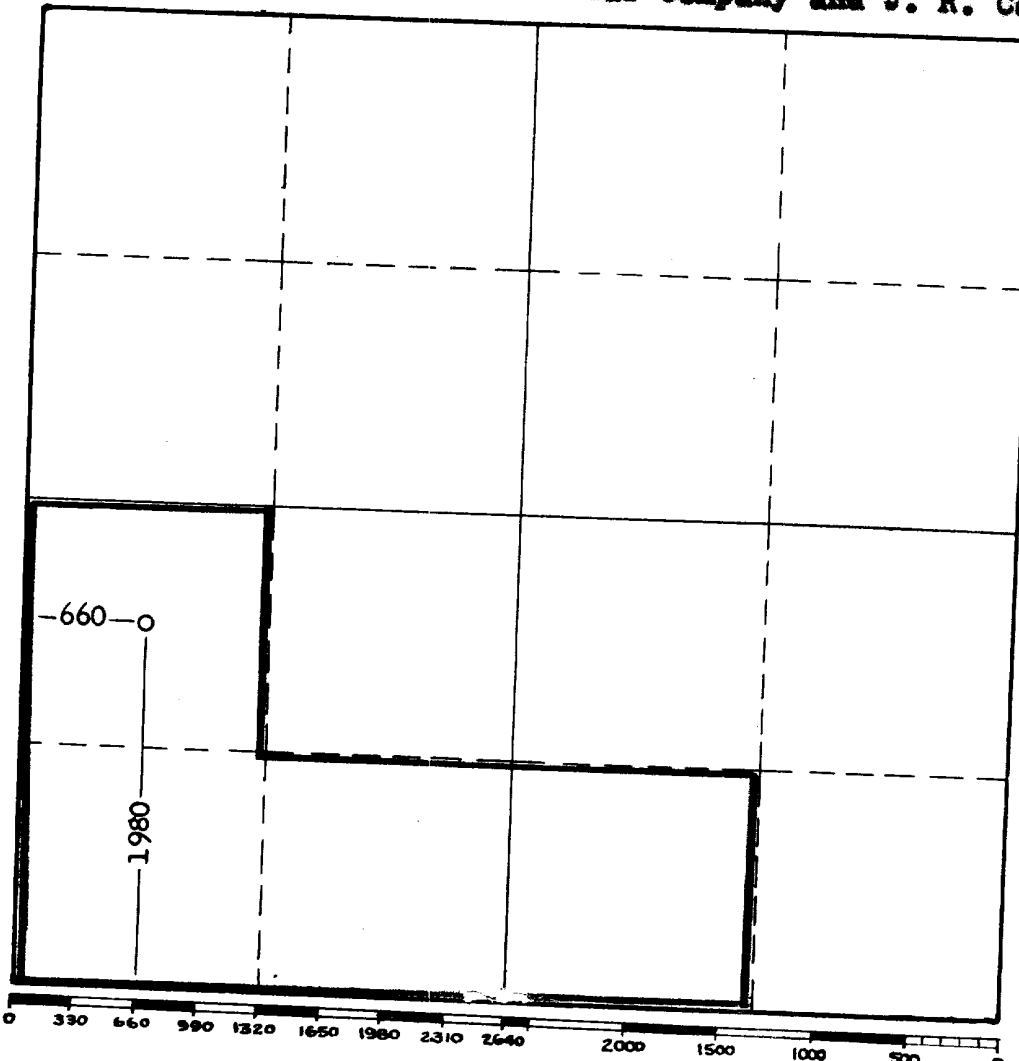

This is to certify that the information in Section A above is true and complete to the best of my knowledge and belief.

Sinclair Oil & Gas Company
(Operator) [Signature]
(Representative) [Signature]
P. O. Box 1470
Midland, Texas
Address

This is to certify that the well location shown on the plat in Section B was plotted from field notes of actual surveys made by me or under my supervision and that the same is true and correct to the best of my knowledge and belief.
Date Surveyed _____

AMENDED
Registered Professional
Engineer and/or Land Surveyor.

(See instructions for completing this form on the reverse side)

Certificate No. _____

INSTRUCTIONS FOR COMPLETION:

1. Operator shall furnish and certify to the information called for in Section A.
2. Operator shall outline the dedicated acreage for both oil and gas wells on the plat in Section B.
3. A registered professional engineer or land surveyor registered in the State of New Mexico or approved by the Commission shall show on the plat the location of the well and certify this information in the space provided.
4. All distances shown on the plat must be from the outer boundaries of Section.
5. If additional space is needed for listing owners and their respective interests as required in question 3, Section A, please use space below

* "Owner" means the person who has the right to drill into and to produce from any pool and to appropriate the production either for himself or for himself and another. (65-3-29 (e) NMSA 1953 Comp.)

NEW MEXICO
OIL CONSERVATION COMMISSION

Gas Well Plat

Sinclair Oil & Gas Company
Operator

J. R. Cone "A"
Lease

Date September 30, 1955

2
Well No.

Name of Producing Formation Elinebry Pool Elinebry Gas

No. Acres Dedicated to the Well 80

SECTION 26 TOWNSHIP 21 - S RANGE 37 - E

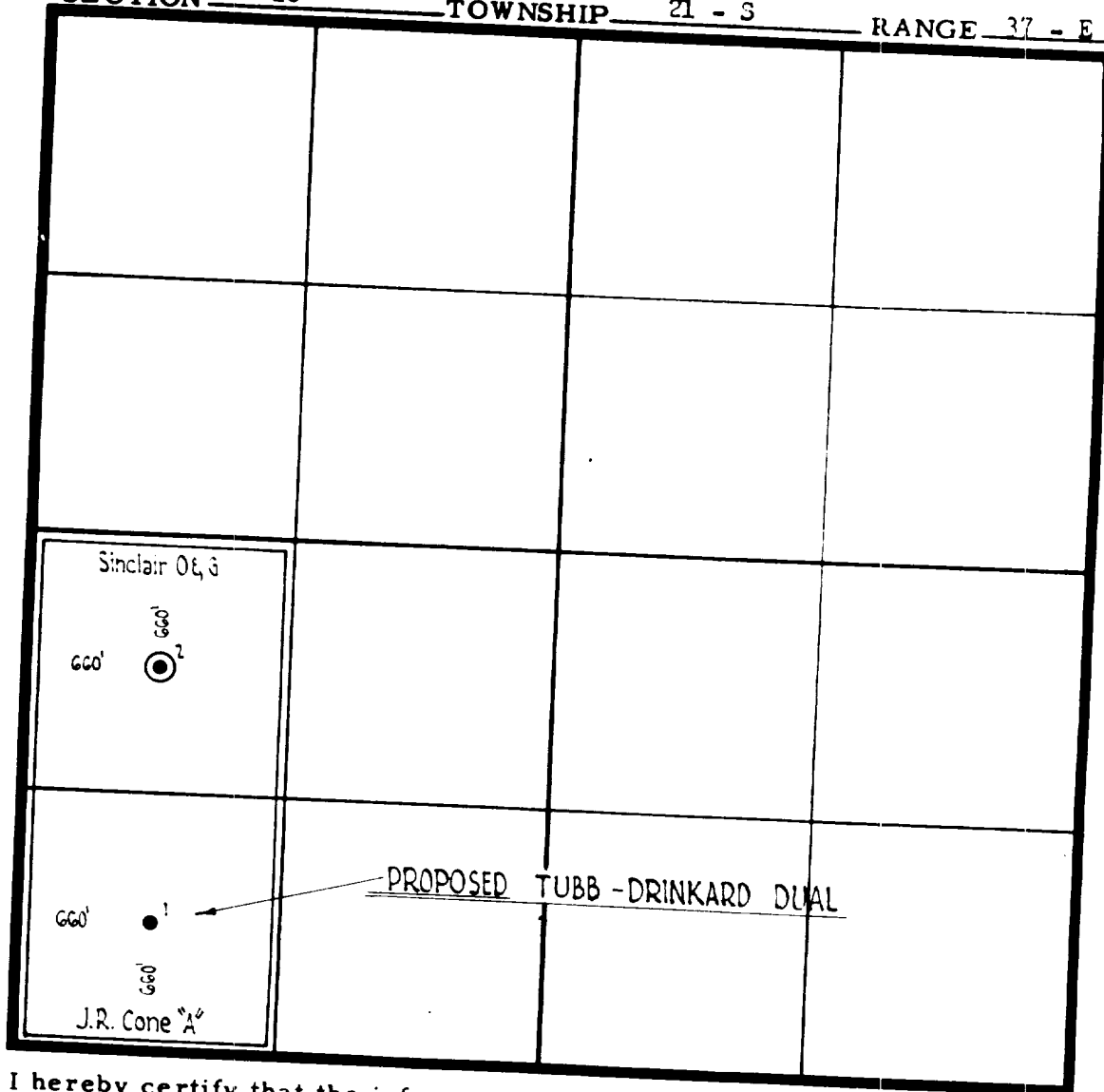

I hereby certify that the information given above is true and complete to the best of my knowledge.

1. If this gas well a dual completion?

Yes X No

2. Are there any other dually completed wells within the dedicated acreage?

Yes X No

Name J. R. Cone
Position Petroleum Engineer
Representing Sinclair Oil & Gas Company
Address Fort Worth, Texas

(over)

oil 62%
gas 8%

oil 38%
gas 92%

Mc. 779 Blinburg O+G + Drinkard (max oil prod. 40 bopd gas 428 mcs/d)

SE # 3386 (Ch. of Lee, Tenn)

SE # 3339 Tubb allow Case

R-2854-A acreage dedicated to J L Case B#126-21-37

SE # 3820 allow Case

MC-1530 Bl + Dr oil + Tubt gas 9/2/64

SE # 3006

NSP-691 80 acres NW 1/4 SW 1/4 + SE 1/4 SE 1/4

SE # 2085 Ch of Drinkard

NSP-374 approx 80 acres

W 1/2 SW 1/4 Sec. 26

R-14940 ac NW 1/4 SW 1/4 SE 1/4 SW 1/4

SE # 3039 NW 1/4 SW 1/4 SE 1/4 Sec. 26

SE # 217 NW 1/4 SW 1/4 SE 1/4 + SE 1/4 SE 1/4 Sec. 26