

Submit to appropriate
District Office
State Lease-4 copies
Fee Lease-3 copies

State of New Mexico
Energy, Minerals and Natural Resources Department

Form C-102
Revised 1-1-89

OIL CONSERVATION DIVISION

P.O. Box 2088
Santa Fe, New Mexico 87504-2088

Well file

DISTRICT I
P.O. Box 1080, Hobbs, NM 88240

DISTRICT II
P.O. Drawer 00, Artesia, NM 88210

DISTRICT III
1000 Rio Brazos Rd., Aztec, NM 87410

WELL LOCATION AND ACREAGE DEDICATION PLAT

All distances must be from the outer boundaries of the Section.

Operator Exxon Corporation			Lease F.F. HARDISON "B"		Well No. 8
Unit Letter I	Section 27	Township 21S	Range 37E	County NMPM LEA	
Actual Footage Location of Well: 1980 feet from the SOUTH line and 660 feet from the EAST line.					
Ground level Elev. 3393'	Producing Formation BLINEBRY	Pool BLINEBRY (PRO GAS)(CONSOLIDATED)		Dedicated Acreage: 120 Acres	
<p>1. Outline the acreage dedicated to the subject well by colored pencil or hatchure marks on the plat below.</p> <p>2. If more than one lease is dedicated to the well, outline each and identify the ownership thereof (both as to working interest and royalty).</p> <p>3. If more than one lease of different ownership is dedicated to the well, have the interest of all owners been consolidated by communization, unitization, force-pooling, etc.?</p> <p><input type="checkbox"/> Yes <input type="checkbox"/> No - If answer is "yes", type of consolidation _____</p> <p>If answer is "no", list the owners and tract descriptions which have actually been consolidated. (Use reverse side of this form if necessary.) _____</p> <p>No allowable will be assigned to the well until all interests have been consolidated (by communization, unitization, forced-pooling, or otherwise) or until a non-standard unit, eliminating such interest, has been approved by the Division.</p>					
				OPERATOR CERTIFICATION I hereby certify that the information contained herein is true and complete to the best of my knowledge and belief.	
				Signature <i>C.H. Harper</i> Printed Name C.H. HARPER Position PERMITS SUPERVISOR Company Exxon Corporation P.O. Box 1600-Midland, Tx.-79702 Date 11-16-93	
R-10062				SURVEYOR CERTIFICATION I hereby certify that the well location shown on this plat was plotted from field notes of actual surveys made by me or under my supervision, and that the same is true and correct to the best of my knowledge and belief.	
				Date Surveyed 11/2/76 Signature & Seal of Professional Surveyor Certificate No. _____	

0 330 660 990 1320 1650 1980 2310 2640 2000 1500 1000 500 0

C.E. File No. **8104728**

Exxon Les. No. 267

NEW MEXICO OIL CONSERVATION COMMISSION

Form C-102
Supersedes C-128
Effective 1-4-65

State Les. No. _____ WELL LOCATION AND ACREAGE DEDICATION PLAT

Federal Les. No. _____ All distances must be from the outer boundaries of the Section

Operator Exxon Corporation			Lease F. F. Hardison "B"		Well No. 8
Unit Letter I	Section 27	Township 21-S	Range 37-E	County Lea	
Actual Footage Location of Well: 1980 feet from the South line and 660 feet from the East line					
Ground Level Elev. 3393	Producing Formation Upper Clearfork		Pool Blinebry		Dedicated Acreage: 120 Acres

1. Outline the acreage dedicated to the subject well by colored pencil or hatchure marks on the plat below. Well No. 7 and Well No. 8 to share 120 acre proration unit.
2. If more than one lease is dedicated to the well, outline each and identify the ownership thereof (both as to working interest and royalty).
3. If more than one lease of different ownership is dedicated to the well, have the interests of all owners been consolidated by communitization, unitization, force-pooling, etc?

☐ Yes ☐ No If answer is "yes," type of consolidation _____

If answer is "no," list the owners and tract descriptions which have actually been consolidated. (Use reverse side of this form if necessary.) _____

No allowable will be assigned to the well until all interests have been consolidated (by communitization, unitization, forced-pooling, or otherwise) or until a non-standard unit, eliminating such interests, has been approved by the Commission.

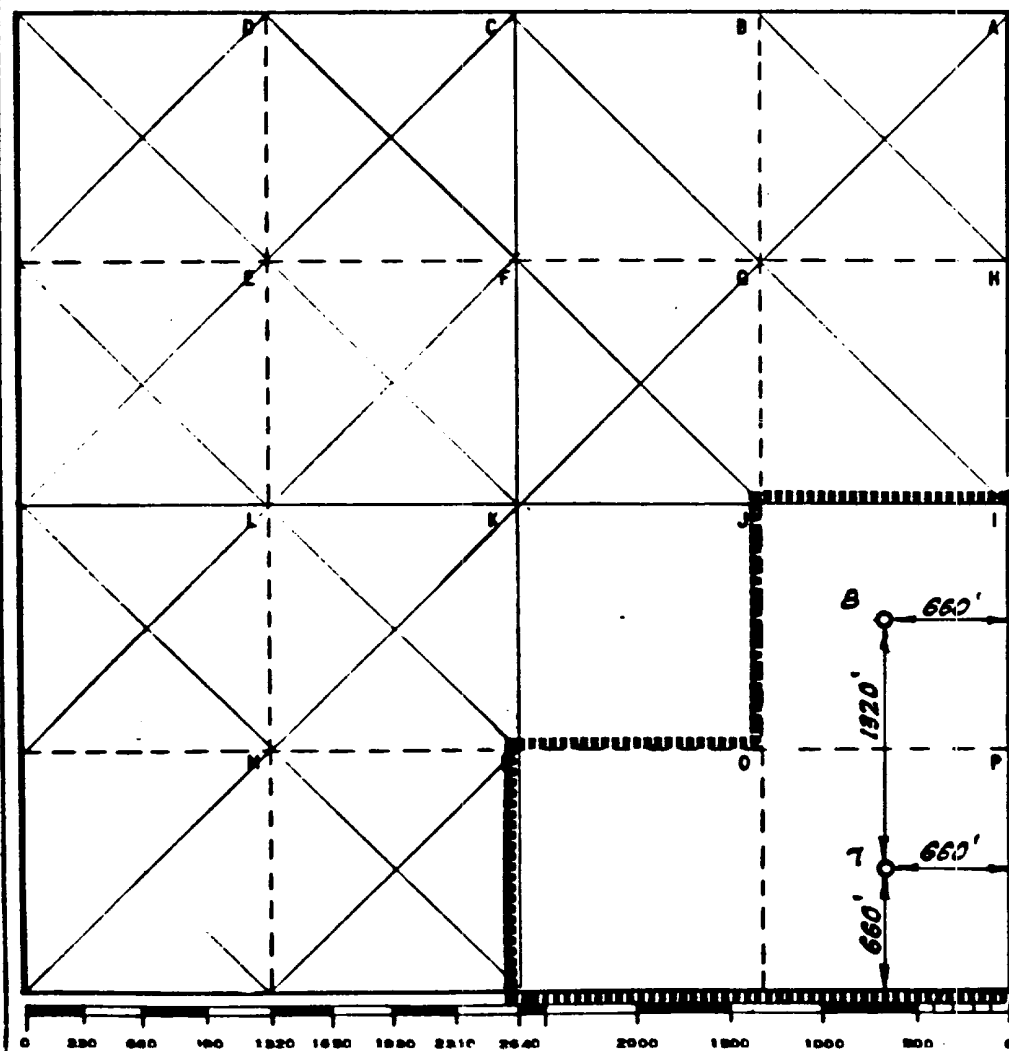

CERTIFICATION

I hereby certify that the information contained herein is true and complete to the best of my knowledge and belief.

Name

Melba Kripling

Position

Proration Specialist

Company Exxon Corporation

Box 1600 Midland, Texas

Date

11-2-76

I hereby certify that the well location shown on this plat was plotted from field notes of actual surveys made by me or under my supervision, and that the same is true and correct to the best of my knowledge and belief.

Date Surveyed

June 5, 1974

Registered Professional Engineer
and/or Land Surveyor*H. L. Hesterfeld*

Certificate No.

1382

NEW MEXICO
OIL CONSERVATION COMMISSION

Gas Well Plat

Date FEB. 26, 1954

HUMBLE OIL & REFINING CO.

Operator

FF HARDISON ET AL "B"

Lease

8

Well No.

(DRINKARD OIL)

Name of Producing Formation BLINEBRY GAS Pool BLINEBRY

No. Acres Dedicated to the Well 160

SECTION 27 TOWNSHIP T-21-S RANGE R-37-E

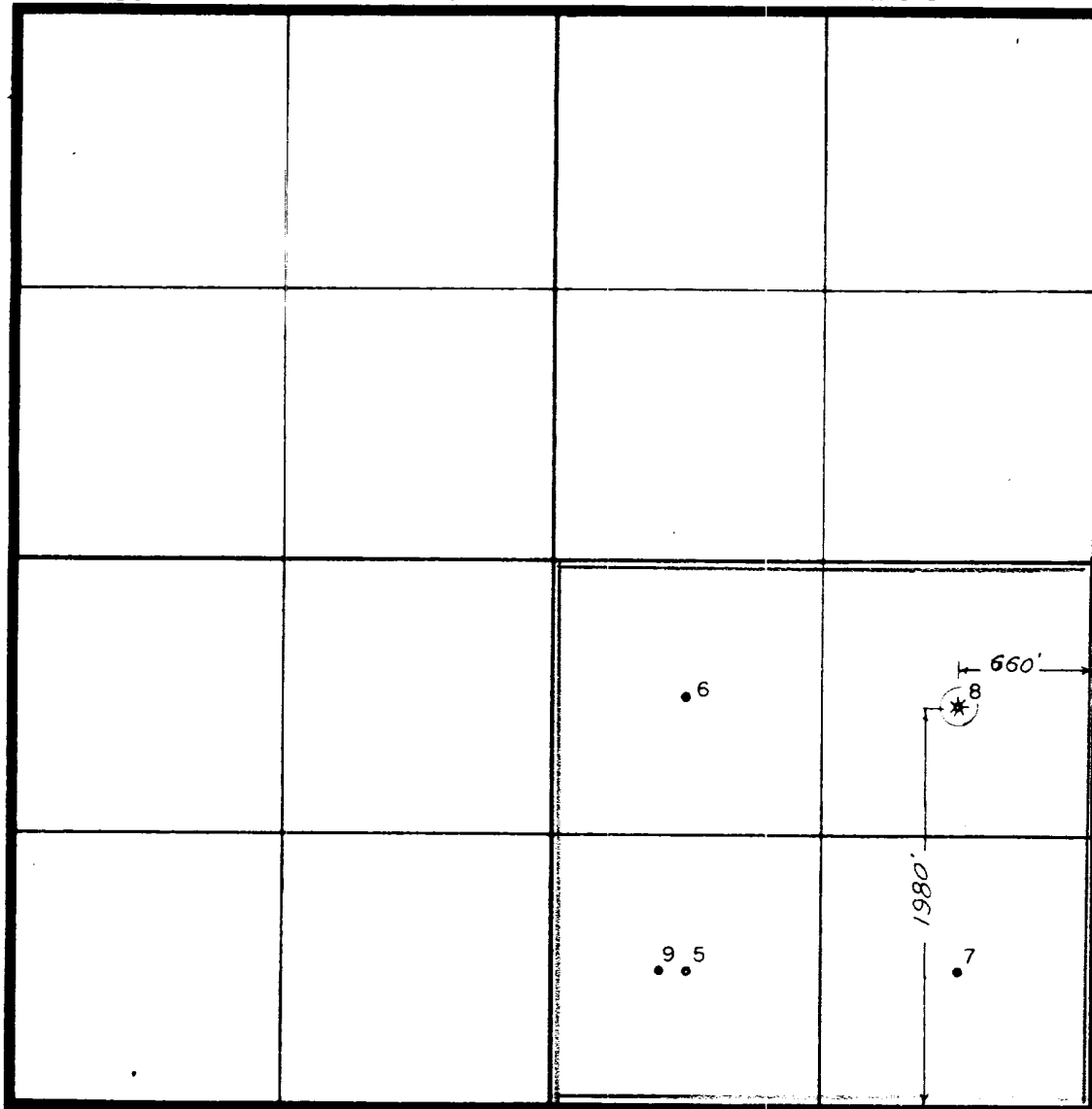

I hereby certify that the information given above is true and complete to the best of my knowledge.

1. Is this gas well a dual completion? Yes No
2. Are there any other dually completed wells within the dedicated acreage? Yes No

Name [Signature]
Position [Signature]
Representing [Signature]
Address Box 100, El Paso, Texas

When re-ordering, specify --

Oxford

STOCK No. 7731/

MADE IN U. S. A.

SD-29-17
12/13/99

120 ac Blinebry Gas, N/2 SE/4 +
SE/4 SE/4 shares w #6-J + 7-P

R-10062

120 ac NW/4 SE/4, NE/4 SE/4, +
SE/4 SE/4 Sec 27 shares w #7

	Dil	Gas
	12%	86% 41%
Blinebry	88%	14% 59%
Drinkard		

DNC-777 Blinebry + Drinkard (MCA 40 BOPD - gas as alloc. in gas schedule)
alloc formula to be set by Dist

NSP-1482 (SP) Blinebry 120 ac Sec. 27 NE/4 SE/4 + S/2 SE/4 shares w #7

SE#4985 Acreage reduced to 120 due to Comp. #6 fac bl. de
Blinebry to produce #7 + #8 on same 160 ac. 11/1/89