

NO. OF COPIES RECEIVED	
DISTRIBUTION	
SANTA FE	
FILE	
U.S.G.S.	
LAND OFFICE	
OPERATOR	

NEW MEXICO OIL CONSERVATION COMMISSION

Form C-101
Revised 1-1-65

5A. Indicate Type of Lease	
STATE <input type="checkbox"/>	FEE <input checked="" type="checkbox"/>
5. State Oil & Gas Lease No.	

APPLICATION FOR PERMIT TO DRILL, DEEPEN, OR PLUG BACK

1a. Type of Work		7. Unit Agreement Name	
b. Type of Well DRILL <input type="checkbox"/> DEEPEN <input type="checkbox"/> ReComplete PLUG BACK <input checked="" type="checkbox"/>		8. Farm or Lease Name	
OIL WELL <input type="checkbox"/> GAS WELL <input type="checkbox"/> OTHER <input type="checkbox"/> SINGLE ZONE <input type="checkbox"/> MULTIPLE ZONE <input type="checkbox"/>		J. N. Carson ACT-A	
2. Name of Operator		9. Well No.	
Chevron U.S.A. Inc.		10	
3. Address of Operator		10. Field and Pool, or Wildcat	
P.O. Box 670, Hobbs, NM 88240		Blinebry Oil & Gas	
4. Location of Well UNIT LETTER <u>J</u> LOCATED <u>2180</u> FEET FROM THE <u>East</u> LINE		12. County	
AND <u>1980</u> FEET FROM THE <u>South</u> LINE OF SEC. <u>28</u> TWP. <u>21S</u> RGE. <u>37E</u> NMPM		Lea	
19. Proposed Depth		19A. Formation	
TD= 7705		Blinebry	
21. Elevations (Show whether DF, RT, etc.)		20. Rotary or C.T.	
3442		---	
21A. Kind & Status Plug. Bond		22. Approx. Date Work will start	
-----		ASAP	

PROPOSED CASING AND CEMENT PROGRAM

SIZE OF HOLE	SIZE OF CASING	WEIGHT PER FOOT	SETTING DEPTH	SACKS OF CEMENT	EST. TOP
	13 3/8		222	325	
	9 5/8	36#	2800	1300	
	7	23#	7570	700	

It is proposed to plug and abandon the Hare (McKee) and recomplete in the Blinebry as follows: TIH w/bit to $\pm 7300'$. Run GR-CNL-CCL f/7300' to 2500'. Set CIBP at 7250' and cap with 50' cement. Set CIBP at 6000'. Perf Blinebry f/approximately 5700' - 5900' w/4" guns, 1 SPF, 180° phase, .4" diameter premium charge. Total 18 holes. RIH w/pkr w/6' spacing. Straddle each perf and acdz w/2bbls 15% NEFE HCL. If perfs communicate cont. pumping acid. Swab test. Report results prior to frac. RU frac equip. Frac Blinebry perfs w/94,000 gallons 40# Xlink and 180,000 lbs ottawa 20/40 sand at 21BPM, with final 26,000 lbs sand resin coated. Swab until sand cleans up. Return to production.

IN ABOVE SPACE DESCRIBE PROPOSED PROGRAM: IF PROPOSAL IS TO DEEPEN OR PLUG BACK, GIVE DATA ON PRESENT PRODUCTIVE ZONE AND PROPOSED NEW PRODUCTIVE ZONE. GIVE BLOWOUT PREVENTER PROGRAM, IF ANY.

I hereby certify that the information above is true and complete to the best of my knowledge and belief.

Signed M. E. Martin Title Staff Drilling Engr. Date June 8, 1988

(This space for State Use)

ORIGINAL SIGNED BY JEFFREY S. SUTHERLAND

APPROVED BY DISTRICT SUPERVISOR TITLE _____ DATE _____

CONDITIONS OF APPROVAL, IF ANY:

NEW MEXICO OIL CONSERVATION COMMISSION
WELL LOCATION AND ACREAGE DEDICATION PLAT

Form C-102
Supersedes C-128
Effective 1-1-65

All distances must be from the outer boundaries of the Section.

Operator Chevron U.S.A. Inc.			Lease J. N. Carson A NET-A		Well No. 10
Unit Letter J	Section 28	Township 21S	Range 37E	County Lea	
Actual Footage Location of Well: 2180 feet from the East line and 1980 feet from the South line					
Ground Level Elev. 3442	Producing Formation Blinebry Oil & Gas		Pool Blinebry Oil & Gas		Dedicated Acreage 40 Acres

1. Outline the acreage dedicated to the subject well by colored pencil or hachure marks on the plat below.
2. If more than one lease is dedicated to the well, outline each and identify the ownership thereof (both as to working interest and royalty).
3. If more than one lease of different ownership is dedicated to the well, have the interests of all owners been consolidated by communitization, unitization, force-pooling, etc?

☐ Yes ☒ No If answer is "yes," type of consolidation _____

If answer is "no," list the owners and tract descriptions which have actually been consolidated. (Use reverse side of this form if necessary.) _____

No allowable will be assigned to the well until all interests have been consolidated (by communitization, unitization, forced-pooling, or otherwise) or until a non-standard unit, eliminating such interests, has been approved by the Commission.

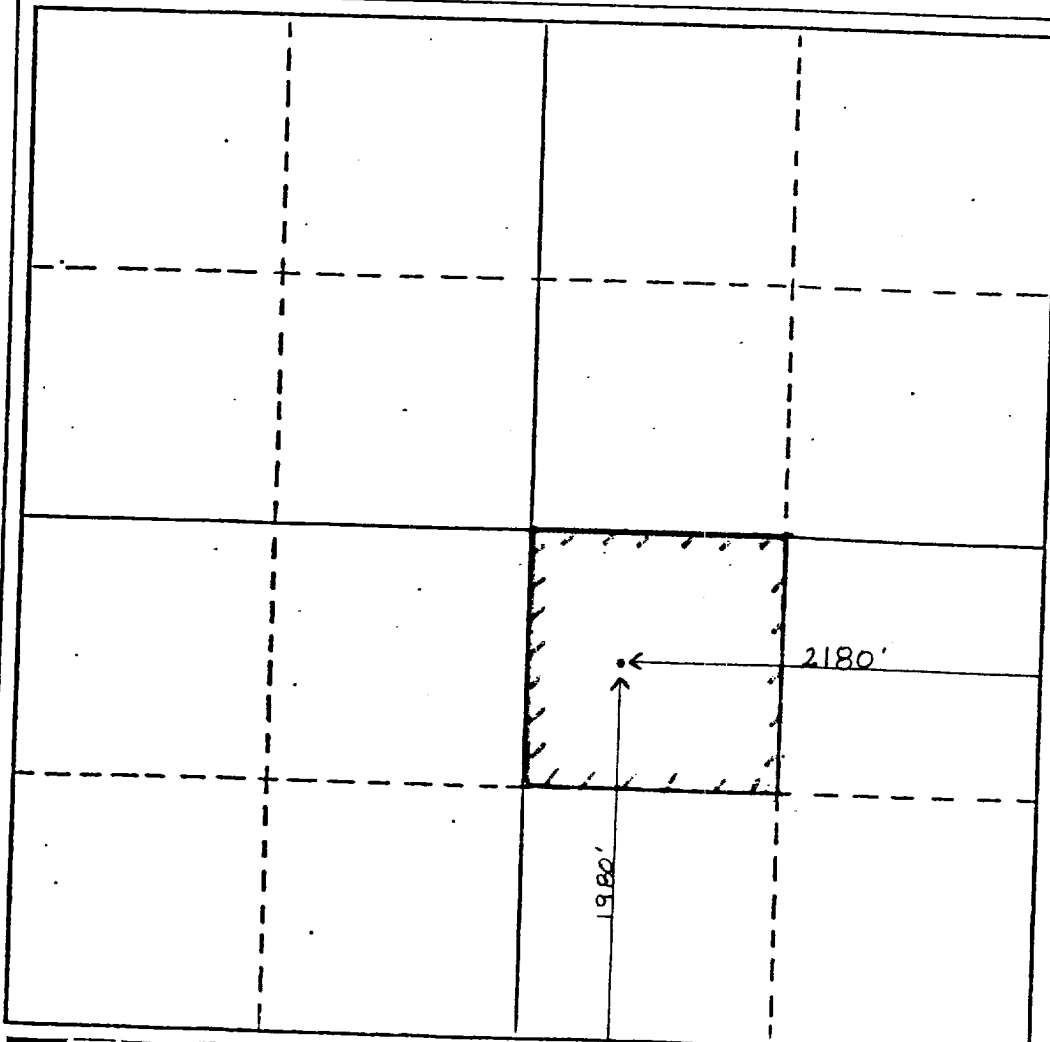

CERTIFICATION

I hereby certify that the information contained herein is true and complete to the best of my knowledge and belief.

Name

M. E. AKINS

Position

STAFF DRILLING ENGINEER

Company

Chevron U.S.A. Inc.

Date

June 8, 1988

I hereby certify that the well location shown on this plat was plotted from field notes of actual surveys made by me or under my supervision, and that the same is true and correct to the best of my knowledge and belief.

Date Surveyed

Registered Professional Engineer and/or Land Surveyor

Certificate No.

