

Submit to Appropriate
District Office
State Lease - 6 copies
Fee Lease - 5 copies

State of New Mexico
Energy, Minerals and Natural Resources Department

Form C-101
Revised 1-1-89

OIL CONSERVATION DIVISION

DISTRICT I
P.O. Box 1980, Hobbs, NM 88240

P.O. Box 2088

Santa Fe, New Mexico 87504-2088

DISTRICT II
P.O. Drawer DD, Artesia, NM 88210

DISTRICT III
1000 Rio Brazos Rd., Aztec, NM 87410

API NO. (assigned by OCD on New Wells)	3002506820
5. Indicate Type of Lease	STATE <input checked="" type="checkbox"/> FEE <input type="checkbox"/>
6. State Oil & Gas Lease No.	464900
7. Lease Name or Unit Agreement Name	
W. S. Marshall "B"	
8. Well No.	3
9. Pool name or Wildcat	Tubb Paddock
10. Proposed Depth	
11. Formation	12. Rotary or C.T.
13. Elevations (Show whether DF, RT, GR, etc.)	14. Kind & Status Plug. Bond
GL 3410' KB 3422'	15. Drilling Contractor
16. Approx. Date Work will start	
5/21/92	

APPLICATION FOR PERMIT TO DRILL, DEEPEN, OR PLUG BACK					
1a. Type of Work:					
DRILL <input type="checkbox"/> RE-ENTER <input type="checkbox"/> DEEPEN <input type="checkbox"/> PLUG BACK <input checked="" type="checkbox"/>					
b. Type of Well:					
OIL WELL <input checked="" type="checkbox"/> GAS WELL <input type="checkbox"/> OTHER <input type="checkbox"/>					
SINGLE ZONE <input checked="" type="checkbox"/> MULTIPLE ZONE <input type="checkbox"/>					
2. Name of Operator					
Marathon Oil Company					
3. Address of Operator					
P. O. Box 552, Midland, TX 79702					
4. Well Location					
Unit Letter K : 1980 Feet From The South Line and 1980 Feet From The West Line					
Section 27 Township 21-S Range 37-E NMPM Lea County					
10. Proposed Depth					
11. Formation					
12. Rotary or C.T.					
13. Elevations (Show whether DF, RT, GR, etc.)					
GL 3410' KB 3422'					
14. Kind & Status Plug. Bond					
15. Drilling Contractor					
16. Approx. Date Work will start					
5/21/92					
17. PROPOSED CASING AND CEMENT PROGRAM					
SIZE OF HOLE	SIZE OF CASING	WEIGHT PER FOOT	SETTING DEPTH	SACKS OF CEMENT	EST. TOP
See original Completion Report					

T.A. Drinkard and Tubb. Recomplete in Paddock.

MIRU. Install BOP. POOH w/prod. string. T.A. Drinkard and Tubb perfs 6352-6479' and 5914-6198' respectively w/CIBP @ 5850' w/2 sx cmt cap. Run bond log. Perf w/2 JSPF (5300-10'). Acid stimulate. Flow and swab back. Perf w/2 JSPF (5126-62')(65-68')(71-76')(82-86')(90-5211') 143 holes. Set RBP 5240'. Stimulate w/1590 HCl. Flow & swab back. POOH w/RBP. Hang well on and put on pump. RDMO.

IN ABOVE SPACE DESCRIBE PROPOSED PROGRAM: IF PROPOSAL IS TO DEEPEN OR PLUG BACK, GIVE DATA ON PRESENT PRODUCTIVE ZONE AND PROPOSED NEW PRODUCTIVE ZONE. GIVE BLOWOUT PREVENTER PROGRAM, IF ANY.

I hereby certify that the information above is true and complete to the best of my knowledge and belief.

SIGNATURE Thomas M. Price TITLE Adv. Eng. Tech. DATE 5/19/92

TYPE OR PRINT NAME Thomas M. Price TELEPHONE NO. (915) 682-1626

(This space for State Use)

APPROVED BY _____ TITLE _____ DATE MAY 21 '92

CONDITIONS OF APPROVAL, IF ANY:

Submit to Appropriate
District Office
State Lease - 4 copies
Fee Lease - 3 copies

State of New Mexico
Energy, Minerals and Natural Resources Department

Form C-102
Revised 1-1-89

OIL CONSERVATION DIVISION

P.O. Box 2088

Santa Fe, New Mexico 87504-2088

DISTRICT I

P.O. Box 1980, Hobbs, NM 88240

DISTRICT II

P.O. Drawer DD, Artesia, NM 88210

DISTRICT III

1000 Rio Brazos Rd., Aztec, NM 87410

WELL LOCATION AND ACREAGE DEDICATION PLAT

All Distances must be from the outer boundaries of the section

Operator Marathon Oil Company			Lease W. S. Marshall "B"		Well No. 3
Unit Letter K	Section 27	Township 21-S	Range 37-E	NMPM	County Lea
Actual Footage Location of Well: 1980 feet from the South line and 1980 feet from the West line					
Ground level Elev. 3410'		Producing Formation Paddock	Pool Paddock	Dedicated Acreage: 40 Acres	

1. Outline the acreage dedicated to the subject well by colored pencil or hatchure marks on the plat below.

2. If more than one lease is dedicated to the well, outline each and identify the ownership thereof (both as to working interest and royalty).

3. If more than one lease of different ownership is dedicated to the well, have the interest of all owners been consolidated by communitization, unitization, force-pooling, etc.?

☐ Yes

☐ No

If answer is "yes" type of consolidation

If answer is "no" list the owners and tract descriptions which have actually been consolidated. (Use reverse side of this form if necessary.)

No allowable will be assigned to the well until all interests have been consolidated (by communitization, unitization, forced-pooling, or otherwise) or until a non-standard unit, eliminating such interest, has been approved by the Division.

OPERATOR CERTIFICATION

I hereby certify that the information contained herein is true and complete to the best of my knowledge and belief.

Signature

Thomas M. Price

Printed Name

Thomas M. Price

Position

Advanced Engineering Tech.
Company

Marathon Oil Company

Date

5/19/92

SURVEYOR CERTIFICATION

I hereby certify that the well location shown on this plat was plotted from field notes of actual surveys made by me or under my supervision, and that the same is true and correct to the best of my knowledge and belief.

Date Surveyed

Signature & Seal of
Professional Surveyor

Certificate No.

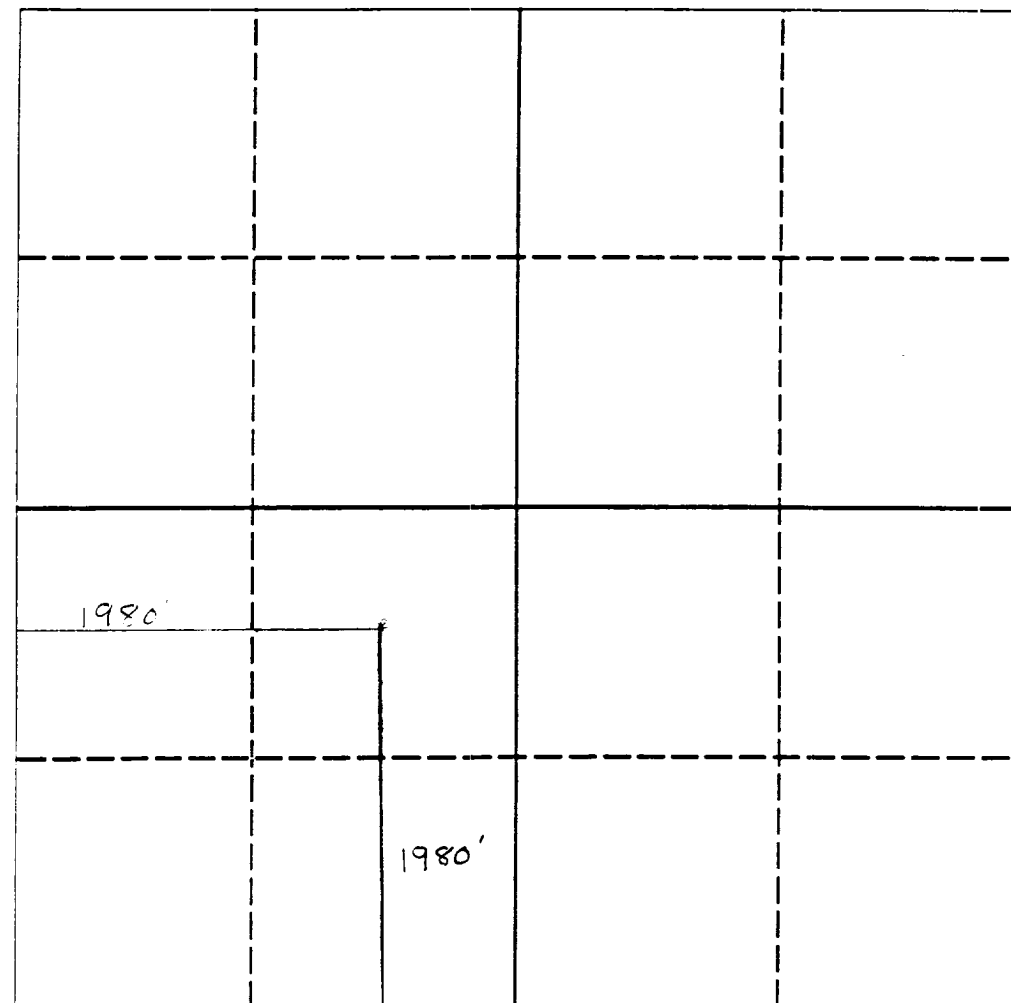

0 330 660 990 1320 1650 1980 2310 2640 2000 1500 1000 500 0