

## OIL CONSERVATION DIVISION

STATE OF NEW MEXICO  
ENERGY AND MINERALS DEPARTMENTP. O. BOX 2088  
SANTA FE, NEW MEXICO 87501Form O-102  
Revised 10-1-78

All distances must be from the outer boundaries of the Section.

Operator Marathon Oil Company			Lease W. S. Marshall "B"			Well No. 4		
Unit Letter L	Section 27	Township 21S	Range 37E	County Lea				
Actual Footage Location of Well:								
1980 feet from the South line and 660 feet from the West line								
Ground Level Elev. 3415	Producing Formation Drinkard/Blinebry		Pool Blinebry		Dedicated Acreage; 120 Acres			

1. Outline the acreage dedicated to the subject well by colored pencil or hatchure marks on the plat below.
2. If more than one lease is dedicated to the well, outline each and identify the ownership thereof (both as to working interest and royalty).
3. If more than one lease of different ownership is dedicated to the well, have the interests of all owners been consolidated by communitization, unitization, force-pooling, etc?

☐ Yes ☐ No If answer is "yes," type of consolidation \_\_\_\_\_

If answer is "no," list the owners and tract descriptions which have actually been consolidated. (Use reverse side of this form if necessary.) \_\_\_\_\_

No allowable will be assigned to the well until all interests have been consolidated (by communitization, unitization, forced-pooling, or otherwise) or until a non-standard unit, eliminating such interests, has been approved by the Division.

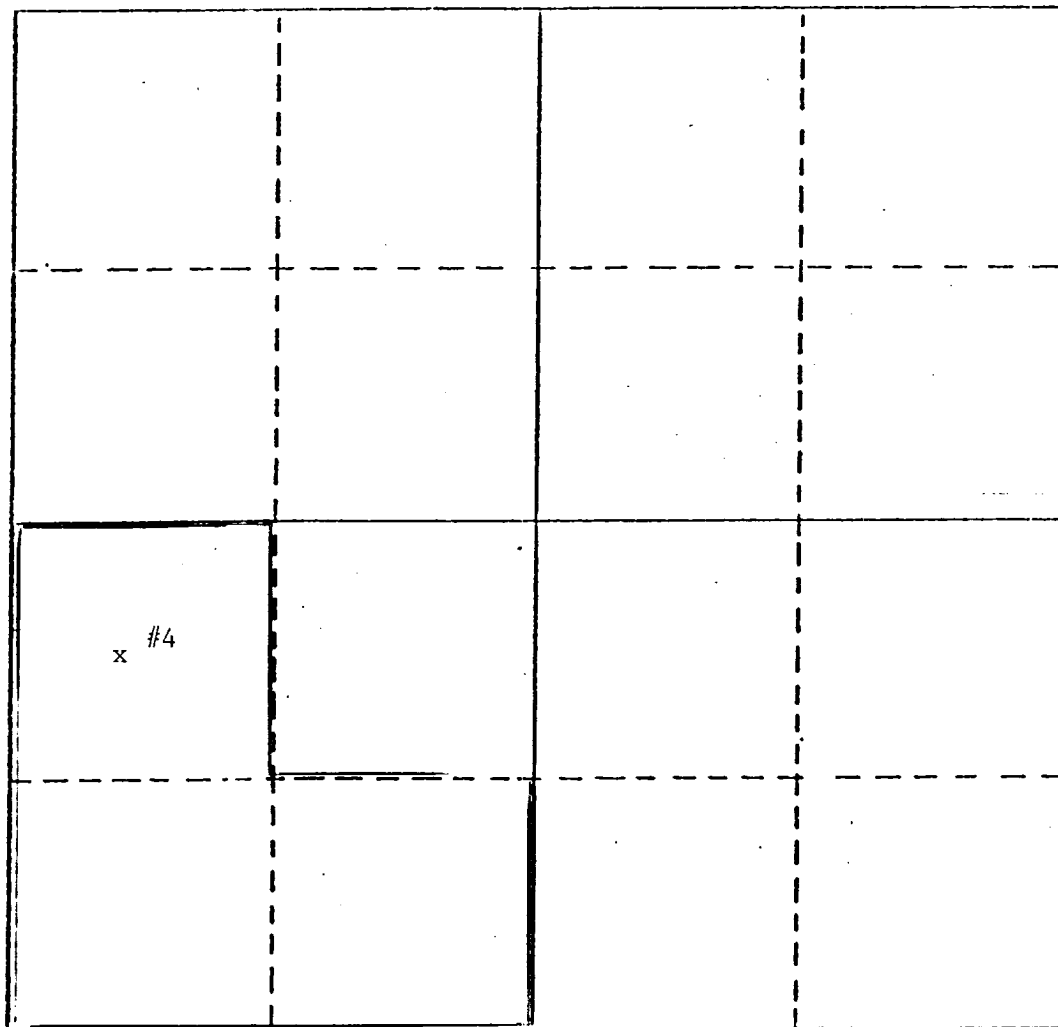

## CERTIFICATION

I hereby certify that the information contained herein is true and complete to the best of my knowledge and belief.

*Thomas F. Zapatka*

Name

Thomas F. Zapatka

Position

Production Engineer

Company

Marathon Oil Company

Date

April 24, 1985

I hereby certify that the well location shown on this plat was plotted from field notes of actual surveys made by me or under my supervision, and that the same is true and correct to the best of my knowledge and belief.

Date Surveyed

Registered Professional Engineer  
and/or Land Surveyor

Certificate No.

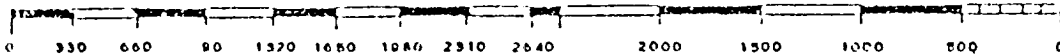

NEW MEXICO  
OIL CONSERVATION COMMISSION

Gas Well

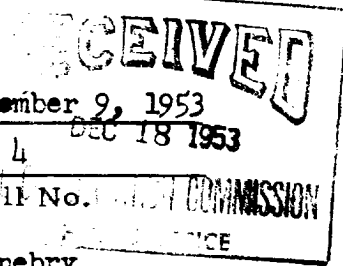

The Ohio Oil Company  
Operator

W. S. Marshall "B"  
Lease

Date December 9, 1953  
4 DEC 18 1953

Well No. OIL CONSERVATION  
COMMISSION

Name of Producing Formation Blinebry Pool Blinebry

No. Acres Dedicated to the Well 160

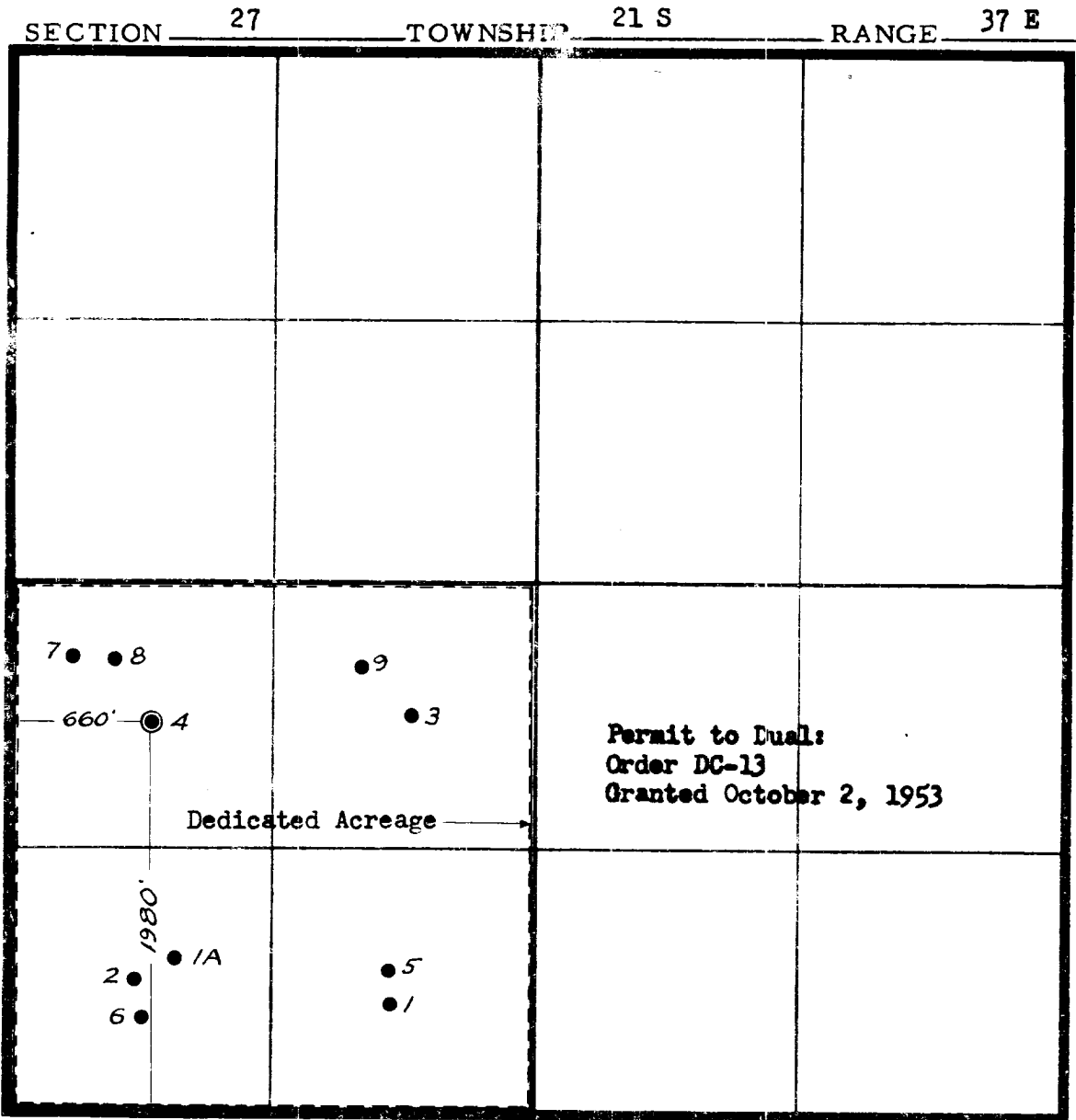

I hereby certify that the information given above is true and complete to the best of my knowledge.

Brunson 5, 6, 8, 9  
Drinkard 1, 2, 3, 4  
Hare 7, 10  
Dual: Tubbs-Drinkard 1  
Dual: Blinebry-Drinkard 2

Name Dr. J. L. J. J.  
Position Petroleum Engineer  
Representing The Ohio Oil Company  
Address Box 552, Midland, Texas

(over)

### INSTRUCTIONS

1. Is this gas well a dual completion? Yes X No
2. If the answer to Question 1 is Yes, are there any other dually completed wells within the dedicated acreage? Yes X No

No. 2 in Tubbs - Drinkard,

A separate plat must be filed for each gas well, outlining the area dedicated to such well and showing the location of all other wells (oil and gas) within the outlined area.

Mail in duplicate to the district office for the district in which the well is located.

# WRS COMPLETION REPORT

COMPLETIONS SEC 27 TWP 21S RGE 37E  
PI# 30-T-0013 08/01/88 30-025-06821-0002 PAGE 1

NMEX LEA \* 1980FSL 660FWL SEC NW SW  
STATE COUNTY FOOTAGE SPOT  
MARATHON OIL D X DO  
OPERATOR WELL CLASS INIT FIN

4 MARSHALL W S "B"  
WELL NO. LEASE NAME

3428KB 3415GR PADDOCK  
OPER ELEV FIELD/POOL/AREA

API 30-025-06821-0002  
LEASE TYPE NO PERMIT OR WELL I.D. NO

05/28/1987 06/02/1987 WO-UNIT OIL-WO  
SPUD DATE COMP. DATE TYPE TOOL STATUS

5440 NOT RPTD  
PROJ. DEPTH PROJ. FORM CONTRACTOR

DTD 6555 PB 5440 OTD 6555 FM/TD DRINKARD  
DRILLERS T.D. LOG T.D. PLUG BACK TO OLD T.D. FORM T.D.

## LOCATION DESCRIPTION

1/2 MI N EUNICE, NM

## TUBING DATA

TBG 2 3/8 AT 5299

## INITIAL POTENTIAL

IPP 24BOPD 60 MCFD 105BW 24HRS  
PADDOCK PERF JET W/ 53/IT 5130- 5270 GROSS  
PERF 5130- 5139 5150- 5153 5183- 5195 5217- 5225  
PERF 5240- 5245 5254- 5258 5265- 5270  
ACID 5130- 5270 2500GALS  
15% NEFE  
GTY 36.8 GOR 2500

TYPE	FORMATION	LTH	TOP DEPTH/SUB	BSE DEPTH/SUB
------	-----------	-----	---------------	---------------

LOG	GRAYBURG		3495 -67	
LOG	SN ANDRS		3862 -434	
LOG	GLORIETA		5048 -1620	
LOG	PADDOCK		5128 -1700	
LOG	BLINEBRY		5487 -2059	

SUBSEA MEASUREMENTS FROM KB

## PRODUCTION TEST DATA

BLINEBRY PERF 5510- 5570  
PERF 5510- 5570

CONTINUED IC# 300257030388

COMPLETIONS  
PI# 30-T-0013 08/01/88 SEC 27 TWP 21S RGE 37E  
30-025-06821-0002 PAGE 2

MARATHON OIL  
4

MARSHALL W S "B"

D X DO

PRODUCTION TEST DATA

BRPG @ 5440

5510- 5570

DRILLING PROGRESS DETAILS

MARATHON OIL  
BOX 552  
MIDLAND, TX 79702  
915-682-1626

OWWO: OLD INFO: FORMERLY MARATHON OIL #4  
MARSHALL WS "B". SPUD 11/19/53. 13 3/8 @ 300  
W/250 SX, 8 5/8 @ 2800 W/1500 SX, 5 1/2 @ 6520  
W/500 SX. OTD 6555. PB 6000. COMP 11/30/53.  
IPP 4200 MCFG. PROD ZONE: BLINEBRY 5510-5570.

07/26  
07/26

LOC/1988/  
6555 TD, PB 5440  
COMP 6/2/87, IPP 24 BO, 60 MCFG, 105 BWPD,  
GOR 2500, GTY 36.8  
PROD ZONE - PADDOCK 5130-5270  
FIRST REPORT & COMPLETION