

Submit to Appropriate
District Office
State Lease - 6 copies
Fee Lease - 5 copies

State of New Mexico
Energy, Minerals and Natural Resources Department

Form C-101
Revised 1-1-89

OIL CONSERVATION DIVISION

DISTRICT I
P.O. Box 1980, Hobbs, NM 88240

DISTRICT II
P.O. Drawer DD, Artesia, NM 88210

DISTRICT III
1000 Rio Brazos Rd., Aztec, NM 87410

P.O. Box 2088

Santa Fe, New Mexico 87504-2088

API NO. (assigned by OCD on New Wells)

30-025-06871

5. Indicate Type of Lease

STATE ☐

FEE ☒

6. State Oil & Gas Lease No.

APPLICATION FOR PERMIT TO DRILL, DEEPEN, OR PLUG BACK

1a. Type of Work:

DRILL ☐

RE-ENTER ☐

DEEPEN ☐

PLUG BACK ☒

b. Type of Well:

OIL

WELL ☐

GAS

WELL ☒

OTHER

SINGLE

ZONE ☐

MULTIPLE

ZONE ☒

7. Lease Name or Unit Agreement Name

E. O. Carson

2. Name of Operator

Mobil Producing TX. & N.M. Inc., Thru its Agent Mobil Expl. & Prod. U.S. Inc.

8. Well No.

17

3. Address of Operator

P.O. Box 633 Midland, Texas 79702

9. Pool name or Wildcat

Blinebry & Tubb Gas

4. Well Location

Unit Letter N : 518.6 Feet From The South Line and 2121.4 Feet From The West Line

Section 28

Township

21S

Range

37E

NMPM

Lea

County

10. Proposed Depth

8143

11. Formation

Blinebry & Tubb

12. Rotary or C.T.

Rotary

13. Elevations (Show whether DF, RT, GR, etc.)

3451- Ground

14. Kind & Status Plug. Bond

On File

15. Drilling Contractor

Unknown

16. Approx. Date Work will start

ASAP

17.

PROPOSED CASING AND CEMENT PROGRAM

SIZE OF HOLE	SIZE OF CASING	WEIGHT PER FOOT	SETTING DEPTH	SACKS OF CEMENT	EST. TOP
17-1/4	13-3/8"	48#	338'	300	Circulated
11"	8-5/8"	32#	2900'	1500	Circulated
7-7/8"	5-1/2"	17#	8143'	950	2325'

This well is presently producing out of Tubb Gas Pool. Permission is requested to plug back and complete as a dual gas well in the Blinebry & Tubb Pools.

- MIRU W0 Unit. NU BOP, Test
- RIH w/RBP + tbq, set RBP @ $\pm 5850'$, cap w/10' sd.
- MIRU wireline ut. Prepare to perf Blinebry from 5450-5716 (total 72 holes, 36') RD wireline unit.
- MIRU service co. Prepare to break down Blinebry perfs w/4000 gals 15% DI NEFE HCL + 100 1.1 sp gr RCBS
- RE1 pkr, run down over perfs, knock off RCBS. Reset pkr @ $\pm 5350'$.
- MIRU D-S and prepare to SWF Blinebry.
- Rel pkr, POOH w/pkr + workstring.
- RIH w/bailer + workstring, CO csg to $\pm 5800'$.
- RIH w/on/off tool + 189 jts 2-3/8" prod tbq.
- Flow test Blinebry down sales line, obtain stabilized rate/ tbq press.
- Swab tbq fluid level to $\pm 5850'$. Open CHSOV w/1 clockwise rotation, flow test Tubb.
- Put dual Blinebry/Tubb on production.

Blowout Preventer Program attached:

IN ABOVE SPACE DESCRIBE PROPOSED PROGRAM: IF PROPOSAL IS TO DEEPEN OR PLUG BACK, GIVE DATA ON PRESENT PRODUCTIVE ZONE AND PROPOSED NEW PRODUCTIVE ZONE. GIVE BLOWOUT PREVENTER PROGRAM, IF ANY.

I hereby certify that the information above is true and complete to the best of my knowledge and belief.

SIGNATURE

Judy Dixon

TITLE Regulatory Technician

DATE 10/12/90

(915)

TYPE OR PRINT NAME

Judy Dixon

TELEPHONE NO. 688-2452

(This space for State Use)

APPROVED BY

TITLE

DATE

CONDITIONS OF APPROVAL, IF ANY:

NSL-2946

Permit Expires 6 Months From Approval
Once Initial Drilling Underway.

OIL CONSERVATION DIVISION

P.O. Box 2088

Santa Fe, New Mexico 87504-2088

DISTRICT I
P.O. Box 1980, Hobbs, NM 88240

DISTRICT II
P.O. Drawer DD, Artesia, NM 88210

DISTRICT III
1000 Rio Brazos Rd., Aztec, NM 87410

WELL LOCATION AND ACREAGE DEDICATION PLAT

All Distances must be from the outer boundaries of the section

Operator Mobil Producing Tx. & N. M. Inc.		Lease E. O. Carson		Well No. 17
Unit Letter N	Section 28	Township 21S	Range 37E	County NMPM Lea

Actual Footage Location of Well:

518.6 feet from the South line and 2121.4 feet from the West line	Ground level Elev. 3451	Producing Formation Blinebry & Tubb	Pool Blinebry & Tubb Gas	Dedicated Acreage: 120 Acres
---	----------------------------	--	-----------------------------	---------------------------------

- Outline the acreage dedicated to the subject well by colored pencil or hatchure marks on the plat below.
- If more than one lease is dedicated to the well, outline each and identify the ownership thereof (both as to working interest and royalty).
- If more than one lease of different ownership is dedicated to the well, have the interest of all owners been consolidated by communitization, unitization, force-pooling, etc.?
☐ Yes ☐ No If answer is "yes" type of consolidation _____
If answer is "no" list the owners and tract descriptions which have actually been consolidated. (Use reverse side of this form if necessary). _____
No allowable will be assigned to the well until all interests have been consolidated (by communitization, unitization, forced-pooling, or otherwise) or until a non-standard unit, eliminating such interest, has been approved by the Division.

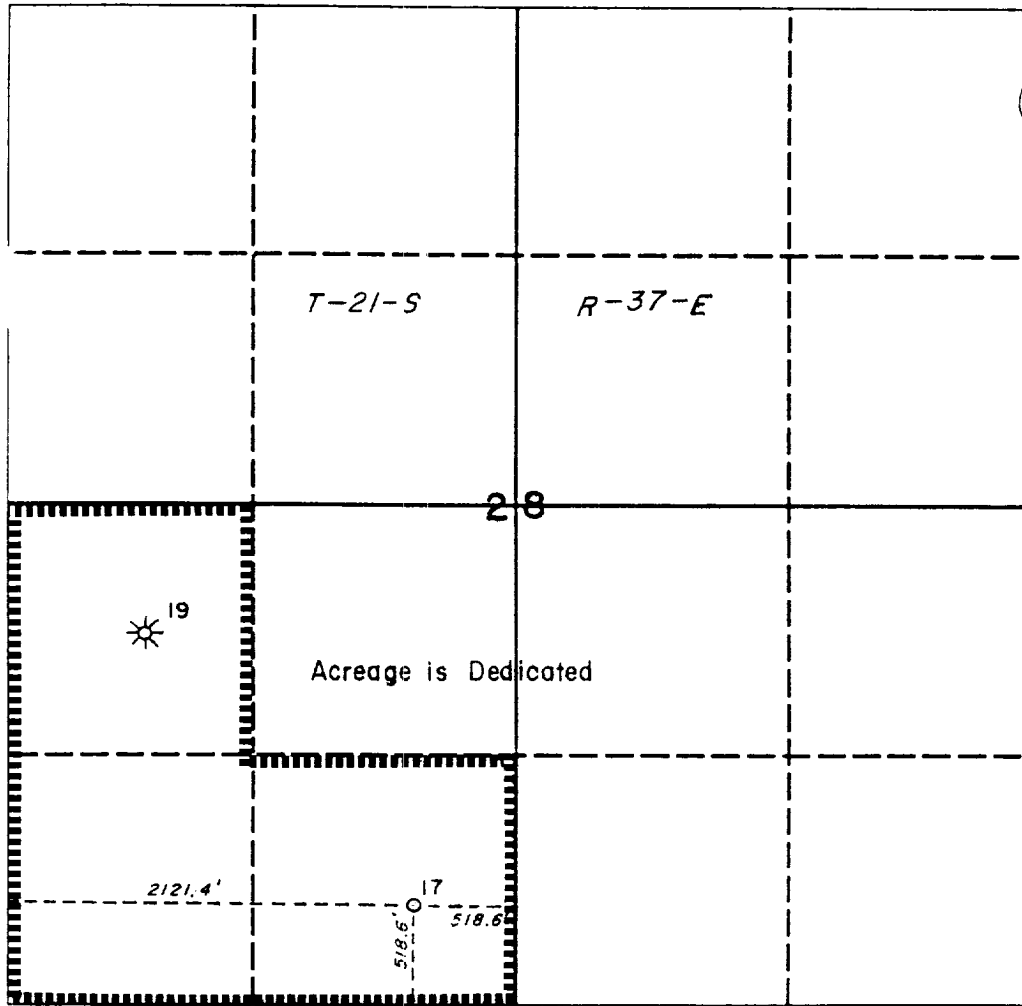

OPERATOR CERTIFICATION

I hereby certify that the information contained herein is true and complete to the best of my knowledge and belief.

Judy Dixon
Signature

Judy Dixon

Printed Name

Environmental & Regulatory
Position

Mobil Producing Texas & New Mexico Inc.
Company
acting by and through its agent
Mobil Exploration & Producing U.S. Inc.
Date

SURVEYOR CERTIFICATION

I hereby certify that the well location shown on this plat was plotted from field notes of actual surveys made by me or under my supervision, and that the same is true and correct to the best of my knowledge and belief.

Date Surveyed

Signature & Seal of
Professional Surveyor

Certificate No.

120 ac Tubb NSP-258 Blinebry NSP-259

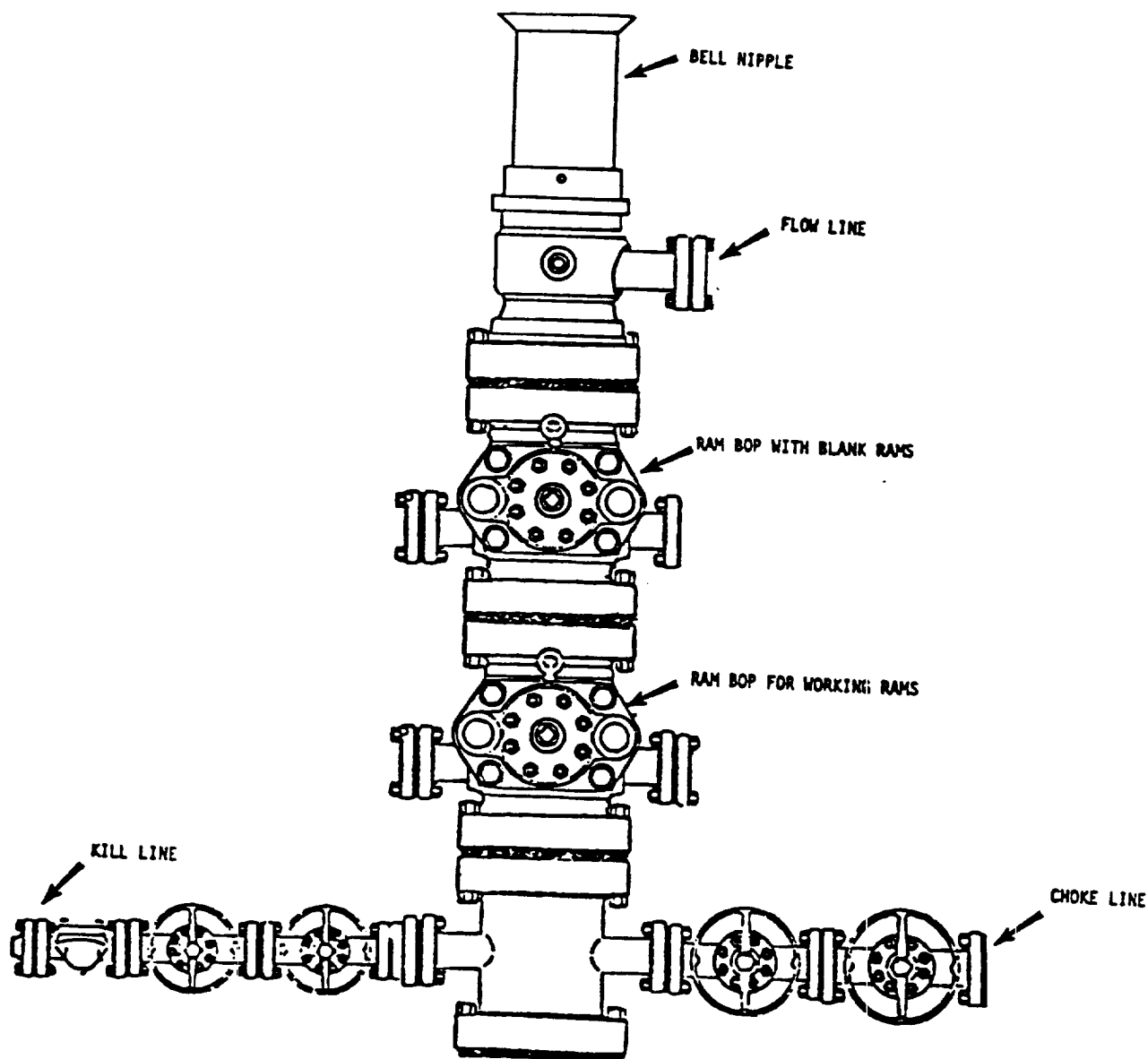

BOP rams will be actuated on each trip of drill pipe and will be tested before drilling the plug on each casing string.

Mobil Producing
Texas & New Mexico Inc.
Houston, Texas

MOBIL NO. 17 E. O. Carson
(LEASE)

Lea COUNTY, New Mexico STATE

BLOWOUT PREVENTER ASSEMBLY

(6 IN. 2000 PSI)

Scale

Date
Drawn
Checked
Approved
Revised

NOTE: ALL WELDING AND METAL-TO-METAL WORK SHOWN.
ALL DIMENSIONS MUST BE TO THE CENTER OF THE PIPE UNLESS OTHERWISE SPECIFIED.
ALL DIMENSIONS MUST BE TO THE CENTER OF THE PIPE UNLESS OTHERWISE SPECIFIED.