

NO. OF COPIES RECEIVED	
DISTRIBUTION	
SANTA FE	
FILE	
U.S.G.S.	
LAND OFFICE	
OPERATOR	

NEW MEXICO OIL CONSERVATION COMMISSION

Form C-101
Revised 1-1-65

5A. Indicate Type of Lease	
STATE <input type="checkbox"/>	FEE <input checked="" type="checkbox"/>
5. State Oil & Gas Lease No.	

APPLICATION FOR PERMIT TO DRILL, DEEPEN, OR PLUG BACK

1a. Type of Work		7. Unit Agreement Name	
b. Type of Well OIL WELL <input checked="" type="checkbox"/> GAS WELL <input type="checkbox"/> OTHER <input type="checkbox"/>		8. Farm or Lease Name E. O. Carson	
2. Name of Operator Mobil Oil Corporation		9. Well No. 18	
3. Address of Operator P. O. Box 633, Midland, Texas 79701		10. Field and Pool, or Wildcat Paddock (Paddock)	
4. Location of Well UNIT LETTER <u>M</u> LOCATED <u>760</u> FEET FROM THE <u>West</u> LINE AND <u>660</u> FEET FROM THE <u>South</u> LINE OF SEC. <u>28</u> TWP. <u>21-S</u> RGE. <u>37-E</u> NMPM		12. County Lea	
19. Proposed Depth 5380'		19A. Formation Paddock	
20. Rotary or C.T. Rotary		21. Elevations (Show whether DF, RT, etc.) 3476' Ground	
21A. Kind & Status Plug. Bond On File		21B. Drilling Contractor Unknown	
22. Approx. Date Work will start August 11, 1972			

PROPOSED CASING AND CEMENT PROGRAM

SIZE OF HOLE	SIZE OF CASING	WEIGHT PER FOOT	SETTING DEPTH	SACKS OF CEMENT	EST. TOP

This well is presently completed in the Hare (Connell) Pool. Permission is requested to squeeze the Connell perforations, plug back to 5400 feet and set a cast iron bridge plug with a 20 foot cement cap - then perforate and test the Paddock formation.

APPROVAL VOID
IF DATE IS LATER THAN
11-9-72

IN ABOVE SPACE DESCRIBE PROPOSED PROGRAM: IF PROPOSAL IS TO DEEPEN OR PLUG BACK, GIVE DATA ON PRESENT PRODUCTIVE ZONE AND PROPOSED NEW PRODUCTIVE ZONE. GIVE BLOWOUT PREVENTER PROGRAM, IF ANY.

I hereby certify that the information above is true and complete to the best of my knowledge and belief.

Signed A. D. Bond A. D. Bond Title Proration Staff Assistant Date August 8, 1972

(This space for State Use)

APPROVED BY [Signature] TITLE SUPERVISOR DISTRICT I DATE AUG 10 1972

CONDITIONS OF APPROVAL, IF ANY:

RECEIVED

AUG 10 1972

OIL CONSERVATION COMM.
HOBBS, N. M.

**NEW MEXICO OIL CONSERVATION COMMISSION
WELL LOCATION AND ACREAGE DEDICATION PLAT**

Form C-102
Supersedes C-128
Effective 1-1-65

All distances must be from the outer boundaries of the Section.

Operator Mobil Oil Corporation			Lease E. O. Carson		Well No. 18
Unit Letter M	Section 28	Township 21-S	Range 37-E	County Lea	
Actual Footage Location of Well: <div style="display: flex; justify-content: space-between;"> 760 feet from the West line and 660 feet from the South line </div>					
Ground Level Elev. 3476	Producing Formation Paddock	Pool Brunson		Dedicated Acreage: 40 Acres	

1. Outline the acreage dedicated to the subject well by colored pencil or hatchure marks on the plat below.
2. If more than one lease is dedicated to the well, outline each and identify the ownership thereof (both as to working interest and royalty).
3. If more than one lease of different ownership is dedicated to the well, have the interests of all owners been consolidated by communitization, unitization, force-pooling, etc?

☐ Yes ☐ No If answer is "yes," type of consolidation _____

If answer is "no," list the owners and tract descriptions which have actually been consolidated. (Use reverse side of this form if necessary.) _____

No allowable will be assigned to the well until all interests have been consolidated (by communitization, unitization, forced-pooling, or otherwise) or until a non-standard unit, eliminating such interests, has been approved by the Commission.

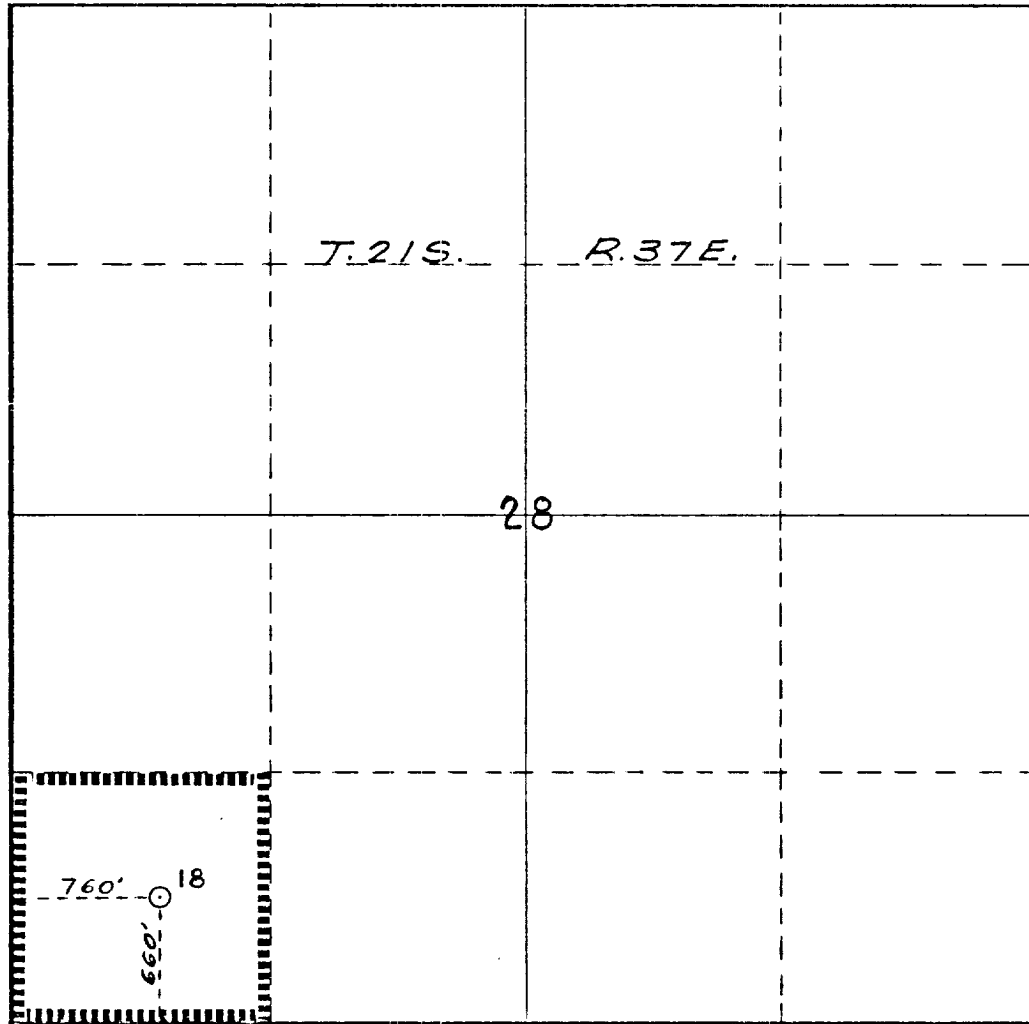

CERTIFICATION

I hereby certify that the information contained herein is true and complete to the best of my knowledge and belief.

A. D. Bond
Name

A. D. Bond

Position

Proration Staff Assistant

Company

Mobil Oil Corporation

Date

August 8, 1972

I hereby certify that the well location shown on this plat was plotted from field notes of actual surveys made by me or under my supervision, and that the same is true and correct to the best of my knowledge and belief.

Date Surveyed

Registered Professional Engineer
and/or Land Surveyor

Certificate No.

0 330 660 990 1320 1650 1980 2310 2640 2970 3300 3630 3960 4290 4620 4950 5280 5610 5940 6270 6600

RECEIVED

AUG 9 1972

OIL CONSERVATION COMM.
HOBBS, N. M.