

NEW MEXICO OIL CONSERVATION COMMISSION
Well Location and Acreage Dedication Plat

Form C-328
Revised 5/1/57
HOBBS OFFICE OCC
Date 1957 October 24, 1957
PM 3:23

Section A.

Operator The Ohio Oil Company Lease Wm. Turner
Well No. 3 Unit Letter I Section 29 Township 21 S Range 37 E NMPM
Located 1980 Feet From South Line, 330 Feet From East Line
County Lea G. L. Elevation 3465' Dedicated Acreage 80 Acres
Name of Producing Formation Tubb Pool Tubb Gas

1. Is the Operator the only owner* in the dedicated acreage outlined on the plat below?
Yes X No _____.
2. If the answer to question one is "no," have the interests of all the owners been consolidated by communitization agreement or otherwise? Yes _____ No _____. If answer is "yes," Type of Consolidation _____
3. If the answer to question two is "no," list all the owners and their respective interests below:

Owner.

Land Description

Section B

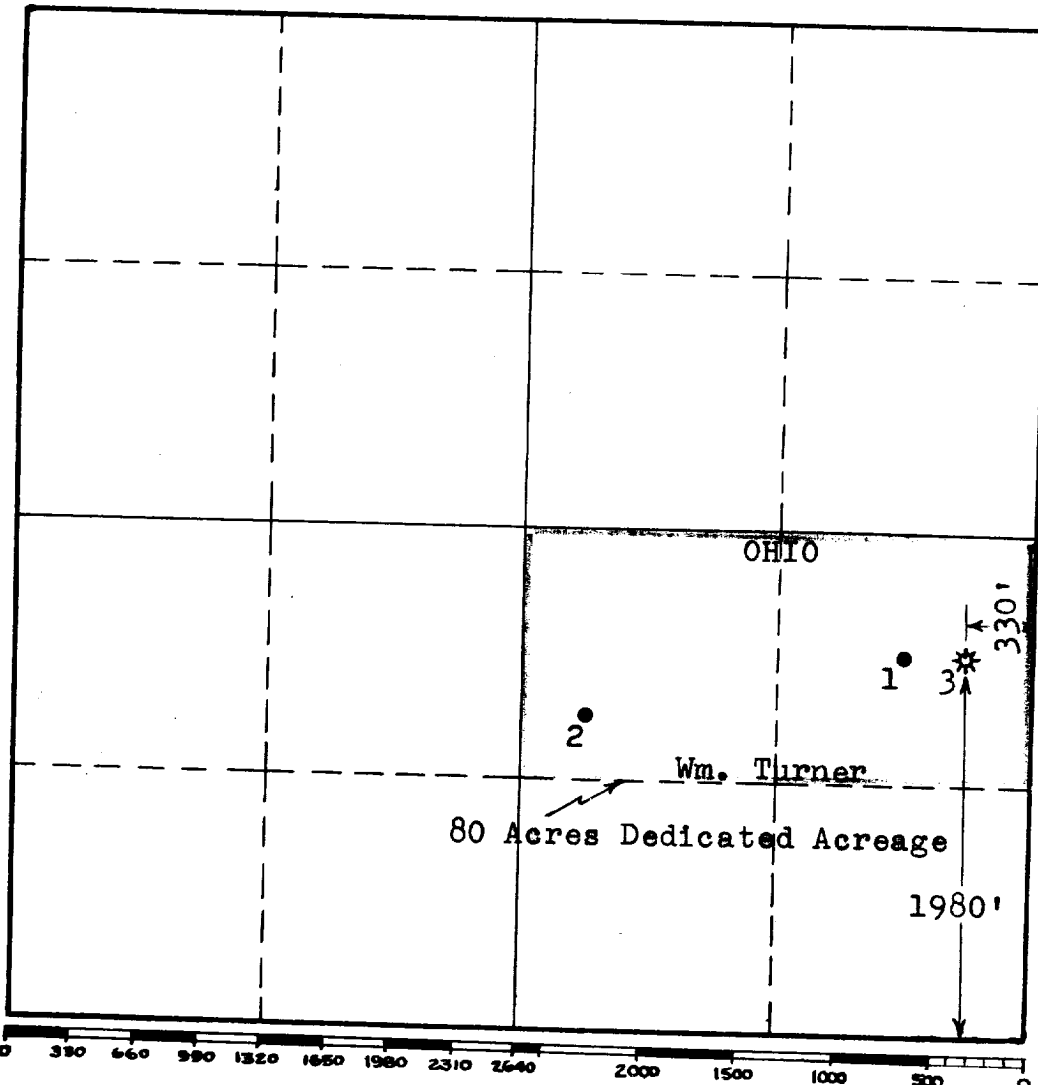

This is to certify that the information in Section A above is true and complete to the best of my knowledge and belief.

The Ohio Oil Company
(Operator)

[Signature]
(Representative)

Box 2107, Hobbs, N. M.
Address

This is to certify that the well location shown on the plat in Section B was plotted from field notes of actual surveys made by me or under my supervision and that the same is true and correct to the best of my knowledge and belief.

Date Surveyed _____

Registered Professional
Engineer and/or Land Surveyor

Certificate No. _____

(See instructions for completing this form on the reverse side.)

INSTRUCTIONS FOR COMPLETION:

1. Operator shall furnish and certify to the information called for in Section A.
2. Operator shall outline the dedicated acreage for both oil and gas wells on the plat in Section B.
3. A registered professional engineer or land surveyor registered in the State of New Mexico or approved by the Commission shall show on the plat the location of the well and certify this information in the space provided.
4. All distances shown on the plat must be from the outer boundaries of Section.
5. If additional space is needed for listing owners and their respective interests as required in question 3, Section A, please use space below

* "Owner" means the person who has the right to drill into and to produce from any pool and to appropriate the production either for himself or for himself and another. (65-3-29 (e) NMSA 1953 Comp.)

NEW MEXICO
OIL CONSERVATION COMMISSION

Well Location and/or Gas Proration Plat

Form O-128

Operator The Ohio Oil Company

HOBBS OFFICE OCC
Lease No. Turner

Date June 27, 1956

Well No. 3 Section 29 Township 21 - N 9 - E Range 37 - E

Located 1980 Feet From South Line, 330 Feet From East

Deer County, New Mexico. G. L. Elevation 3465

Name of Producing Formation Blinberry

Pool Blinberry

Dedicated Acreage 1.00

(Note: All distances must be from outer boundaries of Section)

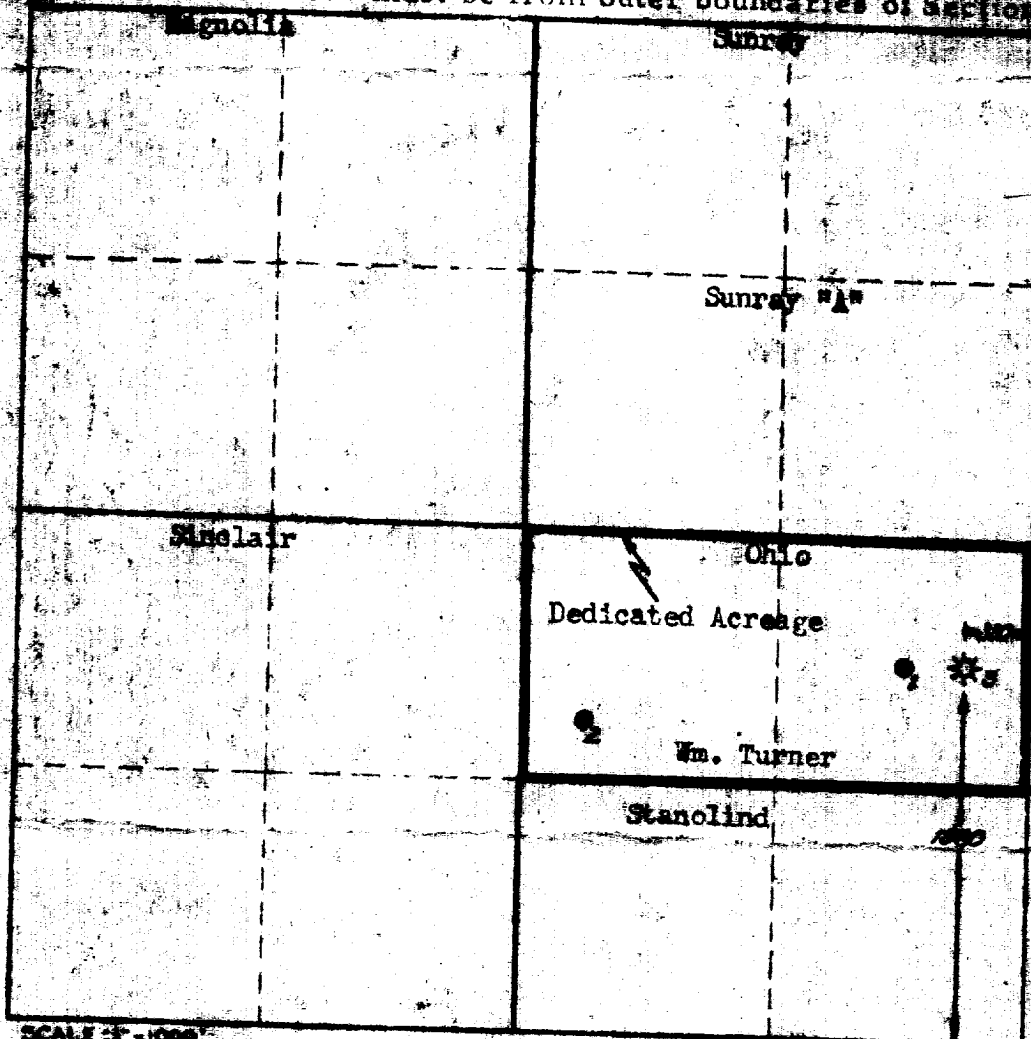

SCALE: 1" = 1000'

1. Is this Well a Dual Comp.? Yes ___ No X
2. If the answer to Question 1 is yes, are there any other dually completed wells within the dedicated acreage? Yes ___ No ___

This is to certify that the above plat was prepared from field notes of actual surveys made by me or under my supervision and that the same are true and correct to the best of my knowledge and belief.

Name Thomas O. Webb
Position Petroleum Engineer
Representing The Ohio Oil Company
Address Box 2107, Hobbs, New Mexico

Date Surveyed _____
Registered Professional Engineer and/or Land Surveyor

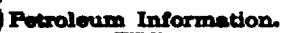

COUNTY	LEA	FIELD	Blinebry	STA	NM
OPR	MARATHON OIL			API	50-025-06879
NO	3 LEASE Turner, William			MAP	
	Sec 29, T21S, R37E			COORD	
	1980 FSL, 330 FEL of Sec				3-1-47 NM
	1 1/2 mi E/Eunice			RESPD 12-3-84 RE	CMP 12-26-84

CSC 13 3/8-300-300 SX 8 5/8-2800-1500 SX 5 1/2-7911-950 SX	WELL CLASS: INIT DX FIN DO LSE. CODE			
	FORMATION	DATUM	FORMATION	DATUM
	ID 7912 (SMPS)		PBD 6082	

IP (Blinebry) Perfs 5751-5955 F 52 BOPD + 14 BW. Pot
based on 24 hr test thru 23/64 chk. GOR 27,730; gty 37;
CP Pkr; TP 475

CONTR	OPRS ELEV	3465 GR	SUB'S
-------	-----------	---------	-------

PD 6082 WO

(Date-NA) by Marathon Oil dual thru (Blinebry)
Perfs 5570-5620 & (Tubb) Perfs 6100-6230, OTD
7912, OPB 6411; OWWO & Re-Cmp. 6-23-83 thru
(Abo) Perfs 6794-7152, OTD 7912, OPB 7485)

CIBP @ 6082

Perf (Blinebry) @ 5751, 5758, 5765, 5786,
5788, 5812, 5835, 5839, 5848, 5859, 5862,
5878, 5891, 5900, 5904, 5926, 5937, 5955
w/2 SPI

3-1-47 NM

LEA
MARATHON OIL

Blinebry
3 Turner, William
Sec 29, T21S, R37E

NM
Page 1

2-25-85 Continued
Acid (5751-5955) 3500 gals (15% HCL)
Frac (5751-5955) 70,000 gals X-linked
KCL + 130,000# sd
3-2-85 COMPLETION ISSUED

3-1-47 NM
IC 30-025-70100-85

COUNTY LEA FIELD Wantz STA N 1
 OPR MARATHON OIL CO. API 30 025-06879
 NO 3 PLEASE Turner, William MAP
Sec 29, T21S, R37E CO-ORD
1980 FSL, 330 FEL of Sec 7-3-45 NM
1 1/2 mi E/Eunice RE- SPD 4-19-83 RE- CMP 6-23-83

CSC	WELL CLASS: INITDX FIN DO LSE CODE			
	FORMATION	DATUM	FORMATION	DATUM
	TD 7912 (SMPS)		PBD 7485	

IP (Abo) Perfs 6794-7152 P 2 BOPD + 4 BW. Pot based on
 24 hr test. GOR TSTM; gty (NR)

CONTR OPRSELEV 3465 CL sub-s

F.R.C. 7-16-83 OWWO
 PD 7485 WO

(Orig. Ohio Oil Co., Cmp. 10-1-49 thru
 (Simpson) Perfs 7858-88, OTD 7912, OPB 7889;
 OWWO & Re-Cmp. 6-16-56 thru (Blincbry) Perfs
 5570-5620, OTD 7912, OPB 5687; OWWO by Marathon
 Oil Co. & Re-Cmp. (date-NA) dual thru (Blincbry)
 Perfs 5570-5620 & (Tubb) Perfs 6100-6230, OTD
 7912, OPB 6411)

7-11-83 TD 7912; PBD 7485; Complete
 Sqzd (6100-6230) 250 sx
 Sqzd (5570-5620) 200 sx
 DO to 7860
 CIBP @ 7485

Perf (Abo) 6794-99, 6803-08, 6823-26, 6844-49,
 6872-76, 6955-58, 6965-68, 6972-78, 7050-62,
 7075-76, 7104-07, 7145-52 w/1 SPF
 7-3-45 NM

LEA
MARATHON OIL CO.

Wantz
3 Turner, William
Sec 29, T21S, R37E

NM
Page #2

7-11-83 Continued
Acid (6794-7152) 7500 gals
Frac (6794-7152) 27,850 gals + 24,600# sd
7-16-83 COMPLETION ISSUED

7-3-45 NM
IC 30-025-70426-83