

PAN AMERICAN PETROLEUM CORPORATION

NSP-384

MAIN OFFICE SOC  
Post Office Box 68  
Hobbs, New Mexico

MAIN OFFICE SOC  
JUL 23 1957  
M 3:02

1957 JUL 24 3:48 PM  
July 24, 1957

File: RLM-513-400.1

Subject: Application for Exception to  
Rule 5 (A), Order No. R-610,  
Pan American Petroleum Corpora-  
tion's W. H. Turner Well No. 3,  
Blinbry Field

Mr. A. L. Porter, Jr. (3)  
New Mexico Oil Conservation Commission  
P.O. Box 871  
Santa Fe, New Mexico

Dear Sir:

Under the provisions of Commission Order No. R-610, Rule 5 (B), Special Rules and Regulations for the Blinbry Gas Pool, delegating the Director of the Commission authority to establish a non-standard gas proration unit by administrative action without notice and hearing, Pan American Petroleum Corporation hereby applies for an exception to Rule 5 (A) of Order R-610 for W. H. Turner Well No. 3, dually completed as a gas-gas well.

In support of the above application the following data are furnished:

1. Application is submitted in triplicate.
2. The proposed non-standard gas proration unit of 40 contiguous acres consists of the 3/2 of SE/4 Section 29, T-21-S, R-37-E.
3. Exact location and name of well involved:  
W. H. Turner Well No. 3 located 560' from the South line and 760' from the East line of Section 29, T-21-S, R-37-E, N.M.P.M., Lea County, New Mexico.
4. The non-standard gas proration unit lies wholly within a single governmental section.
5. The entire proposed non-standard gas proration unit may reasonably be presumed to be productive of gas from the Blinbry Gas Pool.

COPY

RECEIVED  
JAN 10 1963  
U.S. DEPARTMENT OF AGRICULTURE  
WASHINGTON, D.C. 20250

TO: DIRECTOR, AGRICULTURAL RESEARCH SERVICE  
FROM: ASSISTANT SECRETARY FOR AGRICULTURAL RESEARCH  
SUBJECT: [Illegible]

1. [Illegible]

2. [Illegible]

3. [Illegible]

4. [Illegible]

5. [Illegible]

6. [Illegible]

7. [Illegible]

100-100000-100000

6. The length and width of the proposed non-standard gas proration unit does not exceed 2640'.
7. The entire proposed non-standard gas proration unit lies within the horizontal limits of the Blinbry Gas Pool.
8. By copy of this letter of application, all operators owning interest in the quarter section in which the non-standard gas proration unit is situated and which acreage is not included in said non-standard gas proration unit and all operators owning interest within 1500' of the well have been notified by registered mail of this application, as shown on the attached mailing list.

A plat showing acreage to be dedicated, well location and offset ownership is attached.

Yours very truly,

PAN AMERICAN PETROLEUM CORPORATION

*Ralph L. Hendrickson*  
Ralph L. Hendrickson  
Field Superintendent

State of New Mexico  
County of Lea

On this 24th day of July, 1957, before me personally appeared Ralph L. Hendrickson, to me known to be the person who executed the foregoing letter and states the foregoing statements are true to the best of his knowledge and belief.

In Witness whereof, I have hereunto set my hand and affixed my seal on this the day and year first above written.

*[Signature]*  
\_\_\_\_\_  
Notary Public for the State of  
New Mexico, County of Lea

My Commission Expires: 8-3-60



MAILING LIST

New Mexico Oil Conservation Commission  
P.O. Box 2045  
Hobbs, New Mexico

Ohio Oil Company  
P.O. Box 2107  
Hobbs, New Mexico

Magnolia Petroleum Company  
P.O. Box 635  
Midland, Texas

Gulf Oil Corporation  
P.O. Box 2167  
Hobbs, New Mexico

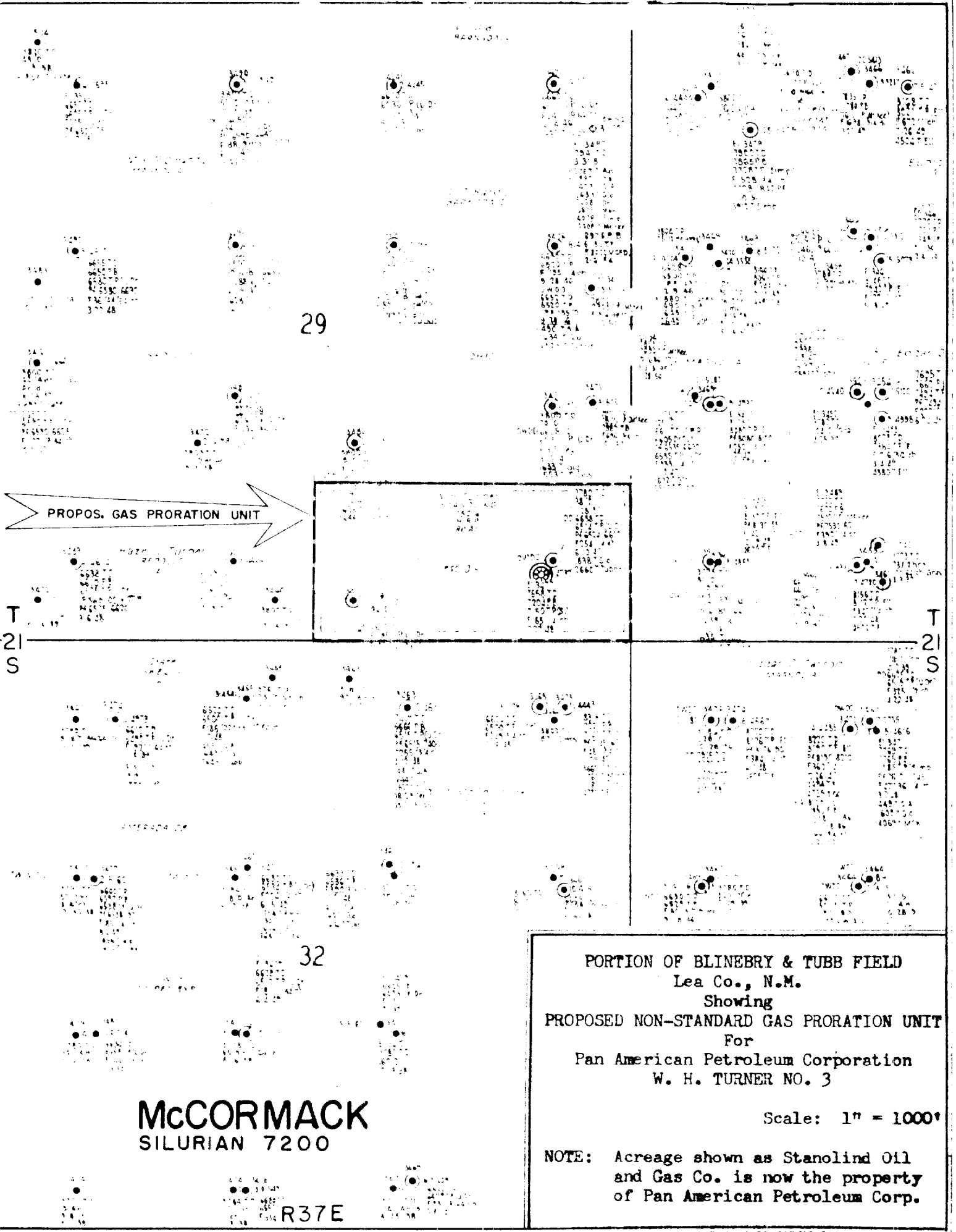

29

PROPOS. GAS PRORATION UNIT

T  
21  
S

T  
21  
S

32

**McCORMACK**  
SILURIAN 7200

R37E

PORTION OF BLINEBRY & TUBB FIELD  
Lea Co., N.M.  
Showing  
PROPOSED NON-STANDARD GAS PRORATION UNIT  
For  
Pan American Petroleum Corporation  
W. H. TURNER NO. 3

Scale: 1" = 1000'

NOTE: Acreage shown as Stanolind Oil  
and Gas Co. is now the property  
of Pan American Petroleum Corp.