

OF CONSERVATION DIVISION

P. O. BOX 2088

SANTA FE, NEW MEXICO 87501

Form C-101
Revised 10-1-78

NO. OF COPIES RECEIVED	
DISTRIBUTION	
SANTA FE	
FILE	
U.S.G.S.	
LAND OFFICE	
OPERATOR	

3A. Indicate Type of Lease
STATE FEE

3. State Oil & Gas Lease No.

APPLICATION FOR PERMIT TO DRILL, DEEPEN, OR PLUG BACK

a. Type of Work

b. Type of Well

DRILL

DEEPEN

PLUG BACK

OIL WELL

GAS WELL

OTHER

SINGLE ZONE

MULTIPLE ZONE

c. Name of Operator

Texaco Inc.

d. Address of Operator

P. O. Box 728, Hobbs, New Mexico 88240

e. Location of Well

UNIT LETTER H

LOCATED 1980

FEET FROM THE North LINE

660

FEET FROM THE East

LINE OF SEC. 30

TWP. 21-S

RCC. 37-E

7. Unit Agreement Name

8. Farm or Lease Name

V. M. Henderson

9. Well No.

3

10. Field and Pool, or Wildcat

Blinebry Oil & Gas

12. County

Lea

19. Proposed Depth

6500'

19A. Formation

Blinebry

20. Rotary or C.T.

f. Elevations (Show whether DF, KI, etc.)

3496' (DF)

21A. Kind & Status Plug. Bond

21B. Drilling Contractor

22. Approx. Date Work will start

August 1, 1986

PROPOSED CASING AND CEMENT PROGRAM

SIZE OF HOLE	SIZE OF CASING	WEIGHT PER FOOT	SETTING DEPTH	SACKS OF CEMENT	EST. TOP
17-1/2"	13-3/8"	48#, H-40	254'	300 sx.	Circulate
10-3/4"	8-5/8"	28#&32#, H-40	2864'	1000 sx.	Circulate
7-7/8"	5-1/2"	15.5#, J-55	6655'	1000 sx.	Circulate

- MIRU. TOH w/4775' rods (already backed off).
- Install BOP, attempt to free tubing.
- If unsuccessful 1st fishing attempt will most likely consist of running string shot to deepest tubing collar available & backoff tubing. Then proceed w/overshot, bumper sub, hydraulic jar, DC's, accelerator on 2-7/8" WS and attempt to jar 2-3/8" tubing out of hole.
- If possible, clean out wellbore to 6500'. If not, clean out to 6100'.
- Set CIBP @ 6500' on wireline, cap with 30' cement using dump bailer.
- Close blinds, pump through tubing head valve, test casing to 500 PSI.
- Rig up wireline packoff, run GR-CNL-CCL log from 4500' to 6500' to chose Blinebry perfs.
- Rig up lubricator (test to 2000 PSI), perf for production w/4" casing gun 5538'-40', 66'-70', 88'-92', 5630'-36', 60'-62', 5700'-02', 5918'-20', 5982'-84', 6000'-02', 2 JSPF, 5825'-50', 5901', 6034', 62', 2 JSPI.

Continued on Page 2

ABOVE SPACE DESCRIBE PROPOSED PROGRAM; IF PROPOSAL IS TO DEEPEN OR PLUG BACK, GIVE DATA ON PRESENT PRODUCTIVE ZONE AND PROPOSED NEW PRODUCTION ZONE. GIVE SLOWOUT PREVENTER PROGRAM, IF ANY.

I hereby certify that the information above is true and complete to the best of my knowledge and belief.

A. J. Seaman

Title Dist. Petr. Engr.

Date July 9, 1986

(This space for State Use)

APPROVED BY Eddie W. Seay
Oil & Gas Inspector

TITLE

DATE

JUL 16 1986

RECEIVED
JUL 15 1986
O.C.D.
HOBBS OFFICE

V. M. Henderson Well No. 3

- 9.) TIH w/treating packer (i.e. Model R), on 2-7/8" WS, testing to 6000 PSI. Circulate, clean 2% KCL.
- 10.) Set packer @ 5250', load backside, pressure to 500 PSI.
- 11.) Acidize Blinebry perfs with 5000 gallons 15% NEFE acid using 50% excess ball sealers (1.3 SG) to divert, ball out, surge off balls, pump remaining acid, flush to bottom perf (rate 3-5 BPM).
- 12.) Recover load and test.
- 13.) Frac Blinebry perfs with 60,000 gallons X-link gel, 120,000 lbs. 20-40 sand (anticipate 25 BPM @ 3770 PSI) (Maximum pressure 6000#).
- 14.) TOH, laying down 2-7/8" WS and packer.
- 15.) TIH with notched collar s/n, on 2-3/8" tubing, clean out to TD, land tubing 50' above top perf.
- 16.) Run pump and rods, hang on, place on production.

RECEIVED
JUL 15 1986
C.C.D.
HOBB'S OFFICE

All distances must be from the outer boundaries of the Section.

Operator Texaco Inc.		Lease V. M. Henderson			Well No. 3
Unit Letter H	Section 30	Township 21-S	Range 37-E	County Lea	
Actual Footage Location of Well: 1980 feet from the North line and 660 feet from the East line					
Ground Level Elev. 3484'	Producing Formation Blinebry		Pool Blinebry Oil & Gas	Dedicated Acreage: 40 Acres	

- Outline the acreage dedicated to the subject well by colored pencil or hachure marks on the plat below.
- If more than one lease is dedicated to the well, outline each and identify the ownership thereof (both as to working interest and royalty).
- If more than one lease of different ownership is dedicated to the well, have the interests of all owners been consolidated by communitization, unitization, force-pooling, etc?
 Yes No If answer is "yes," type of consolidation _____

If answer is "no," list the owners and tract descriptions which have actually been consolidated. (Use reverse side of this form if necessary.) _____
 No allowable will be assigned to the well until all interests have been consolidated (by communitization, unitization, forced-pooling, or otherwise) or until a non-standard unit, eliminating such interests, has been approved by the Division.

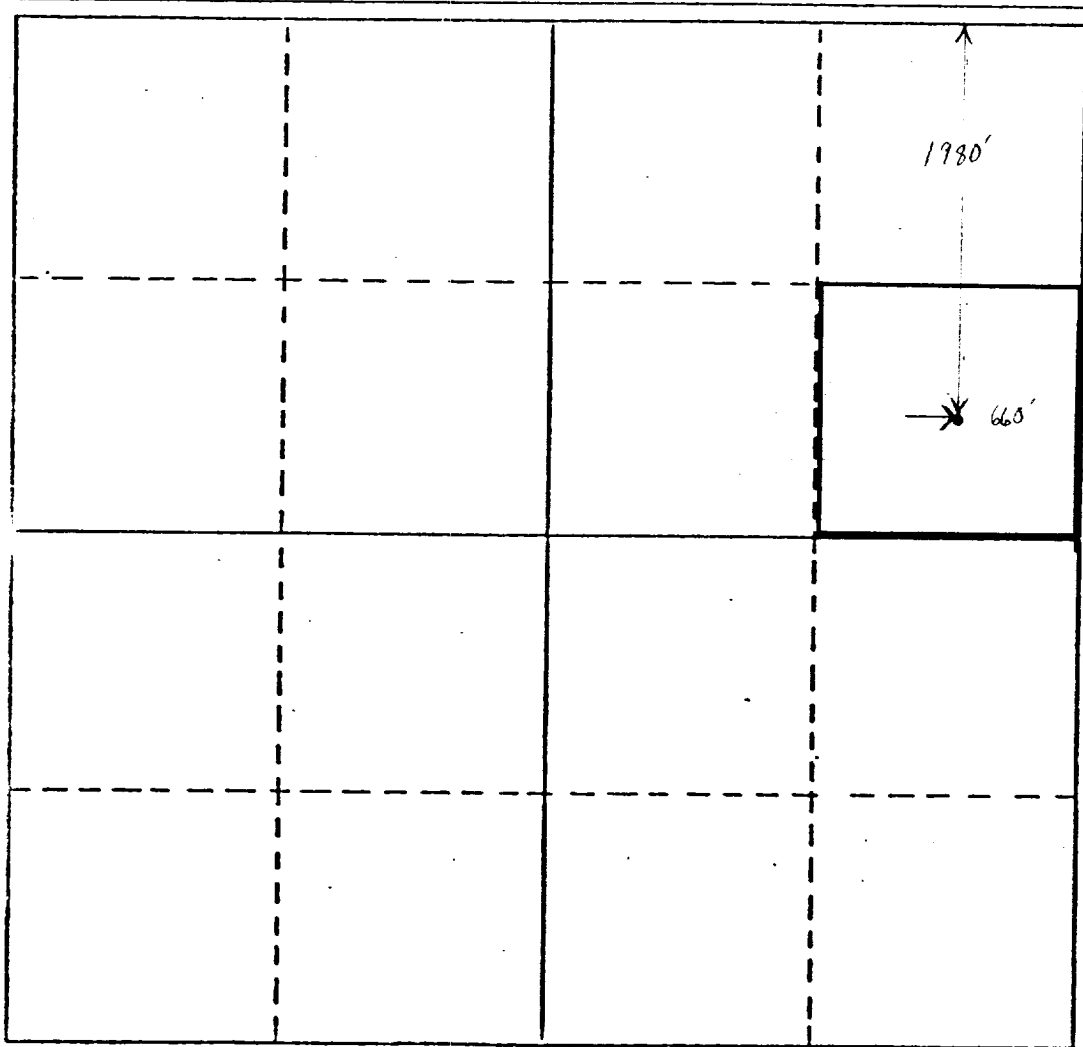

CERTIFICATION

I hereby certify that the information contained herein is true and complete to the best of my knowledge and belief.

L. J. Seeman
Name

L. J. Seeman

Position
Dist. Petr. Eng.

Company
Texaco Inc.

Date
July 8, 1986

I hereby certify that the well location shown on this plat was plotted from field notes of actual surveys made by me or under my supervision, and that the same is true and correct to the best of my knowledge and belief.

Date Surveyed

Registered Professional Engineer and/or Land Surveyor

Certificate No.

