

DUPLICATE

NOTICE OF INTENTION TO DRILL

Notice must be given to the District Office of the Oil Conservation Commission and approval obtained before drilling or recompletion begins. If changes in the proposed plan are considered advisable, a copy of this notice showing such changes will be returned to the sender. Submit this notice in **QUINTUPPLICATE**. One copy will be returned following approval. See additional instructions in Rules and Regulations of the Commission. If State Land submit 6 Copies Attach Form C- 128 in triplicate to first 3 copies of form C-101

Midland, Texas

August 30, 1961

(Place)

(Date)

OIL CONSERVATION COMMISSION
SANTA FE, NEW MEXICO

Gentlemen:

You are hereby notified that it is our intention to commence the Drilling of a well to be known as

TEXACO Inc.

(Company or Operator)

V. M. Henderson

(Lessee)

Well No. 6

in C (Unit)

The well is

to 760 feet from the North line and 1980 feet from the West

(GIVE LOCATION FROM SECTION LINE)

Line of Section 30 T-21-S R.-37-E, NMPM.

(1) Undesignated (oil), (2) Undesignated (gas), Pool, Lea County

(3) Undesignated (oil) If State Land the Oil and Gas Lease is No. - - -

If patented land the owner is V. M. Henderson

Address 1407 Boatmen's Bk. Bldg., St. Louis, Mo.

We propose to drill well with drilling equipment as follows: Rotary

The status of plugging bond is \$10,000. blanket surety bond of Maryland Casualty Co. has been filed with State Geologist.

Drilling Contractor Not known at present

(1) Paddock (oil) (2) Blinebry (gas)

We intend to complete this well in the (3) Drinkard (oil)

formation at an approximate depth of 6700 feet.

CASING PROCEEDURE

We propose to use the following strings of Casing and to cement them as indicated:

Size of Hole	Size of Casing	Weight per Foot	New or Second Hand	Depth	Backs Cement
12-1/4"	9-5/8"	32#	New	1240	800
8-3/4"	7"	20, 23 & 26#	New	6550 6700	750

If changes in the above plans become advisable we will notify you immediately.

ADDITIONAL INFORMATION (If recompletion give full details of proposed plan of work.)

FORMATIONS EXPECTED: Top of San Andres 3953' Top of Tubb 6168'
Top of Anhydrite 1200' " " Glorieta 5105' " " Drinkard Parasyty 6561'
" " Yates 2600' " " Paddock Pay 5159' Total Depth 6700'
" " Grayburg 3638' Blinebry 5526'

CEMENT MUST BE CIRCULATED BEHIND CASING.

Approved: *[Signature]*
Except as follows: *[Signature]*
into *[Signature]*

OIL CONSERVATION COMMISSION

Sincerely yours,

TEXACO Inc.
(Company or Operator)

By: J. J. Velten

Position: Division Civil Engineer
Send Communications regarding well to

Name: TEXACO Inc.

Address: P. O. Box 3109, Midland, Texas

NEW MEXICO OIL CONSERVATION COMMISSION
WELL LOCATION AND ACREAGE DEDICATION PLAT

FORM C-128
Revised 5/1/57

SEE INSTRUCTIONS FOR COMPLETING THIS FORM ON THE REVERSE SIDE

Operator TEXACO Inc.				SECTION A 1961 AUG 31 AM 10:04 Lease V. M. Henderson		Well No. 6*
Unit Letter C	Section 30	Township 21 South	Range 37 East	County Lea		
Actual Footage Location of Well: 760 feet from the North line and 1980 feet from the West line Sec. 30						
Ground Level Elev. 3496	Producing Formation Paddock(oil)		Pool Undesignated		Dedicated Acreage: 40 Acres	

- * To be a triple with Blinbry(gas) & Drinkard(oil)
1. Is the Operator the only owner in the dedicated acreage outlined on the plat below? YES ☒ NO ____ . ("Owner" means the person who has the right to drill into and to produce from any pool and to appropriate the production either for himself or for himself and another. (65-3-29 (e) NMSA 1935 Comp.)
 2. If the answer to question one is "no," have the interests of all the owners been consolidated by communitization agreement or otherwise? YES ____ NO ____ . If answer is "yes," Type of Consolidation ____
 3. If the answer to question two is "no," list all the owners and their respective interests below:

Owner	Land Description

SECTION B

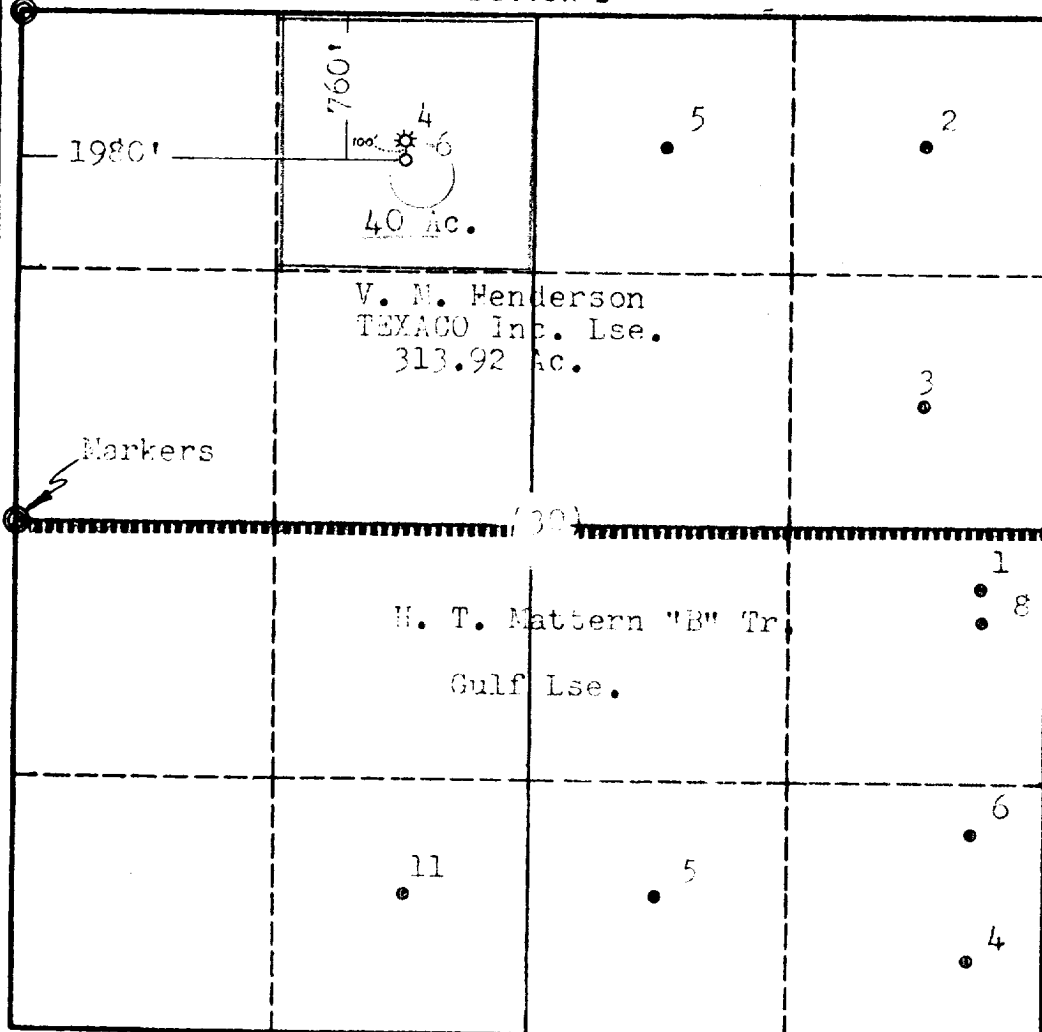

CERTIFICATION

I hereby certify that the information in SECTION A above is true and complete to the best of my knowledge and belief.

Name
J. J. Velten
Position
Division Civil Engineer
Company
TEXACO Inc.
Date
8/30/61

I hereby certify that the well location shown on the plat in SECTION B was plotted from field notes of actual surveys made by me or under my supervision, and that the same is true and correct to the best of my knowledge and belief.

Date Surveyed
8/29/61
Registered Professional Engineer
and/or Land Surveyor
J. J. Velten

Certificate No. 8174

NEW MEXICO OIL CONSERVATION COMMISSION
WELL LOCATION AND ACREAGE DEDICATION PLAT

FORM C-128
Revised 5/1/57

SEE INSTRUCTIONS FOR COMPLETING THIS FORM ON THE REVERSE SIDE

SECTION A

Operator TEXACO Inc.		Lease V. M. Henderson		1961 AUG 31 AM		Well No. * 10-04 6	
Unit Letter C	Section 30	Township 21 South	Range 37 East	County Lea			
Actual Footage Location of Well: 760 feet from the North line and 1980 feet from the West line							
Ground Level Elev. 3496	Producing Formation Drinkard(oil)		Pool Undesignated		Dedicated Acreage: 40 Acres		

- * To be a triple with Paddock(oil) & Blinebry(gas)
1. Is the Operator the only owner in the dedicated acreage outlined on the plat below? YES ☒ NO ____ . ("Owner" means the person who has the right to drill into and to produce from any pool and to appropriate the production either for himself or for himself and another. (65-3-29 (e) NMSA 1935 Comp.)
 2. If the answer to question one is "no," have the interests of all the owners been consolidated by communitization agreement or otherwise? YES ____ NO ____ . If answer is "yes," Type of Consolidation ____
 3. If the answer to question two is "no," list all the owners and their respective interests below:

Owner	Land Description

SECTION B

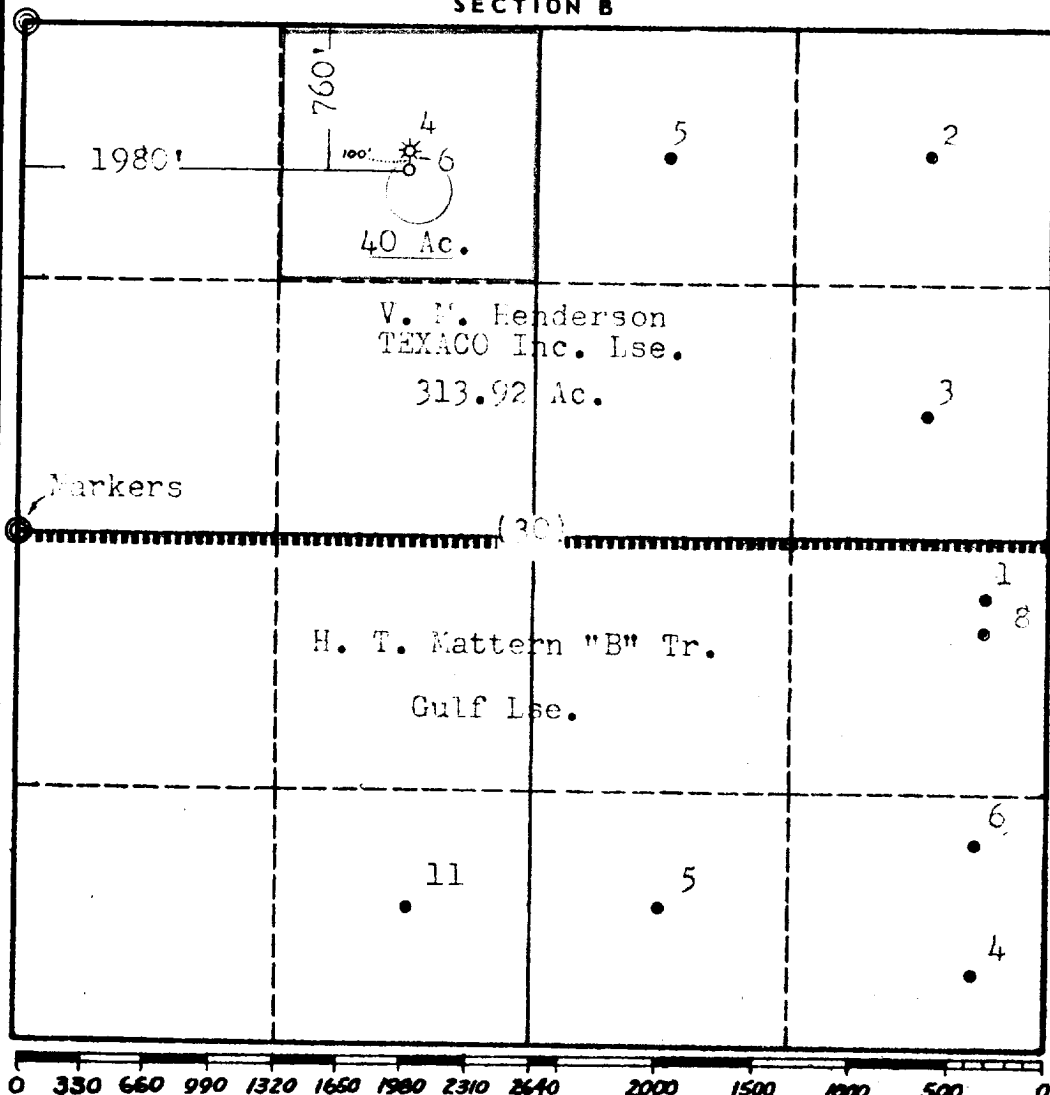

CERTIFICATION

I hereby certify that the information in SECTION A above is true and complete to the best of my knowledge and belief.

Name J. J. Velten
Position Division Civil Engineer
Company TEXACO Inc.
Date 8/30/61

I hereby certify that the well location shown on the plat in SECTION B was plotted from field notes of actual surveys made by me or under my supervision, and that the same is true and correct to the best of my knowledge and belief.

Date Surveyed 8/29/61
Registered Professional Engineer and/or Land Surveyor J. J. Velten
Certificate No. 8174