

NEW MEXICO OIL CONSERVATION COMMISSION

Well Location and Acreage Dedication Plat

Section A.

RECORDS OFFICE 000
Date NOV 7 AM 9:51 November 5, 1957

Operator TRES OIL COMPANY Lease Gill
Well No. 1-A Unit Letter L Section 31 Township 21 S Range 37 E NMPM
Located 1980 Feet From South Line, 612 Feet From West Line
County Lea G. L. Elevation _____ Dedicated Acreage 40 Acres
Name of Producing Formation Grayburg Pool Arrowhead

1. Is the Operator the only owner* in the dedicated acreage outlined on the plat below?
Yes x No _____.
2. If the answer to question one is "no," have the interests of all the owners been consolidated by communitization agreement or otherwise? Yes _____ No _____. If answer is "yes," Type of Consolidation _____
3. If the answer to question two is "no," list all the owners and their respective interests below:

Owner

Land Description

Section B

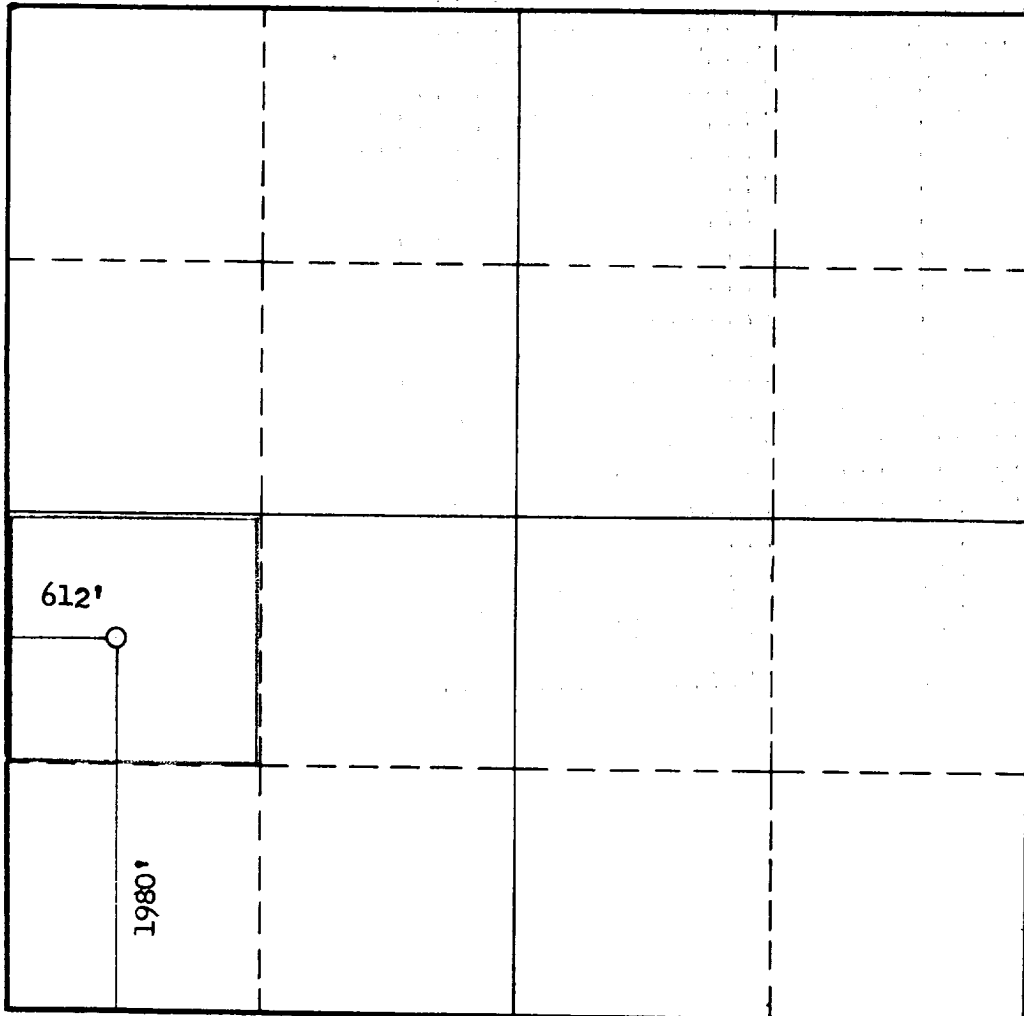

This is to certify that the information in Section A above is true and complete to the best of my knowledge and belief.

TRES OIL COMPANY
(Operator)

M. A. Hobbs
(Representative)

Box 1628, Hobbs, N. M.
Address

This is to certify that the well location shown on the plat in Section B was plotted from field notes of actual surveys made by me or under my supervision and that the same is true and correct to the best of my knowledge and belief.

Date Surveyed 11/5/57

George A. Hirschfeld
Registered Professional
Engineer and/or Land Surveyor.

Certificate No. 1528

(See instructions for completing this form on the reverse side)