

NO. OF COPIES RECEIVED	
DISTRIBUTION	
SANTA FE	
FILE	
U.S.G.S.	
LAND OFFICE	
OPERATOR	

NEW MEXICO OIL CONSERVATION COMMISSION

Form C-101
Revised 1-1-65

5A. Indicate Type of Lease	
STATE <input type="checkbox"/>	FEE <input checked="" type="checkbox"/>
5. State Oil & Gas Lease No.	

APPLICATION FOR PERMIT TO DRILL, DEEPEN, OR PLUG BACK

1a. Type of Work		7. Unit Agreement Name	
b. Type of Well DRILL <input type="checkbox"/> DEEPEN <input checked="" type="checkbox"/> Within Csg. PLUG BACK <input type="checkbox"/> OIL WELL <input checked="" type="checkbox"/> GAS WELL <input type="checkbox"/> OTHER <input type="checkbox"/> SINGLE ZONE <input checked="" type="checkbox"/> MULTIPLE ZONE <input type="checkbox"/>		8. Farm or Lease Name Carson, E. O.	
2. Name of Operator Mobil Producing TX. & N.M. Inc.		9. Well No. 10	
3. Address of Operator P. O. Box 633, Midland, Texas Attention: Env. & Reg. Dept.		10. Field and Pool, or Wildcat Hare Simpson	
4. Location of Well UNIT LETTER <u>F</u> LOCATED <u>2051</u> FEET FROM THE <u>north</u> LINE AND <u>1909</u> FEET FROM THE <u>west</u> LINE OF SEC. <u>33</u> TWP. <u>21-S</u> RGE. <u>37-E</u> NMPM		12. County Lea	
19. Proposed Depth PBD @ 7985'		19A. Formation Simpson	20. Rotary or C.T. Work Over
21. Elevations (Show whether DF, RT, etc.) 3464' DF	21A. Kind & Status Plug. Bond Active Blanket	21B. Drilling Contractor Work Over Rig	22. Approx. Date Work will start 2-10-87

Original PROPOSED CASING AND CEMENT PROGRAM

SIZE OF HOLE	SIZE OF CASING	WEIGHT PER FOOT	SETTING DEPTH	SACKS OF CEMENT	EST. TOP
---	13-3/8"	48#	327'	250	Surface
---	9-5/8"	--	3786'	1050	Surface
8-3/4"	7"	23#	6620'	450	---
6-3/4"	5" Liner	15#	6027-8216'	150	Above TOL

R/C FROM CARY MONTOYA FIELD

Operation to deepen within casing and test McKee and Connell Sands.

1. MI, RU, set cmt retainer @ 7200', sq. Montoya perms W/150 sx cmt, POH.
2. Drill out cmt retainers @ 7200' and 7550', clean out to TD @ 8020', pressure test, resq. if necessary. Run GRN log 8020-7600', POH.
3. Perf Connell Sand 7912-7931', W/2 JSPF, POH.
4. Acidize W/2000 gals 15% HCl W/additives & 40 RCNBS, recover load. Frac (if necessary) W/35,000 gals Ottawa sand (20-40), SION.
5. Recover load, perf McKee Sand 7851-7860' W/2 JSPF, test.
6. Acidize W/1200 gals 15% HCl W/additives and 24 RCNBS, recover load, test.
7. RD and MO PU.

IN ABOVE SPACE DESCRIBE PROPOSED PROGRAM: IF PROPOSAL IS TO DEEPEN OR PLUG BACK, GIVE DATA ON PRESENT PRODUCTIVE ZONE AND PROPOSED NEW PRODUCTIVE ZONE. GIVE BLOWOUT PREVENTER PROGRAM, IF ANY.

I hereby certify that the information above is true and complete to the best of my knowledge and belief.

Signed M. E. Sweeney Title Env. & Regulatory Manager Date February 2, 1987
(This space for State Use)

ORIGINAL SIGNED BY JERRY SEXTON

APPROVED BY DISTRICT I SUPERVISOR TITLE DATE FEB 5 1987

CONDITIONS OF APPROVAL, IF ANY:

RECEIVED
FEB 4 1967
OCC
HUBB'S OFFICE

All distances must be from the outer boundaries of the Section.

Operator Mobil Producing TX. & N.M. Inc.		Lease Carson, E. O.		Well No. 10	
Well Letter F	Section 33	Township 21-S	Range 37-E	County Lea	
Actual Footage Location of Well: 2051 feet from the north line and 1909 feet from the west line					
Ground Level Elev. 3464' DF	Producing Formation Simpson		Pool Hare		Dedicated Acreage: 40 Acres

1. Outline the acreage dedicated to the subject well by colored pencil or hatchure marks on the plat below.
2. If more than one lease is dedicated to the well, outline each and identify the ownership thereof (both as to working interest and royalty).
3. If more than one lease of different ownership is dedicated to the well, have the interests of all owners been consolidated by communitization, unitization, force-pooling, etc?

☐ Yes ☐ No If answer is "yes," type of consolidation _____

If answer is "no," list the owners and tract descriptions which have actually been consolidated. (Use reverse side of this form if necessary.) _____

No allowable will be assigned to the well until all interests have been consolidated (by communitization, unitization, forced-pooling, or otherwise) or until a non-standard unit, eliminating such interests, has been approved by the Division.

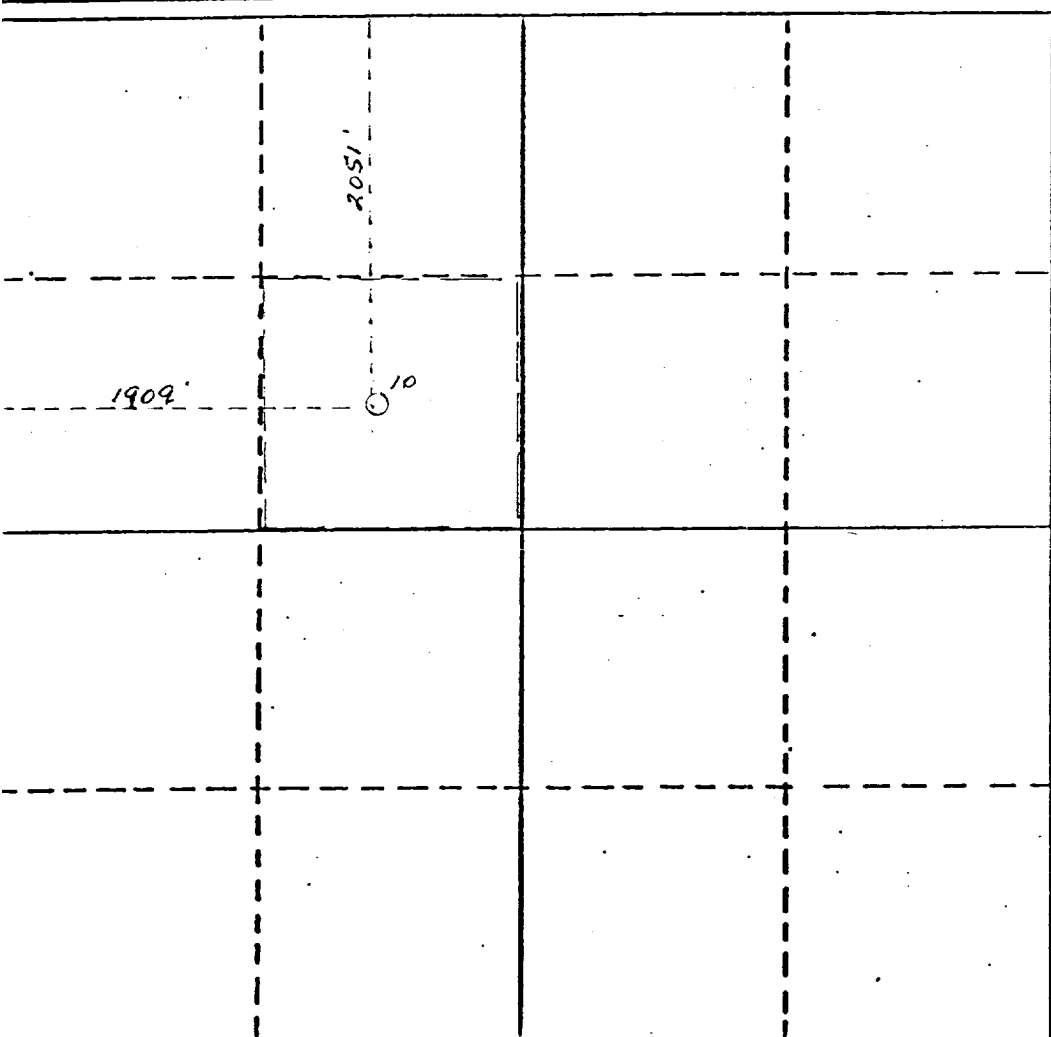

CERTIFICATION

I hereby certify that the information contained herein is true and complete to the best of my knowledge and belief.

M. E. Sweeney

Name

M. E. Sweeney

Position

Env. & Regulatory Manager

Company

Mobil Producing TX. & N.M. Inc.

Date

February 2, 1987

I hereby certify that the well location shown on this plat was plotted from field notes of actual surveys made by me or under my supervision, and that the same is true and correct to the best of my knowledge and belief.

Date Surveyed

Registered Professional Engineer
and/or Land Surveyor

Certificate No.

330 660 80 1320 1650 1980 2310 2640 2000 1500 1000 500 0

RECEIVED
FEB 4 1981
OCD
HOBBS OFFICE