

NO. OF COPIES RECEIVED	
DISTRIBUTION	
SANTA FE	
FILE	
U.S.G.S.	
LAND OFFICE	
OPERATOR	

NEW MEXICO OIL CONSERVATION COMMISSION

Form C-101
Revised 1-1-65

5A. Indicate Type of Lease	
STATE <input type="checkbox"/>	FEE <input checked="" type="checkbox"/>
5. State Oil & Gas Lease No.	

APPLICATION FOR PERMIT TO DRILL, DEEPEN, OR PLUG BACK

1a. Type of Work		7. Unit Agreement Name	
b. Type of Well DRILL <input type="checkbox"/> DEEPEN <input checked="" type="checkbox"/> PLUG BACK <input type="checkbox"/> OIL WELL <input checked="" type="checkbox"/> GAS WELL <input type="checkbox"/> OTHER <input type="checkbox"/> SINGLE ZONE <input checked="" type="checkbox"/> MULTIPLE ZONE <input type="checkbox"/>		8. Farm or Lease Name E.O. CARSON	
2. Name of Operator MOBIL PRODUCING TEXAS AND NEW MEXICO, INC.		9. Well No. 10	
3. Address of Operator P.O. BOX 633, MIDLAND, TEXAS 79702		10. Field and Pool, or Wildcat UNDESIGNATED	
4. Location of Well UNIT LETTER F LOCATED 2051' FEET FROM THE NORTH LINE AND 1909' FEET FROM THE WEST LINE OF SEC. 33 TWP. 21-S RGE. 37-E NMPM			
		12. County LEA	
		19. Proposed Depth 7985'	19A. Formation MONTOKA
		20. Rotary or C.T. ROTARY	
21. Elevations (Show whether DF, RT, etc.) 3464' DF	21A. Kind & Status Plug. Bond ON FILE	21B. Drilling Contractor UNKOWN	22. Approx. Date Work will start AS SOON AS POSSIBLE

23. PROPOSED CASING AND CEMENT PROGRAM					
SIZE OF HOLE	SIZE OF CASING	WEIGHT PER FOOT	SETTING DEPTH	SACKS OF CEMENT	EST. TOP
ON FILE					

- MIRU - POH w/rods - ND wellhead. NU & test BOP. POH w/tbg.
- Set cmt. retainer @ 5050' and sqz Paddock 5150'-5165', 5198'-5208', 5264'-5276'.
- Drill out & test sqz.
- Drill out CIBP and run bit in 5" csg. to \pm 8100'.
- Set 5" CIBP @ 020' & cap w/35' cmt. PBTB @ 7985'.
- Log well and perf Montoya w/2 JSPF. Perfs to be determined. Swab & evaluate.
- Acidize Montoya w/200 gal/ft 15% HCL & RCNBS.
- Put well on production & evaluate.
- Clean location. RD & release pulling unit.

BOP PROGRAM:

CASING STRING

Producing - 7"

API SERIES & SIZE

900 8"

PRESSURE

3000# working press.
6000# test press.

IN ABOVE SPACE DESCRIBE PROPOSED PROGRAM; IF PROPOSAL IS TO DEEPEN OR PLUG BACK, GIVE DATA ON PRESENT PRODUCTIVE ZONE AND PROPOSED NEW PRODUCTIVE ZONE. GIVE BLOWOUT PREVENTER PROGRAM, IF ANY.

I hereby certify that the information above is true and complete to the best of my knowledge and belief.

Signed P.D. Crow for G.E. TATE Title ENV. & REGULATORY MANAGER Date NOVEMBER 18th, 1985

(This space is for use by)

Oil & Gas Inspector

APPROVED BY _____ TITLE _____ DATE **NOV 20 1985**

CONDITIONS OF APPROVAL, IF ANY:

All distances must be from the outer boundaries of the Section.

Operator MOBIL PRODUCING TEXAS AND NEW MEXICO		Lease E.O. CARSON		Well No. 10
Unit Letter F	Section 33	Township 21-SOUTH	Range 37-EAST	County LEA
Actual Footage Location of Well: 2051' feet from the NORTH line and 1909' feet from the WEST line				
Ground Level Elev. 3452'	Producing Formation MONTROYA	Pool UNDESIGNATED	Dedicated Acreage: 40 Acres	

1. Outline the acreage dedicated to the subject well by colored pencil or hachure marks on the plat below.
2. If more than one lease is dedicated to the well, outline each and identify the ownership thereof (both as to working interest and royalty).
3. If more than one lease of different ownership is dedicated to the well, have the interests of all owners been consolidated by communitization, unitization, force-pooling, etc?

☐ Yes ☐ No If answer is "yes," type of consolidation _____

If answer is "no," list the owners and tract descriptions which have actually been consolidated. (Use reverse side of this form if necessary.) _____

No allowable will be assigned to the well until all interests have been consolidated (by communitization, unitization, forced-pooling, or otherwise) or until a non-standard unit, eliminating such interests, has been approved by the Division.

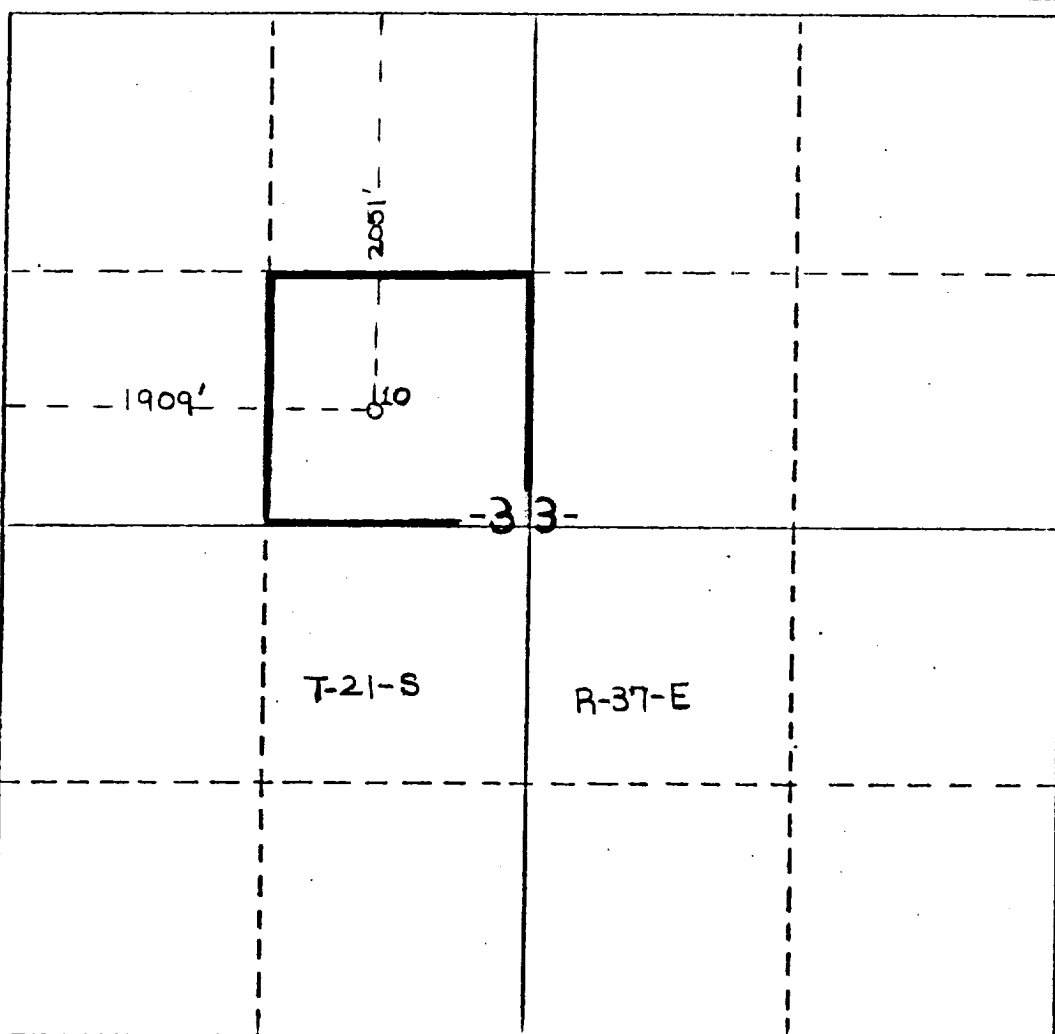

CERTIFICATION

I hereby certify that the information contained herein is true and complete to the best of my knowledge and belief.

S.D. Clow for G.E. Tate

Name
G.E. TATE

Position
ENV. AND REGULATORY MANAGER

Company
MOBIL PRODUCING TX & NM, INC.

Date
NOVEMBER 18th, 1985

I hereby certify that the well location shown on this plat was plotted from field notes of actual surveys made by me or under my supervision, and that the same is true and correct to the best of my knowledge and belief.

Date Surveyed

Registered Professional Engineer
and/or Land Surveyor

Certificate No.

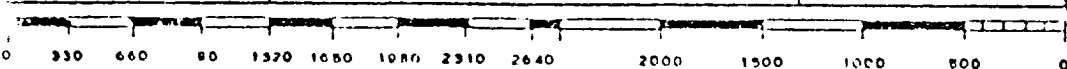

RECEIVED
NOV 19 1985
O.C.D.
HOBBS OFFICE