

NEW MEXICO OIL CONSERVATION COMMISSION

Santa Fe, New Mexico

NOTICE OF INTENTION TO DRILL

MAY 26 1947

Notice must be given to the Oil Conservation Commission or its proper agent and approval obtained before drilling begins. If changes in the proposed plan are considered advisable, a copy of this notice showing such changes must be returned to the sender. Submit this notice in triplicate. One copy will be returned following approval. See additional instructions in Rules and Regulations of the Commission.

Dallas 1, Texas

May 20, 1947

OIL CONSERVATION COMMISSION,
Santa Fe, New Mexico,

PLACE

DATE

Gentlemen:

You are hereby notified that it is our intention to commence the drilling of a well to be known as

MAGNOLIA PETROLEUM COMPANY

E. O. Carson

Well No. 13

in SE 1/4 SW 1/4 NE 1/4

COMPANY OR OPERATOR

LEASE

of Sec. 33, T. 21 south, R. 37 east, N. M. P. M., Burdick Brunson Field, Lea County.

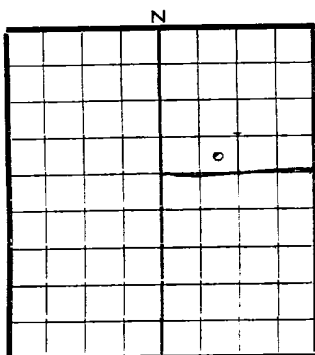

AREA 640 ACRES
LOCATE WELL CORRECTLY

The well is 589' feet (N.) of the South line and 589' feet (W.) of the East line of SE 1/4 of the SW 1/4 of the NE 1/4

(Give location from section or other legal subdivision lines. Cross out wrong directions.)

If state land the oil and gas lease is No. Assignment No.

If patented land the owner is E. O. Carson

Address Merkel, Texas

If government land the permittee is

Address

The lessee is

Address

We propose to drill well with drilling equipment as follows:

Rotary

The status of a bond for this well in conformance with Rule 39 of the General Rules and Regulations of the Commission is as follows: Financial Statement of Company filed with Commission and in First Judicial District of New Mexico.

We propose to use the following strings of casing and to land or cement them as indicated:

SIZE OF HOLE	SIZE OF CASING	WEIGHT PER FOOT	NEW OR SECOND HAND	DEPTH	LANDED OR CEMENTED	SACKS CEMENT
17-1/4"	13-3/8"	48#	New	350'	Cemented	250
11"	8-5/8"	32#	New	3900'	Cemented	875
7-7/8"	5-1/2"	17#	New	7700'	Cemented	675

If changes in the above plan become advisable we will notify you before cementing or landing casing. We estimate that the first productive oil or gas sand should occur at a depth of about 7700' feet.

Additional information:

Approved _____, 19____

Except as follows:

OIL CONSERVATION COMMISSION,

By _____

Title _____

Oil & Gas Inspector

Sincerely yours,

MAGNOLIA PETROLEUM COMPANY

COMPANY OR OPERATOR

By _____

Position Field Superintendent

Send communications regarding well to

Name S. C. McFarlane

Address Box 900, Dallas 1, Texas

Eunice Area - (Ellenburger Pay)

Magnolia Petroleum Company

PRODUCING DEPARTMENT

Location made May 19th, 194 7

E. O. Carson Well No. 13

Lea District

Lease A-8 NM. 612 acres 320 Sec. 33, T21S, R37E { District Township

Lea County, New Mexico

Scale 1"=500' N S E W

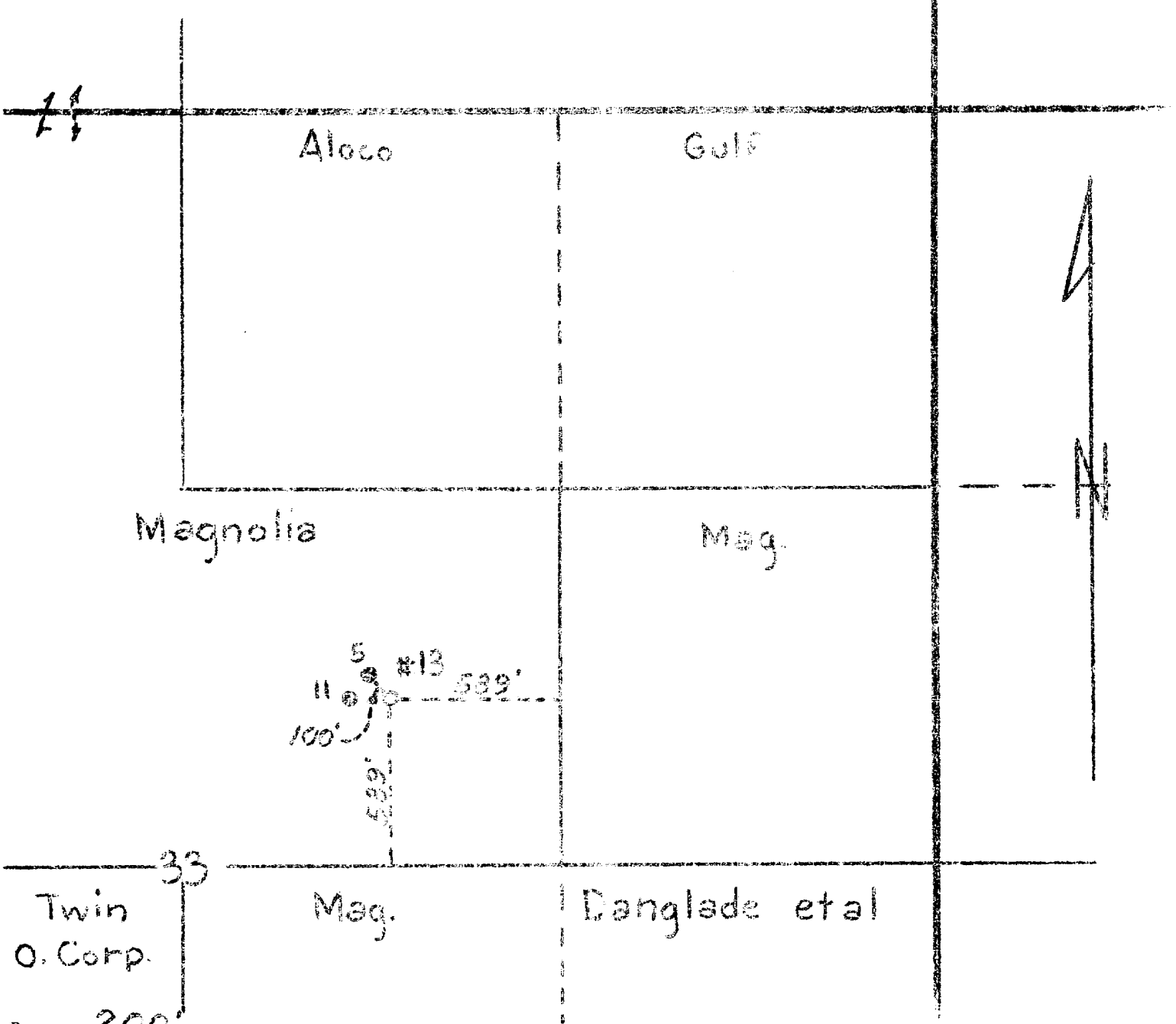

Special instructions

Location changed on account of

Date work is commenced _____, 194 7 R. M. Brady Supt.

Location approved by _____ Plat made by R. M. Brady

Magnolia Petroleum Company
PRODUCING DEPARTMENT

Location for Well No. _____

File No. _____

ELT