

ILLEGIBLE

24. 3-4. 0. 1. 2. 3. 4. 5. 6. 7. 8. 9. 10. 11. 12. 13. 14. 15. 16. 17. 18. 19. 20. 21. 22. 23. 24. 25. 26. 27. 28. 29. 30. 31. 32. 33. 34. 35. 36. 37. 38. 39. 40. 41. 42. 43. 44. 45. 46. 47. 48. 49. 50. 51. 52. 53. 54. 55. 56. 57. 58. 59. 60. 61. 62. 63. 64. 65. 66. 67. 68. 69. 70. 71. 72. 73. 74. 75. 76. 77. 78. 79. 80. 81. 82. 83. 84. 85. 86. 87. 88. 89. 90. 91. 92. 93. 94. 95. 96. 97. 98. 99. 100. 101. 102. 103. 104. 105. 106. 107. 108. 109. 110. 111. 112. 113. 114. 115. 116. 117. 118. 119. 120. 121. 122. 123. 124. 125. 126. 127. 128. 129. 130. 131. 132. 133. 134. 135. 136. 137. 138. 139. 140. 141. 142. 143. 144. 145. 146. 147. 148. 149. 150. 151. 152. 153. 154. 155. 156. 157. 158. 159. 160. 161. 162. 163. 164. 165. 166. 167. 168. 169. 170. 171. 172. 173. 174. 175. 176. 177. 178. 179. 180. 181. 182. 183. 184. 185. 186. 187. 188. 189. 190. 191. 192. 193. 194. 195. 196. 197. 198. 199. 200. 201. 202. 203. 204. 205. 206. 207. 208. 209. 210. 211. 212. 213. 214. 215. 216. 217. 218. 219. 220. 221. 222. 223. 224. 225. 226. 227. 228. 229. 230. 231. 232. 233. 234. 235. 236. 237. 238. 239. 240. 241. 242. 243. 244. 245. 246. 247. 248. 249. 250. 251. 252. 253. 254. 255. 256. 257. 258. 259. 260. 261. 262. 263. 264. 265. 266. 267. 268. 269. 270. 271. 272. 273. 274. 275. 276. 277. 278. 279. 280. 281. 282. 283. 284. 285. 286. 287. 288. 289. 290. 291. 292. 293. 294. 295. 296. 297. 298. 299. 300. 301. 302. 303. 304. 305. 306. 307. 308. 309. 310. 311. 312. 313. 314. 315. 316. 317. 318. 319. 320. 321. 322. 323. 324. 325. 326. 327. 328. 329. 330. 331. 332. 333. 334. 335. 336. 337. 338. 339. 340. 341. 342. 343. 344. 345. 346. 347. 348. 349. 350. 351. 352. 353. 354. 355. 356. 357. 358. 359. 360. 361. 362. 363. 364. 365. 366. 367. 368. 369. 370. 371. 372. 373. 374. 375. 376. 377. 378. 379. 380. 381. 382. 383. 384. 385. 386. 387. 388. 389. 390. 391. 392. 393. 394. 395. 396. 397. 398. 399. 400. 401. 402. 403. 404. 405. 406. 407. 408. 409. 410. 411. 412. 413. 414. 415. 416. 417. 418. 419. 420. 421. 422. 423. 424. 425. 426. 427. 428. 429. 430. 431. 432. 433. 434. 435. 436. 437. 438. 439. 440. 441. 442. 443. 444. 445. 446. 447. 448. 449. 450. 451. 452. 453. 454. 455. 456. 457. 458. 459. 460. 461. 462. 463. 464. 465. 466. 467. 468. 469. 470. 471. 472. 473. 474. 475. 476. 477. 478. 479. 480. 481. 482. 483. 484. 485. 486. 487. 488. 489. 490. 491. 492. 493. 494. 495. 496. 497. 498. 499. 500. 501. 502. 503. 504. 505. 506. 507. 508. 509. 510. 511. 512. 513. 514. 515. 516. 517. 518. 519. 520. 521. 522. 523. 524. 525. 526. 527. 528. 529. 530. 531. 532. 533. 534. 535. 536. 537. 538. 539. 540. 541. 542. 543. 544. 545. 546. 547. 548. 549. 550. 551. 552. 553. 554. 555. 556. 557. 558. 559. 560. 561. 562. 563. 564. 565. 566. 567. 568. 569. 570. 571. 572. 573. 574. 575. 576. 577. 578. 579. 580. 581. 582. 583. 584. 585. 586. 587. 588. 589. 590. 591. 592. 593. 594. 595. 596. 597. 598. 599. 600. 601. 602. 603. 604. 605. 606. 607. 608. 609. 610. 611. 612. 613. 614. 615. 616. 617. 618. 619. 620. 621. 622. 623. 624. 625. 626. 627. 628. 629. 630. 631. 632. 633. 634. 635. 636. 637. 638. 639. 640. 641. 642. 643. 644. 645. 646. 647. 648. 649. 650. 651. 652. 653. 654. 655. 656. 657. 658. 659. 660. 661. 662. 663. 664. 665. 666. 667. 668. 669. 670. 671. 672. 673. 674. 675. 676. 677. 678. 679. 680. 681. 682. 683. 684. 685. 686. 687. 688. 689. 690. 691. 692. 693. 694. 695. 696. 697. 698. 699. 700. 701. 702. 703. 704. 705. 706. 707. 708. 709. 710. 711. 712. 713. 714. 715. 716. 717. 718. 719. 720. 721. 722. 723. 724. 725. 726. 727. 728. 729. 730. 731. 732. 733. 734. 735. 736. 737. 738. 739. 740. 741. 742. 743. 744. 745. 746. 747. 748. 749. 750. 751. 752. 753. 754. 755. 756. 757. 758. 759. 760. 761. 762. 763. 764. 765. 766. 767. 768. 769. 770. 771. 772. 773. 774. 775. 776. 777. 778. 779. 780. 781. 782. 783. 784. 785. 786. 787. 788. 789. 790. 791. 792. 793. 794. 795. 796. 797. 798. 799. 800. 801. 802. 803. 804. 805. 806. 807. 808. 809. 810. 811. 812. 813. 814. 815. 816. 817. 818. 819. 820. 821. 822. 823. 824. 825. 826. 827. 828. 829. 830. 831. 832. 833. 834. 835. 836. 837. 838.

[illegible]

Acid (3786-3974) 1500 gals
Base (3788-5878) 15,000 gals wtr + 75,000% sd
Sizing (3789-5878) 1500 gals
Flow 14, 1147, 1150" unk, 2 hrs, IP 915#
Flow 122, 1147, 1150" unk, 1 hr, IP 1111#
Flow 136 ML/APR, 1150" unk, 1 hr, CP 1114
Flow 137, 1150" 1150" unk, 1 hr, IP 1150#
Flow 138, 1150" 1150" unk, 1 hr, IP 1150#

1-610-21-1

COUNTY	Lea	FIELD	Hare	STATE	N.M.	NO.	OWWO
QPR	Socony Mobil Oil Company, Inc.						MAP
N2	14	LSE	Carson, E. O.				
SEC	33	T.	21S	BLK.	37E	SUR	CO-ORD.
LOC	731' fr N Line & 1909' fr W Line of Sec.						
Re-	MI.	FROM	Re-	CLASS.	EL. 3471' L&S		
SPUD	8-8-63	COMP.	8-28-63	FORMATION	DATUM	FORMATION	DATUM
IFT.							
CSG. & SX.							
	5 1/2"	8220'	1575				
TBS.	DEPTH	SIZE					
LOGS	EL	GR	RA	IND	HC	A	
				TD	8220'	PB	
PROD INT.	(DAILY RATE)	BS&W	GH	GOR	GTY	C. P.	T. P.
TEMPORARILY ABANDONED							
Distribution limited and publication prohibited by subscribers' agreement. Reproduction rights reserved by Williams & Lee Scouting Service, Inc.							
CONT.	PROP DEPTH			TYPE			
DATE							

9-23-63 F.R.C. 9-26-63, OWWO, OTD 8220'
 TD 8220', TEMPORARILY ABANDONED
 Squeezed Perfs (McKee) 7630-56' w/100 sx.
 Perf 7754-70' w/1 SPF
 Ac. W/500 gals
 Swbd 26 BLO + 12 BAW/9 1/2 hrs.
 Set CIBP @ 7675'
 Perf 7610-24' w/1 SPF
 Ac. W/500 gals
 Swbd dry
 Squeezed Perfs 7610-24' with 100 sx.

District I
PO Box 1980, Hobbs, NM 88241-1980
District II
811 South First, Artesia, NM 88210
District III
1000 Rio Brazos Rd., Aztec, NM 87410
District IV
2040 South Pacheco, Santa Fe, NM 87505

State of New Mexico
Energy, Minerals & Natural Resources Department

OIL CONSERVATION DIVISION
2040 South Pacheco
Santa Fe, NM 87505

Form C-102
Revised October 18, 1994
Instructions on back
Submit to Appropriate District Office
State Lease - 4 Copies
Fee Lease - 3 Copies

☐ AMENDED REPORT

WELL LOCATION AND ACREAGE DEDICATION PLAT

1 API Number 30 025 06985		2 Pool Code 72480		3 Pool Name Blinberry (Progas) (effective 1/98)	
4 Property Code 020001		5 Property Name E. O. Carson			6 Well Number 14
7 OGRID No. 150661		8 Operator Name Titan Resources I, Inc.			9 Elevation 3471' GR

10 Surface Location

UL or lot no. C	Section 33	Township 21S	Range 37E	Lot 1dn	Feet from the 731	North/South line North	Feet from the 1909	East/West line West	County Lea
--------------------	---------------	-----------------	--------------	---------	----------------------	---------------------------	-----------------------	------------------------	---------------

11 Bottom Hole Location If Different From Surface

UL or lot no.	Section	Township	Range	Lot 1dn	Feet from the	North/South line	Feet from the	East/West line	County
---------------	---------	----------	-------	---------	---------------	------------------	---------------	----------------	--------

12 Dedicated Acres 160	13 Joint or Infill	14 Consolidation Code	15 Order No.
---------------------------	--------------------	-----------------------	--------------

NO ALLOWABLE WILL BE ASSIGNED TO THIS COMPLETION UNTIL ALL INTERESTS HAVE BEEN CONSOLIDATED
OR A NON-STANDARD UNIT HAS BEEN APPROVED BY THE DIVISION

<p>16</p> <p>Simultaneous acreage dedication</p>				<p>17 OPERATOR CERTIFICATION</p> <p>I hereby certify that the information contained herein is true and complete to the best of my knowledge and belief</p> <p>Signature Laura Clepper</p> <p>Printed Name Regulatory Analyst</p> <p>Title 1/26/2000</p> <p>Date</p>	
<p>18 SURVEYOR CERTIFICATION</p> <p>I hereby certify that the well location shown on this plat was plotted from field notes of actual surveys made by me or under my supervision, and that the same is true and correct to the best of my belief.</p> <p>Date of Survey</p> <p>Signature and Seal of Professional Surveyor:</p> <p>Certificate Number</p>					

District I
PO Box 1884, Hobbs, NM 88241-1884
District II
PO Drawer 800, Aramark, NM 719
District III
1800 Rio Grande Blvd., Alamogordo, NM 88314
District IV
PO Box 2088, Santa Fe, NM 87504-2088

OIL CONSERVATION DIVISION
P.O. Box 2088
Santa Fe, New Mexico 87504-2088

☐ AMENDED REPORT

WELL LOCATION AND ACREAGE DEDICATION PLAT

1 API Number 30-025-06985	2 Pool Code 72480	3 Pool Name Blinebry Gas
4 Property Code 8023	5 Property Name E.O. CARSON	6 Well Number 14
7 OGRID No. 150661	8 Operator Name TITAN RESOURCES I, INC.	9 Elevation

10 Surface Location

UL or lot no.	Section	Township	Range	Loc. Idn	Feet from the	North/South Line	Feet from the	East/West line	County
C	33	21S	37E		731	North	1909	West	Lea

11 Bottom Hole Location If Different From Surface

UL or lot no.	Section	Township	Range	Loc. Idn	Feet from the	North/South Line	Feet from the	East/West line	County

12 Dedicated Acres 80	13 Joint or Infill	14 Consolidation Code	15 Order No. NSL-3100(SD)
---------------------------------	--------------------	-----------------------	-------------------------------------

NO ALLOWABLE WILL BE ASSIGNED TO THIS COMPLETION UNTIL ALL INTERESTS HAVE BEEN CONSOLIDATED OR A NON-STANDARD UNIT HAS BEEN APPROVED BY THE DIVISION

	<p>#14</p>	<p>SEC. 33</p>	<p>R37E</p>	<p>T21S</p>	<p>17 OPERATOR CERTIFICATION</p> <p>I hereby certify that the information contained herein is true and complete to the best of my knowledge and belief.</p> <p><i>Ron Lechwar</i></p> <p>Signature</p> <p>RON LECHWAR</p> <p>Printed Name</p> <p>PROJECT MANAGER</p> <p>Title</p> <p>12/5/96</p> <p>Date</p>				
					<p>#9</p>	<p>SEC. 33</p>	<p>R37E</p>	<p>T21S</p>	<p>18 SURVEYOR CERTIFICATION</p> <p>I hereby certify that the well location shown on this plat was placed from field notes of actual surveys made by me or under my supervision, and that the same is true and correct to the best of my belief.</p> <p>_____</p> <p>Date of Survey</p> <p>Signature and Seal of Professional Surveyor</p>
					<p>NSP-1708</p>				

Certificate Number

District I
PO Box 1988, Hobbs, NM 88240
District II
PO Drawer DD, Artesia, NM 88211-0719
District III
1000 Rio Branson Rd., Aztec, NM 87410
District IV
PO Box 2088, Santa Fe, NM 87504-2088

State of New Mexico
Energy, Minerals and Natural Resources Department

OIL CONSERVATION DIVISION
P.O. Box 2088
Santa Fe, New Mexico 87504-2088

Form C-102
Revised February 10, 1994
Instructions on back
Submit to Appropriate District Office
State Lease - 4 Copies
Fee Lease - 3 Copies

☐ AMENDED REPORT

WELL LOCATION AND ACREAGE DEDICATION PLAT

1 API Number 30-025-06985		2 Pool Code 72480		3 Pool Name BLINEBRY GAS	
4 Property Code 8023		5 Property Name E.O. CARSON			6 Well Number 14
7 OGRID No. 15144		8 Operator Name Mobil Exploration & Producing U.S. Inc. As Agent for Mobil Producing TX & NM Inc.			9 Elevation

10 Surface Location									
UL or lot no. C	Section 33	Township 21S	Range 37E	Lot. Idn	Feet from the 731	North/South Line NORTH	Feet from the 1909	East/West line WEST	County LEA

11 Bottom Hole Location If Different From Surface									
UL or lot no.	Section	Township	Range	Lot. Idn	Feet from the	North/South Line	Feet from the	East/West line	County
12 Dedicated Acres 120		13 Joint or Infill		14 Consolidation Code		15 Order No. NSL-3100(SD)			

NO ALLOWABLE WILL BE ASSIGNED TO THIS COMPLETION UNTIL ALL INTERESTS HAVE BEEN CONSOLIDATED
OR A NON-STANDARD UNIT HAS BEEN APPROVED BY THE DIVISION

				17 OPERATOR CERTIFICATION I hereby certify that the information contained herein is true and complete to the best of my knowledge and belief. <i>Patricia B. Swanner</i> Signature Patricia B. Swanner Printed Name Reg. Tech/Asst. Title 9/16/94 Date	
SEC. 33		R37E			
T21S					
NSP-1708				18 SURVEYOR CERTIFICATION I hereby certify that the well location shown on this plat was plotted from field notes of actual surveys made by me or under my supervision, and that the same is true and correct to the best of my belief. Date of Survey Signature and Seal of Professional Surveyor: Certificate Number	

NEW MEXICO OIL CONSERVATION COMMISSION
WELL LOCATION AND ACREAGE DEDICATION PLAT

Form O-102
Supersedes O-128
Effective 1-1-55

All distances must be from the outer boundaries of the Section.

Operator Mobil Oil Corporation			Lease E. O. Carson		Well No. 14
Unit Letter C	Section 33	Township 21S	Range 37E	County Lea	
Actual Footage Location of Well: 731' feet from the North line and 1909 feet from the West line					
Ground Level Elev. 3471'	Producing Formation Blinebry		Pool Blinebry Gas		Dedicated Acreage: 160 Acres

1. Outline the acreage dedicated to the subject well by colored pencil or hachure marks on the plat below.
2. If more than one lease is dedicated to the well, outline each and identify the ownership thereof (both as to working interest and royalty).
3. If more than one lease of different ownership is dedicated to the well, have the interests of all owners been consolidated by communitization, unitization, force-pooling, etc?

☐ Yes ☐ No If answer is "yes" type of consolidation _____

If answer is "no" list the owners and tract descriptions which have actually been consolidated. (Use reverse side of this form if necessary.) _____

No allowable will be assigned to the well until all interests have been consolidated (by communitization, unitization, forced-pooling, or otherwise) or until a non-standard unit, eliminating such interests, has been approved by the Commission.

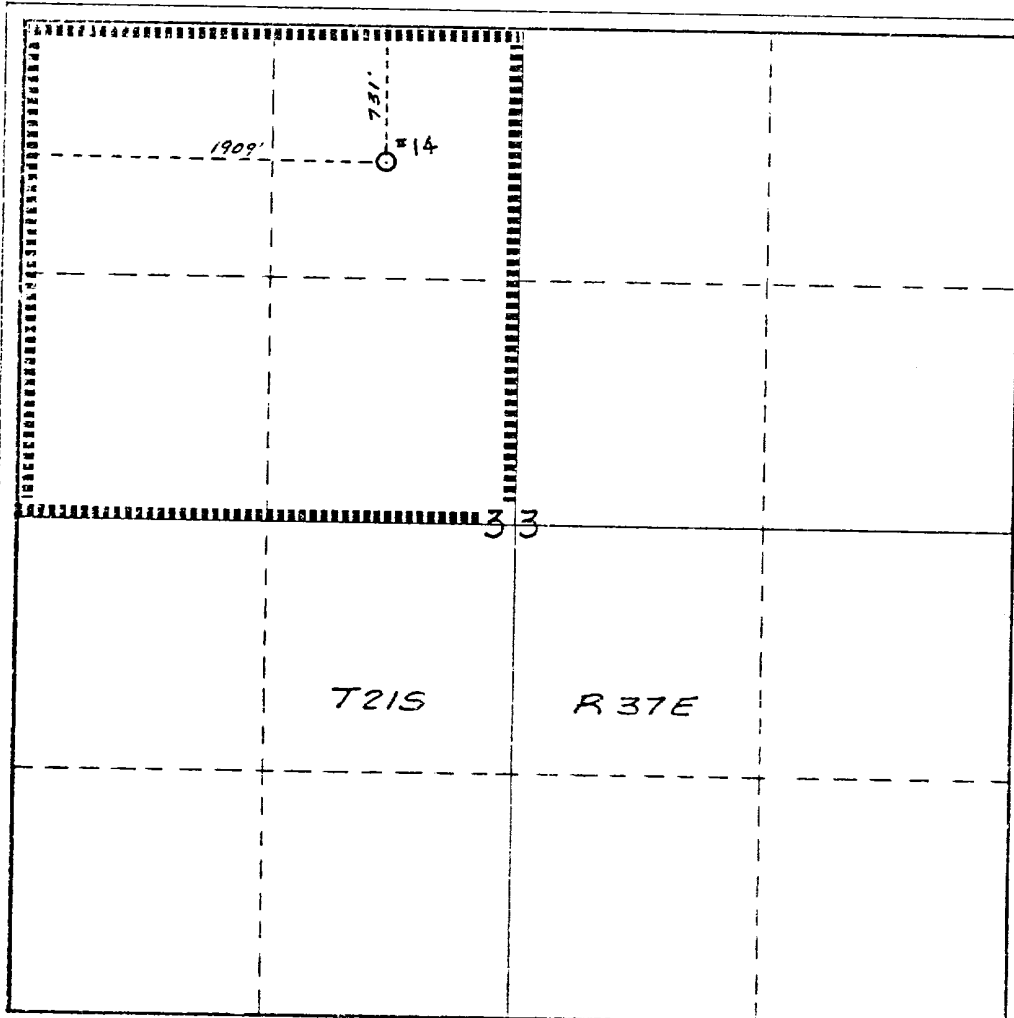

CERTIFICATION

I hereby certify that the information contained herein is true and complete to the best of my knowledge and belief.

A. D. Bond

Name

A. D. Bond

Position

Proration Staff Assistant

Company

Mobil Oil Corporation

Date

January 9, 1973

I hereby certify that the well location shown on this plat was plotted from field notes of actual surveys made by me or under my supervision, and that the same is true and correct to the best of my knowledge and belief.

Date Surveyed

Registered Professional Engineer and/or Land Surveyor

Certificate No.

