

NEW MEXICO OIL CONSERVATION COMMISSION

Santa Fe, New Mexico

NOTICE OF INTENTION TO DRILL

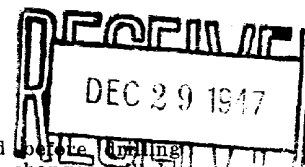

Notice must be given to the Oil Conservation Commission or its proper agent and approval obtained before drilling begins. If changes in the proposed plan are considered advisable, a copy of this notice showing such changes will be returned to the sender. Submit this notice in triplicate. One copy will be returned following approval. See additional instructions in Rules and Regulations of the Commission.

Dallas 1, Texas

Place

December 18, 1947

Date

OIL CONSERVATION COMMISSION,
Santa Fe, New Mexico.

Gentlemen:

You are hereby notified that it is our intention to commence the drilling of a well to be known as

Magnolia Petroleum Company **E.O. Carson** Well No. **15** in **NE NW**
Company or Operator Lease **Eunice Area**
of Sec. **33**, T. **21S**, R. **37 E**, N. M. P. M., **Drinkard Fd.** Field, **Lea** County

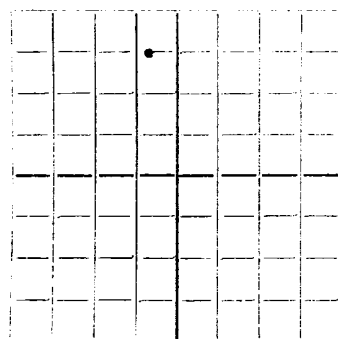

AREA 640 ACRES
LOCATE WELL CORRECTLY

The well is **731** feet **N.** (S.) of the **North** line and **589** feet

E. (W.) of the **East** line of **NE 1/4 NW 1/4**

(Give location from section or other legal subdivision lines. Cross out wrong directions)

If state land the oil and gas lease is No. Assignment No.

If patented land the owner is

Address

If government land the permittee is

Address

The lessee is **E. O. Carson**

Address **Merkel, Texas**

We propose to drill well with drilling equipment as follows: **Rotary tools.**

The status of a bond for this well in conformance with Rule 39 of the General Rules and Regulations of the Commission is as follows: **Financial Statement of Company filed with Commission and in First Judicial District of New Mexico**

We propose to use the following strings of casing and to land or cement them as indicated:

Size of Hole	Size of Casing	Weight Per Foot	New or Second Hand	Depth	Landed or Cemented	Sacks Cement
17-1/4"	13-3/8"OD	48#	New	300'	Cemented	225
11"	8-5/8"OD	32#	New	2900'	Cemented	650
7-3/4"	5-1/2"OD	17#	New	6650'	Cemented	600

If changes in the above plan become advisable we will notify you before cementing or landing casing. We estimate that the first productive oil and gas sand should occur at a depth of about **6650'** feet.

Additional information:

Approved **DEC 28 1947**, 19.....
except as follows:

Sincerely yours,

MAGNOLIA PETROLEUM COMPANY

Company or Operator

By *[Signature]*

Position **Field Superintendent**

Send communications regarding well to

Name **S. C. McFarlane**

Address **Box 900 - Dallas 1, Texas**

OIL CONSERVATION COMMISSION

By *[Signature]*

OIL & GAS INSPECTOR

Title

THE UNIVERSITY OF CHICAGO

DEPARTMENT OF CHEMISTRY

RESEARCH REPORT

NO. 1000

1955

1000

1000

1000

1000

1000

1000

1000

1000

1000

1000

1000

1000

1000

1000

1000

1000

1000

1000

1000

1000

1000

1000

1000

1000

1000

1000

1000

1000

1000

1000

1000

1000

1000

1000

1000

1000

1000

*Ellice Area
Drinkard Pay*

Form X-1318

Magnolia Petroleum Company

PRODUCING DEPARTMENT

Location made Dec. 18th, 194 7

E. O. Carson Well No. 15

Lea

Lease A-B NM-612 acres 320 Sec. 33, T 21 S, R 37 E District { District Township

Lea

County, New Mexico

Scale 1"=500'

N S E W

J. C. Clower

Aloco

Gulf

Magnolia

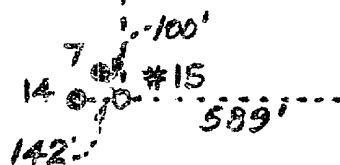

E. O. Carson

33

Twin Oil Corp.

Mag.

Reserve 200'

Special instructions

Location changed on account of

Date work is commenced

194

Supt.

Location approved by

Plat made by

R. M. Brady

Magnolia Petroleum Company
PRODUCING DEPARTMENT

Location for Well No. _____

File No. _____