

R 37 E

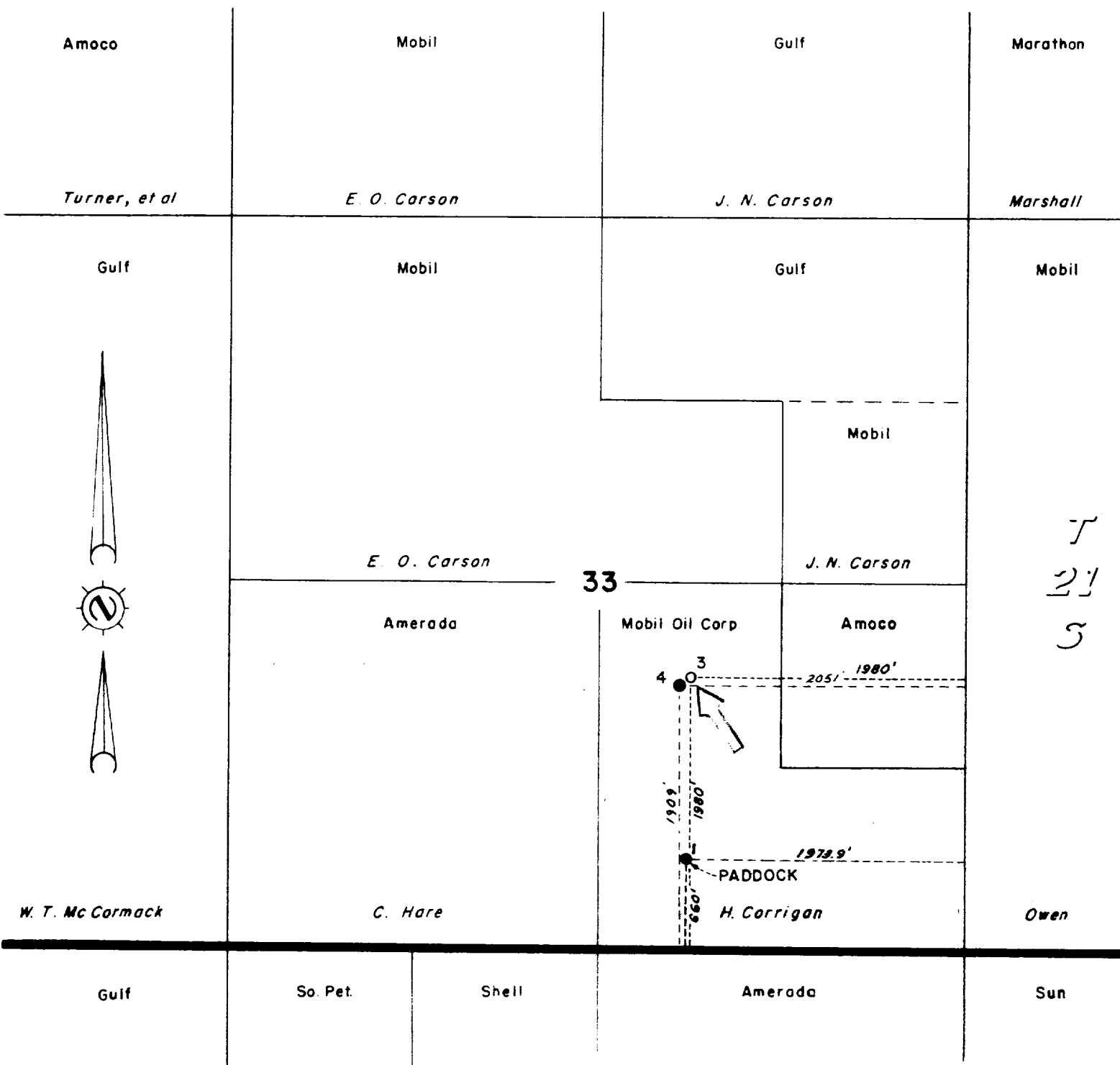

Reserve 200' Permit depth

Special Instructions

Date work is commenced 19 Sept.

Location approved by Plat by Surveyed by

THE STATE OF TEXAS  
COUNTY OF HARRIS

I hereby certify that this plat truly represents conditions as they actually exist on this lease; that said plat which is drawn to the scale indicated hereon, is to the best of my knowledge true and correct; that it accurately shows said lease with all wells on same; that number and locations of said wells are as indicated hereon; and that this plat correctly reflects all pertinent and required data.

*AS Bond*

**Mobil Oil Corporation**  
**Houston E & P Division**

LEASE H. Corrigan  
WELL NO. DATE  
DIVISION Houston LEASE NO. NM 693A1h D  
TOTAL ACRES IN LEASE 120 ACRES COVERED BY PLAT 120  
DESCRIPTION W/2 SE/4 & SE/4 SE/4 Sec. 33  
T21S-R37E

Lea County, New Mexico

DRAWN T Roy DATE 3-17-70 FIELD WANTZ - ABO, PADDOCK, EUMONT QUEEN GAS  
SCALE 1"=1000' FILE NO. 65