

District I
PO Box 1980, Hobbs, NM 88241-1980

District II
PO Drawer DD, Artesia, NM 88211-0719

District III
1000 Rio Brases Rd. , Aztec, NM 87410

District IV
PO Box 2088, Santa Fe, NM 87504-2088

State of New Mexico
Energy, Minerals & Natural Resources Department

OIL CONSERVATION DIVISION
PO Box 2088
Santa Fe, NM 87504-2088

Form C-102
Revised February 10, 1994
Submit to Appropriate District Office
State Lease - 4 Copies
Fee Lease - 3 Copies

☐ AMENDED REPORT

WELL LOCATION AND ACREAGE DEDICATION PLAT

API Number 3002507011		Pool Code 06660	Pool Name BLINEBRY OIL & GAS
Property Code 004180	Property Name F. F. HARDISON "B"		Well Number 4
OGPD No. 007673	Operator Name Exxon Corp.		Elevation 3402'

Surface Location

UL or lot no.	Section	Township	Range	Lot Idn	Feet from the	North/South line	Feet from the	East/West line	County
B	34	21S	37E		660'	NORTH	1980'	EAST	LEA

Bottom Hole Location If Different From Surface

UL or lot no.	Section	Township	Range	Lot Idn	Feet from the	North/South line	Feet from the	East/West line	County
Dedicated Acres 40		Joint or Infill		Consolidation Code		Order No.			

NO ALLOWABLE WILL BE ASSIGNED TO THIS COMPLETION UNITL ALL INTERESTS HAVE BEEN CONSOLIDATED
OR A NON-STANDARD UNIT HAS BEEN APPROVED BY THE DIVISION

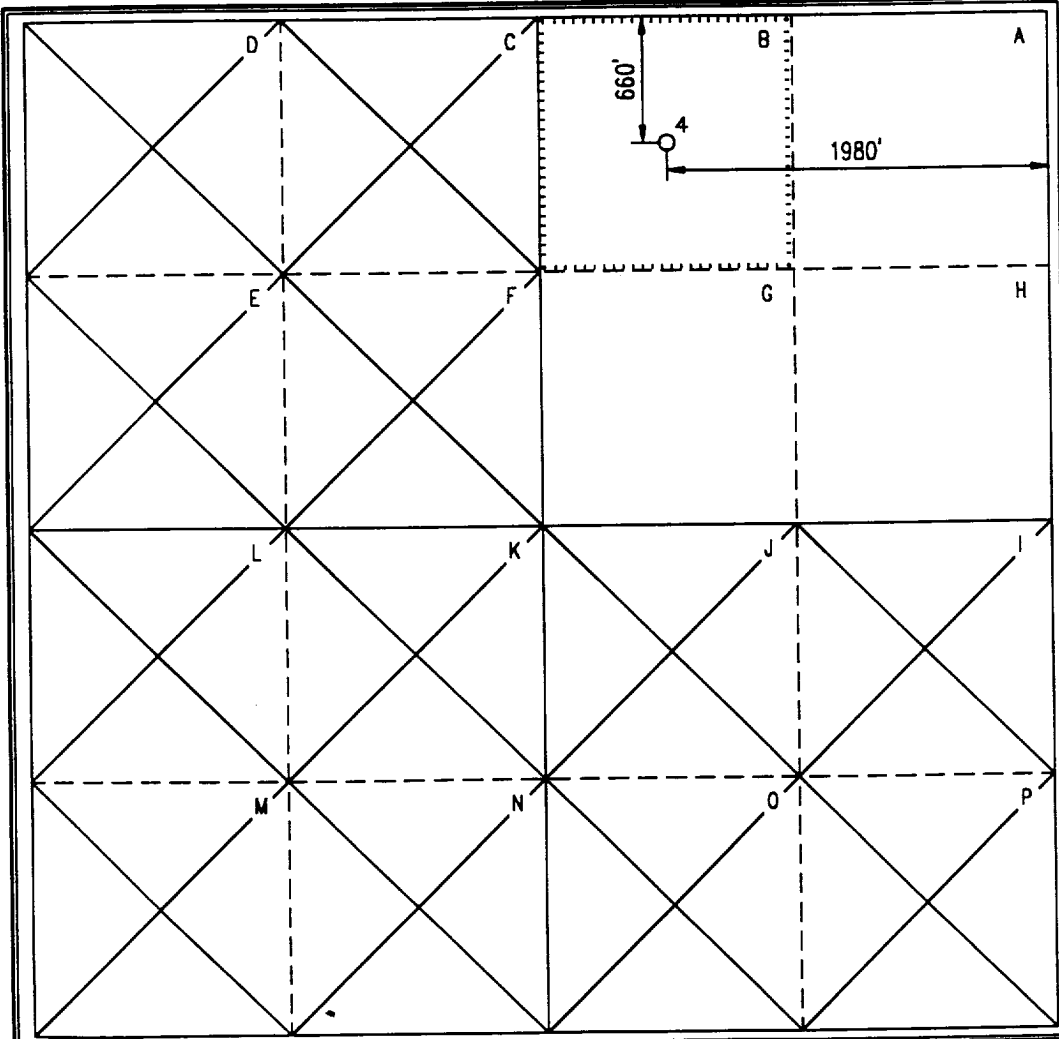

OPERATOR CERTIFICATION

I hereby certify that the information contained herein is true and complete to the best of my knowledge and belief.

C.H. Harper
Signature
C.H. Harper
Printed Name
Permits Supervisor
Title
7-18-95
Date

SURVEYOR CERTIFICATION

I hereby certify that the well location shown on this plat was plotted from field notes of actual surveys made by me or under my supervision, and that the same is true and correct to the best of my belief.

6/5/74
Date of Survey
Signature and Seal of Professional Surveyor.

Certificate Number

RECEIVED

JUL 26 1995

JOHN HOBBS
OFFICE

Submit to Appropriate
District Office
State Lease-4 copies
Fee Lease-3 copies

State of New Mexico
Energy, Minerals and Natural Resources Department

Form C-102
Revised 1-1-89

OIL CONSERVATION DIVISION

P.O. Box 2088
Santa Fe, New Mexico 87504-2088

DISTRICT I
P.O. Box 1980, Hobbs, NM 88240

DISTRICT II
P.O. Drawer DD, Artesia, NM 88210

DISTRICT III
1000 Rio Brazos Rd., Aztec, NM 87410

WELL LOCATION AND ACREAGE DEDICATION PLAT

All distances must be from the outer boundaries of the Section.

Operator Exxon Corporation			Lease F.F. HARDISON "B"		Well No. 4
Unit Letter B	Section 34	Township 21S	Range 37E	County NMPM	LEA
Actual Footage Location of Well: 660 feet from the NORTH line and 1980 feet from the EAST line.					
Ground level Elev. 3402'	Producing Formation BLINEBRY	Pool BLINEBRY (PRO GAS)(CONSOLIDATED)		Dedicated Acreage: 80 Acres	

- Outline the acreage dedicated to the subject well by colored pencil or hatchure marks on the plat below.
- If more than one lease is dedicated to the well, outline each and identify the ownership thereof (both as to working interest and royalty).
- If more than one lease of different ownership is dedicated to the well, have the interest of all owners been consolidated by communitization, unitization, force-pooling, etc.?

☐ Yes

☐ No

If answer is "yes", type of consolidation

If answer is "no", list the owners and tract descriptions which have actually been consolidated. (Use reverse side of this form if necessary.)

No allowable will be assigned to the well until all interests have been consolidated (by communitization, unitization, forced-pooling, or otherwise) or until a non-standard unit, eliminating such interest, has been approved by the Division.

OPERATOR CERTIFICATION

I hereby certify that the information contained herein is true and complete to the best of my knowledge and belief.

Signature

Printed Name

C.H. HARPER

Position

PERMITS SUPERVISOR

Company

Exxon Corporation

P.O. Box 1600-Midland, Tx.-79702

Date

11-16-93

SURVEYOR CERTIFICATION

I hereby certify that the well location shown on this plat was plotted from field notes of actual surveys made by me or under my supervision, and that the same is true and correct to the best of my knowledge and belief.

Date Surveyed

6/5/74

Signature & Seal of

Professional Surveyor

Certificate No.

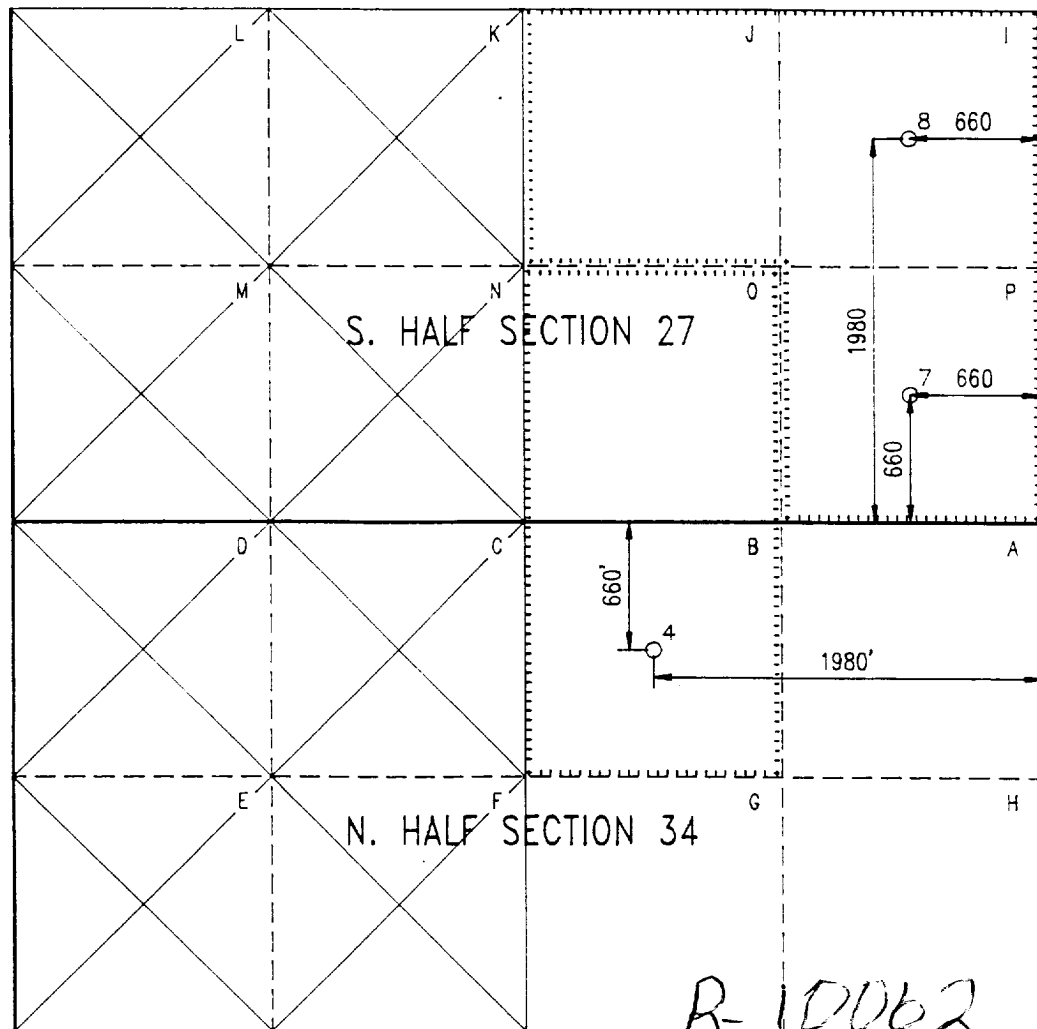

OIL CONSERVATION DIVISION

P.O. Box 2088
Santa Fe, New Mexico 87504-2088

DISTRICT I
P.O. Box 1980, Hobbs, NM 88240
DISTRICT II
P.O. Drawer DD, Artesia, NM 88210
DISTRICT III
1000 Rio Brazos Rd., Aztec, NM 87410

WELL LOCATION AND ACREAGE DEDICATION PLAT

All distances must be from the outer boundaries of the Section.

Operator Exxon Corporation			Lease F.F. HARDISON "B"		Well No. 4
Unit Letter B	Section 34	Township 21/S	Range 37/E	County NMPM	LEA
Actual Footage Location of Well: 660 feet from the NORTH line and 1980 feet from the EAST line.					
Ground level Elev. 3402'	Producing Formation BLINEBRY		Pool BLINEBRY OIL & GAS		Dedicated Acreage: 40 Acres

- Outline the acreage dedicated to the subject well by colored pencil or hatchure marks on the plat below.
- If more than one lease is dedicated to the well, outline each and identify the ownership thereof (both as to working interest and royalty).
- If more than one lease of different ownership is dedicated to the well, have the interest of all owners been consolidated by communitization, unitization, force-pooling, etc.?
☐ Yes ☐ No If answer is "yes", type of consolidation _____
If answer is "no", list the owners and tract descriptions which have actually been consolidated. (Use reverse side of this form if necessary.) _____
No allowable will be assigned to the well until all interests have been consolidated (by communitization, unitization, forced-pooling, or otherwise) or until a non-standard unit, eliminating such interest, has been approved by the Division.

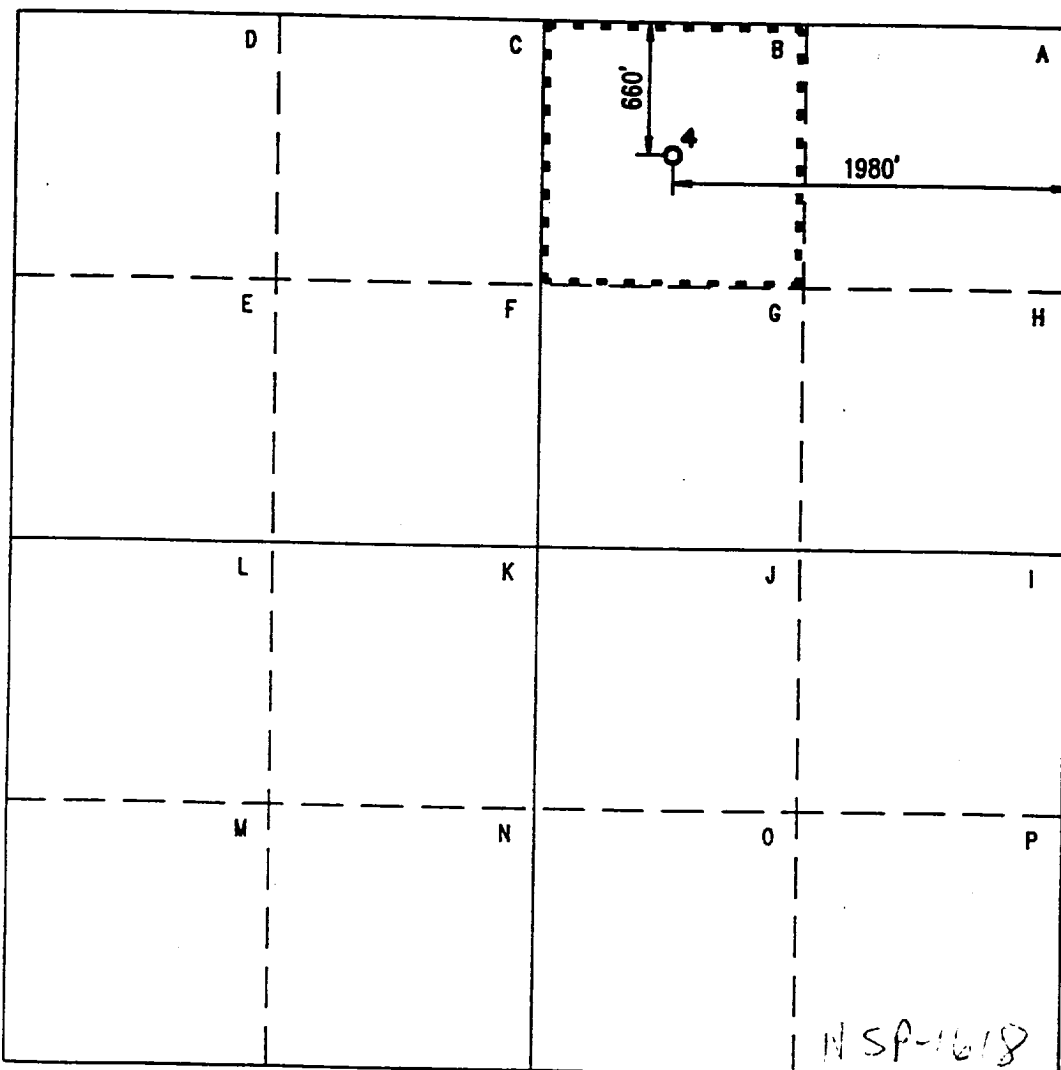

OPERATOR CERTIFICATION

I hereby certify that the information contained herein is true and complete to the best of my knowledge and belief.

Signature
Charlotte Harper
Printed Name
Charlotte Harper
Position
PERMITS SUPERVISOR
Company
Exxon Corporation
P.O. Box 1600-Midland, Tx.-79702
Date
9/24/90

SURVEYOR CERTIFICATION

I hereby certify that the well location shown on this plat was plotted from field notes of actual surveys made by me or under my supervision, and that the same is true and correct to the best of my knowledge and belief.

Date Surveyed
6/05/74

Signature & Seal of
Professional Surveyor

Certificate No.

EXXON 52267

NEW MEXICO OIL CONSERVATION COMMISSION

State of New Mexico

WELL LOCATION AND ACREAGE DEDICATION PLAT

C-102
uses C-10
tive 1-1-65

Federal Lse. No.

All distances must be from the outer boundaries of the Section.

Operator EXXON CORPORATION			Lease F.F. HARDISON "B"		Well No. 4
Unit Letter B	Section 34	Township 21-S	Range 37-E	County LEA	
Actual Footage Location of Well: 660 feet from the North line and 1980 feet from the East line					
Ground Level Elev. 3402	Producing Formation Lower Clearfork		Pool Blinebry Gas		Dedicated Acreage: * 160 Acres

1. Outline the acreage dedicated to the subject well by colored pencil or hachure marks on the plat below.
2. If more than one lease is dedicated to the well, outline each and identify the ownership thereof (both as to working interest and royalty). * **Well No. 2 & Well No. 4 To Share 160 Ac. Proration Unit**
3. If more than one lease of different ownership is dedicated to the well, have the interests of all owners been consolidated by communitization, unitization, force-pooling, etc?

☐ Yes ☐ No If answer is "yes," type of consolidation _____

If answer is "no," list the owners and tract descriptions which have actually been consolidated. (Use reverse side of this form if necessary.) _____

No allowable will be assigned to the well until all interests have been consolidated (by communitization, unitization, forced-pooling, or otherwise) or until a non-standard unit, eliminating such interests, has been approved by the Commission.

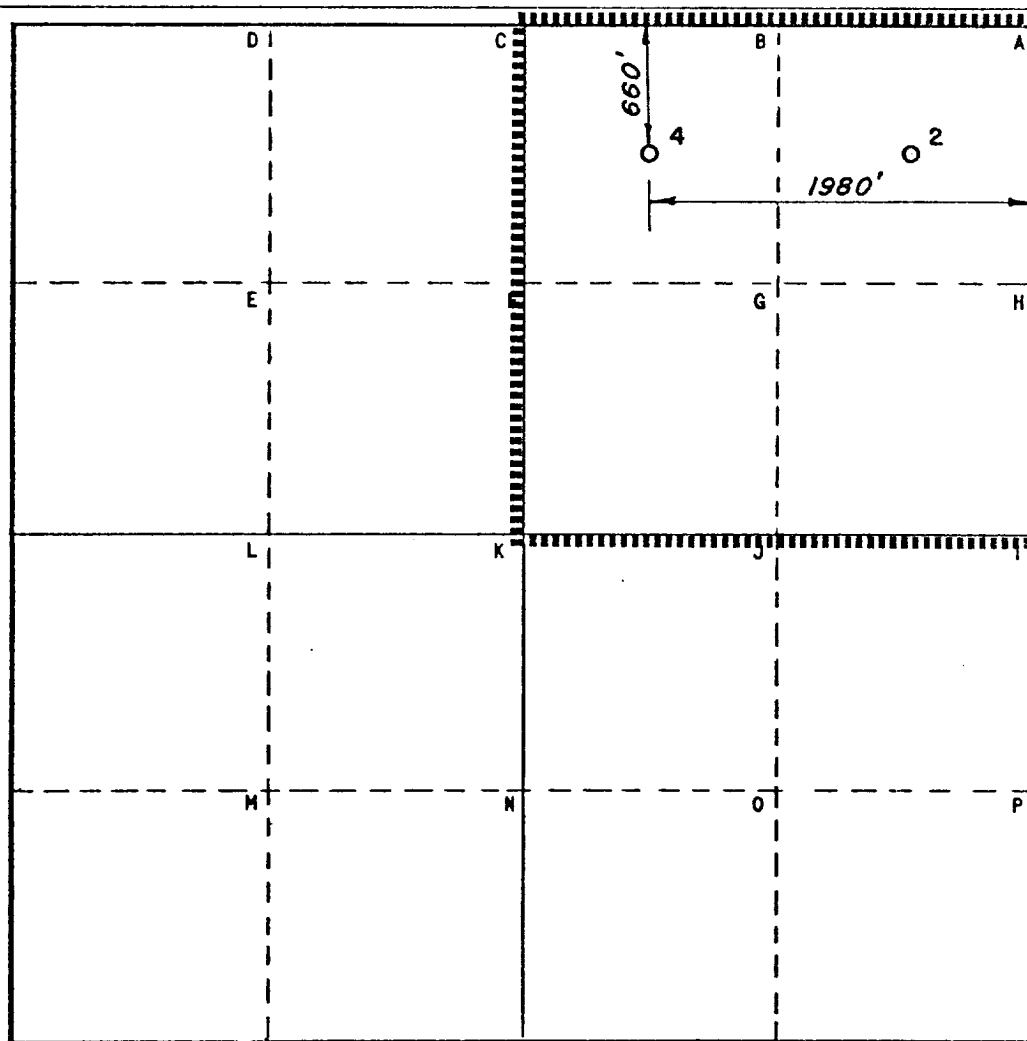

CERTIFICATION

I hereby certify that the information contained herein is true and complete to the best of my knowledge and belief.

Name *A. L. Clemmer*

Position
Proration Specialist

Company **EXXON CORPORATION**
Box 1600 Midland, Texas

Date
June 5, 1974

I hereby certify that the well location shown on this plat was plotted from field notes of actual surveys made by me or under my supervision, and that the same is true and correct to the best of my knowledge and belief.

Date Surveyed
June 5, 1974

Registered Professional Engineer
and/or Land Surveyor

H. S. Hesterfield

Certificate No.
1382

NEW MEXICO OIL CONSERVATION COMMISSION
WELL LOCATION AND ACREAGE DEDICATION PLAT

Form 3-1-72
Revised C-128
Effective 1-1-65

All distances must be from the outer boundaries of the Section.

Operator Humble Oil & Refining Co.			Lease F. F. Hardison "B"		Well No. 4
Unit Letter B	Section 34	Township 21-S	Range 37-E	County Lea	
Actual Acreage of well: _____					
Distance from the North line and 1,980 feet from the East line					
Ground Level Elev. 3,402	Producing Formation Lower Clearfork	Pool Blinbry Gas	Dedicated Acreage: 120 Acres		

1. Outline the acreage dedicated to the subject well by colored pencil or hachure marks on the plat below. *effective 12-1-70*
2. If more than one lease is dedicated to the well, outline each and identify the ownership thereof (both as to working interest and royalty).
3. If more than one lease of different ownership is dedicated to the well, have the interests of all owners been consolidated by communitization, unitization, force-pooling, etc?

☐ Yes ☐ No If answer is "yes," type of consolidation _____

If answer is "no," list the owners and tract descriptions which have actually been consolidated. (Use reverse side of this form if necessary.) _____

No allowable will be assigned to the well until all interests have been consolidated (by communitization, unitization, forced-pooling, or otherwise) or until a non-standard unit, eliminating such interests, has been approved by the Commission.

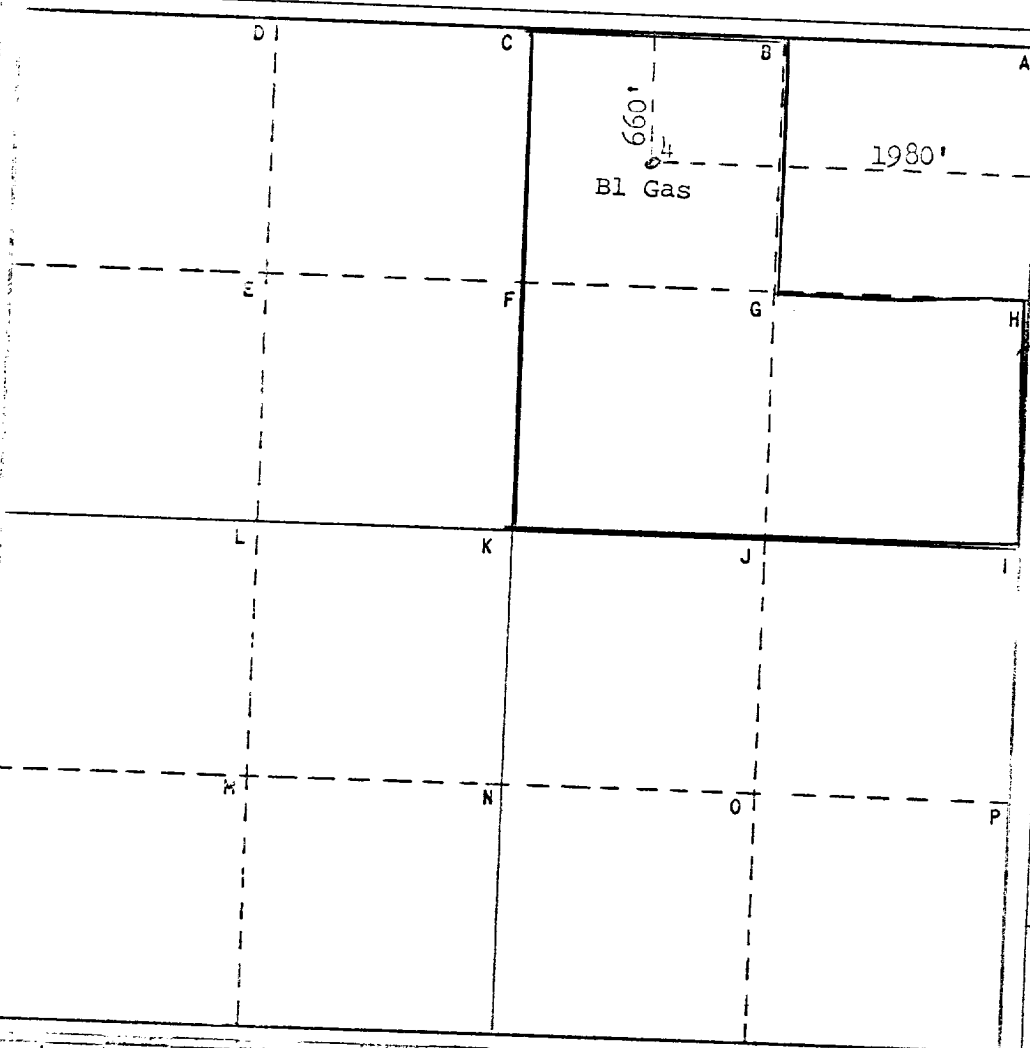

CERTIFICATION

I hereby certify that the information contained herein is true and complete to the best of my knowledge and belief.

Name _____
Position _____
Agent _____
Company Humble Oil & Refining Co.
Box 1600 Midland, Texas
Date 11-5-70

I hereby certify that the well location shown on this plat was plotted from field notes of actual surveys made by me or under my supervision, and that the same is true and correct to the best of my knowledge and belief.

Date Surveyed _____
Registered Professional Engineer and/or Land Surveyor _____
Certificate No. _____

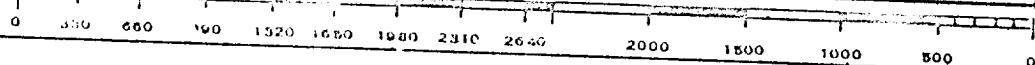

Miles _____ of _____, New Mexico

RECEIVED

NOV 13 1970

OIL CONSERVATION COMM.
HOBBS, N. M.

Federal Lse.No. _____ All distances must be from the outer boundaries of the Section.

Operator Humble Oil & Refining Co.			Lease F. F. Hardison "B"		Well No. 4
Unit Letter B	Section 34	Township 21-S	Range 37-E	County Lea	
Actual Footage Location of Well: 660 feet from the North line and 1,980 feet from the East line					
Ground Level Elev: 3,402	Producing Formation Lower Clearfork		Pool Blinebry Gas	Dedicated Acreage: 160 Acres	

1. Outline the acreage dedicated to the subject well by colored pencil or hatchure marks on the ^{effective 1-1-72} plat below.
2. If more than one lease is dedicated to the well, outline each and identify the ownership thereof (both as to working interest and royalty).
3. If more than one lease of different ownership is dedicated to the well, have the interests of all owners been consolidated by communitization, unitization, force-pooling, etc?

☐ Yes ☐ No If answer is "yes," type of consolidation _____

If answer is "no," list the owners and tract descriptions which have actually been consolidated. (Use reverse side of this form if necessary.) _____

No allowable will be assigned to the well until all interests have been consolidated (by communitization, unitization, forced-pooling, or otherwise) or until a non-standard unit, eliminating such interests, has been approved by the Commission.

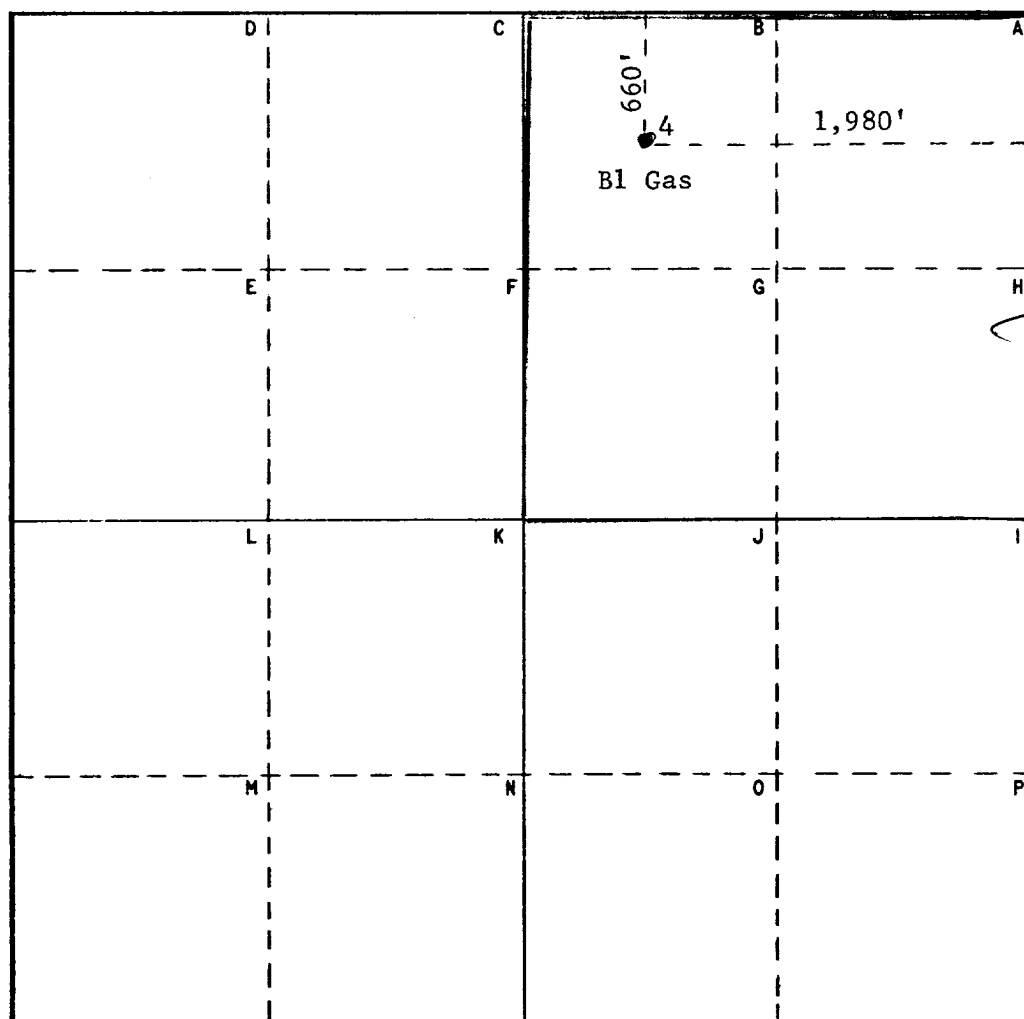

CERTIFICATION

I hereby certify that the information contained herein is true and complete to the best of my knowledge and belief.

Name

Position

Agent

Company Humble Oil & Refining Co.
Box 1600 Midland, Texas

Date

12-1-71

I hereby certify that the well location shown on this plat was plotted from field notes of actual surveys made by me or under my supervision, and that the same is true and correct to the best of my knowledge and belief.

Date Surveyed

Registered Professional Engineer
and/or Land Surveyor

Certificate No.

RECEIVED

DEC 31 1971

OIL CONSERVATION COMM.
HOBBBS, N. M.

Humble Lse.No. _____ NEW MEXICO OIL CONSERVATION COMMISSION
 State Lse.No. _____ WELL LOCATION AND ACREAGE DEDICATION PLAT
 Federal Lse.No. _____

Form C-102
 Sub. Eds C-128
 Eff. June 14-65

All distances must be from the outer boundaries of the Section.

Operator Humble Oil & Refining Co.			Lease F. F. Hardison "B"		Well No. 1100
Unit Letter B	Section 34	Township 21-S	Range 37-E	County Lea	
Actual Footage Location of Well: 660 feet from the North line and 1980 feet from the East line					
Ground Level Elev: 3402	Producing Formation Lower Clearfork	Pool Blinebry Gas	Dedicated Acreage: 120 Acres		

1. Outline the acreage dedicated to the subject well by colored pencil or hachure marks on the plat below.
2. If more than one lease is dedicated to the well, outline each and identify the ownership thereof (both as to working interest and royalty).
3. If more than one lease of different ownership is dedicated to the well, have the interests of all owners been consolidated by communitization, unitization, force-pooling, etc?

☐ Yes ☐ No If answer is "yes," type of consolidation _____

If answer is "no," list the owners and tract descriptions which have actually been consolidated. (Use reverse side of this form if necessary.) _____

No allowable will be assigned to the well until all interests have been consolidated (by communitization, unitization, forced-pooling, or otherwise) or until a non-standard unit, eliminating such interests, has been approved by the Commission.

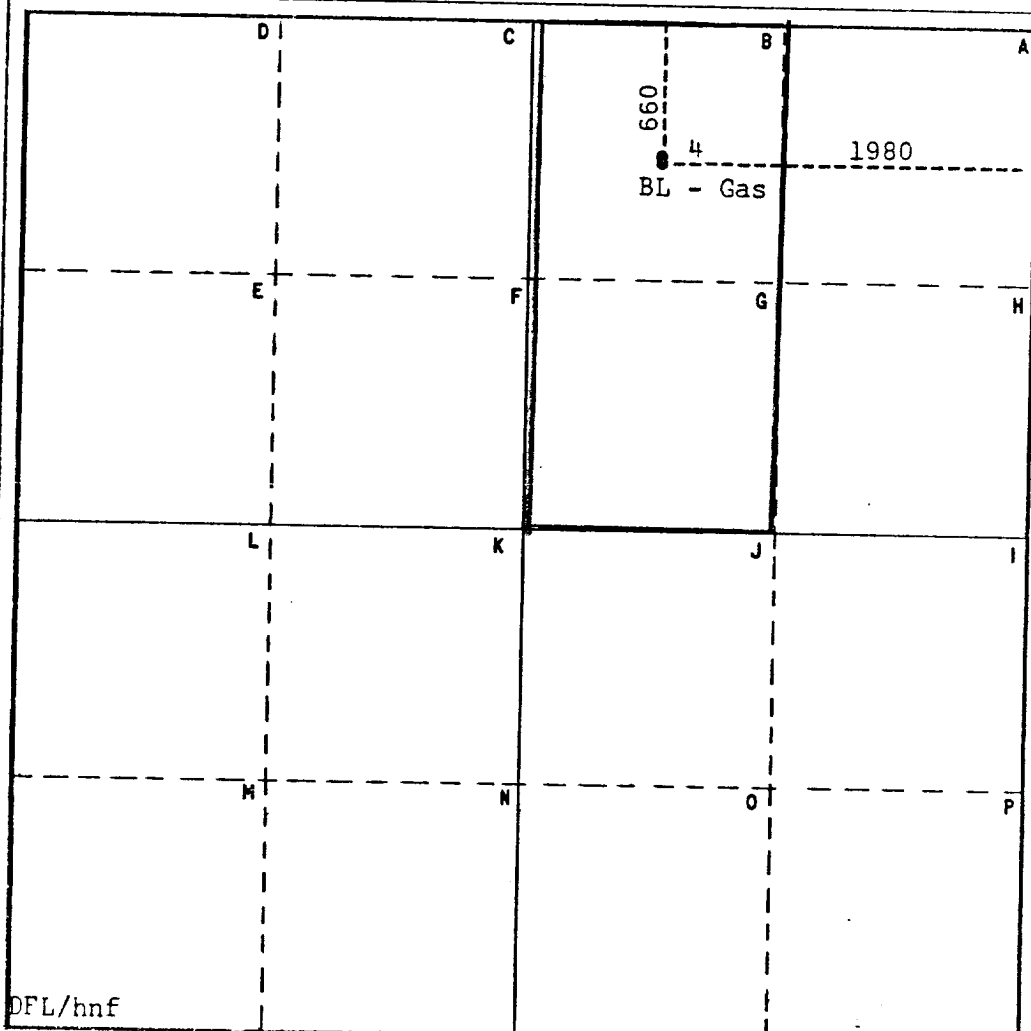

CERTIFICATION

I hereby certify that the information contained herein is true and complete to the best of my knowledge and belief.

Name
 Position
 Agent
 Company Humble Oil & Refining Co.
 Box 1600 Midland, Texas
 Date
 11-18-68

I hereby certify that the well location shown on this plat was plotted from field notes of actual surveys made by me or under my supervision, and that the same is true and correct to the best of my knowledge and belief.

Date Surveyed
 Registered Professional Engineer and/or Land Surveyor

Certificate No.

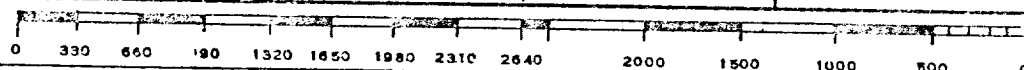

Miles _____ of _____, New Mexico

**NEW MEXICO OIL CONSERVATION COMMISSION
WELL LOCATION AND ACREAGE DEDICATION PLAT**

Form C-102
Supersedes C-128
Effective 1-1-65

All distances must be from the outer boundaries of the Section.

OFFICE O.C.C.
17 9 48 AM '65

Operator HUMBLE OIL & REFINING COMPANY			Lease F. F. Hardison "B"		Well No. 4
Unit Letter "B"	Section 34	Township 21-S	Range 37-E	County Lea	
Actual Footage Location of Well: 660 feet from the North line and 1980 feet from the East line					
Ground Level Elev: 3402	Producing Formation Lower Clearfork		Pool Blinebry Gas		Dedicated Acreage: 120 Acres

1. Outline the acreage dedicated to the subject well by colored pencil or hatchure marks on the plat below.
2. If more than one lease is dedicated to the well, outline each and identify the ownership thereof (both as to working interest and royalty).
3. If more than one lease of different ownership is dedicated to the well, have the interests of all owners been consolidated by communitization, unitization, force-pooling, etc?
☐ Yes ☐ No If answer is "yes," type of consolidation _____

If answer is "no," list the owners and tract descriptions which have actually been consolidated. (Use reverse side of this form if necessary.) _____

No allowable will be assigned to the well until all interests have been consolidated (by communitization, unitization, forced-pooling, or otherwise) or until a non-standard unit, eliminating such interests, has been approved by the Commission.

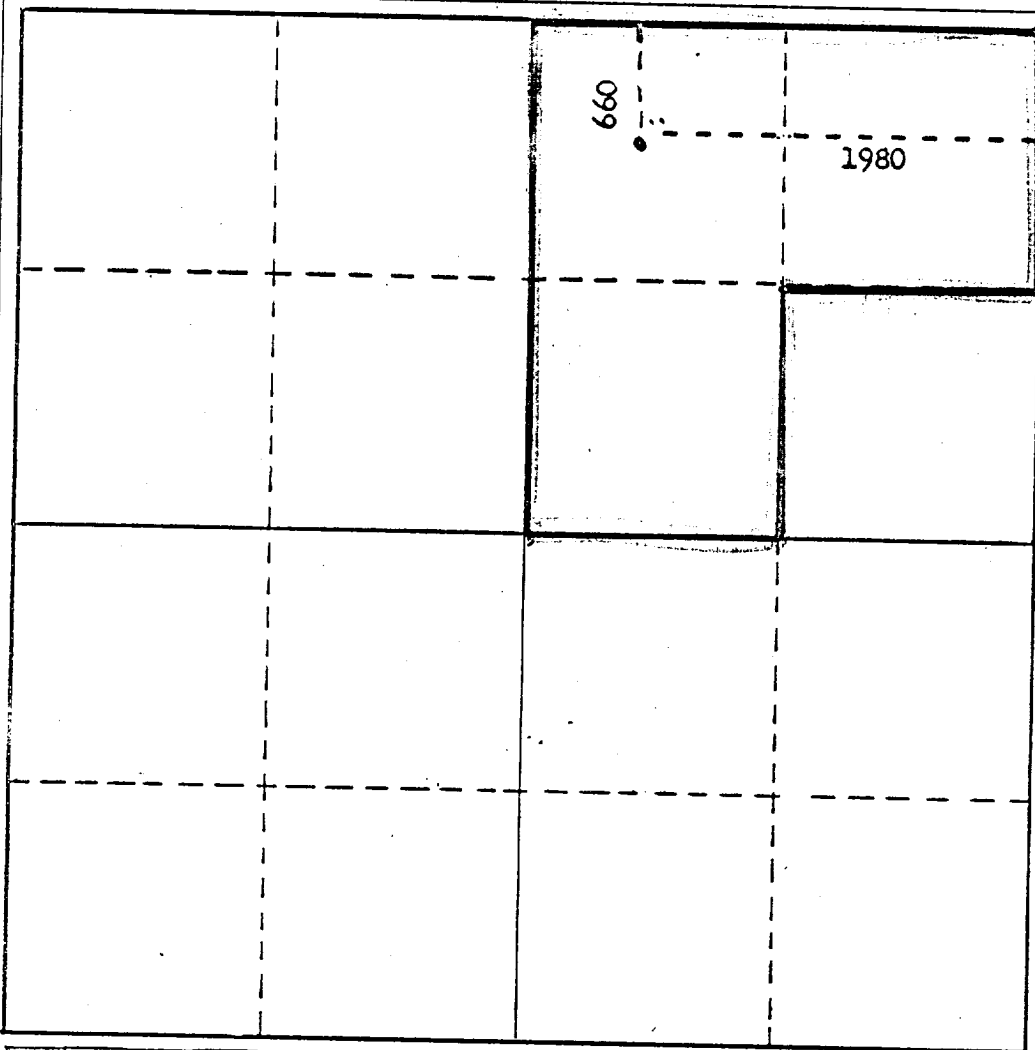

CERTIFICATION

I hereby certify that the information contained herein is true and complete to the best of my knowledge and belief.

Name <i>E. L. ...</i>
Position District Adm. Supvr.
Company Humble Oil & Refining Co.
Date December 10, 1965

I hereby certify that the well location shown on this plat was plotted from field notes of actual surveys made by me or under my supervision, and that the same is true and correct to the best of my knowledge and belief.

Date Surveyed
Registered Professional Engineer and/or Land Surveyor

Certificate No. _____

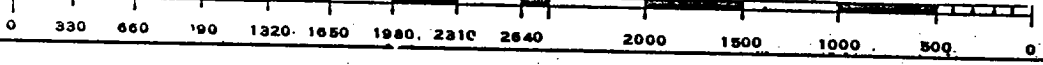

NUMBER OF COPIES RECEIVED	
DISTRIBUTION	
SANTA FE	
FILE	
U. S. G. S.	
LAND OFFICE	
TRANSPORTER	OIL GAS
PRODUCTION OFFICE	
OPERATOR	

NEW MEXICO OIL CONSERVATION COMMISSION
WELL LOCATION AND ACREAGE DEDICATION PLAT
 SEE INSTRUCTIONS FOR COMPLETING THIS FORM ON THE REVERSE SIDE

FORM C-128
 Revised 5/1/57

SECTION A 1963 JUL 3 PM 3:11			
Operator HUMBLE OIL & REFINING COMPANY		Lease F. F. Hardison "B"	
Unit Letter "B"		Well No. 4	
Section 34	Township T-21-S	Range R-37-E	County Lea
Actual Footage Location of Well: 660 feet from the North line and 1980 feet from the East line			
Ground Level Elev. 3402	Producing Formation Lower Clearfork	Pool Blinebry Gas	Dedicated Acreage: 80 Acres

1. Is the Operator the only owner in the dedicated acreage outlined on the plat below? YES ☒ NO ____ . ("Owner" means the person who has the right to drill into and to produce from any pool and to appropriate the production either for himself or for himself and another. (65-3-29 (e) NMSA 1935 Comp.)
2. If the answer to question one is "no," have the interests of all the owners been consolidated by communitization agreement or otherwise? YES ____ NO ____ . If answer is "yes," Type of Consolidation ____
3. If the answer to question two is "no," list all the owners and their respective interests below:

Owner	Land Description

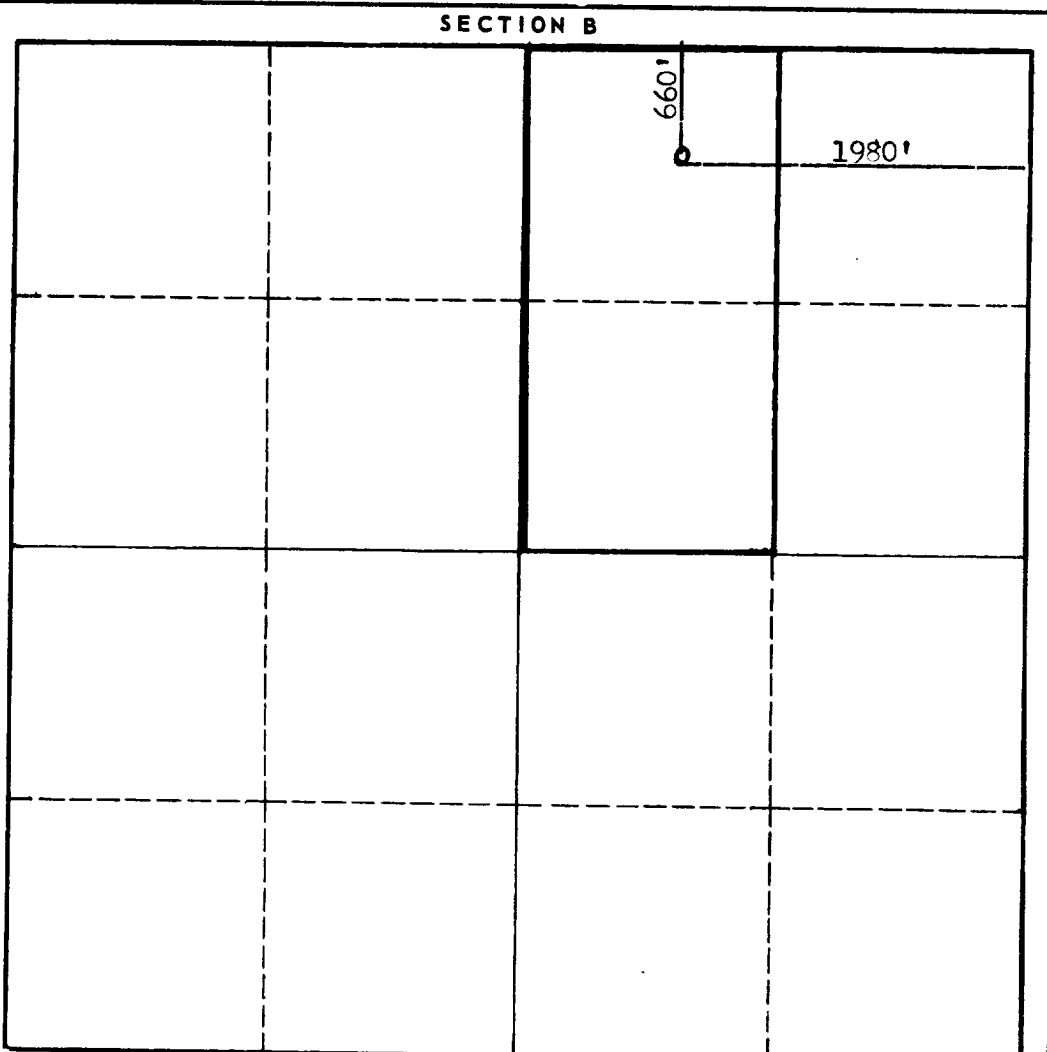

CERTIFICATION

I hereby certify that the information in SECTION A above is true and complete to the best of my knowledge and belief.

Name <i>Wm. H. Day</i>
Position Agent
Company HUMBLE OIL & REFINING CO.
Date 7-3-63

I hereby certify that the well location shown on the plat in SECTION B was plotted from field notes of actual surveys made by me or under my supervision, and that the same is true and correct to the best of my knowledge and belief.

Date Surveyed
Registered Professional Engineer and/or Land Surveyor
Certificate No.

INSTRUCTIONS FOR COMPLETION OF FORM C-128

1. Operator shall furnish and certify to the information called for in Section A.
2. Operator shall outline the dedicated acreage for *both* oil and gas wells on the plat in Section B.
3. A registered professional engineer or land surveyor registered in the State of New Mexico or approved by the Commission shall show on the plat the location of the well and certify this information in the space provided.
4. All distances shown on the plat must be from the outer boundaries of the Section.
5. If additional space is needed for listing owners and their respective interests as required in question 3 of Section A, please use space below.

NUMBER OF COPIES RECEIVED	
DISTRIBUTION	
STATE	
FILE	
U.S.G.S.	
LAND OFFICE	
TRANSPORTER	OIL
	GAS
PRODUCTION OFFICE	
OPERATOR	

NEW MEXICO OIL CONSERVATION COMMISSION
WELL LOCATION AND ACREAGE DEDICATION PLAT
 SEE INSTRUCTIONS FOR COMPLETING THIS FORM ON THE REVERSE SIDE

FORM C-128
 Revised 5/1/57

SECTION A

Operator Humble Oil & Refining Company		Lease F. F. Hardison B		Well No. 4	
Unit Letter B	Section 34	Township 21-S	Range 37-E	County Lea	
Actual Footage Location of Well: 660 feet from the North line and 1980 feet from the East line					
Ground Level Elev. 3402	Producing Formation Lower Clearfork		Pool Blinbry Gas	Dedicated Acreage: 120 Acres	

1. Is the Operator the only owner in the dedicated acreage outlined on the plat below? YES ☒ NO ____ . ("Owner" means the person who has the right to drill into and to produce from any pool and to appropriate the production either for himself or for himself and another. (65-3-29 (e) NMSA 1935 Comp.)
2. If the answer to question one is "no," have the interests of all the owners been consolidated by communitization agreement or otherwise? YES ____ NO ____ . If answer is "yes," Type of Consolidation _____
3. If the answer to question two is "no," list all the owners and their respective interests below:

Owner	Land Description

SECTION B

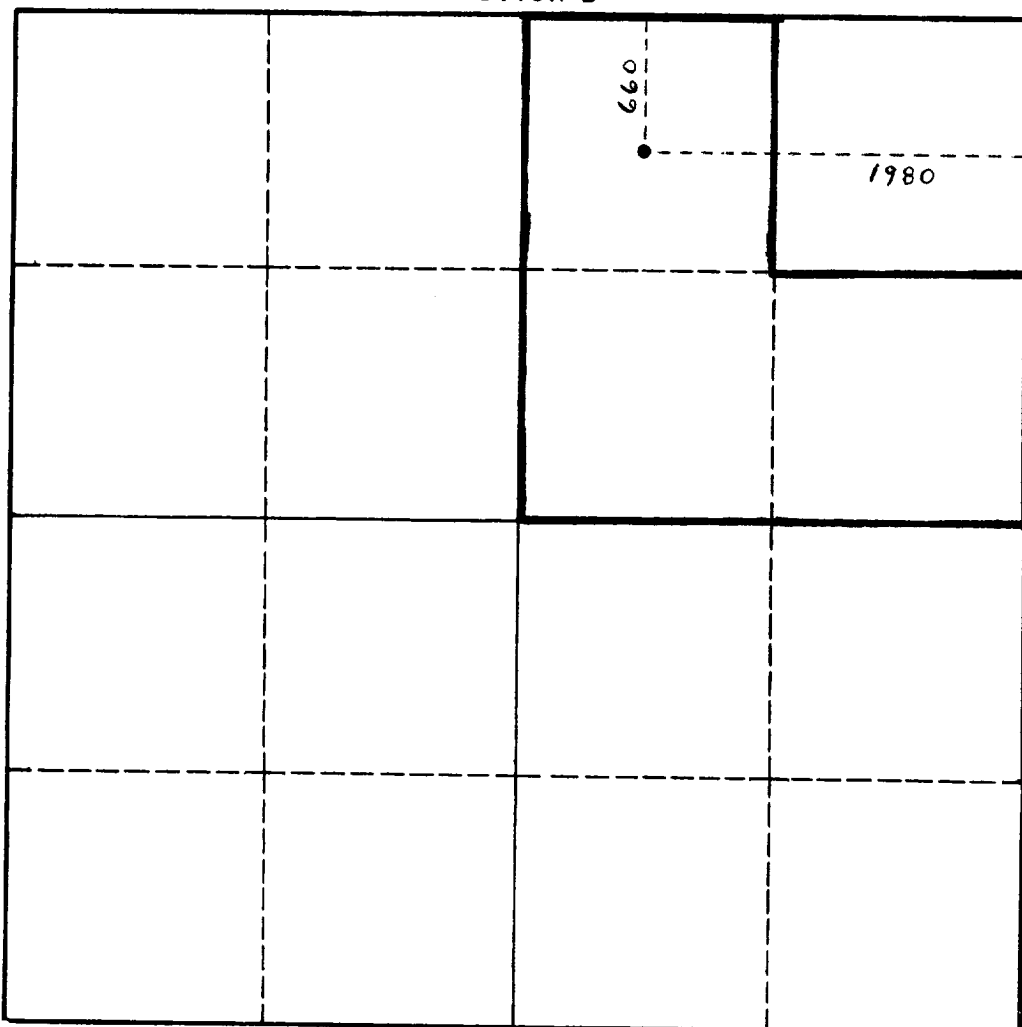

CERTIFICATION

I hereby certify that the information in SECTION A above is true and complete to the best of my knowledge and belief.

Name	ORIGINAL SIGNED: E. S. DAVIS
Position	Agent
Company	Humble Oil & Refining Co.
Date	11-27-62

I hereby certify that the well location shown on the plat in SECTION B was plotted from field notes of actual surveys made by me or under my supervision, and that the same is true and correct to the best of my knowledge and belief.

Date Surveyed	
Registered Professional Engineer and/or Land Surveyor	
Certificate No.	

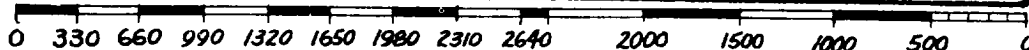

INSTRUCTIONS FOR COMPLETION OF FORM C-128

1. Operator shall furnish and certify to the information called for in Section A.
2. Operator shall outline the dedicated acreage for *both* oil and gas wells on the plat in Section B.
3. A registered professional engineer or land surveyor registered in the State of New Mexico or approved by the Commission shall show on the plat the location of the well and certify this information in the space provided.
4. All distances shown on the plat must be from the outer boundaries of the Section.
5. If additional space is needed for listing owners and their respective interests as required in question 3 of Section A, please use space below.

NEW MEXICO
OIL CONSERVATION COMMISSION

Gas Well Plat

Date NOV. 12, 1953

HUMBLE OIL & REFINING CO.

F. F. HARDISON ET AL "B"

4

Operator

Lease

Well No.

(DRINKARD OIL)

Name of Producing Formation BLINEBRY GAS Pool BLINEBRY

No. Acres Dedicated to the Well 160

SECTION 34 TOWNSHIP T-21-S RANGE R-37-E

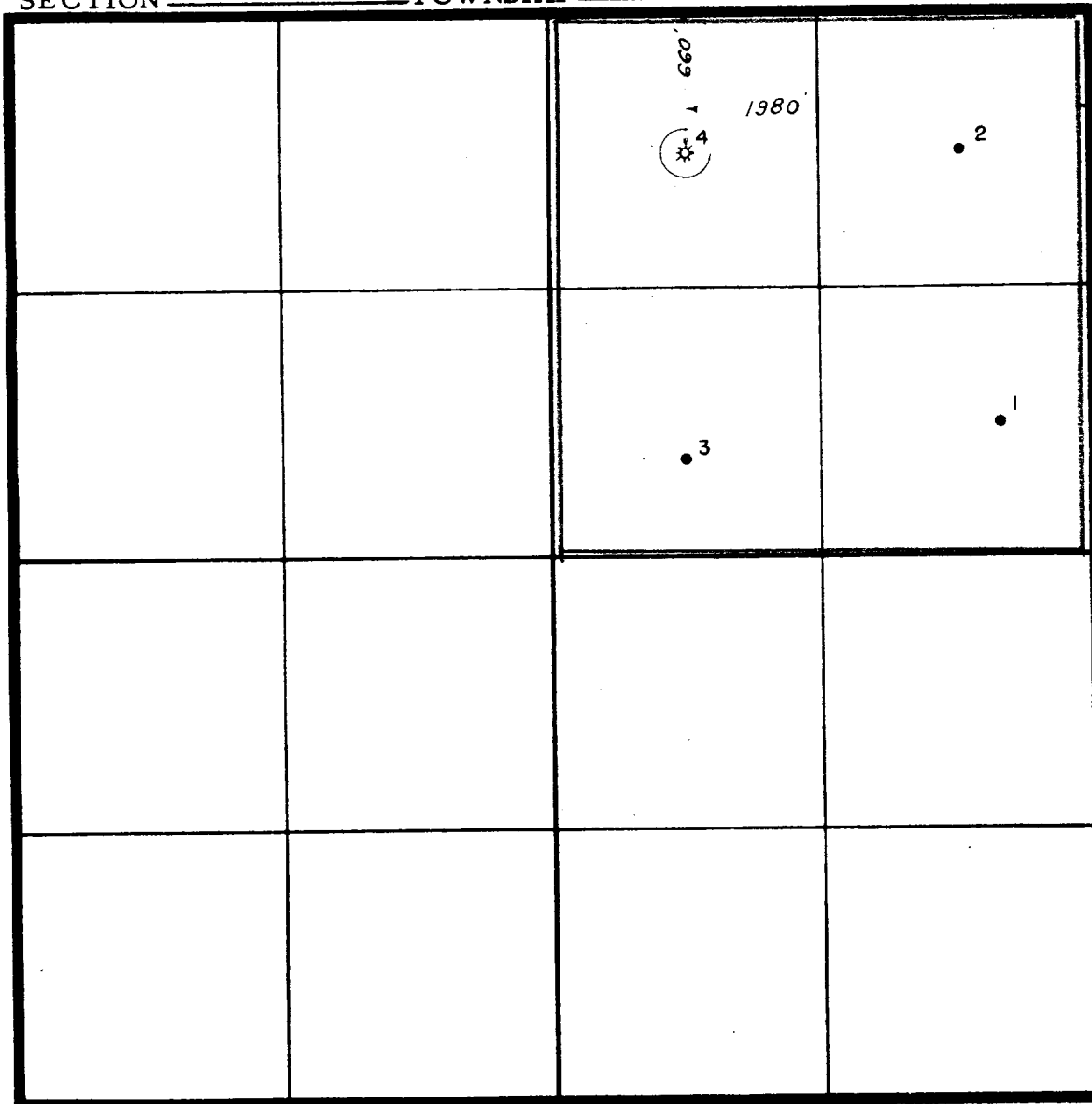

I hereby certify that the information given above is true and complete to the best of my knowledge.

1. Is this gas well a dual completion? Yes No
2. Are there any other dually completed wells within the dedicated acreage? Yes No

Name J. F. Hall
Position Assistant Division Superintendent
Representing Humble Oil & Refining Company
Address B x 1000, Midland, Texas

(over)

WT-A 1600

