

NO. OF COPIES PREPARED	
DISTRIBUTION	
SANTA FE	
FILE	
U.S.G.S.	
LAND OFFICE	
OPERATOR	

NEW MEXICO OIL CONSERVATION COMMISSION

Form O-101
Revised 1-1-65

5A. Indicate Type of Lease	
STATE <input type="checkbox"/>	FED <input checked="" type="checkbox"/>
6. State Oil & Gas Lease No.	

APPLICATION FOR PERMIT TO DRILL, DEEPEN, OR PLUG BACK

1a. Type of Work		7. Unit Agreement Name	
b. Type of Well OIL WELL <input type="checkbox"/> GAS WELL <input checked="" type="checkbox"/> OTHER <input type="checkbox"/> *See Below		Marshall Com	
2. Name of Operator		8. Firm or Lease Name	
Mobil Oil Corporation			
3. Address of Operator		9. Well No.	
P. O. Box 633, Midland, Texas 79701		6	
4. Location of Well		10. Field and Pool, or Wildcat	
UNIT LETTER E LOCATED 2230 FEET FROM THE North LINE		Drinkard	
AND 330 FEET FROM THE West LINE OF SEC. 34 TWP. 21-S RGE. 37-E		11. County	
		Lea	
13. Proposed Depth		14. Formation	20. Rotary or C.T.
5288		Drinkard	Rotary
21. Elevations (Show whether DF, RI, etc.)	21A. Kind & Status Plug. Bond	21B. Drilling Contractor	22. Approx. Date Work will start
3464 - Ground	On File		10-29-73

PROPOSED CASING AND CEMENT PROGRAM

SIZE OF HOLE	SIZE OF CASING	WEIGHT PER FOOT	SETTING DEPTH	SACKS OF CEMENT	EST. TOP

*This well is presently completed as an oil well in the Paddock Pool. Permission is requested to perforate the Drinkard pay, stimulate both zones and dually complete as an oil well in the Paddock and a gas well in the Drinkard.

APPROVAL VALID
FOR 90 DAYS UNLESS
DRILLING COMMENCED,

EXPIRES 1-29-74

IN ABOVE SPACE DESCRIBE PROPOSED PROGRAM: IF PROPOSAL IS TO DEEPEN OR PLUG BACK, GIVE DATA ON PRESENT PRODUCTIVE ZONE AND PROPOSED NEW PRODUCTIVE ZONE. GIVE BLOWOUT PREVENTER PROGRAM, IF ANY.

I hereby certify that the information above is true and complete to the best of my knowledge and belief.

Signed A. D. Bond A. D. Bond Title Proration Staff Assistant Date October 25, 1973

(This space for State Use)

APPROVED BY [Signature] TITLE _____ DATE _____
CONDITIONS OF APPROVAL, IF ANY:

NEW MEXICO OIL CONSERVATION COMMISSION
WELL LOCATION AND ACREAGE DEDICATION PLAT

Form 0-1
Supersedes O-1-1
Effective 1-1-66

All distances must be from the outer boundaries of the Section.

Operator Mobil Oil Corporation			Lease Marshall Com		Well No. 6
Unit Letter E	Section 34	Township 21-S	Range 37-E	County Lea	
Actual Pictograph Location of Well:					
2230		feet from the North line and		330 feet from the West line	
Ground Level Elev. 3464	Producing Formation Drinkard		Pool Drinkard		Dedicated Acreage: 40 Acres

1. Outline the acreage dedicated to the subject well by colored pencil or hachure marks on the plat below.
2. If more than one lease is dedicated to the well, outline each and identify the ownership thereof (both as to working interest and royalty).
3. If more than one lease of different ownership is dedicated to the well, have the interests of all owners been consolidated by communitization, unitization, force-pooling, etc?

☐ Yes ☐ No If answer is "yes," type of consolidation _____

If answer is "no," list the owners and tract descriptions which have actually been consolidated. (Use reverse side of this form if necessary.) _____

No allowable will be assigned to the well until all interests have been consolidated (by communitization, unitization, forced-pooling, or otherwise) or until a non-standard unit, eliminating such interests, has been approved by the Commission.

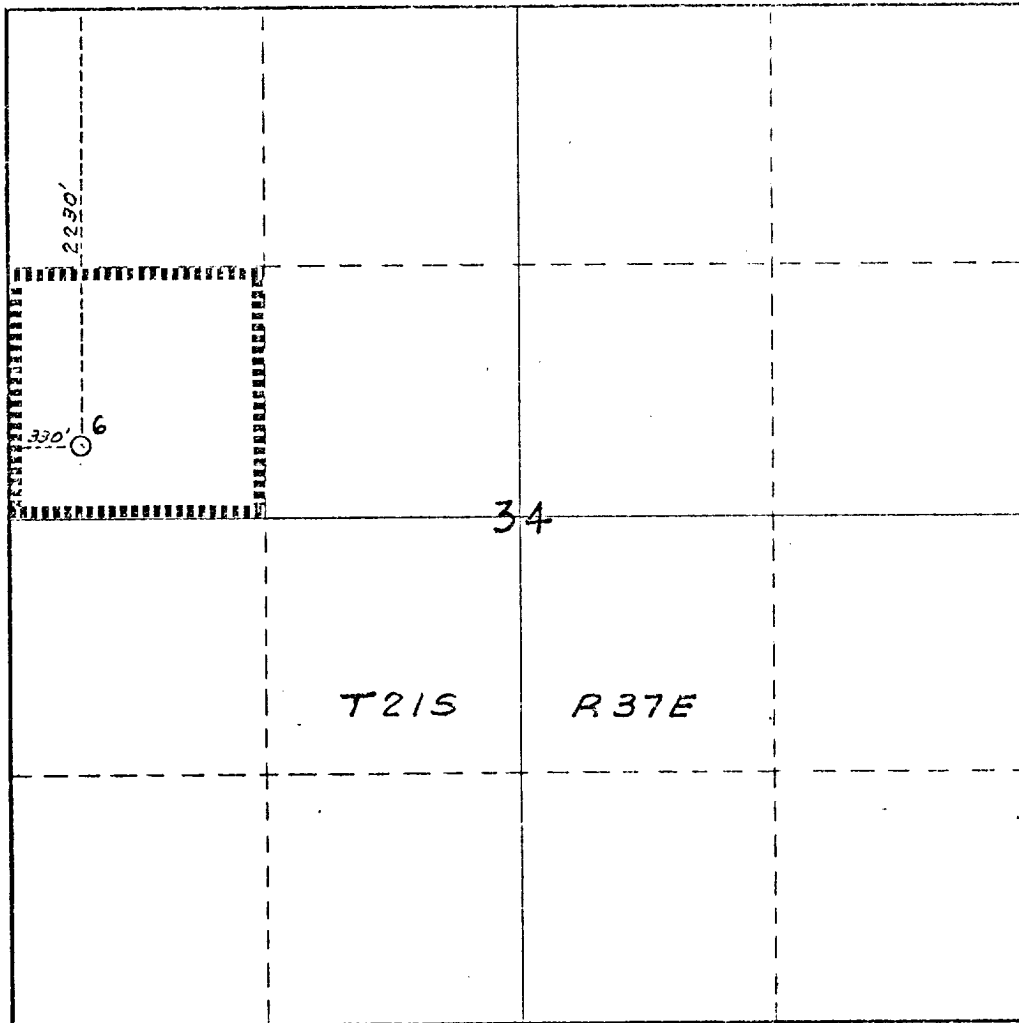

CERTIFICATION

I hereby certify that the information contained herein is true and complete to the best of my knowledge and belief.

A. D. Bond

Name

A. D. Bond

Position

Proration Staff Assistant

Company

Mobil Oil Corporation

Date

October 25, 1973

I hereby certify that the well location shown on this plat was plotted from field notes of actual surveys made by me or under my supervision, and that the same is true and correct to the best of my knowledge and belief.

Date Surveyed

Registered Professional Engineer
and/or Land Surveyor

Certificate No.

0 330 660 990 1320 1650 1980 2310 2640 2000 1500 1000 500 0