

NEW MEXICO OIL CONSERVATION COMMISSION  
SANTA FE, NEW MEXICO  
APPLICATION FOR MULTIPLE COMPLETION  
HOBBS OFFICE O. C. C.

Form C-107  
5-1-61

MAY 5 10 18 AM '69

Operator <b>Pan American Petroleum Corporation</b>		County <b>Lea</b>	Date <b>April 28, 1969</b>
Address <b>Box 68, Hobbs, New Mexico 88240</b>		Lease <b>State "C" Tract 13</b>	Well No. <b>5</b>
Location of Well <b>E</b>	Unit <b>36</b>	Section <b>21-S</b>	Range <b>37-E</b>

1. Has the New Mexico Oil Conservation Commission heretofore authorized the multiple completion of a well in these same pools or in the same zones within one mile of the subject well? YES ☒ NO ☐
2. If answer is yes, identify one such instance: Order No. R-307; Operator Lease, and Well No.: Getty State S #2 C-15-21-37

3. The following facts are submitted:	Upper Zone	Intermediate Zone	Lower Zone
a. Name of Pool and Formation	<b>Blinebry</b>		<b>Tubb</b>
b. Top and Bottom of Pay Section (Perforations)	<b>5566 } Various Intervals</b> <b>5888 }</b>		<b>6014 - 6042'</b> <b>6084 - 6246'</b>
c. Type of production (Oil or Gas)	<b>Gas</b>		<b>Gas</b>
d. Method of Production (Flowing or Artificial Lift)	<b>Flowing</b>		<b>Flowing</b>

4. The following are attached. (Please check YES or NO)

Yes	No	
<input checked="" type="checkbox"/>	<input type="checkbox"/>	a. Diagrammatic Sketch of the Multiple Completion, showing all casing strings, including diameters and setting depths, centralizers and/or turbolizers and location thereof, quantities used and top of cement, perforated intervals, tubing strings, including diameters and setting depth, location and type of packers and side door chokes, and such other information as may be pertinent.
<input checked="" type="checkbox"/>	<input type="checkbox"/>	b. Plat showing the location of all wells on applicant's lease, all offset wells on offset leases, and the names and addresses of operators of all leases offsetting applicant's lease.
<input type="checkbox"/>	<input checked="" type="checkbox"/>	c. Waivers consenting to such multiple completion from each offset operator, or in lieu thereof, evidence that said offset operators have been furnished copies of the application.*
<input checked="" type="checkbox"/>	<input type="checkbox"/>	d. Electrical log of the well or other acceptable log with tops and bottoms of producing zones and intervals of perforation indicated thereon. (If such log is not available at the time application is filed it shall be submitted as provided by Rule 112-A.)

5. List all offset operators to the lease on which this well is located together with their correct mailing address.

Continental Oil Company, Box 460, Hobbs, New Mexico

Atlantic - Richfield Box 1978, Roswell, New Mexico

Getty Oil Company Box 249, Hobbs, New Mexico

Texas Pacific Coal & Oil Co. Box 1069, Hobbs, New Mexico

Cities Service Oil Company Box 69, Hobbs, New Mexico

6. Were all operators listed in Item 5 above notified and furnished a copy of this application? YES ☒ NO ☐ . If answer is yes, give date of such notification April 28, 1969.

CERTIFICATE: I, the undersigned, state that I am the \_\_\_\_\_ of the \_\_\_\_\_ (company), and that I am authorized by said company to make this report; and that this report was prepared under my supervision and direction and that the facts stated therein are true, correct and complete to the best of my knowledge.

CC: NMOCC-Hobbs  
NSW  
Well File - Susp  
RRY

Original Signed by  
**V. E. STALEY**

Signature

\*Should waivers from all offset operators not accompany an application for administrative approval, the New Mexico Oil Conservation Commission will hold the application for a period of twenty (20) days from date of receipt by the Commission's Santa Fe office. If, after said twenty-day period, no protest nor request for hearing is received by the Santa Fe office, the application will then be processed.

NOTE: If the proposed multiple completion will result in an unorthodox well location and/or a non-standard proration unit in one or more of the producing zones, then separate application for approval of the same should be filed simultaneously with this application.

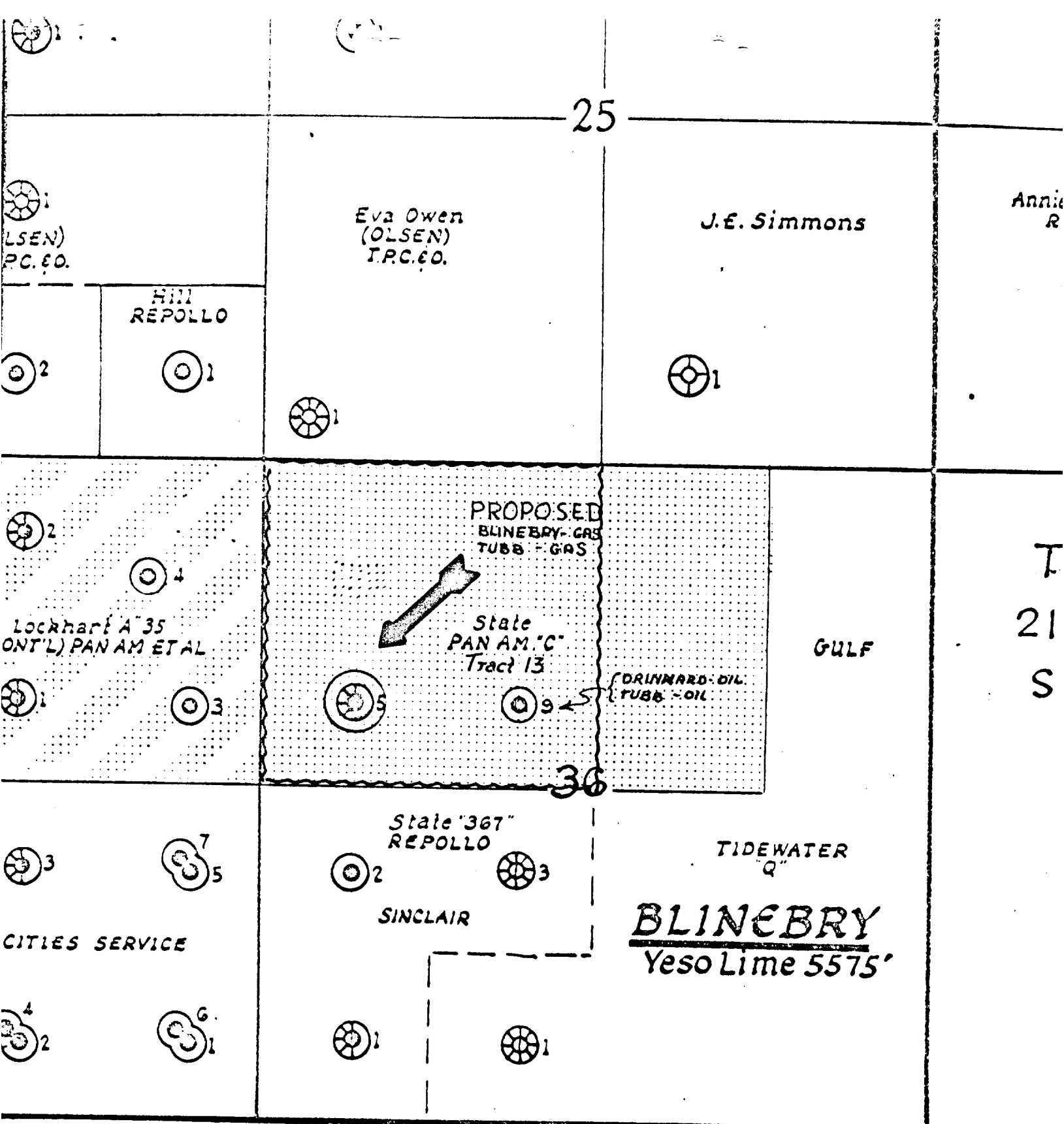

DEDICATED  
ACREAGE  
BLINEBRY-

Plat of  
State "C" Tr. 13  
Lea Co, N.M.  
1" = 1000'

ENGINEERING CHART  
(TRACING)

FILE

APP.

DATE 5-1-69

BY RRY

SUBJECT STATE C TRACT 13 Well No. 5 (F-36-21-37)

DIAGRAMMATIC SKETCH FOR MULTIPLE COMPLETION

ELEVATION 3371-DF

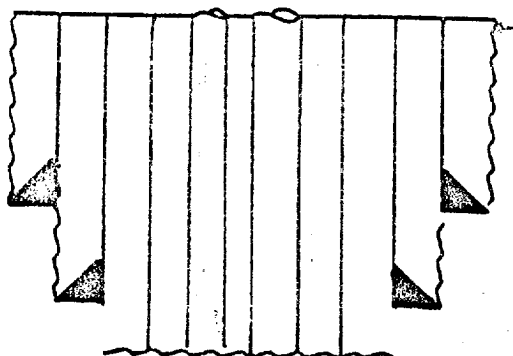

13 3/8" CSA 301' CEMENT CIRCULATED.

9 3/8" CSA 1410' CEMENT W/ 700SX.

LINEBRY-GAS

TOP - 5566 ->

BTM - 5848 ->

2 3/8" OD 4.7" Tbq @ 5668'

BAKER MODEL 'D' PACKER @ 5950'

TUBB-GAS

TOP 6014' ->

BTM 6246' ->

2 3/8" OD 4.7" Tbq @ 6003'

PBD- 6340'  
CAST IRON BP @ 6350'  
7" CSA 6585' W/ 3500 SX.

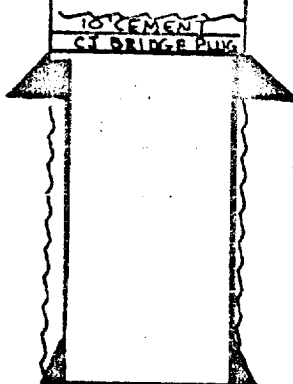

TD- 7564 (4 1/2" OD LINER 6411-7564' W/ 250 SX.