

# WRS COMPLETION REPORT

COMPLETIONS SEC 1 TWP 20S RGE 38E  
PI# 30-T-0014 03/16/87 30-025-07722-0002 PAGE 1

NMEX LEA \* 2310FNL 330FEL SEC SE NE  
STATE COUNTY FOOTAGE SPOT

ZIA ENERGY D X DG  
OPERATOR WELL CLASS INIT FIN

1 JONES L D

WELL NO. LEASE NAME HOUSE

3592GR API 30-025-07722-0002

LEASE TYPE NO. PERMIT OR WELL ID NO. STATUS

12/23/1986 12/24/1986 WO-UNIT GAS-WO  
SPUD DATE COMP. DATE TYPE TOOL

3174 YTS-SVRV NOT RPTD

PROJ. DEPTH PROJ. FORM CONTRACTOR

DTD 7605 PB 3174 OTD 7605 FM/TD DRINKARD

DRILLERS T.D. LOG T.D. PLUG BACK TO OLD T.D. FORM T.D.

## LOCATION DESCRIPTION

9 MI SE MONUMENT, NM

## INITIAL POTENTIAL

IPF 15 MCFD 3000- 3120 24HRS

YTS-SVRV PERF  
PERF 3000- 3120  
CP 1300

GTY (NR);GOR (NR)

FM - YATES

## PRODUCTION TEST DATA

BLINEBRY PERF 6070- 6246  
PERF 6070- 6246 DEPTH 3174  
BRPG 6070- 6246

## DRILLING PROGRESS DETAILS

ZIA ENERGY  
BOX 2219  
HOBBS, NM 88240  
505-393-2937

OWWO: OLD INFO: FORMERLY DAMSON EXPLORATION  
CORP #1 JONES L D. 13 3/8 @ 325 W/325 SX,  
8 5/8 @ 3145 W/230 SX, 5 1/2 @ 7531 W/450 SX.  
OTD 7605. PB 6600. COMP 3/1/69. IPF 585.6  
MCFGPD. PROD ZONE: BLINEBRY 6070-6246.

03/10 LOC/1987/

CONTINUED IC# 300257006187

Copyrighted 1987  
Reproduction  
Prohibited

Petroleum Information

BB a company of  
The Dun & Bradstreet Corporation

P - WRS-GET  
Form No 187

COMPLETIONS  
PI# 30-T-0014 03/16/87 SEC 1 TWP 20S RGE 38E  
30-025-07722-0002 PAGE 2

ZIA ENERGY  
1

JONES L D

D X DG

DRILLING PROGRESS DETAILS

03/10 7605 TD, PB 3:74  
COMP 12/24/86, IPF 15 MCFGPD, CK NOT RPTD,  
GOR (NR), GTY (NR), FCP  
1300  
PROD ZONE - YATES-SEVEN RIVERS 3000-3120  
FIRST REPORT & COMPLETION

Re-Cmp 3-1-69		CLASS		EL	
		FORMATION	DATUM	FORMATION	DATUM
CSG & SX TUBING					
13 3/8" at 325' w/325 sx					
8 5/8" at 3145' w/230 sx					
5 1/2" at 7531' w/450 sx					
LOGS EL GR RA IND HC A					
		TD 7605'; PBD 6600'			

IP (Blinebry) Perfs 6070-6246' CAOF 585.6 MCF/GPI

Distribution limited and publication prohibited by subscribers' agreement.  
Reproduction rights reserved by Williams & Lee Scouting Service, Inc.

CONT. \_\_\_\_\_ PROP. DEPTH 7531' TYPE WD

F.R.C. 8-7-69  
PD 7531' WO (Blinebry)  
(Orig. Westates Pet. Co. #1 Jones, P&A 6-14-55,  
OTD 7605')  
7-5-69 ID 7605'; PBD 6600'; COMPLETE  
Ran 5 1/2" casing  
Perf (Blinebry) 6070-6246' w/19 shots (Overall)  
Perf (Drinkard) 6684-7232' w/38 shots (Overall)  
Acid (6070-6246') 2000 gals  
Frac (6070-6246') 15,000 gals wtr + 15,000# sd  
Acid (6684-7232') 5000 gals  
Frac (6684-7232') 30,000 gals wtr & sd  
BP @ 6600'

HA House NM Sec 1, T20S, R38E  
DEMSON EXPLORATION CORP. 1 Jones, L. D. Page #2

8-5-69 Ann. tested

LOG POINT GAUGES (Blinebry):

Flwd 172.7 MCF/CPD thru 1/16" chk, 3 hrs, TP 1832#

Flwd 315.2 MCF/CPD thru 3/32" chk, 3 hrs, TP 1538#

Flwd 442.5 MCF/CPD thru 1/8" chk, 3 hrs, TP 1190#

Flwd 529.8 MCF/CPD thru 3/16" chk, 3 hrs, TP 671#

8-7-69 COMPLETION REPORTED

**NEW MEXICO OIL CONSERVATION COMMISSION  
WELL LOCATION AND ACREAGE DEDICATION PLAT**

Form C-102  
Supersedes C-128  
Effective 1-1-65

All distances must be from the outer boundaries of the Section.

Operator <b>Zia Energy, Inc.</b>			Lease <b>L. D. Jones</b>		Well No. <b>1</b>
Unit Letter <b>H</b>	Section <b>1</b>	Township <b>20 South</b>	Range <b>38 East</b>	County <b>Lea</b>	
Actual Footage Location of Well:					
<b>2310</b>		feet from the <b>North</b>	line and	<b>330</b>	feet from the <b>East</b> line
Ground Level Elev. <b>3593'</b>	Producing Formation <b>Blinebry</b>		Pool <b>House Blinebry</b>		Dedicated Acreage: <b>40</b> Acres

1. Outline the acreage dedicated to the subject well by colored pencil or hachure marks on the plat below.
2. If more than one lease is dedicated to the well, outline each and identify the ownership thereof (both as to working interest and royalty).
3. If more than one lease of different ownership is dedicated to the well, have the interests of all owners been consolidated by communitization, unitization, force-pooling, etc?

☐ Yes    ☐ No    If answer is "yes," type of consolidation \_\_\_\_\_

If answer is "no," list the owners and tract descriptions which have actually been consolidated. (Use reverse side of this form if necessary.) \_\_\_\_\_

No allowable will be assigned to the well until all interests have been consolidated (by communitization, unitization, forced-pooling, or otherwise) or until a non-standard unit, eliminating such interests, has been approved by the Commission.

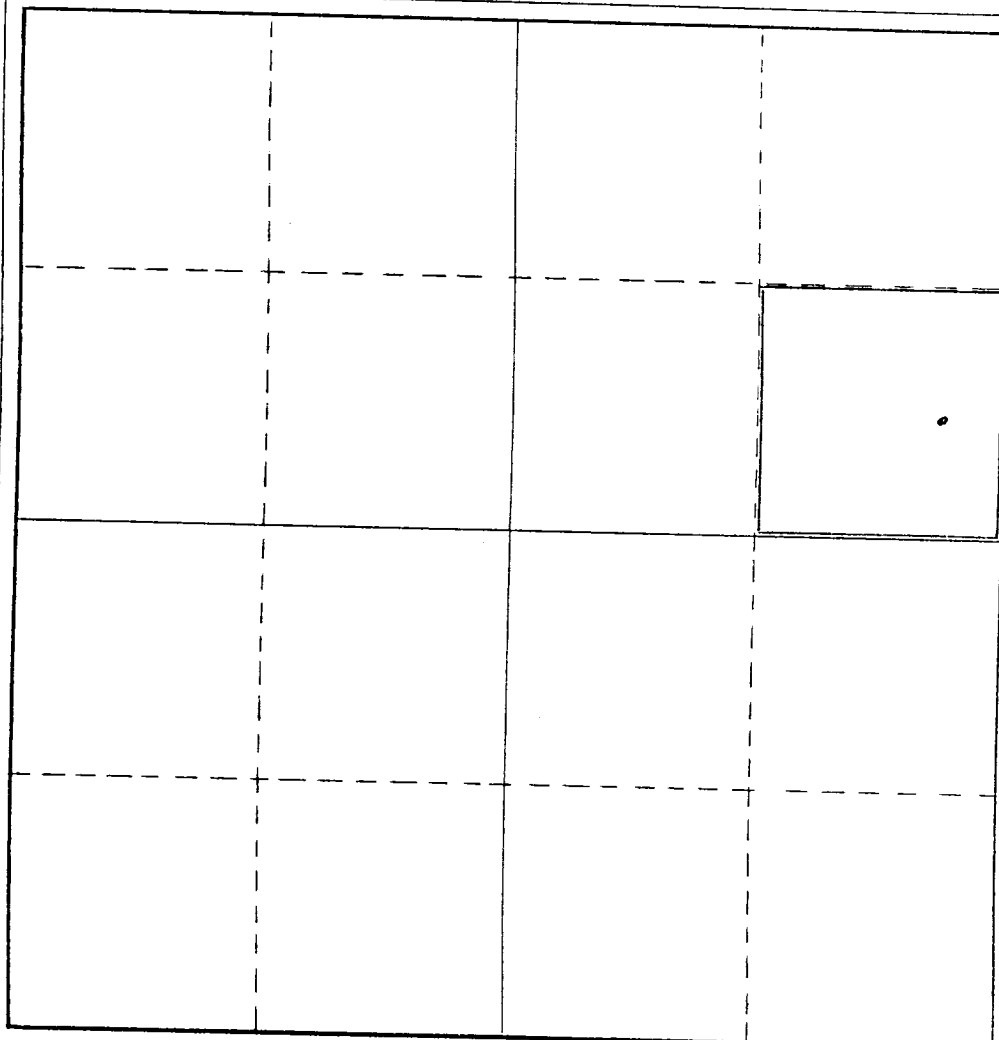

**CERTIFICATION**

*I hereby certify that the information contained herein is true and complete to the best of my knowledge and belief.*

Name  
*M. J. Nelson*  
Position  
**Engineer**  
Company  
**Zia Energy, Inc.**  
Date  
**11/7/83**

*I hereby certify that the well location shown on this plat was plotted from field notes of actual surveys made by me or under my supervision, and that the same is true and correct to the best of my knowledge and belief.*

Date Surveyed \_\_\_\_\_  
Registered Professional Engineer  
and/or Land Surveyor \_\_\_\_\_

Certificate No. \_\_\_\_\_



**AMENDED****WELL LOCATION AND ACREAGE DEDICATION PLAT**Supplement to Form  
E-10-11-65

All distances must be from the outer boundaries of the Section

Operator <b>Damson Exploration Corp.</b>			Lease <b>JONES</b>		Well No. <b>1</b>
Quarter Section <b>H</b>	Section <b>1</b>	Township <b>20 SOUTH</b>	Range <b>38 EAST</b>	County <b>LEA</b>	
A. Well Location Location of Well: <b>2310</b> feet from the <b>NORTH</b> line and <b>330</b> feet from the <b>EAST</b> line					
Ground Surface Elev. <b>3593</b>	Producing Formation <b>Tubb, Drinkard Blinebry</b>	Pool <b>Undesignated House Blinebry</b>	Borehole <b>160</b>		

1. Outline the acreage dedicated to the subject well by colored pencil or hatchure marks on the plat below.
2. If more than one lease is dedicated to the well, outline each and identify the ownership thereof (both as to working interest and royalty).
3. If more than one lease of different ownership is dedicated to the well, have the interests of all owners been consolidated by communitization, unitization, force-pooling, etc?

☐ Yes ☐ No If answer is "yes," type of consolidation \_\_\_\_\_

If answer is "no," list the owners and tract descriptions which have actually been consolidated. (Use reverse side of this form if necessary.) \_\_\_\_\_

No allowable will be assigned to the well until all interests have been consolidated (by communitization, unitization, forced-pooling, or otherwise) or until a non-standard unit, eliminating such interests, has been approved by the Commission.

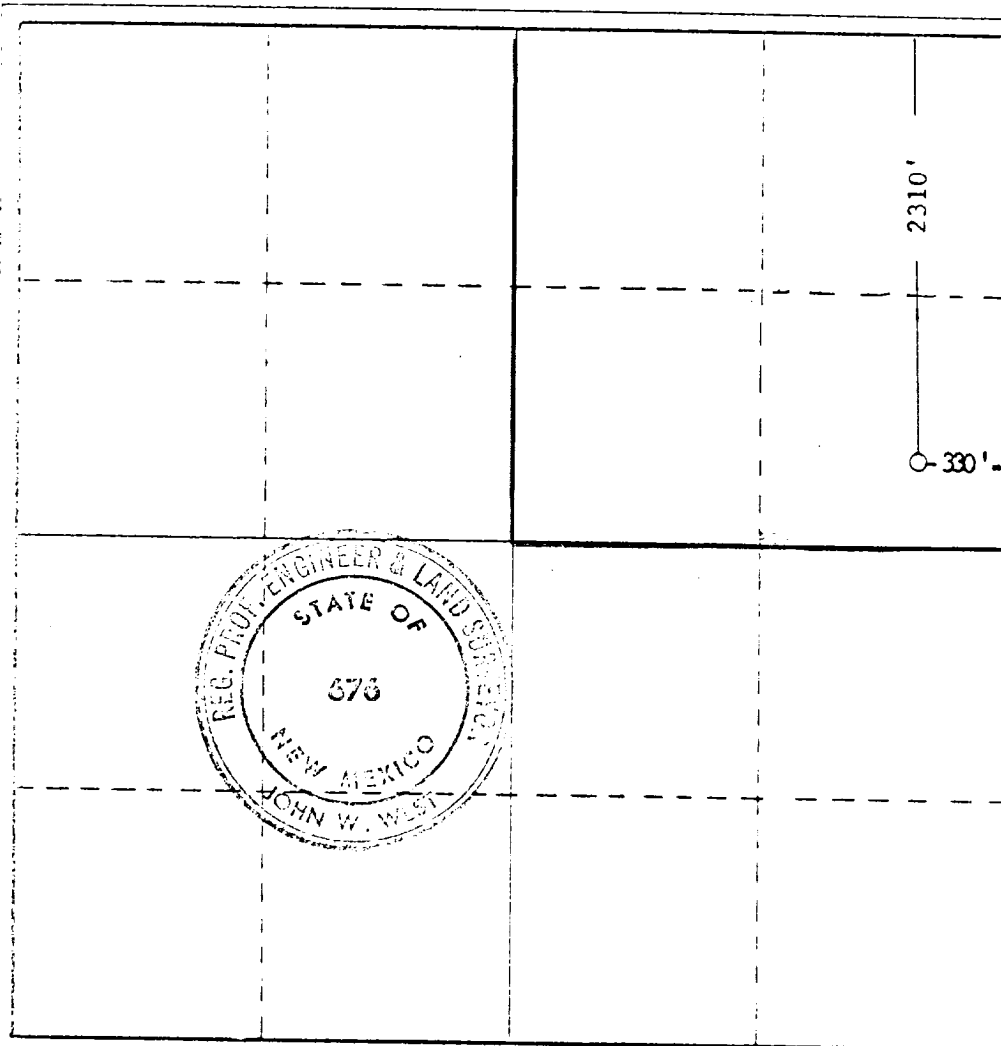
**CERTIFICATION**

I hereby certify that the information contained herein is true and complete to the best of my knowledge and belief.

Name James Bell

Position Agent

Company  
**Damson Exploration Corp.**

Date  
**5-7-69**

I hereby certify that the well location shown on this plat was plotted from field notes of actual surveys made by me or under my supervision, and that the same is true and correct to the best of my knowledge and belief.

Date Surveyed  
**OCTOBER 12, 1968**

Registered Professional Engineer and or Land Surveyor

John W. West

Certificate No. **676**