

NUMBER OF COPIES RECEIVED	
DISTRIBUTION	
SANTA FE	
FILE	
U.S.G.S.	
LAND OFFICE	
TRANSPORTER	OIL
	GAS
PRODUCTION OFFICE	
OPERATOR	

**NEW MEXICO OIL CONSERVATION COMMISSION**  
**Santa Fe, New Mexico**

Form C-101  
Revised (12/1/55)

**NOTICE OF INTENTION TO DRILL**

Notice must be given to the District Office of the Oil Conservation Commission and approval obtained before drilling or recompletion begins. If changes in the proposed plan are considered advisable, a copy of this notice showing such changes will be returned to the sender. Submit this notice in QUINTUPLICATE. One copy will be returned following approval. See additional instructions in Rules and Regulations of the Commission. If State Land submit 6 Copies Attach Form C- 128 in triplicate to first 3 copies of form C-101

Midland, Texas  
(Place)

July 12, 1962  
(Date)

OIL CONSERVATION COMMISSION  
SANTA FE, NEW MEXICO

Gentlemen:

You are hereby notified that it is our intention to commence the Drilling of a well to be known as

Hisson Drilling Company  
(Company or Operator)

Byers  
(Lease)

Well No. 1, in 1 The well is

located 320 feet from the West line and 1650 feet from the South line of Section 7, T. 20S, R. 33E, NMPM.

(GIVE LOCATION FROM SECTION LINE) Skarga Pool, Lea County

If State Land the Oil and Gas Lease is No.

If patented land the owner is. Various

Address.

We propose to drill well with drilling equipment as follows: Rotary

The status of plugging bond is. Blanket Bond

Travelers Indemnity

Drilling Contractor Hisson Drilling Company

Midland, Texas

We intend to complete this well in the Grayburg formation at an approximate depth of 4000 feet.

**CASING PROGRAM**

We propose to use the following strings of Casing and to cement them as indicated:

Size of Hole	Size of Casing	Weight per Foot	New or Second Hand	Depth	Sacks Cement
12-1/4	6-5/8	24	New	300	250
6-3/4	4-3/4	10.50	"	4000	125

If changes in the above plans become advisable we will notify you immediately.

ADDITIONAL INFORMATION (If recompletion give full details of proposed plan of work.)

COPIES MUST BE CIRCULATED SOON

Approved \_\_\_\_\_, 19\_\_\_\_  
Except as follows:

\* Cement must tie back  
into \_\_\_\_\_

OIL CONSERVATION COMMISSION

By \_\_\_\_\_

Sincerely yours,

Hisson Drilling Company  
(Company or Operator)

By \_\_\_\_\_

Position Agent

Send Communications regarding well to

Name Hisson Drilling Company

Address Box 953, Midland, Texas

**NEW MEXICO OIL CONSERVATION COMMISSION**  
**WELL LOCATION AND ACREAGE DEDICATION PLAT**

FORM C-128  
 Revised 5/1/57

**SEE INSTRUCTIONS FOR COMPLETING THIS FORM ON THE REVERSE SIDE**

**SECTION A**

Operator <b>HISSOM DRILLING COMPANY</b>			Lease <b>BYERS</b>		Well No. <b>1</b>
Unit Letter <b>L</b>	Section <b>7</b>	Township <b>20 SOUTH</b>	Range <b>38 EAST</b>	County <b>LEA</b>	

Actual Footage Location of Well:  
**1650** feet from the **SOUTH** line and **330** feet from the **WEST** line

Ground Level Elev. <b>3556.6'</b>	Producing Formation <b>Grayburg</b>	Pool <b>Skaggs</b>	Dedicated Acreage: <b>40.57</b> Acres
--------------------------------------	--	-----------------------	--

1. Is the Operator the only owner in the dedicated acreage outlined on the plat below? YES ☒ NO ☐ ("Owner" means the person who has the right to drill into and to produce from any pool and to appropriate the production either for himself or for himself and another. (65-3-29 (e) NMSA 1935 Comp.)
2. If the answer to question one is "no," have the interests of all the owners been consolidated by communitization agreement or otherwise? YES ☐ NO ☐ If answer is "yes," Type of Consolidation \_\_\_\_\_
3. If the answer to question two is "no," list all the owners and their respective interests below:

Owner	Land Description

**SECTION B**

**CERTIFICATION**

I hereby certify that the information in SECTION A above is true and complete to the best of my knowledge and belief.

Name <i>David L. Hunt</i>
Position <b>Agent</b>
Company <b>Hissom Drilling Company</b>
Date <b>July 13, 1962</b>

I hereby certify that the well location shown on the plat in SECTION B was plotted from field notes of actual surveys made by me or under my supervision, and that the same is true and correct to the best of my knowledge and belief.

Date Surveyed <b>7-11-62</b>
Registered Professional Engineer and/or Land Surveyor, <b>JOHN W. WEST</b>
Certificate No. <i>John W. West</i> <b>N.M. - P.E. &amp; L.S. NO. 676</b>

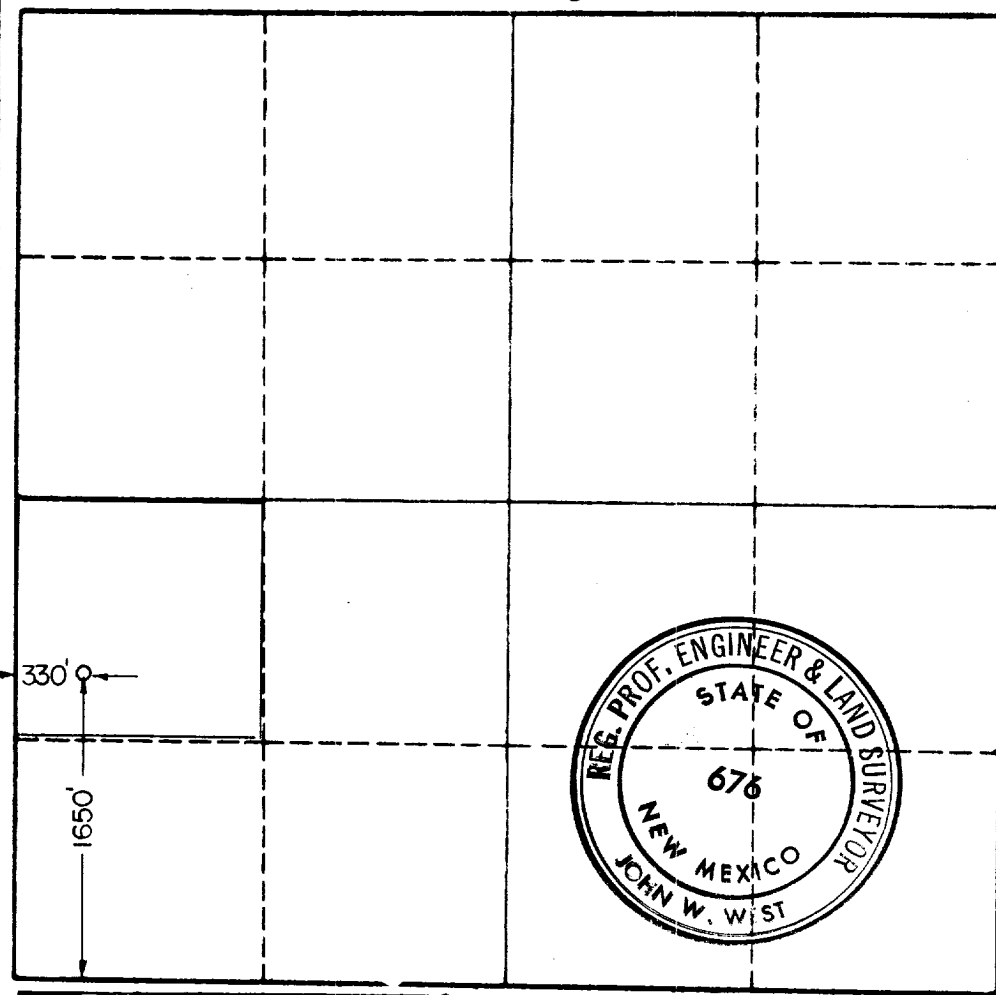

0 330 660 990 1320 1650 1980 2310 2640 2000 1500 1000 500 0