

WELL LOCATION

COMPANY

AMERADA PETROLEUM CORP.

LEASE

USA-HOWSE

WELL NO.

1

RECEIVED
DEC 18 1950OIL CONSERVATION COMMISSION
HOBBS-OFFICE

NOTE: THE 1/4 CORNER MARKER COMMON TO SECTIONS
1 AND 6 WAS USED AS FORESIGHT. THE EAST 1/4 CORNER
MARKER OF SEC 12 AND NE CORNER OF SEC 12 HAVE
BEEN REMOVED.

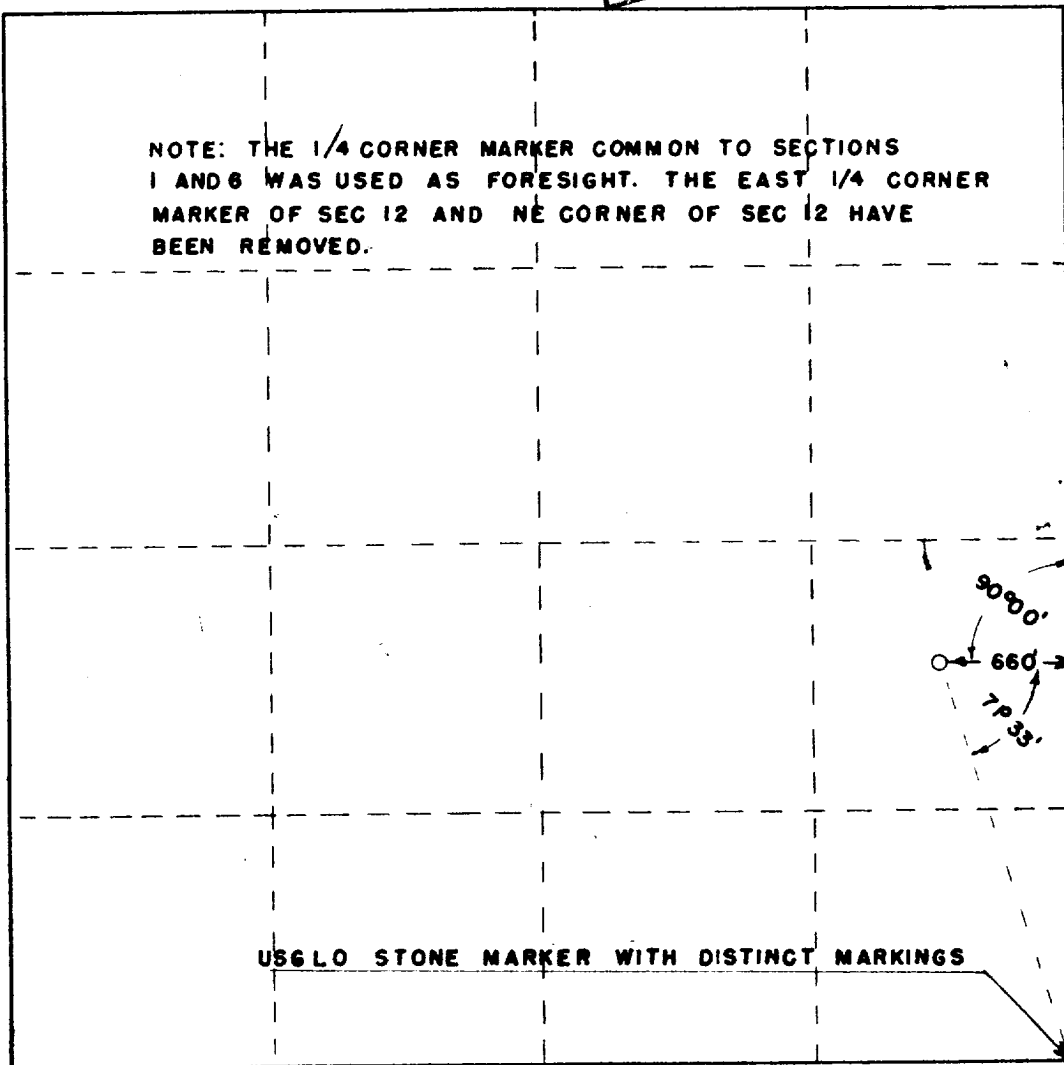
SEC. 12 TWP. 20 S. RGE. 38 E. N.M.P.M.

I CERTIFY THAT THIS SURVEY WAS MADE UNDER
MY DIRECTION, AND THAT THE PLAT IS CORRECT
TO THE BEST OF MY KNOWLEDGE.

John W. West
NEW MEXICO LICENSE NO. 676

G.H.

APPROVED
DEC 18 1950

Date

DEC 9, 1950