

APPROVED COPY TO O. C. C.

Form 9-581a
(Feb. 1961)

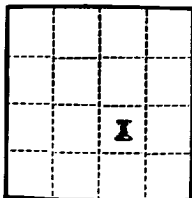

SEP 5 1961 (SUBMIT IN TRIPLICATE)

HOBBS

Budget Bureau No. 42-R388.4
Approval expires 12-31-60.

Land Office Las Cruces
Lease No. LC 031670b
Unit NMFU

E. W. STANDLEY
DISTRICT ~~DEPAR~~ **UNITED STATES**
DEPARTMENT OF THE INTERIOR
GEOLOGICAL SURVEY

SEP 5 1961

REC

SUNDRY NOTICES AND REPORTS ON WELLS

SEP 5 1961

U. S. GEOLOGICAL SURVEY
HOBBS, NEW MEXICO

NOTICE OF INTENTION TO DRILL.....	<input checked="" type="checkbox"/>	SUBSEQUENT REPORT OF WATER SHUT-OFF.....	
NOTICE OF INTENTION TO CHANGE PLANS.....		SUBSEQUENT REPORT OF SHOOTING OR ACIDIZING.....	
NOTICE OF INTENTION TO TEST WATER SHUT-OFF.....		SUBSEQUENT REPORT OF ALTERING CASING.....	
NOTICE OF INTENTION TO RE-DRILL OR REPAIR WELL.....		SUBSEQUENT REPORT OF RE-DRILLING OR REPAIR.....	
NOTICE OF INTENTION TO SHOOT OR ACIDIZE.....		SUBSEQUENT REPORT OF ABANDONMENT.....	
NOTICE OF INTENTION TO PULL OR ALTER CASING.....		SUPPLEMENTARY WELL HISTORY.....	
NOTICE OF INTENTION TO ABANDON WELL.....			

(INDICATE ABOVE BY CHECK MARK NATURE OF REPORT, NOTICE, OR OTHER DATA)

WARREN UNIT ~~McKEE~~

September 5, 1961

Well No. 28 is located 1980 ft. from S line and 2310 ft. from E line of sec. 20

SE 1/4 Section 20

(1/4 Sec. and Sec. No.)

20

(Twp.)

38

(Range)

N.M.P.M.

(Meridian)

Warren McKee

(Field)

Lea

(County or Subdivision)

New Mexico

(State or Territory)

The elevation of the derrick floor above sea level is _____ ft.

DETAILS OF WORK

(State names of and expected depths to objective sands; show sizes, weights, and lengths of proposed casings; indicate mudding jobs, cementing points, and all other important proposed work)

It is our intention to drill a well at the above location to a TD of approximately 9100' with rotary tools, in order to develop McKee oil reserves on the lease.

All casing points will be cemented in accordance with approved methods of the U.S.G.S. and any special requirements will be complied with.

It is planned to use the following casing pattern: 13-3/8" surface string to be set at approximately 250' and cemented with 300 sacks to surface; 9-5/8" intermediate string to be set at approximately 3000' to be cemented with 1550 sacks; 7" production string to be set at approximately 9100' and cemented with 500 sacks.

Approval to produce this well upon completion is also requested.

I understand that this plan of work must receive approval in writing by the Geological Survey before operations may be commenced.

Company Continental Oil Company

Address Box 427

Hobbs, New Mexico

By [Signature]

District Superintendent

Title

U.S.G.S. (5) PARTNERS (6) WAM FILE

NEW MEXICO OIL CONSERVATION COMMISSION
WELL LOCATION AND ACREAGE DEDICATION PLAT

FORM C-128
Revised 5/1/57

SEE INSTRUCTIONS FOR COMPLETING THIS FORM ON THE REVERSE SIDE

SECTION A

Operator CONTINENTAL OIL COMPANY		Lease WARREN UNIT MCKEE		Well No. 28
Unit Letter J	Section 20	Township 20 SOUTH, RANGE	Range 38 EAST	County LEA
Actual Footage Location of Well: 1980 feet from the SOUTH line and 2310 feet from the EAST line				
Ground Level Elev.	Producing Formation McKee		Pool Warren McKee	Dedicated Acreage: 40 Acres

1. Is the Operator the only owner in the dedicated acreage outlined on the plat below? YES ☒ NO ____ ("Owner" means the person who has the right to drill into and to produce from any pool and to appropriate the production either for himself or for himself and another. (65-3-29 (e) NMSA 1935 Comp.)
2. If the answer to question one is "no," have the interests of all the owners been consolidated by communitization agreement or otherwise? YES ____ NO ____ . If answer is "yes," Type of Consolidation ____
3. If the answer to question two is "no," list all the owners and their respective interests below:

Owner	Land Description

SECTION B

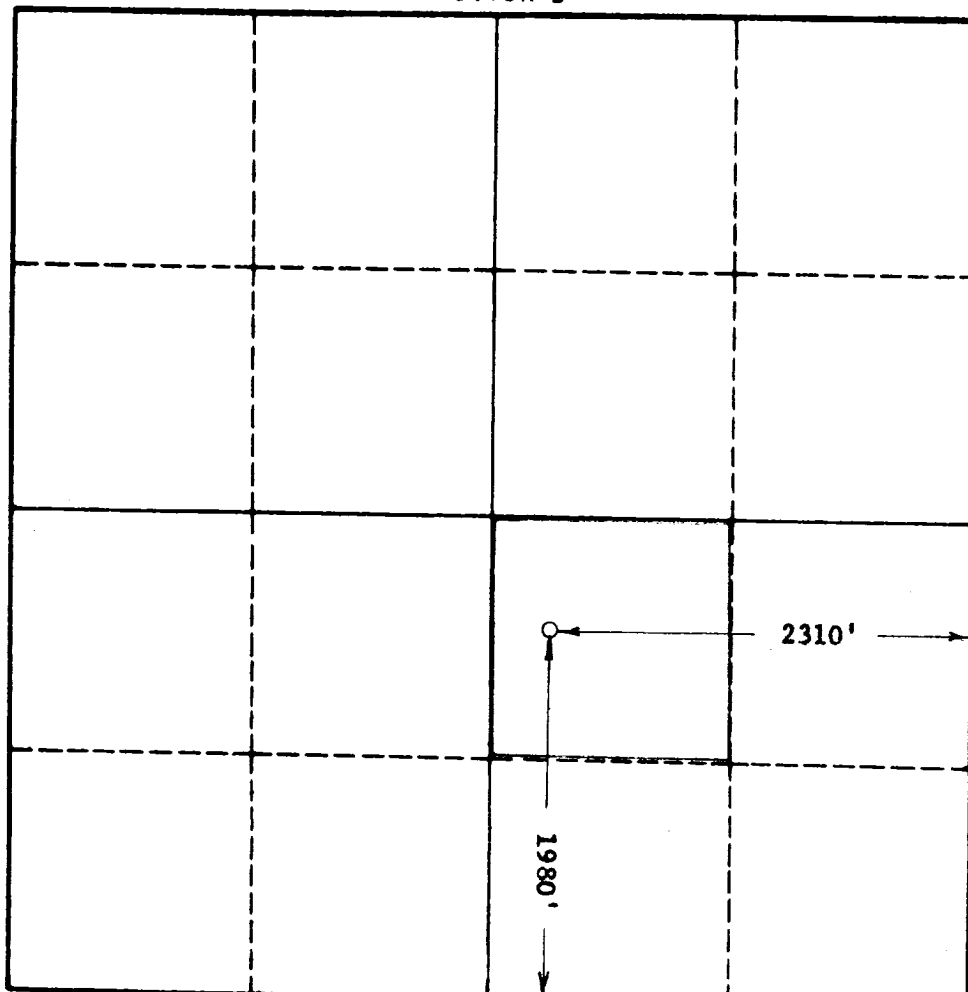

CERTIFICATION

I hereby certify that the information in SECTION A above is true and complete to the best of my knowledge and belief.

Name <i>L. M. Adair</i>
Position District Superintendent
Company Continental Oil Company
Date September 5, 1961

I hereby certify that the well location shown on the plat in SECTION B was plotted from field notes of actual surveys made by me or under my supervision, and that the same is true and correct to the best of my knowledge and belief.

Date Surveyed SEPTEMBER 2, 1961
Registered Professional Engineer and/or Land Surveyor, JOHN E. WEST
Certificate No. 676
N. M. S. E. L. S. NO. 676