



IN REPLY REFER TO:

UNITED STATES  
DEPARTMENT OF THE INTERIOR

GEOLOGICAL SURVEY

P. O. Box 1338  
Hobbs, New Mexico

December 7, 1956

Continental Oil Company  
Box 427  
Hobbs, New Mexico

Re: Lease Las Cruces 031670(b)

Gentlemen:

Receipt is acknowledged of "Notice of Intention to Drill" dated December 6, 1956, covering your well No. 53 SEMI McKee on the subject leasehold in the SW $\frac{1}{4}$  sec. 20, T. 20 S., R. 33 E., N.M.P.M., Lea County, New Mexico.

Your proposed work is approved subject to compliance with the provisions of the "Oil and Gas Operating Regulations" revised May 25, 1942, copy of which will be furnished you on request, and subject to the following condition:

1. Drilling operations so authorized are subject to the attached sheet (revised February 1955) for general conditions of approval.

Very truly yours,

H. A. DuPont  
District Engineer

(SUBMIT IN TRIPLICATE)

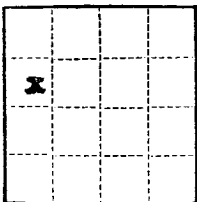
Land Office Las Cruces  
Lease No. 10 031670 b  
Unit S. E. N. U.UNITED STATES  
DEPARTMENT OF THE INTERIOR  
GEOLOGICAL SURVEY  
60 11 1 47

## SUNDRY NOTICES AND REPORTS ON WELLS

NOTICE OF INTENTION TO DRILL.....	<input checked="" type="checkbox"/>	SUBSEQUENT REPORT OF WATER SHUT-OFF.....	
NOTICE OF INTENTION TO CHANGE PLANS.....		SUBSEQUENT REPORT OF SHOOTING OR ACIDIZING.....	
NOTICE OF INTENTION TO TEST WATER SHUT-OFF.....		SUBSEQUENT REPORT OF ALTERING CASING.....	
NOTICE OF INTENTION TO RE-DRILL OR REPAIR WELL.....		SUBSEQUENT REPORT OF RE-DRILLING OR REPAIR.....	
NOTICE OF INTENTION TO SHOOT OR ACIDIZE.....		SUBSEQUENT REPORT OF ABANDONMENT.....	
NOTICE OF INTENTION TO PULL OR ALTER CASING.....		SUPPLEMENTARY WELL HISTORY.....	
NOTICE OF INTENTION TO ABANDON WELL.....			

(INDICATE ABOVE BY CHECK MARK NATURE OF REPORT, NOTICE, OR OTHER DATA)

STW McKee Co. 53

Hobbs, New Mexico December 6, 1956

Well No. 53 is located 2096 ft. from N line and 554 ft. from W line of sec. 20N 1/4 Section 20  
(1/4 Sec. and Sec. No.)206  
(Twp.)36  
(Range)N. M. P. M.  
(Meridian)North Warren McKee  
(Field)Lea  
(County or Subdivision)New Mexico  
(State or Territory)

The elevation of the derrick floor above sea level is \_\_\_\_\_ ft.

## DETAILS OF WORK

(State names of and expected depths to objective sands; show sizes, weights, and lengths of proposed casings; indicate mudding jobs, cementing points, and all other important proposed work)

It is our intention to drill a well at the above location to a total depth of approximately 9250' with rotary tools in order to continue development of McKee oil reserves and to meet demands of the USGS for further development of federal leases comprising the Southeast Monument Unit. All casing points will be cemented in accordance with approved methods of the U. S. Geological Survey and any other special requirements will be complied with.

It is planned to use the following casing pattern: 10 3/4" to be set at 250' and cemented with approximately 250 sacks, cement to be circulated. 7 5/8" to be set at 3400' and cemented with approximately 1100 sacks. 5 1/2" to be set at 9250', cemented with approximately 450 sacks and to be perforated opposite the pay zone.

Approval to produce this well upon completion is also requested.

I understand that this plan of work must receive approval in writing by the Geological Survey before operations may be commenced.

Company Continental Oil CompanyAddress Box 427Hobbs, New MexicoBy [Signature]Title District Superintendent

NEW MEXICO  
OIL CONSERVATION COMMISSION

Form C-128

Well Location and/or Gas Proration Plat

ROBBS OFFICE 000

Date 12-3-1956

Operator CONTINENTAL OIL Co. Lease SEMU. MEKEE

Well No. 53 Section 20 Township 20-S Range 38-E NMPM

Located 2086 Feet From NORTH Line, 554 Feet From WEST Line,

LEA County, New Mexico. G. L. Elevation \_\_\_\_\_

Name of Producing Formation \_\_\_\_\_ Pool \_\_\_\_\_ Dedicated Acreage \_\_\_\_\_

(Note: All distances must be from outer boundaries of Section)

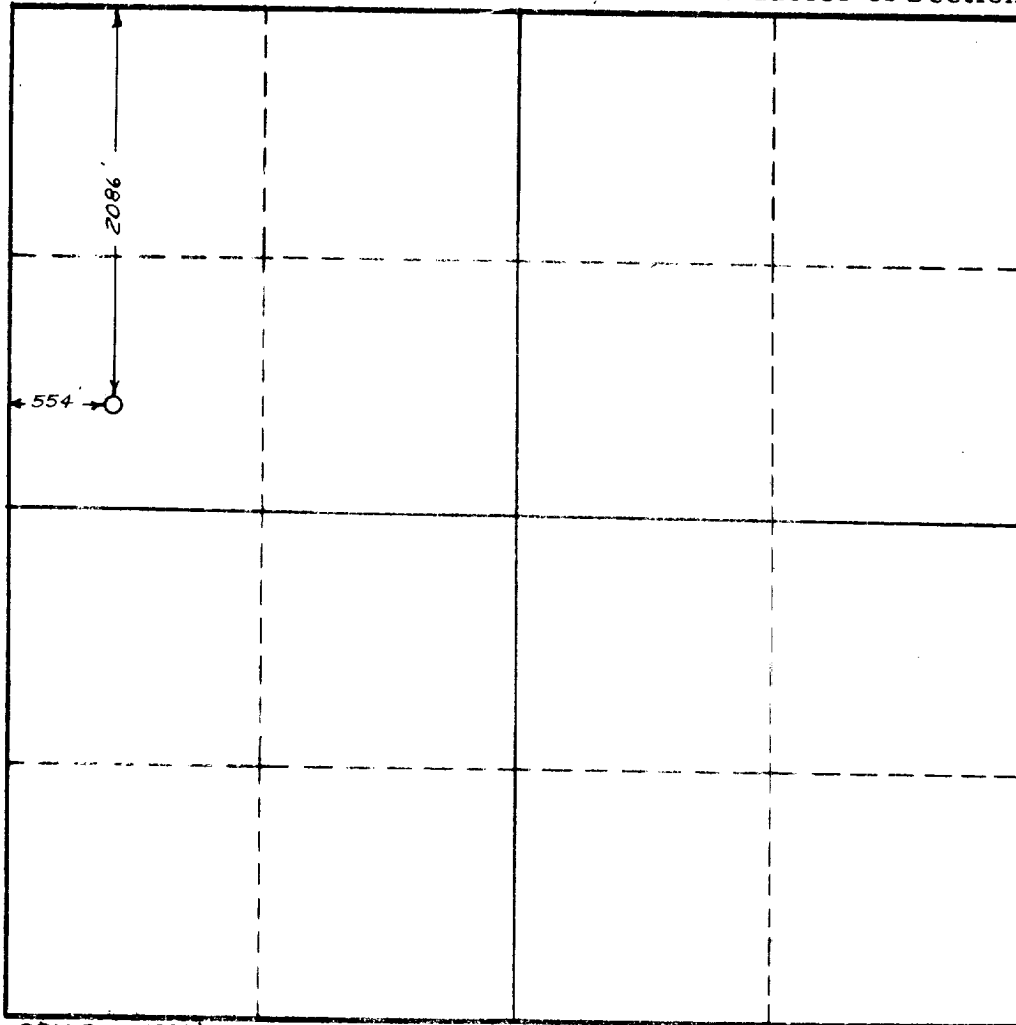

SCALE: 1" = 1000'

1. Is this Well a Dual Comp. ? Yes \_\_\_ No \_\_\_
2. If the answer to Question 1 is yes, are there any other dually completed wells within the dedicated acreage? Yes \_\_\_ No \_\_\_

This is to certify that the above plat was prepared from field notes of actual surveys made by me or under my supervision and that the same are true and correct to the best of my knowledge and belief.

Name \_\_\_\_\_  
Position \_\_\_\_\_  
Representing \_\_\_\_\_  
Address \_\_\_\_\_

Date Surveyed 12-3-1956  
John W. West  
Registered Professional Engineer and/or  
Land Surveyor