

NEW MEXICO OIL CONSERVATION COMMISSION

Santa Fe, New Mexico

NOTICE OF INTENTION TO DRILL OR RECOMPLETION

Notice must be given to the District Office of the Oil Conservation Commission and approval obtained before drilling or recompletion begins. If changes in the proposed plan are considered advisable, a copy of this notice showing such changes will be returned to the sender. Submit this notice in QUINTUPPLICATE. One copy will be returned following approval. See additional instructions in Rules and Regulations of the Commission. If State Land submit 6 Copies

MIDLAND, TEXAS

(Place)

FEBRUARY 19, 1957

(Date)

OIL CONSERVATION COMMISSION
SANTA FE, NEW MEXICO

Gentlemen:

You are hereby notified that it is our intention to commence the (Drilling) (Recompletion) of a well to be known as

THE BRITISH AMERICAN OIL PRODUCING COMPANY, P.O. BOX 2818, MIDLAND, TEXAS

(Company or Operator)

HALL STATE "F"

(Lease)

Well No. 2

in 0

(Unit)

The well is

located 660 feet from the SOUTH line and 1650 feet from the

EAST

Line of Section 11, T. 22-S, R. 35-E, NMPM.

(GIVE LOCATION FROM SECTION LINE)

JALMAT

Pool,

LEA

County

If State Land the Oil and Gas Lease is No. STATE E-8244

If patented land the owner is

Address

We propose to drill well with drilling equipment as follows: 4100 w/rotary.

The status of plugging bond is \$ 10,000 Continental Casualty Company
effective 1947.

Drilling Contractor Unknown

We intend to complete this well in the Yates Sand Formation

formation at an approximate depth of 38-4100 feet.

CASING PROGRAM

We propose to use the following strings of Casing and to cement them as indicated:

Size of Hole	Size of Casing	Weight per Foot	New or Second Hand	Depth	Sacks Cement
13 3/4"	8 5/8"OD	24	NEW	330	250
7 7/8"	4 1/2"OD	11.6	NEW	4100	300

If changes in the above plans become advisable we will notify you immediately.

ADDITIONAL INFORMATION (If recompletion give full details of proposed plan of work.)

Note: Please call Collect approval to Drill to: C.E. Brandon, Dist. Supt.
Phone MU-4 8021,
Midland, Texas

Sincerely yours,

The British American Oil Producing Co.

(Company or Operator)

By A.E. Gandy

Position Asst. Dist. Clerk

Send Communications regarding well to

Name C.E. Brandon, Dist. Supt.,

Address P.O. Box 2818, Midland, Texas

OIL CONSERVATION COMMISSION

By

E.J. Fischer

NEW MEXICO
OIL CONSERVATION COMMISSION

Form C-128

Well Location and/or Gas Proration Plat

Date JAN. 21, 1957

Operator BRITISH AMERICAN OIL PROD'G CO Lease HALL- STATE "F"

Well No. _____ Section 11 Township 22-S Range 35-E NMPM

Located 660 Feet From SOUTH Line, 1650 Feet From EAST Line,

LEA County, New Mexico. G. L. Elevation 3608

Name of Producing Formation YATES- SAND Pool JALMAT Dedicated Acreage 40

(Note: All distances must be from outer boundaries of Section)

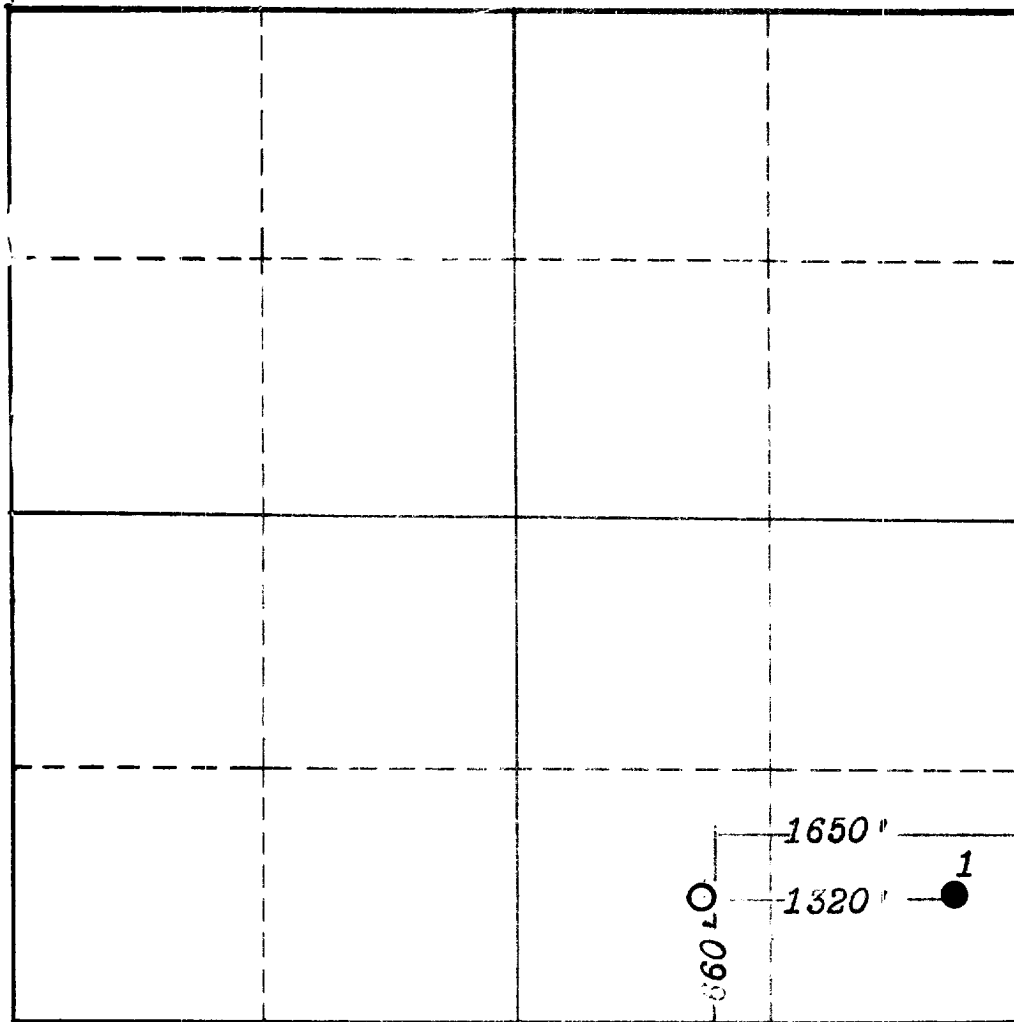

NOTE

This section of
form is to be
used for gas
wells only.



SCALE: 1"=1000'

1. Is this Well a Dual Comp. ? Yes ___ No ___.
2. If the answer to Question 1 is yes, are there any other dually completed wells within the dedicated acreage ? Yes ___ No ___.

Name _____
Position _____
Representing _____
Address _____

This is to certify that the above plat was prepared from field notes of actual surveys made by me or under my supervision and that the same are true and correct to the best of my knowledge and belief.

Date Surveyed JAN. 21, 1957
[Signature]
Registered Professional Engineer and/or
Land Surveyor