

NEW MEXICO OIL CONSERVATION COMMISSION  
MISCELLANEOUS REPORTS ON WELLS

(Submit to appropriate District Office as per Commission Rule 1106)

COMPANY THE BRITISH AMERICAN OIL PRODUCING COMPANY, BOX 474, MIDLAND, TEXAS  
(Address)

LEASE HALL S ATE<sup>TM</sup> WELL NO. 13 UNIT B S 11 T 22-S R 35-E  
DATE WORK PERFORMED SEE BELOW POOL UNDESIGNATED

This is a Report of: (Check appropriate block) ☒ Results of Test of Casing Shut-off  
☒ Beginning Drilling Operations ☐ Remedial Work  
☐ Plugging ☐ Other \_\_\_\_\_

Detailed account of work done, nature and quantity of materials used and results obtained.

1. Spudded well at 6:00 PM 6-26-1958. Drilled 12 1/4" hole to 337ft.
2. Ran 8 jts. 8 5/8"OD Casing 22.7#, Spiral Weld and set at 335'. Cemented with 200 sacks 2% ca. cl. cement. Job complete at 4:00 AM 6-27-1958. Good returns to surface w/cement.
3. W.O.C. Tested casing with 1000 lbs for 30 minutes, held ok. 6-28-1958. Drilled out.

FILL IN BELOW FOR REMEDIAL WORK REPORTS ONLY

Original Well Data:

DF Elev. \_\_\_\_\_ TD \_\_\_\_\_ PBD \_\_\_\_\_ Prod. Int. \_\_\_\_\_ Compl Date \_\_\_\_\_  
Tbng. Dia \_\_\_\_\_ Tbng Depth \_\_\_\_\_ Oil String Dia \_\_\_\_\_ Oil String Depth \_\_\_\_\_  
Perf Interval (s) \_\_\_\_\_  
Open Hole Interval \_\_\_\_\_ Producing Formation (s) \_\_\_\_\_

RESULTS OF WORKOVER:

	BEFORE	AFTER
Date of Test	_____	_____
Oil Production, bbls. per day	_____	_____
Gas Production, Mcf per day	_____	_____
Water Production, bbls. per day	_____	_____
Gas-Oil Ratio, cu. ft. per bbl.	_____	_____
Gas Well Potential, Mcf per day	_____	_____
Witnessed by _____		

(Company)

OIL CONSERVATION COMMISSION

Name E. Fischer  
Title \_\_\_\_\_  
Date \_\_\_\_\_

I hereby certify that the information given above is true and complete to the best of my knowledge.

Name German B. French  
Position Dist. Clerk  
Company The British American Oil Prod. Co.

NEW MEXICO OIL CONSERVATION COMMISSION  
Santa Fe, New Mexico

Form C-101  
Revised (12/1/55)

NOTICE OF INTENTION TO DRILL

Notice must be given to the District Office of the Oil Conservation Commission and approval obtained before drilling or recompletion begins. If changes in the proposed plan are considered advisable, a copy of this notice showing such changes will be returned to the sender. Submit this notice in QUINTUPLICATE. One copy will be returned following approval. See additional instructions in Rules and Regulations of the Commission. If State Land submit 6 Copies Attach Form C-128 in triplicate to first 3 copies of form C-101

Midland, Texas

(Place)

June 23, 1958

(Date)

OIL CONSERVATION COMMISSION  
SANTA FE, NEW MEXICO

Gentlemen:

You are hereby notified that it is our intention to commence the Drilling of a well to be known as

The British-American Oil Producing Company, Post Office Box 474, Midland, Texas

(Company or Operator)

Hall State "F"

(Lease)

Well No. 13

in 8 (Unit)

The well is

located 660 feet from the North line and 2,310 feet from the East

line of Section 11, T. 22-S, R. 35-E, NMPM.

(GIVE LOCATION FROM SECTION LINE)

Undesignated

Pool,

Lea

County

If State Land the Oil and Gas Lease is No. State No. E-8244

If patented land the owner is

Address

We propose to drill well with drilling equipment as follows: Rotary

The status of plugging bond is \$10,000. Continental Casualty Company  
Effective 1947

Drilling Contractor J. C. Grain Drilling Company  
528 Wilson Building, Dallas 1, Texas

We intend to complete this well in the Yates Sand formation at an approximate depth of 3800-4100 feet.

CASING PROGRAM

We propose to use the following strings of Casing and to cement them as indicated:

Size of Hole	Size of Casing	Weight per Foot	New or Second Hand	Depth	Sacks Cement
12 1/4"	8 5/8" OD	22.7	New	330	200
7 7/8"	5 1/2" OD	15.5	New	4100	250

If changes in the above plans become advisable we will notify you immediately.

ADDITIONAL INFORMATION (If recompletion give full details of proposed plan of work.)

NOTE: Please call collect approval to drill to: Cecil E. Brandon, District Superintendent  
Phone MU 3-4201  
Midland, Texas

Approved....., 19.....  
Except as follows:

OIL CONSERVATION COMMISSION

By

Sincerely yours,

The British-American Oil Producing Company  
(Company or Operator)

By German B. French  
Position District Clerk

Send Communications regarding well to

Name Cecil E. Brandon, District Supt.

Address P. O. Box 474, Midland, Texas

NE MEXICO OIL CONSERVATION COMMISSION  
Well Location and Acreage Dedication Plat

Section A.

Date MAY 1

Operator BRITISH AMER. OIL PROD'G CO. Lease HALL- STATE  
Well No. 13 Unit Letter B Section 11 Township 22-S Range 35-E NMPM  
Located 660 Feet From NORTH Line, 2310 Feet From EAST Line  
County LEA G. L. Elevation 3602 Dedicated Acreage 40 Acres  
Name of Producing Formation YATES-SAND Pool JALNET

1. Is the Operator the only owner\* in the dedicated acreage outlined on the plat below?  
Yes X No       .
2. If the answer to question one is "no," have the interests of all the owners been consolidated by communitization agreement or otherwise? Yes        No       . If answer is "yes," Type of Consolidation
3. If the answer to question two is "no," list all the owners and their respective interests below:

<u>Owner</u>	<u>Land Description</u>

Section B

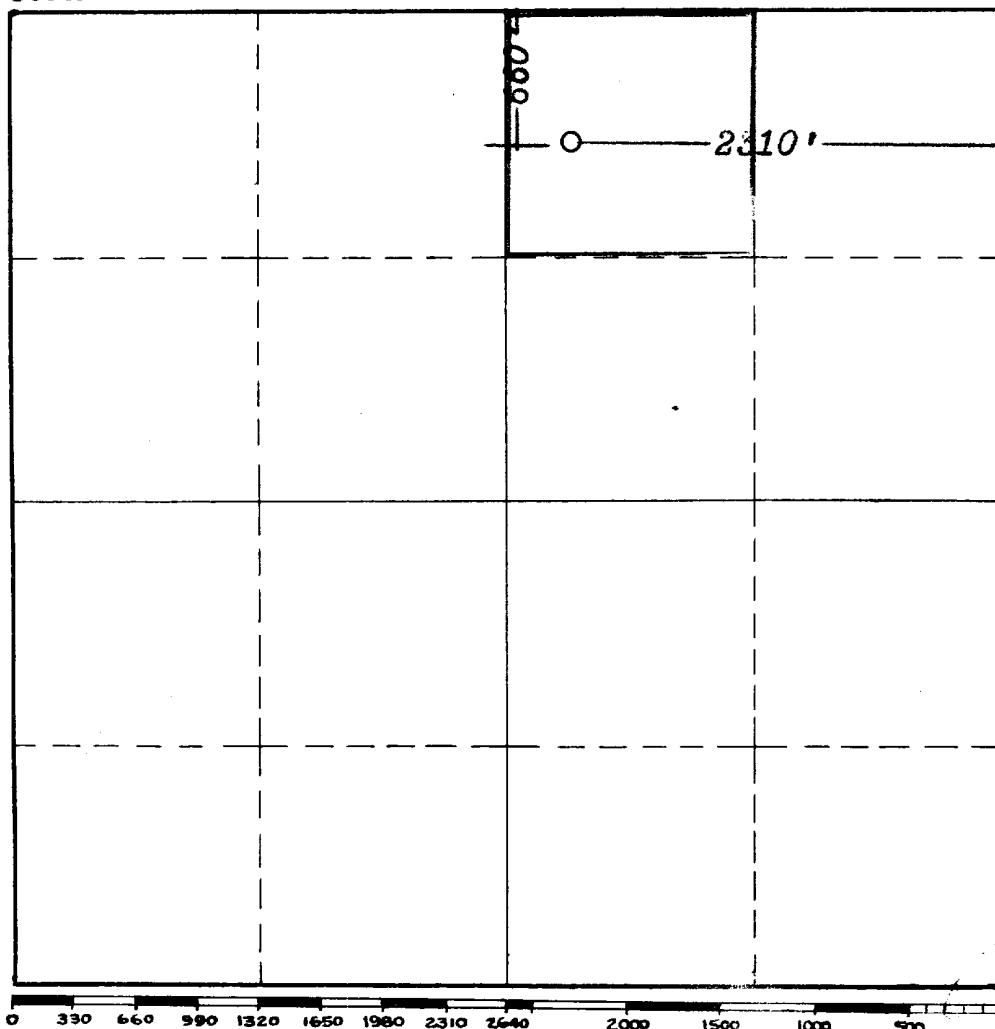

This is to certify that the information in Section A above is true and complete to the best of my knowledge and belief.  
The British-American Oil Prod. Company

(Operator)  
German B. French  
(Representative)  
German B. French, Dist. Clerk  
P. O. Box 474, Midland, Texas  
Address

This is to certify that the well location shown on the plat in Section B was plotted from field notes of actual surveys made by me or under my supervision and that the same is true and correct to the best of my knowledge and belief.  
Date Surveyed MAY 19, 1958

Ray M. Williams  
Registered Professional  
Engineer and/or Land Surveyor.

Certificate No. 754

(See instructions for completing this form on the reverse side)

INSTRUCTIONS FOR COMPLETION:

1. Operator shall furnish and certify to the information called for in Section A.
2. Operator shall outline the dedicated acreage for both oil and gas wells on the plat in Section B.
3. A registered professional engineer or land surveyor registered in the State of New Mexico or approved by the Commission shall show on the plat the location of the well and certify this information in the space provided.
4. All distances shown on the plat must be from the outer boundaries of Section.
5. If additional space is needed for listing owners and their respective interests as required in question 3, Section A. please use space below

\* "Owner" means the person who has the right to drill into and to produce from any pool and to appropriate the production either for himself or for himself and another. (65-3-29 (e) NMSA 1953 Comp)