

October 27, 1954

Mr. W. B. Macey, Secretary
New Mexico Oil Conservation Commission
P. O. Box 871
Santa Fe, New Mexico

Re: Application By J. R. Cone
For a Non-Standard Gas
Proration Unit Embracing
320 Acres Of His Nix-State
Lease, Jalmat Gas Pool,
Lea County, New Mexico

Dear Sir:

C C O P Y
Comes now J. R. Cone, an independent producer with offices in Lubbock, Texas, who respectfully requests approval of a non-standard gas proration unit as an exception to those provisions of Order No. R-520 which pertain to the Jalmat Gas Pool, and in support thereof does state:

1. That Applicant is the owner of a lease covering all of the S/2 of Section 13, T-22-S, R-35-E, NMPM, Lea County, New Mexico, said lease being known as the J. R. Cone Nix-State lease.

2. That Applicant completed his No. 1 well as a dry gas producer from the Yates formation at a location 1980 feet from the South line and 660 feet from the East line of the said Section 13. This is the only well that has been drilled on the S/2 of the said Section 13.

3. That Applicant requests that all of the S/2 of Section 13, T-22-S, R-35-E, be designated as a 320-acre gas proration unit for Cone Nix-State Well No. 1 in exception to Rule 5 (a) of Order No. R-520; and, that the limits of the Jalmat Gas Pool be extended to include all of the S/2 of Section 13, T-22-S, R-35-E. Only 160 acres, being the SE/4 of the said Section 13, are now assigned to Nix-State No. 1 for proration purposes and included in the Jalmat Gas Pool.

4. That a plat showing the above-described lease and well together with the operators owning interests within a 1500-foot radius of the well is attached hereto.

5. That a copy of this application with plat attached has been addressed by registered mail to those operators described in Paragraphs 5 and 6 of Rule 5 (b), Order No. R-520, "Special Rules And Regulations For The Jalmat Gas Pool", namely:

Cities Service Oil Company
P. O. Box 97
Hobbs, New Mexico

The Texas Company
P. O. Box 1270
Midland, Texas

Respectfully submitted,

cc with plat:
Cities Service Oil Company
The Texas Company
✓ Oil Conservation Commission, Hobbs

J. R. Cone
By L. O. Storm
L. O. Storm, Agent

10/1/54

MEMORANDUM FOR THE RECORD
SUBJECT: [illegible]
[illegible]

[illegible]
[illegible]
[illegible]
[illegible]
[illegible]

[illegible]
[illegible]
[illegible]
[illegible]
[illegible]

[illegible]
[illegible]
[illegible]
[illegible]

[illegible]
[illegible]
[illegible]
[illegible]
[illegible]

[illegible]
[illegible]
[illegible]
[illegible]
[illegible]
[illegible]
[illegible]
[illegible]

[illegible]
[illegible]
[illegible]
[illegible]

[illegible]
[illegible]
[illegible]
[illegible]
[illegible]

[illegible]
[illegible]
[illegible]

[illegible]
[illegible]
[illegible]

[illegible]

[illegible]
[illegible]
[illegible]
[illegible]

[illegible]
[illegible]
[illegible]
[illegible]

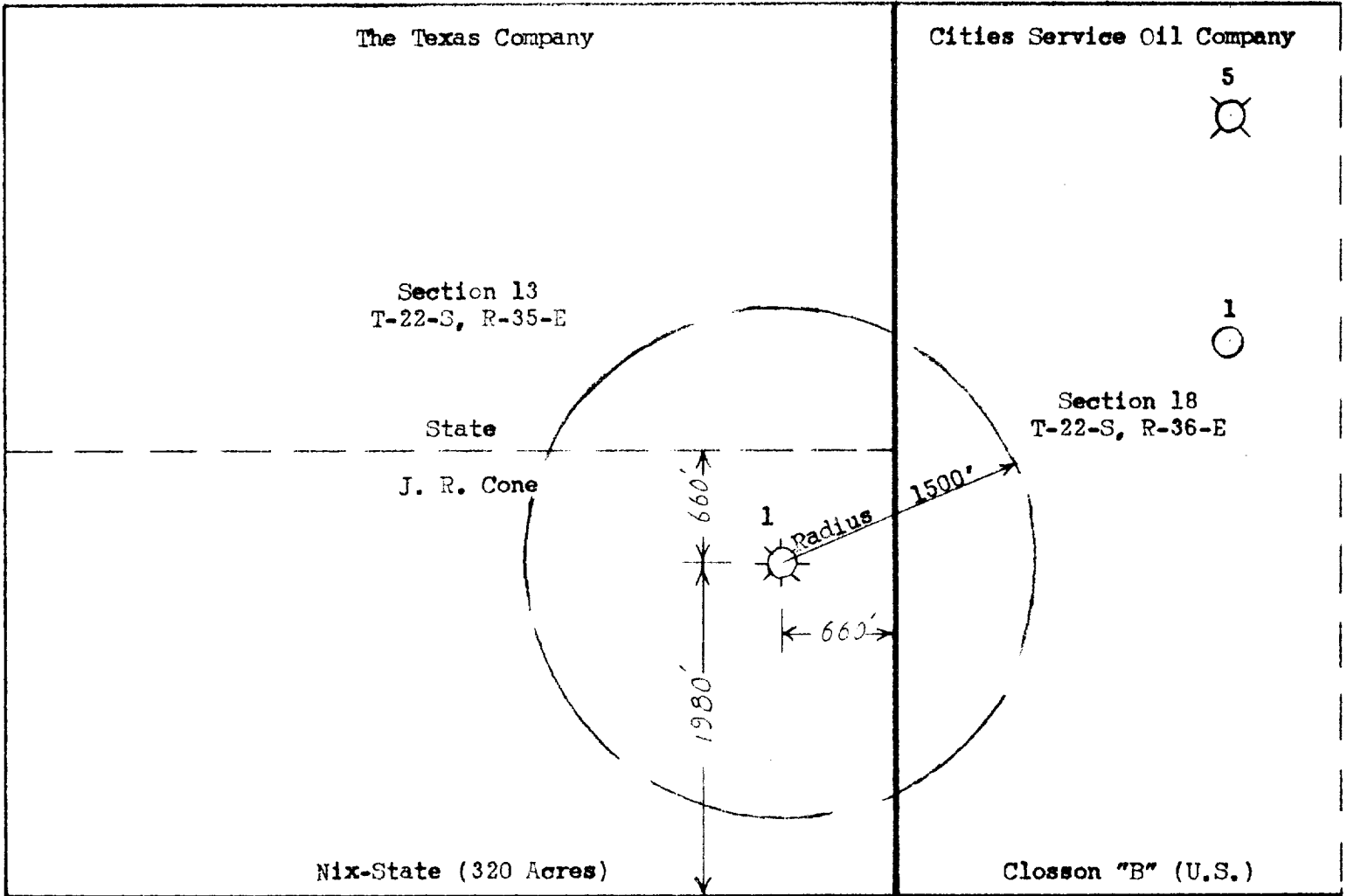

Plat Showing
 J. R. Cone Nix-State Lease
 S/2 Section 13, T-22-S, R-35-E
 JALMAT GAS POOL
 Lea County, New Mexico

To Accompany Application For
 320-Acre Non-Standard Gas Unit
 For J. R. Cone Nix-State Well No. 1
 Scale 1" = 1000'