

NEW MEXICO OIL CONSERVATION COMMISSION
WELL LOCATION AND ACREAGE DEDICATION PLAT

FORM C-128
Revised 5/1/57

SEE INSTRUCTIONS FOR COMPLETING THIS FORM ON THE REVERSE SIDE

MINES OFFICE OCC

SECTION A

Operator Schermmerhorn Oil Corporation		Lease Amerada		1960 JAN 22 AM 10:19	
Unit Letter I	Section 24	Township 22 South	Range 35 East	County Lea County	
Actual Footage Location of Well: 660' feet from the East line and 1980' feet from the South line					
Ground Level Elev. 3584	Producing Formation Yates		Pool Jalmat Gas	Dedicated Acreage: 160 Acres	

1. Is the Operator the only owner in the dedicated acreage outlined on the plat below? YES ☒ NO ☐ ("Owner" means the person who has the right to drill into and to produce from any pool and to appropriate the production either for himself or for himself and another. (65-3-29 (e) NMSA 1935 Comp.)
2. If the answer to question one is "no," have the interests of all the owners been consolidated by communitization agreement or otherwise? YES ☐ NO ☐ If answer is "yes," Type of Consolidation _____
3. If the answer to question two is "no," list all the owners and their respective interests below:

Owner	Land Description

SECTION B

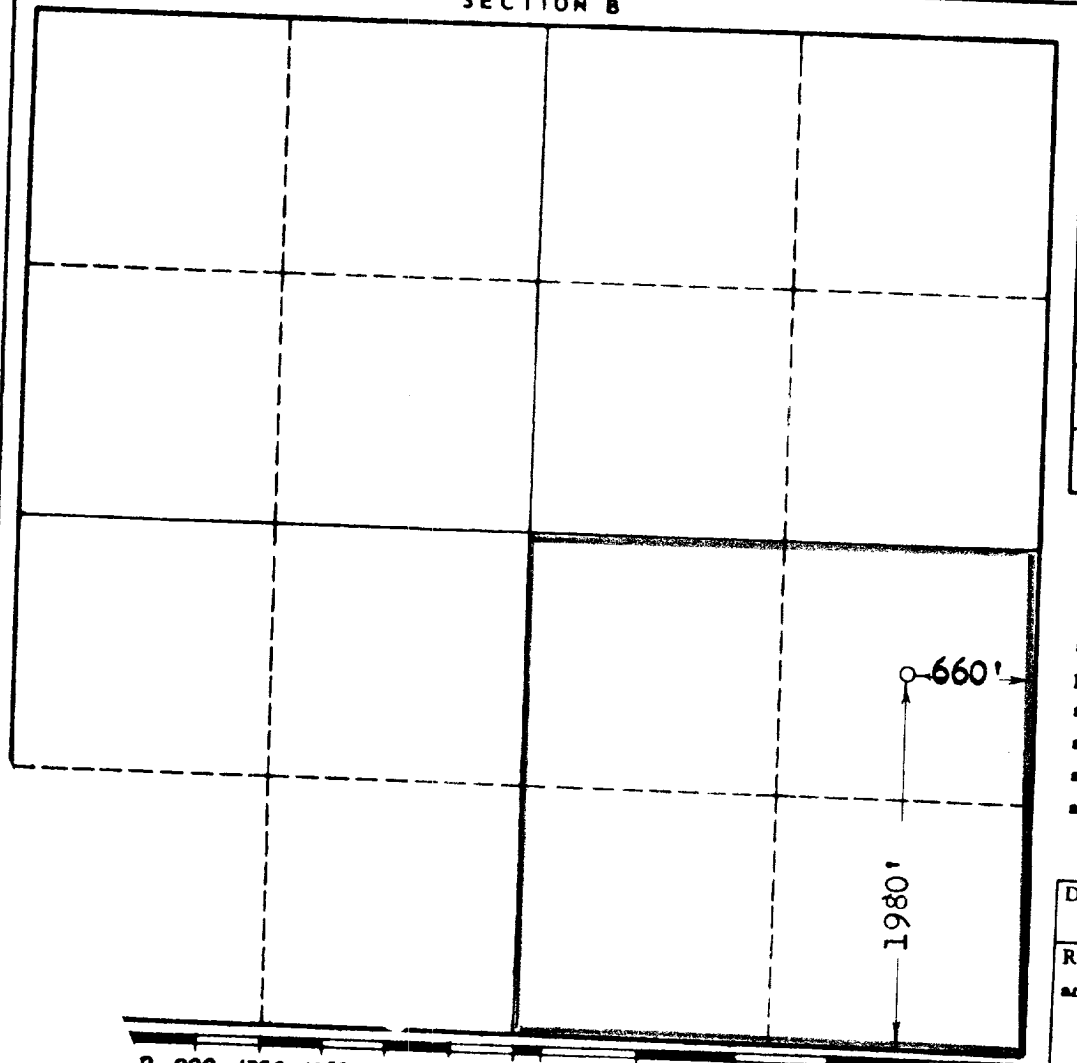

CERTIFICATION

I hereby certify that the information in SECTION A above is true and complete to the best of my knowledge and belief.

Name: J. Hiram Moore
Position: Geologist
Company: Schermmerhorn Oil Corp.
Date: January 19, 1960

I hereby certify that the well location shown on the plat in SECTION B was plotted from field notes of actual surveys made by me or under my supervision, and that the same is true and correct to the best of my knowledge and belief.

Date Surveyed: 3-28-1955
Registered Professional Engineer and/or Land Surveyor, JOHN W. [Signature]
Certificate No. N.M. - P.E. & L.S. NO. 1