

UNITED STATES
DEPARTMENT OF THE INTERIOR
BUREAU OF LAND MANAGEMENT

APPLICATION FOR PERMIT TO DRILL OR DEEPEN

1a. TYPE OF WORK

DRILL ☐

DEEPEN ☒

b. TYPE OF WELL

OIL
WELL ☐

GAS
WELL ☐

OTHER INJECTOR

SINGLE
ZONE ☒

MULTIPLE
ZONE ☐

2. NAME OF OPERATOR

CHEVRON U.S.A. INC.

3. ADDRESS AND TELEPHONE NO.

P.O. BOX 1150 MIDLAND, TX 79702 (915) 687-7812

4. LOCATION OF WELL (Report location clearly and in accordance with any State requirements.)*

At surface 1980 FNL & 660 FWL

At proposed prod. zone

Unit E

14. DISTANCE IN MILES AND DIRECTION FROM NEAREST TOWN OR POST OFFICE*

3 MILES WEST OF EUNICE New Mexico

15. DISTANCE FROM PROPOSED*

LOCATION TO NEAREST
PROPERTY OR LEASE LINE, FT.
(Also to nearest drig. unit line, if any)

18. DISTANCE FROM PROPOSED LOCATION*

TO NEAREST WELL, DRILLING, COMPLETED,
OR APPLIED FOR, ON THIS LEASE, FT.

16. NO. OF ACRES IN LEASE

5,922.26

19. PROPOSED DEPTH

4300

17. NO. OF ACRES ASSIGNED
TO THIS WELL

40

20. ROTARY OR CABLE TOOLS

ROTARY

21. ELEVATIONS (Show whether DF, RT, GR, etc.)

3519 GE

22. APPROX. DATE WORK WILL START*

ASAP

23.

EXISTING ~~PROPOSED~~ CASING AND CEMENTING PROGRAM

SIZE OF HOLE	GRADE SIZE OF CASING	WEIGHT PER FOOT	SETTING DEPTH	QUANTITY OF CEMENT
UNKNOWN	10 3/4"	30.51	274	225 SX.
UNKNOWN	7 5/8"	26.4	1284	425 SX.
UNKNOWN	5 1/2"	17	3739	425 SX.

- 1.) SQZ. CSG AS NEEDED. DEEPEN WELL FROM 3825' TO 4300'.
- 2.) CONVERT TO INJECTION, SELECTIVELY PERF AS NEEDED.
- 3.) STARCH & BRINE MUD SYSTEM
- 4.) WELL NAME CHANGE FROM CONOCO LOCKHART B-1 #1
TO ARROWHEAD GRAYBURG UNIT #158.

USE 2000 PSF BOPE

IN ABOVE SPACE DESCRIBE PROPOSED PROGRAM: If proposal is to deepen, give data on present productive zone and proposed new productive zone. If proposal is to drill or deepen directionally, give pertinent data on subsurface locations and measured and true vertical depths. Give blowout preventer program, if any.

SIGNED

P.R. Matthews

TITLE

TECHNICAL ASSISTANT

DATE

9/20/91

(This space for Federal or State office use)

PERMIT NO.

APPROVAL DATE

Application approval does not warrant or certify that the applicant holds legal or equitable title to those rights in the subject lease which would entitle the applicant to conduct operations thereon.

CONDITIONS OF APPROVAL, IF ANY:

APPROVED BY

TITLE

DATE

10/4/91

*See Instructions On Reverse Side

Title 18 U.S.C. Section 1001, makes it a crime for any person knowingly and willfully to make to any department or agency of the United States any false, fictitious or fraudulent statements or representations as to any matter within its jurisdiction.

Submit to Appropriate
District Office
State Lease - 4 copies
Fee Lease - 3 copies

State of New Mexico
Energy, Minerals and Natural Resources Department

Form C-102
Revised 1-1-89

OIL CONSERVATION DIVISION

P.O. Box 2088
Santa Fe, New Mexico 87504-2088

DISTRICT I
P.O. Box 1980, Hobbs, NM 88240

DISTRICT II
P.O. Drawer DD, Artesia, NM 88210

DISTRICT III
1000 Rio Brazos Rd., Aztec, NM 87410

WELL LOCATION AND ACREAGE DEDICATION PLAT

All Distances must be from the outer boundaries of the section

Operator CHEVRON USA INC.			Lease ARROWHEAD GRAYBURG		Well No. 158
Unit Letter E	Section 1	Township 22 S	Range 36 E	County LEA, NM	
Actual Footage Location of Well: 1980 feet from the NORTH line and 660 feet from the WEST line					
Ground level Elev. 3519	Producing Formation GRAYBURG		Pool ARROWHEAD / GRAYBURG		Dedicated Acreage: 40 Acres

- Outline the acreage dedicated to the subject well by colored pencil or hatchure marks on the plat below.
- If more than one lease is dedicated to the well, outline each and identify the ownership thereof (both as to working interest and royalty).
- If more than one lease of different ownership is dedicated to the well, have the interest of all owners been consolidated by communitization, unitization, force-pooling, etc.?
☐ Yes ☐ No If answer is "yes" type of consolidation _____
If answer is "no" list the owners and tract descriptions which have actually been consolidated. (Use reverse side of this form if necessary). _____
No allowable will be assigned to the well until all interests have been consolidated (by communitization, unitization, forced-pooling, or otherwise) or until a non-standard unit, eliminating such interest, has been approved by the Division.

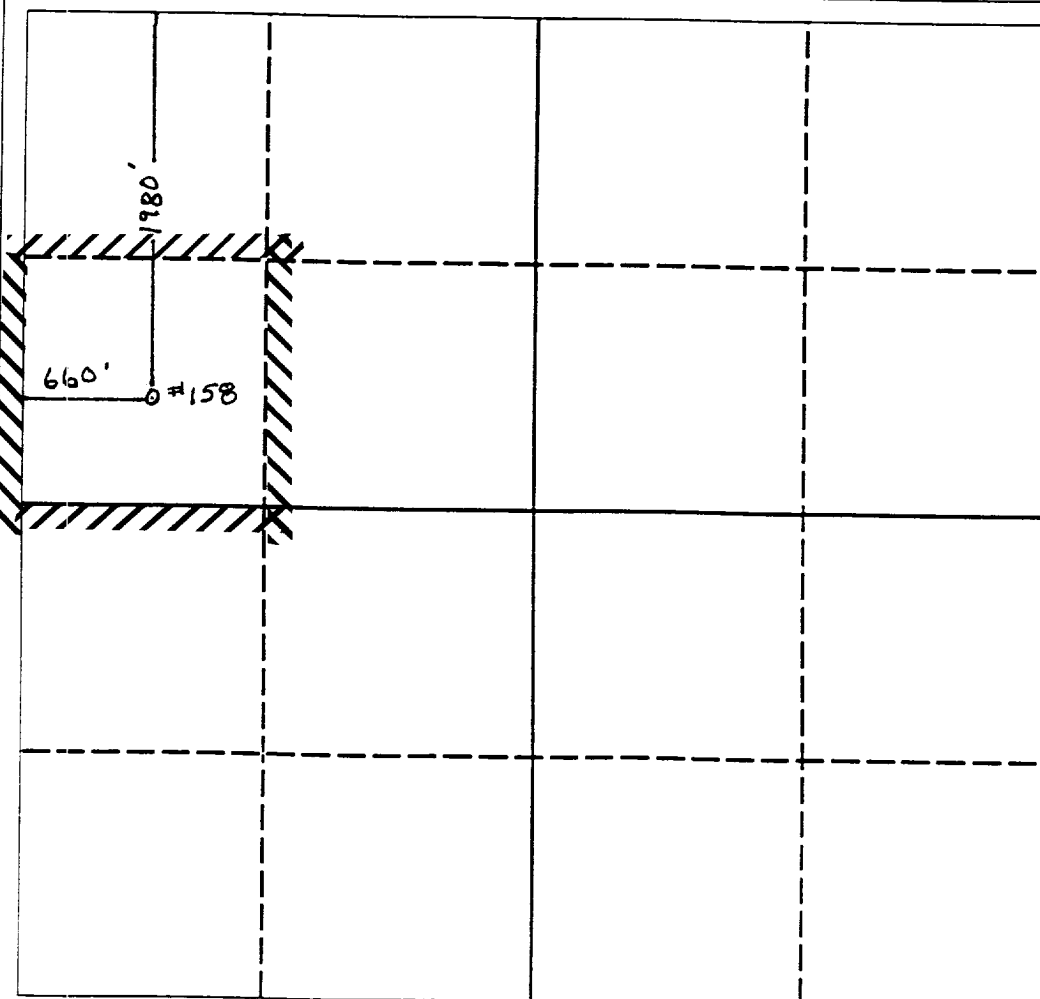

OPERATOR CERTIFICATION

I hereby certify that the information contained herein is true and complete to the best of my knowledge and belief.

Signature
P.R. Matthews
Printed Name
P.R. MATTHEWS
Position
TECHNICAL ASST
Company
CHEVRON USA INC.
Date
9/20/91

SURVEYOR CERTIFICATION

I hereby certify that the well location shown on this plat was plotted from field notes of actual surveys made by me or under my supervision, and that the same is true and correct to the best of my knowledge and belief.

Date Surveyed

Signature & Seal of
Professional Surveyor

Certificate No.

0 330 660 990 1320 1650 1980 2310 2640 2000 1500 1000 500 0